

Contraforte "Variável" 3,30m 187,8 580516000

Abstützbock Variabel 3,30m

Constituído por:

(A) **Cinta para contraforte WU14** 99,0 580510000

pintado de azul
altura: 252 cm

(B) **Cinta multi-uso WS10 Top50 2,00m** 38,9 580007000

pintado de azul

(C) **Placa de tracção** 2,5 580534000

pintado de azul
comprimento: 19 cm

(D) **Calço de base** 9,5 580532000

pintado de azul
comprimento: 28 cm

(E) **Cavilha de ligação 10cm** 0,34 580201000

galvanizado
comprimento: 14 cm

(F) **Pinça de mola 5mm** 0,05 580204000

galvanizado
comprimento: 13 cm

(G) **Escora de reclinacção 12 3,00m** 32,0 580521000

pintado de azul
comprimento: 201 - 234 cm

(H) **Abraçadeira simples 48mm 50** 0,84 682002000

galvanizado
tamanho de chave: 22 mm

pintado de azul

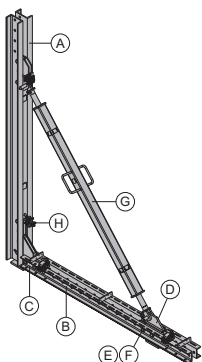

Placa de tracção

Zuglasche

2,5 580534000



pintado de azul
comprimento: 19 cm

Cinta multi-uso WS10 Top50 1,00m 19,6 580003000

Cinta multi-uso WS10 Top50 1,75m 35,0 580006000

Cinta multi-uso WS10 Top50 2,00m 38,9 580007000

Cinta multi-uso WS10 Top50 2,50m 48,7 580009000

Cinta multi-uso WS10 Top50 2,75m 54,2 580010000

Cinta multi-uso WS10 Top50 3,00m 60,2 580011000

Cinta multi-uso WS10 Top50 3,50m 68,4 580012000

Cinta multi-uso WS10 Top50 4,00m 79,4 580013000

Mehrweckriegel WS10 Top50

pintado de azul

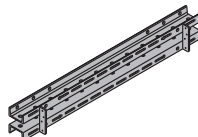

Cinta WS10 Top50 1,00m 20,2 580040000

Cinta WS10 Top50 1,75m 35,8 580043000

Cinta WS10 Top50 2,00m 40,2 580044000

Cinta WS10 Top50 2,50m 51,0 580046000

Cinta WS10 Top50 2,75m 56,1 580047000

Cinta WS10 Top50 3,00m 60,4 580048000

Cinta WS10 Top50 3,50m 71,5 580050000

Cinta WS10 Top50 4,00m 82,1 580052000

Stahlwandriegel WS10 Top50

pintado de azul

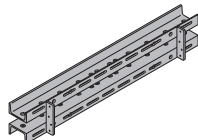

Escora de reclinacção 12 3,00m

Spindelstrebe 12 3,00m

32,0 580521000

pintado de azul
comprimento: 201 - 234 cm

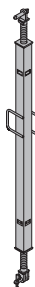

Cinta para contraforte WU14 99,0 580510000

Abstützbockriegel WU14

Constituído por:

(A) **Perfil de suporte WU14** 81,0 580509000

pintado de azul
altura: 250 cm

(B) **Sapata de pressão** 6,2 580531000

pintado de azul
altura: 32 cm

(C) **Base de ancoragem** 12,0 580533000

pintado de azul
altura: 51 cm

pintado de azul
altura: 252 cm

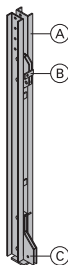

Calço de base 9,5 580532000

Stützsuh

pintado de azul
comprimento: 28 cm

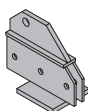

[kg] Artikel nr.

[kg] Artikel nr.

Escora de eixos roscados T7 305/355cm
Spindelstrebe T7 305/355cm

35,0 584327000

galvanizado

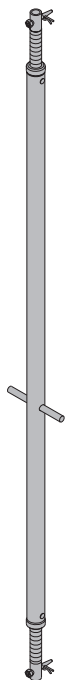

Tramo de contraforte F 1,50m
Anbaurahmen F 1,50m

236,0 580502000

pintado de azul
comprimento: 280 cm

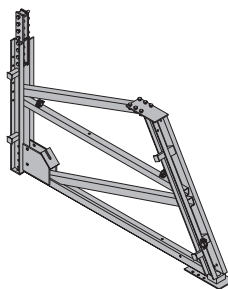

Tramo de contraforte F 2,00m
Anbaurahmen F 2,00m

451,0 580501000

pintado de azul
comprimento: 394 cm

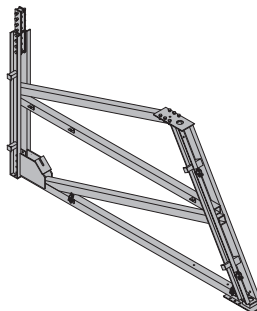

Tala de união FF20/50 Z
Elementverbinder FF20/50 Z

6,0 587533000

pintado de azul
comprimento: 55 cm

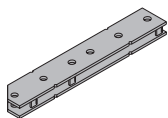

Fuso dianteiro para contraforte
Abstützbockspindel vorne

8,5 580508000

galvanizado

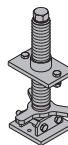

Cavilha de ligação 10cm
Verbindungsbolzen 10cm

0,34 580201000

galvanizado
comprimento: 14 cm

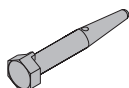

Fuso traseiro para contraforte
Abstützbockspindel hinten

18,3 580515000

galvanizado

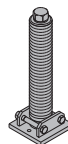

Pinça de mola 5mm
Federvorstecker 5mm

0,05 580204000

galvanizado
comprimento: 13 cm



Cinta de ancoragem 0,70m
Cinta de ancoragem 1,95m
Cinta de ancoragem 2,95m
Ankerriegel

27,0 580517000
76,3 580545000
110,0 580546000

pintado de azul

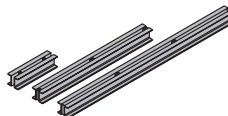

Contraforte universal F 4,50m
Abstützbock-Universal F 4,50m

306,0 580500000

pintado de azul
comprimento: 196 cm
altura: 365 - 394 cm

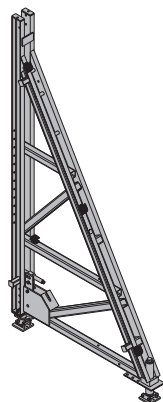

Cinta multi-uso WU12 Top50 2,00m
Cinta multi-uso WU12 Top50 3,00m
Mehrzweckriegel WU12 Top50

50,0 580022000
75,7 580024000

pintado de azul

Perfil ancoragem 0,55m
Ankerprofil 0,55m

44,5 582904000

pintado de azul

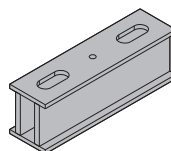

[kg] Artikel nr.

[kg] Artikel nr.

Fixador de cinta de amarração

Ankerriegelhalter

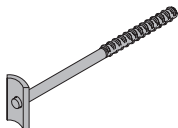
0,62 580539000galvanizado
comprimento: 31 cm**Grampo de cunha Framax**

Framax-Spannklemme

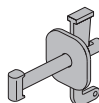
1,5 588152000galvanizado
comprimento: 21 cm**Esquadro de canto para contraforte**

Ecklasche Abstützbock

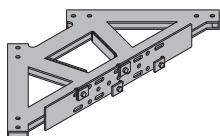
44,4 580518000pintado de azul
comprimento: 92 cm
largura: 92 cm**Conector Framax**

Framax-Bocklasche

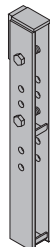
15,0 580506000pintado de azul
altura: 77 cm**Cinta de fachada WS10 2,50m**

Fassadenriegel WS10 2,50m

50,0 580692000

pintado de azul

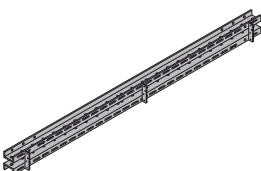
**Parafuso para contraforte Framax 36cm**

Framax-Bockschraube 36cm

0,62 580505000

galvanizado

**Distanciador de apoio 20cm**

Bockdistanz 20cm

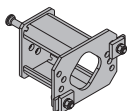
9,4 580519000galvanizado
comprimento: 25 cm
largura: 19 cm
altura: 20 cm**Placa de apoio Framax 6/15**

Framax-Druckplatte 6/15

0,80 588183000

galvanizado

**Grampo distanciador de apoio 20cm**

Klemme für Bockdistanz 20cm

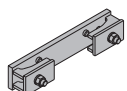
5,0 582920000galvanizado
comprimento: 36 cm
largura: 7 cm**Roda afixável 200**

Ansteckrolle 200

19,3 580538000pintado de azul
altura: 38 cm**Garra de suporte 9-15cm**

Riegelhalter 9-15cm

2,7 580625000

galvanizado

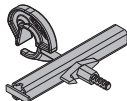
**Roda afixável 250**

Ansteckrolle 250

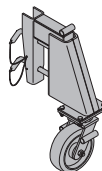
47,0 580537000pintado de azul
altura: 78 cm**Garra de suporte**

Keilriegelhalter

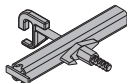
2,5 580526000galvanizado
comprimento: 26 cm
altura: 31 cm**Macaco c. dispositivo de translação**

Hubwinde mit Transportroller

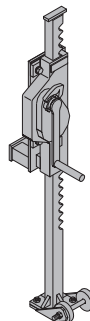
37,0 580541000pintado de azul
altura: 127 cm
Atenção às instruções de serviço!

CE

Parafuso universal Framax 10-16cm

Framax-Universalverbinder 10-16cm

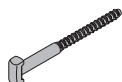
0,60 588158000galvanizado
comprimento: 26 cm**Parafuso universal Framax 10-25cm**

Framax-Universalverbinder 10-25cm

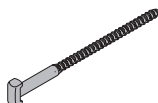
0,69 583002000galvanizado
comprimento: 36 cm

[kg] Artikel nr.

Perfil viajante F 2,00m frontal 180,0 582925000

Verfahrprofil F 2,00m vorne

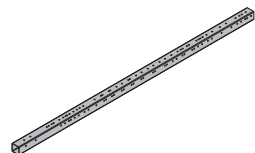
galvanizado
comprimento: 600 cm**Placa parafuso F 2,00m**

Schraubplatte F 2,00m

galvanizado
comprimento: 20 cm

2,9 582933000

Placa conectora F 2.00m

Verbindungsplatte F 2,00m

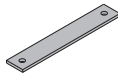
galvanizado
comprimento: 42 cm

2,3 582934000

Conector roda F 2,00m frontal

Radanschluss F 2,00m vorne

33,7 582926000

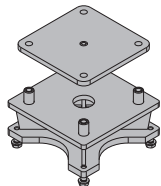
galvanizado
comprimento: 30 cm
largura: 30 cm
altura: 16,5 cm**Gancho de elevação F 2,00m traseiro**

Hubkonsole F 2,00m hinten

14,0 582935000

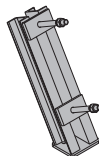
galvanizado
altura: 48,6 cm**Maxila fixação F 2,00m**

Klemmbacke F 2,00m

0,82 582927000

galvanizado
comprimento: 12,5 cm**Abraçadeira simples 48mm 50**

Abraçadeira simples 48mm 95

0,84 682002000

Anschraubkupplung

0,88 586013000

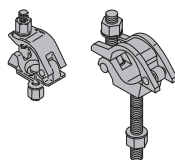
galvanizado
tamanho de chave: 22 mm**Placa fixação F 2,00m**

Klemmplatte F 2,00m

3,5 582928000

galvanizado
comprimento: 24 cm**Abraçadeira giratória 48mm**

Drehkupplung 48mm

1,5 582560000

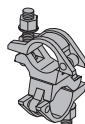
galvanizado
tamanho de chave: 22 mm**Chapa interior F 2,00m**

Zwischenplatte F 2,00m

6,0 582929000

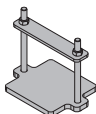
galvanizado
comprimento: 25 cm
largura: 18 cm**Perfil viajante F 2,00m traseiro**

Verfahrprofil F 2,00m hinten

187,5 582930000

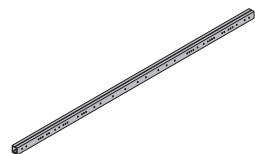
galvanizado
comprimento: 574 cm**Tubo de andaime 48,3mm 1,00m**

3,6 682014000

Tubo de andaime 48,3mm 1,50m

5,4 682015000

Tubo de andaime 48,3mm 2,00m

7,2 682016000

Tubo de andaime 48,3mm 2,50m

9,0 682017000

Tubo de andaime 48,3mm 3,00m

10,8 682018000

Tubo de andaime 48,3mm 3,50m

12,6 682019000

Tubo de andaime 48,3mm 4,00m

14,4 682021000

Tubo de andaime 48,3mm 4,50m

16,2 682022000

Tubo de andaime 48,3mm 5,00m

18,0 682023000

Tubo de andaime 48,3mm 5,50m

19,8 682024000

Tubo de andaime 48,3mm 6,00m

21,6 682025000

Tubo de andaime 48,3mmm

3,6 682001000

Gerüstrohr 48,3mm

galvanizado

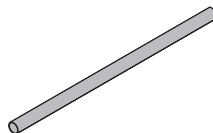
**Conector roda F 2,00m traseiro**

Radanschluss F 2,00m hinten

44,5 582931000

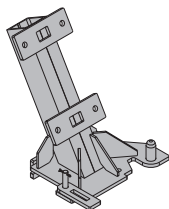
galvanizado
altura: 61,5 cm**Console de betonagem MF75**

Anschraubbühne MF75

19,0 580669000

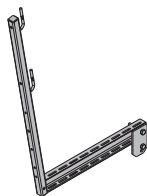
galvanizado
comprimento: 113 cm
altura: 152 cm**Placa ligação F 2,00m**

Anschlussplatte F 2,00m

15,8 582932000

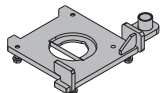
galvanizado
comprimento: 44,1 cm
largura: 35,7 cm

[kg] Artikel nr.

Placa giratória MF

Schwenkplatte MF

4,5 580672000

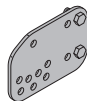

galvanizado
comprimento: 29 cm
altura: 20 cm

[kg] Artikel nr.

Chave de caixa 3/4"

Sechskantnuss 46 3/4"

0,70 580512000

**Lingada de elevação 3,50m**

Kranseilschlaufe 3,50m

8,8 580461000

diâmetro: 16 cm
Atenção às instruções de serviço!

**Extensão 20cm 3/4"**

Verlängerung 20cm 3/4"

0,68 580683000

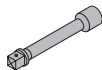
**Cavalete ensaio ancoragens incl. 15,0/20,0**

Prüfbock für Schräganker 15,0/20,0

13,5 580514000

galvanizado
comprimento: 32 cm
largura: 25 cm
altura: 19 cm

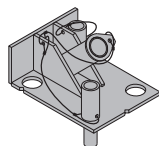
**Chave para cone de posicionamento 20,0**

Konusschlüssel 20,0

3,5 581471000

galvanizado
comprimento: 57 cm

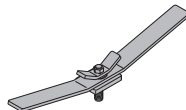
**Caixa de ferramentas universal 15,0**

Universal-Werkzeugbox 15,0

9,1 580392000

Incluído no volume de fornecimento:

(A) Chave de roquete 1/2"

galvanizado
comprimento: 30 cm

0,73 580580000

(B) Chave de bocas 13/17

0,08 580577000

(C) Chave de bocas 22/24

0,22 580587000

(D) Chave de bocas 30/32

0,80 580897000

(E) Chave de bocas 36/41

1,0 580586000

(F) Chave de orelhas 17/19

0,27 580590000

(G) Chave de caixa quadrada 22

0,31 580589000

(H) Chave 41

0,99 580585000

(I) Extensão 11cm 1/2"

0,20 580581000

(J) Extensão 22cm 1/2"

0,31 580582000

(K) Cardan

0,16 580583000

(L) Chave de caixa 19 1/2" L

0,16 580598000

(M) Chave de caixa 13 1/2"

0,06 580576000

(N) Chave de caixa 24 1/2"

0,12 580584000

(O) Chave de caixa 30 1/2"

0,20 580575000

(P) Chave para cone de posicionamento 15,0 DK

galvanizado
comprimento: 8 cm
tamanho de chave: 30 mm

0,30 580579000

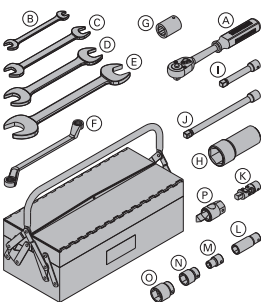
**Escora de eixos roscados T6 100/150cm**

Spindelstrebe T6 100/150cm

12,5 584323000

galvanizado

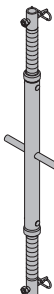
**Escora de eixos roscados T7 100/150cm**

Spindelstrebe T7 100/150cm

16,8 584309000

galvanizado

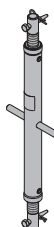
**Escora de eixos roscados T7 200/250cm**

Spindelstrebe T7 200/250cm

26,2 584325000

galvanizado

**Chave de roquete 3/4"**

Umschaltknarre 3/4"

1,5 580894000

galvanizado
comprimento: 50 cm

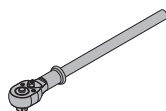

[kg] Artikel nr.

Escora de eixos roscados T7 250/300cm

29,4 584326000

Spindelstrebe T7 250/300cm

galvanizado

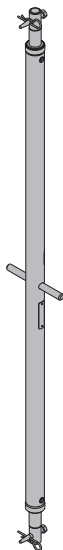

[kg] Artikel nr.

Escora de eixos roscados SL-1 T16 140/225cm

87,8 582872000

Spindelstrebe SL-1 T16 140/225cm

galvanizado

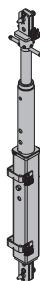

Escora de eixos roscados T10 350/400cm

57,5 584328000

Spindelstrebe T10 350/400cm

galvanizado

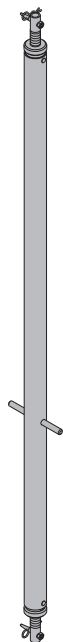

Escora de eixos roscados SL-1 T16 220/375cm

123,0 582874000

Spindelstrebe SL-1 T16 220/375cm

galvanizado



Escora de eixos roscados T10 350/400cm

57,5 584328000

Spindelstrebe T10 350/400cm

galvanizado

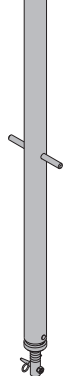

Tramo de contraforte F 2,40m

1107,0 582901000

Anbaurahmen F 2,40m

pintado de azul
comprimento: 576 cm

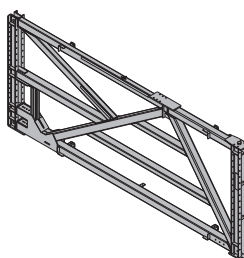

Escora de eixos roscados SL-1 T16 100/140cm

54,1 582871000

Spindelstrebe SL-1 T16 100/140cm

galvanizado

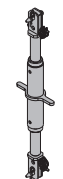

Placa de empalme F 2,40m

32,5 582902000

Aufstocklasche F 2,40m

pintado de azul
altura: 63,5 cm

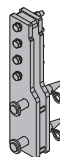

Escora de eixos roscados SL-1 T16 100/140cm

54,1 582871000

Spindelstrebe SL-1 T16 100/140cm

galvanizado



Fuso regulação tramo contraforte F 2,40m

20,1 582903000

Spindel für Anbaurahmen F 2,40m

galvanizado
altura: 47,5 cm

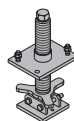

Descimbrador 1000kN

53,5 582905000

Absenkeil 1000kN

pintado de azul
altura: 18,2 - 27,2 cm



[kg] Artikel nr.

[kg] Artikel nr.

Chave de orelhas 80

Ringschlüssel 80

3,8 582906000**Reforço intermédio para contraforte**

Zwischenflansch für Abstützbock

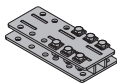
16,2 582911000galvanizado
comprimento: 62,4 cmpintado de azul
comprimento: 42,7 cm**Estabilizador 2,95m**

Verschwertungsprofil 2,95m

42,5 582907000**Calço de base WU16**

Stützschuh WU16

8,3 582912000

pintado de azul

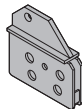
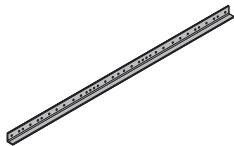
pintado de azul
comprimento: 26,5 cm**Plataforma 1,00m para contraforte**

Bühnenprofil 1,00m für Abstützbock

10,7 582908000**Sapata de pressão T7/T16**

Druckschuh T7/T16

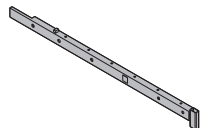
18,5 582913000galvanizado
comprimento: 147,5 cmpintado de azul
altura: 72,5 cm**Lingueta de segurança para plataforma**

Auszugsicherung für Bühnenprofil

1,7 582909000**Cinta multi-uso SL-1 WU16 1,00m**

Mehrzweckriegel SL-1

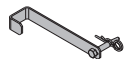
35,0 582877000galvanizado
comprimento: 38,4 cm

pintado de azul

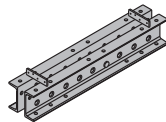
Cinta multi-uso SL-1 WU16 3,00m**107,0 582888000****Montante de guarda corpos 1,00m**

Geländer 1,00m

3,8 584335000**Ligacao para cintras SL-1 WU16 0,75m**

Riegelverbinder SL-1 WU16 0,75m

31,0 582886000galvanizado
comprimento: 124 cmgalvanizado
comprimento: 75 cm**Junta em T para contraforte**

T-Lasche für Abstützbock

29,8 582910000**Roda 90kN**

Schwerlastrad 90kN

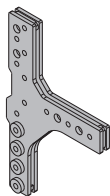
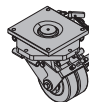
85,0 582921000pintado de azul
comprimento: 74,6 cmgalvanizado
altura: 38 cm**Cavilha de ligação SL-1 D32 100**

Verbindungsbolzen SL-1 D32 100

1,0 582885000**Conector roda F 2,40m**

Radanschluss F 2,40m

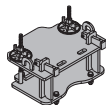
45,0 582922000galvanizado
comprimento: 17 cmgalvanizado
comprimento: 49 cm
largura: 36 cm
altura: 25 cm**Montante de guarda corpos T 1,80m**

Einschubgeländer T 1,80m

17,7 584373000**Consola perfil viajanete F 2,40m**

Verfahrprofil-Konsole F 2,40m

31,0 582924000

galvanizado

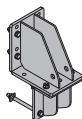
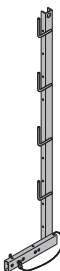
galvanizado
comprimento: 28,5 cm
largura: 22 cm
altura: 48,2 cm

Sistemas de segurança Doka



Plataformas de trabalho e protecção, segurança e acesso encontra no capítulo "Sistemas-Segurança-Doka"