

Painel FF20 2,00x2,75m 21mm	335,0	587512000
Painel FF20 1,00x2,75m 21mm	166,0	587508000
Painel FF20 0,75x2,75m 21mm	131,0	587504000
Painel FF20 0,50x2,75m 21mm	92,0	587500000
Painel FF20 2,00x1,00m 21mm	190,0	587523000
Painel FF20 1,00x1,00m 21mm	95,0	587522000
Painel FF20 0,75x1,00m 21mm	79,5	587521000
Painel FF20 0,50x1,00m 21mm	58,0	587520000
Painel FF20 2,00x3,75m 21mm	440,0	587564000
Painel FF20 1,00x3,75m 21mm	224,0	587562000
Painel FF20 0,75x3,75m 21mm	172,0	587561000
Painel FF20 0,50x3,75m 21mm	120,0	587560000
Painel FF20 2,00x6,50m 21mm	692,0	587563000
Painel FF20 1,00x6,50m 21mm	346,0	587565000
Painel FF20 0,75x6,50m 21mm	272,0	587566000
Painel FF20 0,50x6,50m 21mm	189,5	587567000
Fertigelement FF20 21mm		

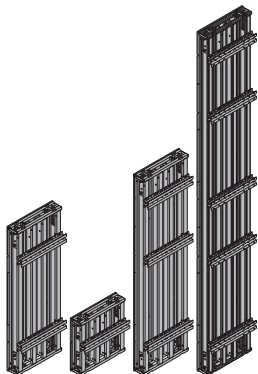

Canto interior FF20 2,75m 21mm	214,0	587516000
Canto interior FF20 1,00m 21mm	117,0	587525000
Innenecke FF20 21mm		

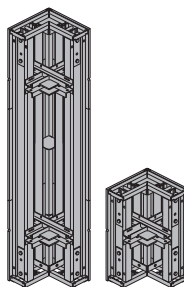

Canto interior FF20 2,75m 27mm	220,0	587608000
Canto interior FF20 1,00m 27mm	120,0	587618000
Canto interior FF20 0,50m 27mm	33,5	587628000
Innenecke FF20 27mm		

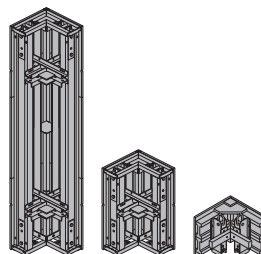

Painel FF20 2,00x2,75m 27mm	348,0	587606000
Painel FF20 1,00x2,75m 27mm	173,0	587604000
Painel FF20 0,75x2,75m 27mm	136,0	587602000
Painel FF20 0,50x2,75m 27mm	96,0	587600000
Painel FF20 2,00x1,00m 27mm	195,0	587616000
Painel FF20 1,00x1,00m 27mm	103,0	587614000
Painel FF20 0,75x1,00m 27mm	81,5	587612000
Painel FF20 0,50x1,00m 27mm	59,5	587610000
Fertigelement FF20 27mm		

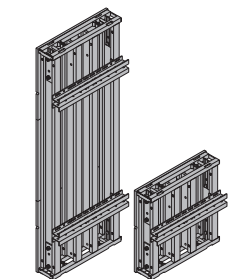

Ângulo interior art. FF20 2,75m 21mm	246,5	587577000
Ângulo interior art. FF20 1,00m 21mm	103,0	587575000
Ângulo interior art. FF20 0,50m 21mm	53,7	587573000
Gelenkinnenecke FF20 21mm		

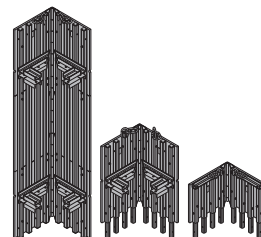

Ângulo interior art. FF20 0,50m 27mm	55,0	587647000
Ângulo interior art. FF20 1,00m 27mm	108,8	587649000
Ângulo interior art. FF20 2,75m 27mm	255,0	587651000
Gelenkinnenecke FF20 27mm		

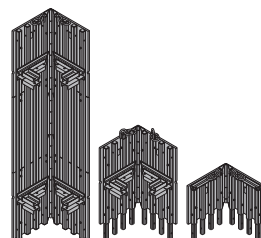

Painel de acrescento FF20 2,00x0,50m 21mm	90,5	587529000
Painel de acrescento FF20 1,00x0,50m 21mm	45,4	587528000
Painel de acrescento FF20 0,75x0,50m 21mm	36,4	587527000
Painel de acrescento FF20 0,50x0,50m 21mm	27,5	587526000
Aufstockelement FF20 21mm		



Painel de acrescento FF20 2,00x0,50m 27mm	67,5	587626000
Painel de acrescento FF20 1,00x0,50m 27mm	33,4	587624000
Painel de acrescento FF20 0,75x0,50m 27mm	28,8	587622000
Painel de acrescento FF20 0,50x0,50m 27mm	21,0	587620000
Aufstockelement FF20 27mm		



Ângulo exterior art. FF20 2,75m 21mm	102,7	587579000
Ângulo exterior art. FF20 1,00m 21mm	46,2	587578000
Gelenkaußencke FF20 21mm		

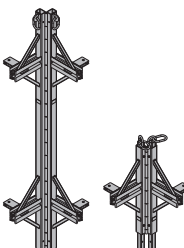

pintado de azul

[kg] Artikel nr.

Ângulo exterior art. FF20 2,75m 27mm 102,7 587654000
Ângulo exterior art. FF20 1,00m 27mm 46,2 587653000
 Gelenkaußenecke FF20 27mm

pintado de azul

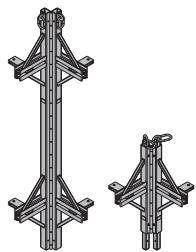

Ângulo exterior art. FF20 0,50m 27mm 16,1 587652000
 Gelenkaußenecke FF20 0,50m

pintado de azul



Esquadro de canto FF20 G 7,2 587571000
 Ecklasche FF20 G

pintado de azul
 comprimento: 49 cm
 largura: 24 cm

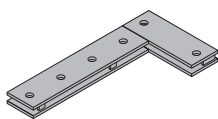

Parafuso FF20 0,30 587545000
 Spannbolzen FF20

galvanizado
 comprimento: 17 cm
 tamanho de chave: 30 mm

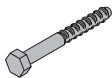

Porca de estrela 15,0 G 0,47 587544000
 Sternmutter 15,0 G

galvanizado
 largura: 10 cm
 altura: 5 cm
 tamanho de chave: 30 mm



Tala de união FF20/50 6,3 587530000
 Elementverbinder FF20/50

pintado de azul
 comprimento: 55 cm

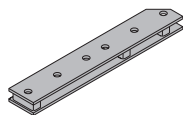

Tala de união FF20/50 Z 6,0 587533000
 Elementverbinder FF20/50 Z

pintado de azul
 comprimento: 55 cm

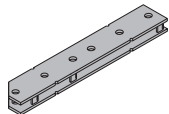

Tala de compensação FF20/50 9,1 587532000
 Ausgleichlasche FF20/50

pintado de azul
 comprimento: 87 cm

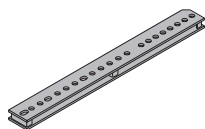

[kg] Artikel nr.

Presilha de viga Top50 1,2 580081000
 Trägerklammer Top50

pintado de azul
 altura: 15 cm

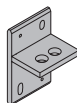

Tala de ancoragem FF20/50 6,6 587531000
 Ankerungslasche FF20/50

pintado de azul
 comprimento: 55 cm

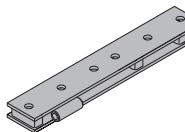

Tala com ajuste de ligação 13,8 580215000
 Verbindungslasche mit Fugenjustierung

pintado de azul
 comprimento: 76 cm

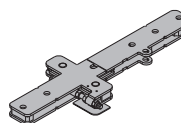

Placa de distribuição FF20 1,7 580216000
 Verteilerplatte FF20

galvanizado
 largura: 10,9 cm
 altura: 12 cm



Tala de sobreposição FF20 6,2 587534000
 Versatzlasche FF20

pintado de azul
 comprimento: 35 cm
 largura: 18 cm
 altura: 4 cm

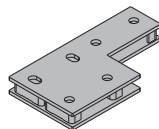

Esquadro de canto exterior FF20 21mm 18,6 587535000
Esquadro de canto exterior FF20 27mm 18,6 587634000
 Außenecklasche FF20

pintado de azul
 comprimento lateral: 60 cm

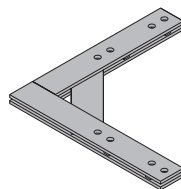

Cachorro orientável de estic. 4,4 580604000
 Universal-Winkelspanner

pintado de azul
 comprimento: 20 cm

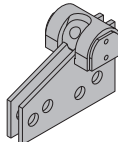

Cavilha de ligação 10cm 0,34 580201000
 Verbindungsbolzen 10cm

galvanizado
 comprimento: 14 cm

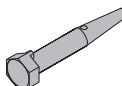

	[kg]	Artikel nr.
Pinça de mola 5mm Federvorstecker 5mm	0,05	580204000
	galvanizado	comprimento: 13 cm

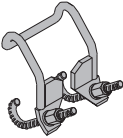
Colchete de falange H20 Flanschklammer H20	1,0	580135000
	galvanizado	largura: 13 cm tamanho de chave: 19 mm

Esquadro para acresento FF20 Aufstockwinkel FF20	7,8	587547000
	pintado de azul	altura: 46 cm

Cinta multi-uso WS10 Top50 0,50m	10,2	580001000
Cinta multi-uso WS10 Top50 0,75m	14,9	580002000
Cinta multi-uso WS10 Top50 1,00m	19,6	580003000
Cinta multi-uso WS10 Top50 1,25m	24,7	580004000
Cinta multi-uso WS10 Top50 1,50m	29,7	580005000
Cinta multi-uso WS10 Top50 1,75m	35,0	580006000
Cinta multi-uso WS10 Top50 2,00m	38,9	580007000
Cinta multi-uso WS10 Top50 2,25m	44,2	580008000
Cinta multi-uso WS10 Top50 2,50m	48,7	580009000
Cinta multi-uso WS10 Top50 2,75m	54,2	580010000
Cinta multi-uso WS10 Top50 3,00m	60,2	580011000
Cinta multi-uso WS10 Top50 3,50m	68,4	580012000
Cinta multi-uso WS10 Top50 4,00m	79,4	580013000
Cinta multi-uso WS10 Top50 4,50m	89,1	580014000
Cinta multi-uso WS10 Top50 5,00m	102,0	580015000
Cinta multi-uso WS10 Top50 5,50m	112,4	580016000
Cinta multi-uso WS10 Top50 6,00m	118,0	580017000

Mehrzweckriegel WS10 Top50	pintado de azul
----------------------------	-----------------

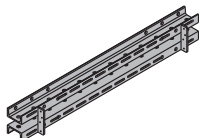

	[kg]	Artikel nr.
Escora de aprumo 340 Elementstütze 340	30,2	588246000
Constituído por:		
(A) Cabeça para escora de aprumo	3,5	588244000
2 unidades		
galvanizado		
comprimento: 40,8 cm		
largura: 11,8 cm		
altura: 17,6 cm		
(B) Base para escora de aprumo	2,1	588245000
galvanizado		
comprimento: 20 cm		
largura: 11 cm		
altura: 10 cm		
(C) Escora de aprumo 340	14,2	588247000
galvanizado		
comprimento: 190 - 341 cm		
(D) Escora ajustável 120	7,2	588248000
galvanizado		
comprimento: 80 - 130 cm		

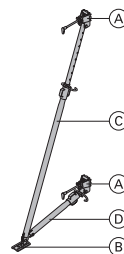

galvanizado
Estado de fornecimento: fechado

Escora de aprumo 540 Elementstütze 540	49,0	588249000
Constituído por:		
(A) Cabeça para escora de aprumo	3,5	588244000
2 unidades		
galvanizado		
comprimento: 40,8 cm		
largura: 11,8 cm		
altura: 17,6 cm		
(B) Base para escora de aprumo	2,1	588245000
galvanizado		
comprimento: 20 cm		
largura: 11 cm		
altura: 10 cm		
(C) Escora de aprumo 540	29,6	588250000
galvanizado		
comprimento: 309 - 550 cm		
(D) Escora ajustável 220	10,2	588251000
comprimento: 171 - 224 cm		

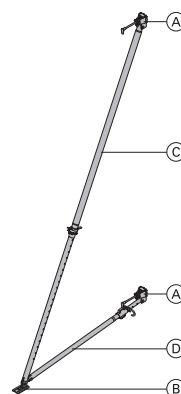

galvanizado
Estado de fornecimento: fechado

Eurex 60 550

Eurex 60 550

Conforme o comprimento necessário, constituído por:

- (A) **Escora de aprumo Eurex 60 550** **42,5 582658000**
revestido com pó, azul
alumínio
comprimento: 343 - 553 cm
- (B) **Extensão Eurex 60 2,00m** **21,3 582651000**
revestido com pó, azul
alumínio
comprimento: 250 cm
- (C) **Espiga de ligação Eurex 60** **8,6 582652000**
alumínio
comprimento: 100 cm
diâmetro: 12,8 cm
- (D) **Conector Eurex 60** **3,9 582657000**
galvanizado
comprimento: 15 cm
largura: 15 cm
altura: 30 cm
- (E) **Base de escora de aprumo Eurex 60** **8,5 582660000**
galvanizado
comprimento: 31 cm
largura: 12 cm
altura: 33 cm
- (F) **Escora ajustável Eurex 60 540** **29,0 582659000**
galvanizado
comprimento: 302 - 543 cm
- (G) **Cabeça para escora de aprumo** **3,5 588244000**
2 unidades
galvanizado
comprimento: 40,8 cm
largura: 11,8 cm
altura: 17,6 cm

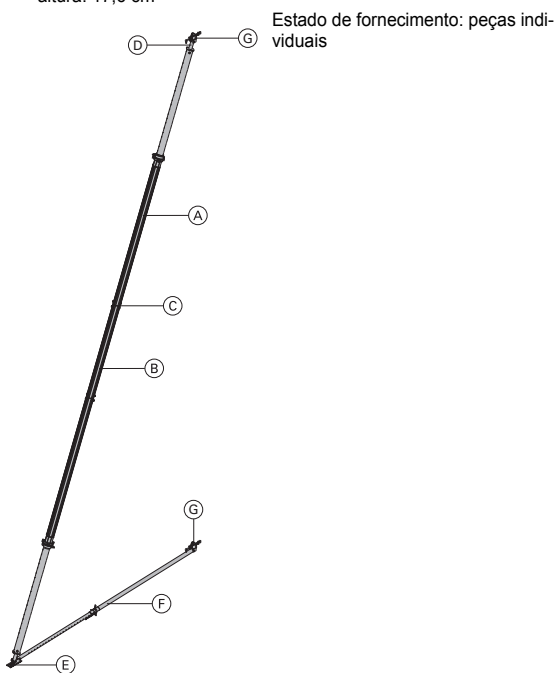
**Ferramenta de desmontagem universal**

Universal-Lösewerkzeug

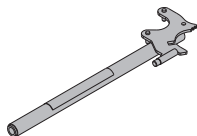
3,7 582768000galvanizado
comprimento: 75,5 cm**Ancoragem express Doka 16x125mm**

Doka-Expressanker 16x125mm

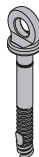
0,31 588631000galvanizado
comprimento: 18 cm
Atenção às instruções de montagem!**Bucha espiral Doka 16mm**

Doka-Coil 16mm

0,009 588633000galvanizado
diâmetro: 1,6 cm**Consola de betonagem L**

Betonierkonsole L

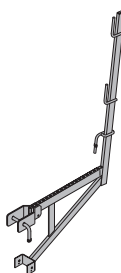
12,6 587153500galvanizado
comprimento: 101 cm
altura: 159 cm**Consola de betonagem L pintada**

Betonierkonsole L lackiert

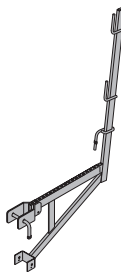
12,0 587153000pintado de azul
comprimento: 101 cm
altura: 159 cm**Consola universal 60**

Universal-Konsole 60

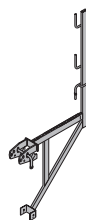
14,0 580477000galvanizado
comprimento: 86 cm
altura: 181 cm**Consola universal 90**

Universal-Konsole 90

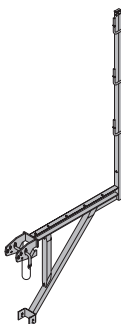
30,4 580476000galvanizado
comprimento: 121 cm
altura: 235 cm

Manilha universal
Universal-Geländerbügel

3,0 580478000

galvanizado
altura: 20 cm

Tubo de andaime 48,3mm 1,00m	3,6	682014000
Tubo de andaime 48,3mm 1,50m	5,4	682015000
Tubo de andaime 48,3mm 2,00m	7,2	682016000
Tubo de andaime 48,3mm 2,50m	9,0	682017000
Tubo de andaime 48,3mm 3,00m	10,8	682018000
Tubo de andaime 48,3mm 3,50m	12,6	682019000
Tubo de andaime 48,3mm 4,00m	14,4	682021000
Tubo de andaime 48,3mm 4,50m	16,2	682022000
Tubo de andaime 48,3mm 5,00m	18,0	682023000
Tubo de andaime 48,3mm 5,50m	19,8	682024000
Tubo de andaime 48,3mm 6,00m	21,6	682025000
Tubo de andaime 48,3mmm	3,6	682001000

Gerüstrohr 48,3mm

galvanizado

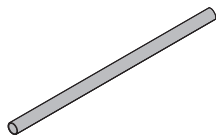
**Ligação para tubo de andaime**

Gerüstrohranschluss

0,27 584375000

galvanizado
altura: 7 cm**Abraçadeira simples 48mm 50**

Anschraubkupplung 48mm 50

0,84 682002000

galvanizado
tamanho de chave: 22 mm**Plat. betonagem Framax U 1,25/2,70m**

Framax-Betonierbühne U 1,25/2,70m

127,5 588377000

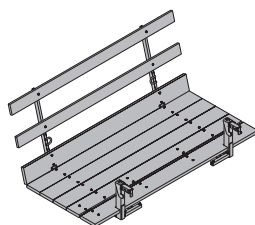
peças de aço galvanizadas
peças de madeira envernizadas a
amarelo
Estado de fornecimento: fechado**Guarda corpos lateral T**

Seitenschutzgeländer T

29,1 580488000

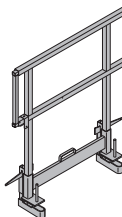
galvanizado
comprimento: 115 - 175 cm
altura: 112 cm**Montante de guarda corpos T 1,80m**

Einschubgeländer T 1,80m

17,7 584373000

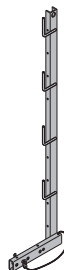

galvanizado

Ligação para tubo de andaime

Gerüstrohranschluss

0,27 584375000

galvanizado
altura: 7 cm**Abraçadeira simples 48mm 50**

Anschraubkupplung 48mm 50

0,84 682002000

galvanizado
tamanho de chave: 22 mm**Plat. betonagem Framax U 1,25/2,70m**

Framax-Betonierbühne U 1,25/2,70m

127,5 588377000

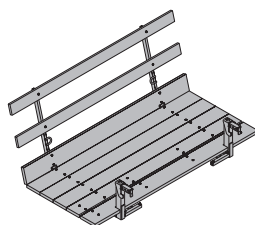
peças de aço galvanizadas
peças de madeira envernizadas a
amarelo
Estado de fornecimento: fechado**Combinação de correntes de susp. Doka 3,20m**

Doka-Vierstrangkette 3,20m

15,0 588620000

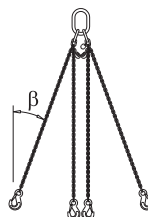

Atenção às instruções de serviço!

CE

Plat. betonagem Framax U 1,25/2,70m

Framax-Betonierbühne U 1,25/2,70m

127,5 588377000

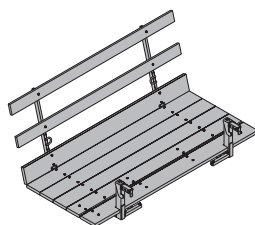
peças de aço galvanizadas
peças de madeira envernizadas a
amarelo
Estado de fornecimento: fechado**Corrente de elevação 100cm 15kN**

Anschlagkette 100cm 15kN

1,8 587548000

comprimento: 103 cm
Atenção às instruções de serviço!

CE

Plat. betonagem Framax U 1,25/2,70m

Framax-Betonierbühne U 1,25/2,70m

127,5 588377000

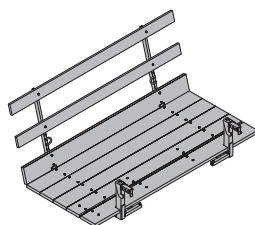
peças de aço galvanizadas
peças de madeira envernizadas a
amarelo
Estado de fornecimento: fechado**Cinta de carga e descarga Dokamatic 13,00m**

Dokamatic-Umsetzgurt 13,00m

10,5 586231000

verde
Atenção às instruções de serviço!

CE

Plat. betonagem Framax U 1,25/2,70m

Framax-Betonierbühne U 1,25/2,70m

127,5 588377000

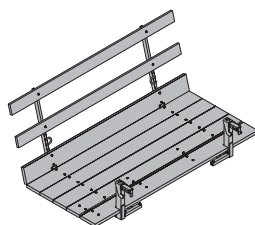
peças de aço galvanizadas
peças de madeira envernizadas a
amarelo
Estado de fornecimento: fechado**Adapt. FF20 para plataf. de beton. Framax U**

FF20-Adapter f. Framax-Betonierbühne U

6,8 588381000

galvanizado
comprimento: 34 cm**Adapt. Top50 para plataf. de beton. Framax U**

Top50-Adapter für Framax-Betonierbühne U

18,5 588384000

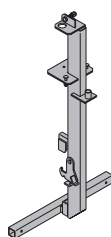
galvanizado
largura: 75 cm
altura: 134 cm**Mecanismo automático Fix-De-Fix 3150kg**

Abhängeautomat Fix-De-Fix 3150kg

27,0 586014000

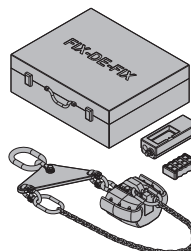

Atenção às instruções de serviço!

CE



Gancho de suspensão

6,2 580460000

Kranöse



galvanizado
altura: 59 cm

Adaptador de altura para cintas multi-uso

10,3 580206000

Höhenjustierung für Mehrzweckriegel

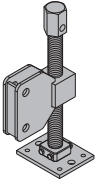

galvanizado
altura: 45 cm

Sistemas de segurança Doka



Plataformas de trabalho e protecção, segurança e acesso encontra no capítulo "Sistemas-Segurança-Doka"