

[kg] Artikel nr.

Cinta multi-uso WS10 Top50 0,50m	10,2	580001000
Cinta multi-uso WS10 Top50 0,75m	14,9	580002000
Cinta multi-uso WS10 Top50 1,00m	19,6	580003000
Cinta multi-uso WS10 Top50 1,25m	24,7	580004000
Cinta multi-uso WS10 Top50 1,50m	29,7	580005000
Cinta multi-uso WS10 Top50 1,75m	35,0	580006000
Cinta multi-uso WS10 Top50 2,00m	38,9	580007000
Cinta multi-uso WS10 Top50 2,25m	44,2	580008000
Cinta multi-uso WS10 Top50 2,50m	48,7	580009000
Cinta multi-uso WS10 Top50 2,75m	54,2	580010000
Cinta multi-uso WS10 Top50 3,00m	60,2	580011000
Cinta multi-uso WS10 Top50 3,50m	68,4	580012000
Cinta multi-uso WS10 Top50 4,00m	79,4	580013000
Cinta multi-uso WS10 Top50 4,50m	89,1	580014000
Cinta multi-uso WS10 Top50 5,00m	102,0	580015000
Cinta multi-uso WS10 Top50 5,50m	112,4	580016000
Cinta multi-uso WS10 Top50 6,00m	118,0	580017000

Mehrzweckriegel WS10 Top50

pintado de azul

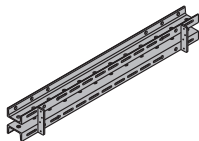

Cinta multi-uso SL-1 WU16 0,625m	24,0	582875000
Cinta multi-uso SL-1 WU16 0,75m	29,0	582876000
Cinta multi-uso SL-1 WU16 1,00m	35,0	582877000
Cinta multi-uso SL-1 WU16 1,25m	44,5	582878000
Cinta multi-uso SL-1 WU16 1,50m	53,0	582879000
Cinta multi-uso SL-1 WU16 1,75m	67,0	582880000
Cinta multi-uso SL-1 WU16 2,00m	72,1	582881000
Cinta multi-uso SL-1 WU16 2,25m	86,0	582882000
Cinta multi-uso SL-1 WU16 2,50m	89,9	582883000
Cinta multi-uso SL-1 WU16 3,00m	107,0	582888000

Mehrzweckriegel SL-1

pintado de azul

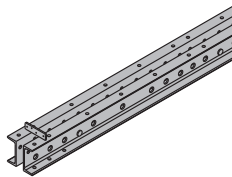
**Cinta de canto 20**

Eckriegel 20

**23,5 580031000**

pintado de azul

comprimento lateral: 52 cm

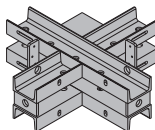

Cinta multi-uso WU12 Top50 1,00m	25,3	580018000
Cinta multi-uso WU12 Top50 1,25m	32,0	580019000
Cinta multi-uso WU12 Top50 1,50m	37,5	580020000
Cinta multi-uso WU12 Top50 1,75m	44,2	580021000
Cinta multi-uso WU12 Top50 2,00m	50,0	580022000
Cinta multi-uso WU12 Top50 2,50m	63,1	580023000
Cinta multi-uso WU12 Top50 3,00m	75,7	580024000
Cinta multi-uso WU12 Top50 3,50m	90,7	580025000
Cinta multi-uso WU12 Top50 4,00m	103,4	580026000

Mehrzweckriegel WU12 Top50

pintado de azul

**Cinta de canto WS10 Top50 .....m**

Eckwandriegel WS10 Top50 .....m

**20,5 580069000**

pintado de azul

Em função do projecto!

As cintas de canto Doka podem ser fornecidas também com o perfil U120 (Designação para encomenda: WU12).

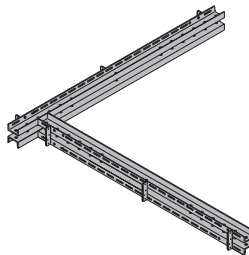

Cinta WS10 Top50 0,50m	10,4	580038000
Cinta WS10 Top50 0,75m	15,4	580039000
Cinta WS10 Top50 1,00m	20,2	580040000
Cinta WS10 Top50 1,25m	25,0	580041000
Cinta WS10 Top50 1,50m	30,3	580042000
Cinta WS10 Top50 1,75m	35,8	580043000
Cinta WS10 Top50 2,00m	40,2	580044000
Cinta WS10 Top50 2,25m	46,1	580045000
Cinta WS10 Top50 2,50m	51,0	580046000
Cinta WS10 Top50 2,75m	56,1	580047000
Cinta WS10 Top50 3,00m	60,4	580048000
Cinta WS10 Top50 3,50m	71,5	580050000
Cinta WS10 Top50 4,00m	82,1	580052000
Cinta WS10 Top50 4,50m	92,2	580054000
Cinta WS10 Top50 5,00m	102,0	580056000
Cinta WS10 Top50 5,50m	112,4	580058000
Cinta WS10 Top50 6,00m	122,2	580060000

Stahlwandriegel WS10 Top50

pintado de azul

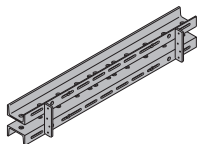
**Cinta angular WS10 Top50 .....m**

Winkelriegel WS10 Top50 .....m

**21,5 580068000**

pintado de azul

Em função do projecto!

As cintas de canto Doka podem ser fornecidas também com o perfil U120 (Designação para encomenda: WU12).

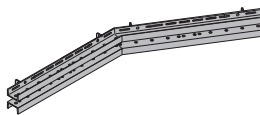
**Colchete de falange H20**

Flanschklammer H20

**1,0 580135000**

galvanizado

largura: 13 cm

tamanho de chave: 19 mm

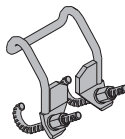

Cinta WU12 Top50 1,00m	25,3	580085000
Cinta WU12 Top50 1,25m	31,6	580086000
Cinta WU12 Top50 1,50m	37,9	580087000
Cinta WU12 Top50 1,75m	44,2	580088000
Cinta WU12 Top50 2,00m	50,5	580089000
Cinta WU12 Top50 2,50m	63,1	580091000
Cinta WU12 Top50 3,00m	75,7	580092000
Cinta WU12 Top50 3,50m	88,4	580093000

Stahlwandriegel WU12 Top50

pintado de azul

**Colchete de falange G**

Flanschklammer G

**1,1 580120000**

galvanizado

largura: 13 cm

tamanho de chave: 19 mm



[kg] Artikel nr.

**Garra de flange**

Flanschkralle

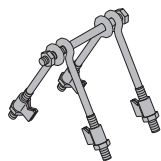
**1,0 580137000**

galvanizado  
largura: 17 cm  
tamanho de chave: 19 mm

**Grampo de flange H20**

Riegelklammer H20

**0,22 580114000**

galvanizado  
largura: 8 cm  
tamanho de chave: 13 mm

**Parafuso de fixação de viga S 8/60**

Riegelverschraubung S 8/60

**0,06 580116000**

galvanizado  
comprimento: 7 cm  
tamanho de chave: 13 mm

**Parafuso de fixação de viga H 8/70**

Riegelverschraubung H 8/70

**0,06 580117000**

galvanizado  
comprimento: 8 cm  
tamanho de chave: 13 mm

**Placa de fixação**

Anschraublascalche

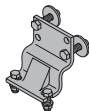
**2,7 580110000**

pintado de azul  
largura: 13 cm  
altura: 15 cm

**Topo de protecção H20**

Stirnschuh H20

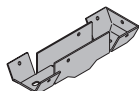
**0,36 587248000**

galvanizado  
comprimento: 20 cm  
largura: 7 cm

**Gancho de suspensão**

Kranöse

**6,2 580460000**

galvanizado  
altura: 59 cm

**Tala de união Top50 Z**

Verbindungsblasche Top50 Z

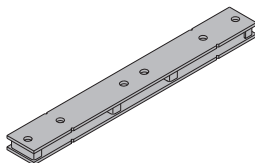
**8,5 580074000**

pintado de azul  
comprimento: 76 cm

**Tala de união FF20/50**

Elementverbinder FF20/50

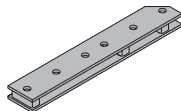
**6,3 587530000**

pintado de azul  
comprimento: 55 cm

**Tala de união FF20/50 Z**

Elementverbinder FF20/50 Z

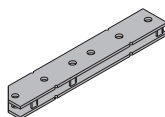
**6,0 587533000**

pintado de azul  
comprimento: 55 cm

**Tala de compensação 1,40m Top50**

Ausgleichsblasche 1,40m Top50

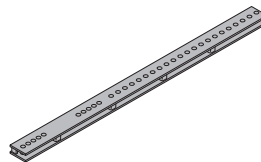
**15,0 580075000**

pintado de azul

**Tala de compensação FF20/50**

Ausgleichsblasche FF20/50

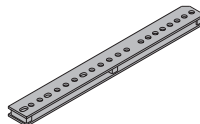
**9,1 587532000**

pintado de azul  
comprimento: 87 cm

**Presilha de viga Top50**

Trägerklammer Top50

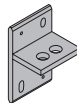
**1,2 580081000**

pintado de azul  
altura: 15 cm

**Tala de ancoragem FF20/50**

Ankerungsblasche FF20/50

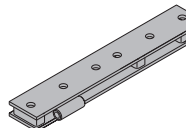
**6,6 587531000**

pintado de azul  
comprimento: 55 cm

**Meia tala de união**

Halblasche

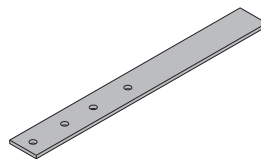
**5,5 580267000**

pintado de azul  
comprimento: 78 cm

**Tala com ajuste de ligação**

Verbindungsblasche mit Fugenjustierung

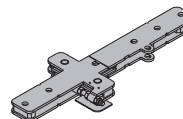
**13,8 580215000**

pintado de azul  
comprimento: 76 cm

**Tala de sobreposição FF20**

Versatzblasche FF20

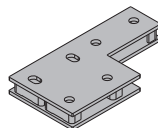
**6,2 587534000**

pintado de azul  
comprimento: 35 cm  
largura: 18 cm  
altura: 4 cm

**Esquadro de canto interior H20 Top50**

Innecksclache H20 Top50

**11,3 580035000**

pintado de azul  
comprimento: 80 cm  
largura: 38 cm

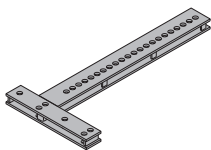
**Cachorro orientável de estic.**

Universal-Winkelspanner

**4,4 580604000**

pintado de azul  
comprimento: 20 cm

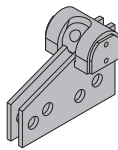
**Esquadro de canto H20/H36 Top50**

Eckclache H20/H36 Top50

**10,0 580078000**

pintado de azul  
comprimento: 49,7 cm  
largura: 45,1 cm

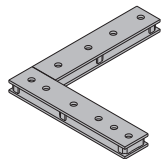
**Cachorro orient. 20,0 SL-1 WU16**

Winkelspanner 20,0 SL-1 WU16

**8,1 587543000**

pintado de azul  
comprimento: 24 cm

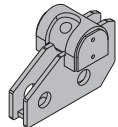
**Esquadro interior de fuste**

Verschieblasche

**9,6 580262000**

pintado de azul  
comprimento lateral: 60 cm

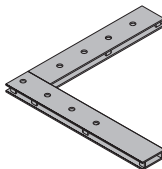
**Gancho de suspensão para cof. pilares**

Kranöse für Stützenschalung

**65,0 580607000**

galvanizado, pintado de azul  
comprimento: 85 cm  
largura: 85 cm

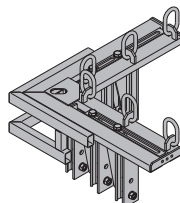
**Tala de transição 18mm**Tala de transição 21mm  
Übergangslasche**16,0 588654000****15,8 588656000**

pintado de azul  
comprimento: 54 cm  
largura: 30 cm  
altura: 51 cm

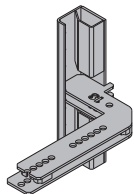
**Tala de união articulada A Top50 ..... graus**

Gelenklasche A Top50 ..... Grad

**20,0 580208000**

galvanizado  
comprimento lateral: 36 cm

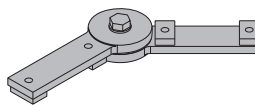
**Tala angular girat.**

Drehgelenklasche

**20,0 587542000**

galvanizado  
comprimento: 155 cm

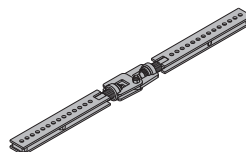
**Ligação para cintras SL-1 WU16 0,75m**

Riegelverbinder SL-1 WU16 0,75m

**31,0 582886000**

galvanizado  
comprimento: 75 cm

**Cavilha de ligação 10cm**

Verbindungsbolzen 10cm

**0,34 580201000**

galvanizado  
comprimento: 14 cm

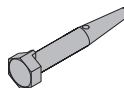
**Reforço de canto**

Eckspindel

**17,5 580264000**

galvanizado  
comprimento: 65 cm  
altura: 31 cm

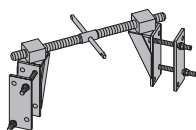
**Cavilha de ligação 25cm**

Verbindungsbolzen 25cm

**0,58 580202000**

galvanizado  
comprimento: 25 cm

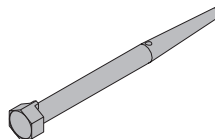
**Esquadro ligação canto 90/50**

Winkellasche 90/50

**13,8 580603000**

pintado de azul  
comprimento: 51 cm  
largura: 40 cm

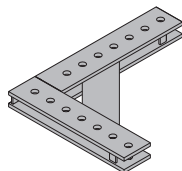
**Pinça de mola 5mm**

Federvorstecker 5mm

**0,05 580204000**

galvanizado  
comprimento: 13 cm



**Placa de empalme H20**

Aufstocklasche H20

**8,3 580310000**galvanizado  
comprimento: 68,8 cm**Compensação de canto 3,00m**

Eckschiene

**53,0 580282000**

Eckschiene

**69,0 580284000**

revestido com pó, azul

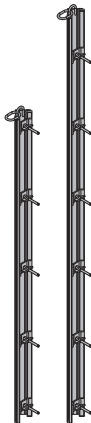
**Junta de compensação 3,00m**

Ausgleichsschiene

**36,8 580332000**

Ausgleichsschiene

**51,2 580334000**

revestido com pó, azul

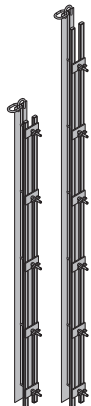
**Quebra juntas T 21/42 2,00m**

T-Leiste 21/42 2,00m

**0,34 580196000**

cinzento

**Escora de aprumo 340**

Elementstütze 340

**30,2 588246000**

Constituído por:

**(A) Cabeça para escora de aprumo****3,5 588244000**2 unidades  
galvanizado  
comprimento: 40,8 cm  
largura: 11,8 cm  
altura: 17,6 cm**(B) Base para escora de aprumo****2,1 588245000**galvanizado  
comprimento: 20 cm  
largura: 11 cm  
altura: 10 cm**(C) Escora de aprumo 340****14,2 588247000**galvanizado  
comprimento: 190 - 341 cm**(D) Escora ajustável 120****7,2 588248000**galvanizado  
comprimento: 80 - 130 cm

galvanizado

Estado de fornecimento: fechado

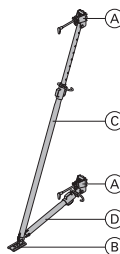
**Escora de aprumo 540**

Elementstütze 540

**49,0 588249000**

Constituído por:

**(A) Cabeça para escora de aprumo****3,5 588244000**2 unidades  
galvanizado  
comprimento: 40,8 cm  
largura: 11,8 cm  
altura: 17,6 cm**(B) Base para escora de aprumo****2,1 588245000**galvanizado  
comprimento: 20 cm  
largura: 11 cm  
altura: 10 cm**(C) Escora de aprumo 540****29,6 588250000**galvanizado  
comprimento: 309 - 550 cm**(D) Escora ajustável 220****10,2 588251000**

comprimento: 171 - 224 cm

galvanizado

Estado de fornecimento: fechado

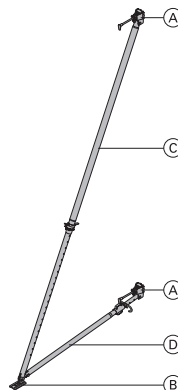

**Eurex 60 550**

Eurex 60 550

Conforme o comprimento necessário, constituído por:

- (A) **Escora de aprumo Eurex 60 550** **42,5 582658000**  
revestido com pó, azul  
alumínio  
comprimento: 343 - 553 cm
- (B) **Extensão Eurex 60 2,00m** **21,3 582651000**  
revestido com pó, azul  
alumínio  
comprimento: 250 cm
- (C) **Espiga de ligação Eurex 60** **8,6 582652000**  
alumínio  
comprimento: 100 cm  
diâmetro: 12,8 cm
- (D) **Conector Eurex 60** **3,9 582657000**  
galvanizado  
comprimento: 15 cm  
largura: 15 cm  
altura: 30 cm
- (E) **Base de escora de aprumo Eurex 60** **8,5 582660000**  
galvanizado  
comprimento: 31 cm  
largura: 12 cm  
altura: 33 cm
- (F) **Escora ajustável Eurex 60 540** **29,0 582659000**  
galvanizado  
comprimento: 302 - 543 cm
- (G) **Cabeça para escora de aprumo** **3,5 588244000**  
2 unidades  
galvanizado  
comprimento: 40,8 cm  
largura: 11,8 cm  
altura: 17,6 cm

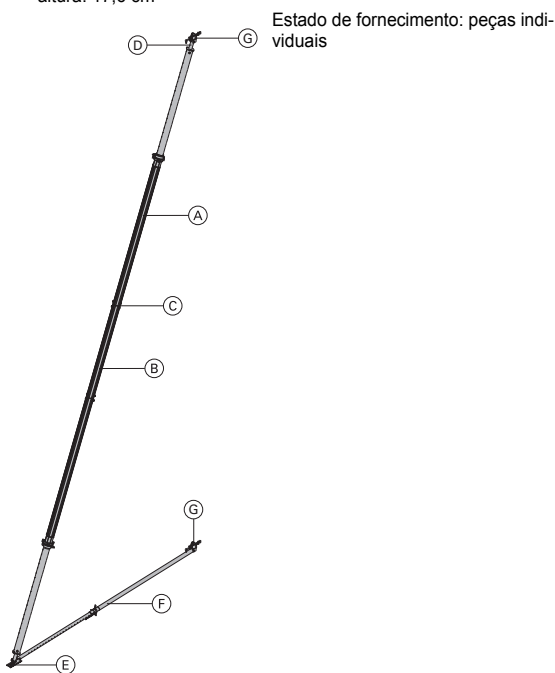
**Cabeça para escora de aprumo Eurex 60 Top50** **7,1 582665000**

Stützenkopf Eurex 60 Top50

galvanizado  
altura: 50 cm**Ferramenta de desmontagem universal** **3,7 582768000**

Universal-Lösewerkzeug

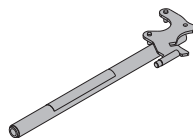
galvanizado  
comprimento: 75,5 cm**Ancoragem express Doka 16x125mm** **0,31 588631000**

Doka-Expressanker 16x125mm

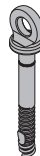
galvanizado  
comprimento: 18 cm  
Atenção às instruções de montagem!**Bucha espiral Doka 16mm** **0,009 588633000**

Doka-Coil 16mm

galvanizado  
diâmetro: 1,6 cm**Consola universal 60** **14,0 580477000**

Universal-Konsole 60

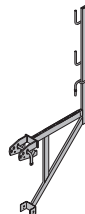
galvanizado  
comprimento: 86 cm  
altura: 181 cm**Consola universal 90** **30,4 580476000**

Universal-Konsole 90

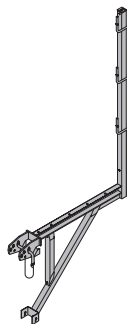
galvanizado  
comprimento: 121 cm  
altura: 235 cm**Consola de betonagem L** **12,6 587153500**

Betonierkonsole L

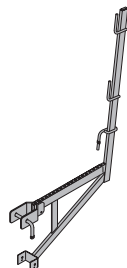
galvanizado  
comprimento: 101 cm  
altura: 159 cm

**Consola de betonagem L pintada**

Betonierkonsole L lackiert

**12,0 587153000**

pintado de azul  
comprimento: 101 cm  
altura: 159 cm

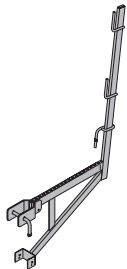
**Adapt. Top50 para plataf. de beton. Framax U**

Top50-Adapter für Framax-Betonierbühne U

**18,5 588384000**

galvanizado  
largura: 75 cm  
altura: 134 cm

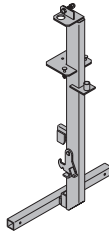
**Manilha universal**

Universal-Geländerbügel

**3,0 580478000**

galvanizado  
altura: 20 cm

**Guarda corpos lateral T**

Seitenschutzgeländer T

**29,1 580488000**

galvanizado  
comprimento: 115 - 175 cm  
altura: 112 cm

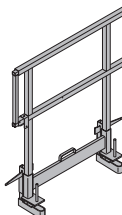
**Ligação para tubo de andaime**

Gerüstrohranschluss

**0,27 584375000**

galvanizado  
altura: 7 cm

**Montante de guarda corpos T 1,80m**

Einschubgeländer T 1,80m

**17,7 584373000**

galvanizado

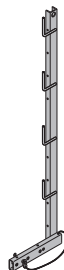
**Tubo de andaime 48,3mm 1,00m****3,6 682014000****Tubo de andaime 48,3mm 1,50m****5,4 682015000****Tubo de andaime 48,3mm 2,00m****7,2 682016000****Tubo de andaime 48,3mm 2,50m****9,0 682017000****Tubo de andaime 48,3mm 3,00m****10,8 682018000****Tubo de andaime 48,3mm 3,50m****12,6 682019000****Tubo de andaime 48,3mm 4,00m****14,4 682021000****Tubo de andaime 48,3mm 4,50m****16,2 682022000****Tubo de andaime 48,3mm 5,00m****18,0 682023000****Tubo de andaime 48,3mm 5,50m****19,8 682024000****Tubo de andaime 48,3mm 6,00m****21,6 682025000****Tubo de andaime 48,3mm .....m****3,6 682001000**

Gerüstrohr 48,3mm

galvanizado

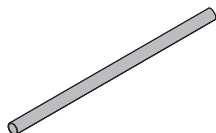
**Montante de guarda corpos 1,50m**

Geländer 1,50m

**12,4 582754000**

galvanizado

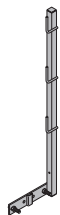
**Abraçadeira simples 48mm 50**

Anschraubkupplung 48mm 50

**0,84 682002000**

galvanizado  
tamanho de chave: 22 mm

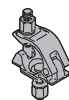
**Combinação de correntes de susp. Doka 3,20m**

Doka-Vierstrangkette 3,20m

**15,0 588620000**

Atenção às instruções de serviço!

**Plat. betonagem Framax U 1,25/2,70m**

Framax-Betonierbühne U 1,25/2,70m

**127,5 588377000**

peças de aço galvanizadas  
peças de madeira envernizadas a amarelo  
Estado de fornecimento: fechado

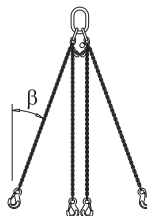
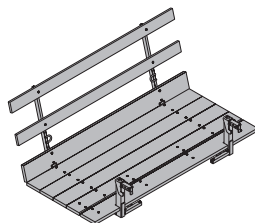

CE

[kg] Artikel nr.

[kg] Artikel nr.

**Mecanismo automático Fix-De-Fix 3150kg**

**27,0 586014000**

Abhängeautomat Fix-De-Fix 3150kg

Atenção às instruções de serviço!

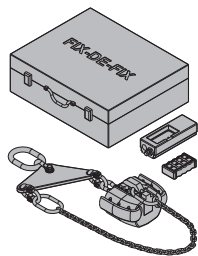

**Escora de eixos roscados T7 75/110cm**

**13,2 584308000**

**Escora de eixos roscados T7 100/150cm**

**16,8 584309000**

**Escora de eixos roscados T7 150/200cm**

**21,6 584324000**

**Escora de eixos roscados T7 200/250cm**

**26,2 584325000**

**Escora de eixos roscados T7 250/300cm**

**29,4 584326000**

**Escora de eixos roscados T7 305/355cm**

**35,0 584327000**

Spindelstrebe T7

galvanizado



**Travamento T5/5 .....mm**

**6,5 584311000**

Strebe T5/5 .....mm

pintado de azul  
peso por m



**Escora de eixos roscados T10 350/400cm**

**57,5 584328000**

**Escora de eixos roscados T10 .....mm**

**16,9 584391000**

Spindelstrebe T10

galvanizado

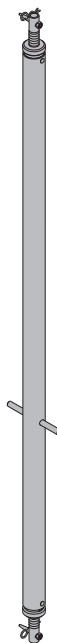
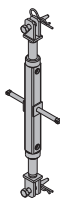

**Escora de eixos roscados T6 73/110cm**

**10,2 584355000**

**Escora de eixos roscados T6 100/150cm**

**12,5 584323000**

Spindelstrebe T6

galvanizado

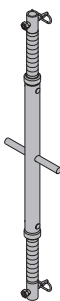

**Escora de eixos roscados GS T6 95/140cm**

**10,3 584340000**

Spindelstrebe GS T6 95/140cm

galvanizado



**Base universal T8**

**8,6 584314000**

Universal-Spindelfuß T8

pintado de azul  
galvanizado  
altura: 30 cm



**Fuso de ajuste Top50**

**11,9 580218000**

Höhenjustierung für Schalungsträger

galvanizado  
altura: 46 cm

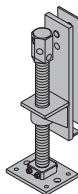

[kg] Artikel nr.

[kg] Artikel nr.

**Adaptador de altura para cintas multi-uso**

Höhenjustierung für Mehrzweckriegel

10,3 580206000

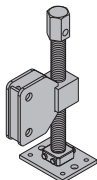
galvanizado  
altura: 45 cm**Acessório de fecho de painel D125 SCC**

Sperrschieber D125 SCC

18,0 588127000

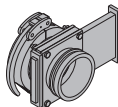
galvanizado  
comprimento: 18 cm  
largura: 33 cm  
altura: 27 cm**Fuso de ajuste M36**

Höhenjustierspindel M36

6,2 500663002

galvanizado  
comprimento: 31 cm  
altura: 29,2 cm**Esquadro de montagem Top50**

Montagelasche Top50

6,7 580082000

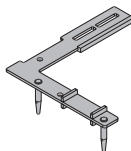
pintado de azul  
comprimento: 55 cm  
largura: 48 cm**Cabeça de suspensão WS10**

Aufhängekopf WS10

8,1 580449000

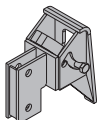
galvanizado  
comprimento: 21 cm  
largura: 18 cm  
altura: 23 cm**Tensor de fita B 5,00m**

Bandzwinge B 5,00m

3,5 580394000

galvanizado

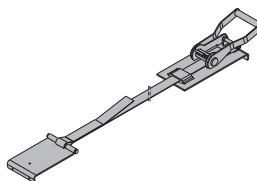
**Travamento universal Top50 .....mm**

Tragwerkklasche Top50 .....mm

11,1 584312000

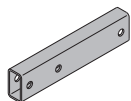
pintado de azul  
peso por m**Perfil bitola .....m**

Führungsschiene .....m

1,8 580079000

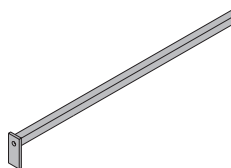
pintado de azul  
peso por m**Caixa de ferramentas GF**

GF-Werkzeugbox

6,5 580390000

Incluído no volume de fornecimento:

**(A) Chave de roquete 1/2"**galvanizado  
comprimento: 30 cm

0,73 580580000

**(B) Chave de bocas 13/17**

0,08 580577000

**(C) Chave de bocas 22/24**

0,22 580587000

**(D) Chave de bocas 30/32**

0,80 580897000

**(E) Chave de orelhas 17/19**

0,27 580590000

**(F) Extensão 11cm 1/2"**

0,20 580581000

**(G) Extensão 22cm 1/2"**

0,31 580582000

**(H) Cardan**

0,16 580583000

**(I) Chave de caixa 19 1/2" L**

0,16 580598000

**(J) Chave de caixa 13 1/2"**

0,06 580576000

**(K) Chave de caixa 24 1/2"**

0,12 580584000

**(L) Chave de caixa 30 1/2"**

0,20 580575000

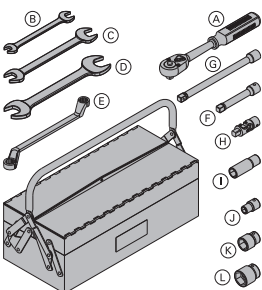
**Bitola de furação Top50**

Bohrplatte Top50

2,9 580080000

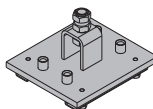
pintado de azul  
comprimento: 17 cm  
largura: 15 cm  
Ferramenta: Broca (diâmetro 10 mm)**Cantoneira de ligação 9x5cm**

Winkelverbinder 9x5cm

0,22 580381000

galvanizado

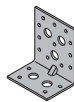
**Esquadro de flanco direito**

Esquadro de flanco esquerdo

0,09 582521000

0,09 582522000

Sparrenpfettenanker

galvanizado  
comprimento: 17 cm**Esquadro H20 para superfície cofrante**

Schalhaut-Schraubwinkel H20

0,19 586256000

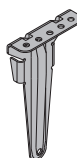
galvanizado  
altura: 19,2 cm**Emboque GF SCC**

GF-Füllstutzen SCC

39,0 580217000

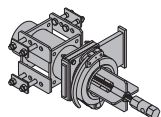
galvanizado  
comprimento: 66 cm



**Raspadeira dupla Xlife 100/150 1,40m**

Doppelschaber Xlife 100/150mm 1,40m

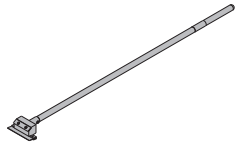
**2,8 588674000****Caixa de acessórios Doka**

Doka-Kleinteilebox

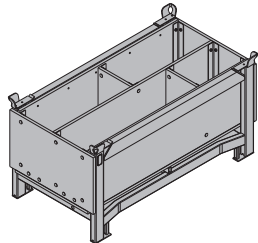
**106,4 583010000**

peças de madeira envernizadas a amarelo

peças de aço galvanizadas

comprimento: 154 cm

largura: 83 cm

altura: 77 cm

Atenção às instruções de serviço!

**Jogo de rodas B**

Anklemm-Radsatz B

**33,6 586168000**

pintado de azul

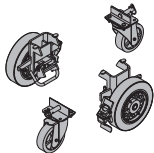
**Sistemas de segurança Doka**

**Plataformas de trabalho e proteção, segurança e acesso encontra no capítulo "Sistemas-Segurança-Doka"**