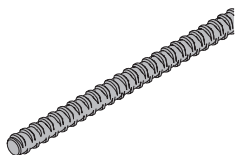

Ankersystem 15,0

Stag 15,0mm galvanisert 0,50m	0,72	581821000
Stag 15,0mm galvanisert 0,75m	1,1	581822000
Stag 15,0mm galvanisert 1,00m	1,4	581823000
Stag 15,0mm galvanisert 1,25m	1,8	581826000
Stag 15,0mm galvanisert 1,50m	2,2	581827000
Stag 15,0mm galvanisert 1,75m	2,5	581828000
Stag 15,0mm galvanisert 2,00m	2,9	581829000
Stag 15,0mm galvanisert 2,50m	3,6	581852000
Stag 15,0mm galvanisertm	1,4	581824000
Stag 15,0mm ubehandlet 0,50m	0,73	581870000
Stag 15,0mm ubehandlet 0,75m	1,1	581871000
Stag 15,0mm ubehandlet 1,00m	1,4	581874000
Stag 15,0mm ubehandlet 1,25m	1,8	581886000
Stag 15,0mm ubehandlet 1,50m	2,1	581876000
Stag 15,0mm ubehandlet 1,75m	2,5	581887000
Stag 15,0mm ubehandlet 2,00m	2,9	581875000
Stag 15,0mm ubehandlet 2,50m	3,6	581877000
Stag 15,0mm ubehandlet 3,00m	4,3	581878000
Stag 15,0mm ubehandlet 3,50m	5,0	581888000
Stag 15,0mm ubehandlet 4,00m	5,7	581879000
Stag 15,0mm ubehandlet 5,00m	7,2	581880000
Stag 15,0mm ubehandlet 6,00m	8,6	581881000
Stag 15,0mm ubehandlet 7,50m	10,7	581882000
Stag 15,0mm ubehandletm	1,4	581873000

Tie rod 15.0mm

DIN
18216
Vingemutter 15,0

Wing nut 15.0

0,31 581961000

Galvanisert
Lengde: 10 cm
Høyde: 5 cm
Nøkkelåpning: 27 mm

DIN
18216
Stagmutter 15,0

Super plate 15.0

1,1 581966000

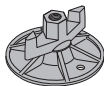
Galvanisert
Høyde: 6 cm
Diameter: 12 cm
Nøkkelåpning: 27 mm

DIN
18216
Sekskantmutter 15,0

Hexagon nut 15.0

0,23 581964000

Galvanisert
Lengde: 5 cm
Nøkkelåpning: 30 mm

DIN
18216
Ankerplate 12/12

Anchor plate 12/12

1,3 581930000

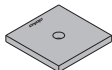

Galvanisert

DIN
18216
Ankerplate 15/20

Anchor plate 15/20

1,8 581929000

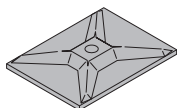

Galvanisert

DIN
18216
Vinkelplate 12/18

Angle anchor plate 12/18

1,5 581934000

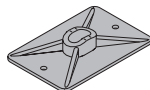

Galvanisert

DIN
18216
Top50 ankermutter 15,0

Top50 form-tie nut 15.0

3,8 580073000

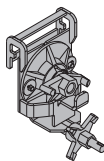
Galvanisert
Høyde: 25 cm
Spikerplate 15,0

Fixing plate 15.0

0,15 581692000

Galvanisert
Diameter: 10 cm
Forløpskonus 15,0 5cm

Positioning cone 15.0 5cm

0,43 581969000

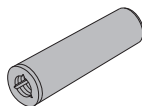
Galvanisert
Lengde: 11 cm
Diameter: 3 cm
Verktøy: Nøkkel for forløpskonus 15,0 DK
Overhold monteringsveiledningen!
Klatrekonus 15,0 5cm

Climbing cone 15.0 5cm

0,97 581980000

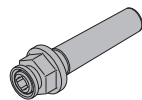
Galvanisert
Lengde: 17 cm
Diameter: 6 cm
Nøkkelåpning: 41 mm
Overhold monteringsveiledningen!
Foringshylse 15,0 5cm

Sealing sleeve 15.0 5cm

0,008 581990000

Oransje
Lengde: 10 cm
Diameter: 3 cm
Hun-bolt 15,0 5cm

She-bolt 15.0 5cm

1,7 581972000

Galvanisert
Lengde: 76 cm
Nøkkelåpning: 24 mm
Overhold monteringsveiledningen!

DIN
18216
Hun-bolt 15,0 5cm 1,20m

She-bolt 15.0 5cm 1.20m

2,5 581832000

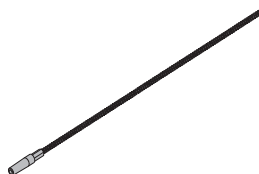
Galvanisert
Lengde: 131 cm
Nøkkelåpning: 24 mm
Overhold monteringsveiledningen!

DIN
18216
Forløpskonus 15,0 5cm

Cantilever positioning cone 15.0 5cm

0,45 581699000

Lengde: 11 cm
Diameter: 5 cm
Verktøy: Nøkkel for forløpskonus 15,0 DK
Overhold monteringsveiledningen!
Foringshylse S 15,0 5cm

Sealing sleeve S 15.0 5cm

0,009 581697000

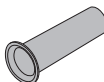
Oransje
Lengde: 11 cm
Diameter: 4,7 cm

[kg] Art. nr.

Forløpskon for matrisevegger 15,0 5cm

Fair-faced concrete positioning cone 15.0 5cm

0,46 581973000



Galvanisert
Lengde: 11 cm
Diameter: 4,3 cm
Verktøy: Nøkkel for forløpskonus
15,0 DK

Opphengskonus 15,0 5cm

Suspension cone 15.0 5cm

0,88 581971000

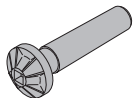

Galvanisert
Lengde: 16 cm
Diameter: 6 cm
Overhold monteringsveiledningen!

Opphengskonus 15,0 for isolasjon opp til 11cm

Suspension cone 15.0 f. insulation up to 11cm

3,6 580495000

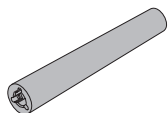

Galvanisert
Lengde: 30 cm
Diameter: 5 cm

Foringshylse 15,0 for isolasjon opp til 11cm

Sealing sleeve 15.0 f. insulation up to 11cm

0,05 580498000

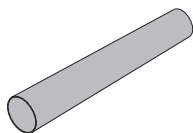

Naturhvit
Lengde: 30 cm
Diameter: 6 cm

Konusskrue RD 28

Cone screw RD 28

0,65 580496000



Galvanisert
Lengde: 9 cm
Diameter: 6 cm

Posisjoneringsplate RD 28

Positioning disk RD 28

0,25 580497000



Galvanisert
Diameter: 9 cm

Universal klatrekonus 15,0

Universal climbing cone 15.0

1,3 581977000

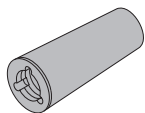

Galvanisert
Lengde: 13 cm
Diameter: 5 cm
Verktøy: Universal konusnøkkel
15,0/20,0

Konusskrue B 7cm

Cone screw B 7cm

0,86 581444000



rød
Lengde: 10 cm
Diameter: 7 cm
Nøkkellåpning: 50 mm

Foringshylse K 15,0

Sealing sleeve K 15.0

0,03 581976000

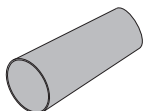

Oransje
Lengde: 12 cm
Diameter: 6 cm

[kg] Art. nr.

Forløpskon for matrisevegger MF 15,0

Fair-faced concrete positioning cone MF 15.0

1,5 581928000

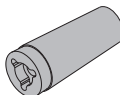

Galvanisert
Lengde: 12,6 cm
Diameter: 5,3 cm
Verktøy: Universal konusnøkkel
15,0/20,0

Posisjoneringsplate M30

Positioning disk M30

0,25 581975000



Galvanisert
Diameter: 9 cm

Forløpsklemme M30

Positioning clamp M30

0,19 581833000



Galvanisert
Diameter: 4 cm

Innskruingskonus 30kN 15,0

Screw-in cone 30kN 15.0

0,74 581895000

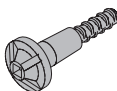

Galvanisert
Lengde: 15 cm

Gesimsanker 30kN 15,0

Bridge edge beam anchor 30kN 15.0

0,45 581896000



Galvanisert
Lengde: 7 cm
Overhold monteringsveiledningen!

Spikerkonus 15,0

Nailing cone 15.0

0,02 581897000



Svart
Lengde: 7 cm

Hull-plugg 29 mm

Hole plug 29mm

0,003 581891000



Grå
Diameter: 3 cm

Zink plugg 15,0

Zinc plug 15.0

0,20 581889000



Galvanisert
Lengde: 9,9 cm
Diameter: 2,9 cm
Verktøy: Firkantnøkkel 1/2"

Stop anker 15,0 11,5cm

Stop anchor 15.0 11.5cm

0,63 581868000



Ubehandlet

Stop anker 15,0 16cm

Stop anchor 15.0 16cm

0,38 581997000



Ubehandlet

	[kg]	Art. nr.
Stop anker 15,0 40cm Stop anchor 15.0 40cm	0,71	581999000
 Ubehandlet		

Stop anker tosidig 15,0 20cm Stop anchor double-ended 15.0 20cm	0,76	581820000
 Ubehandlet		
Spesiallengder kan bestilles på spesialart.nr. 580100000 ved å oppgi betegnelse og ønsket lengde i mm.		

Grisehale anker 15,0 Pigtail anchor 15.0	0,92	581984000
 Ubehandlet		
Lengde: 67 cm		

Vegganker 15,0 15cm Wall anchor 15.0 15cm	1,5	581893000
 Galvanisert		

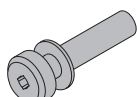
Ophengskonus 15,0 med krave Suspension cone 15.0 with collar	1,4	580428000
 Galvanisert		
Lengde: 16 cm		
Diameter: 6 cm		
Overhold monteringsveiledningen!		

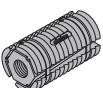
Fjellanker 15,0 Rock anchor spreader unit 15.0	0,41	581120000
 Galvanisert		
Lengde: 9 cm		
Diameter: 4 cm		
Overhold monteringsveiledningen!		

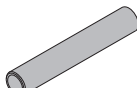
Monteringsrør for fjellanker Rock anchor installation tube	0,85	581123000
 Galvanisert		
Lengde: 50 cm		
Diameter: 3 cm		

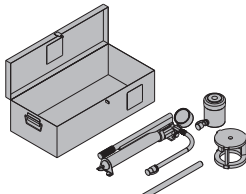
Forspenningsinstrument 300kN Tensioning instrument 300kN	32,0	581815000
 Galvanisert		

Vannspørre 15,0 Water stop connector 15.0	0,52	581914000
 Ubehandlet		
Lengde: 12 cm		

	[kg]	Art. nr.
Vannspørre med stag 15,0 33cm Vannspørre med stag S 15,0 33cm Water stop with tie rod 15.0	1,3	581817000
 Ubehandlet		
Lengde: 33 cm		
Diameter: 7 cm		
Spesiallengder kan bestilles på spesialart.nr. 580100000 ved å oppgi betegnelse og ønsket lengde i mm.		

Vannspørre med stag G 15,0 33cm Water stop G 15.0 33cm	0,68	581818000
 Ubehandlet		
Lengde: 33 cm		
Bredde: 12 cm		
Høyde: 12 cm		
Spesiallengder kan bestilles på spesialart.nr. 580100000 ved å oppgi betegnelse og ønsket lengde i mm.		



Fiberbetong plugg 30,7mm	0,03	581902000
Fiberbetong plugg 32mm	0,02	581830000
Fiberbetong plugg 45mm	0,10	581438000
Fiberbetong plugg 54mm	0,16	581955000
Fibre concrete plug		

 Grå		
---	--	--

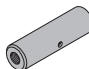

Betongkonus 52mm Concrete cone 52mm	0,19	581939000
---	-------------	------------------

 Grå		
---	--	--

Skjøtemuffe 15,0 Rod connector 15.0	0,49	581981000
 Ubehandlet		
Lengde: 11 cm		
Diameter: 3 cm		
		

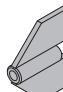
Sveisbar muffe 15,0 Weldable coupler 15.0	0,25	581691000
 Ubehandlet		
Lengde: 8 cm		
Diameter: 3 cm		
Advarsel: Må ikke sveises mens staget er innskrudd – fare for brudd!		
		

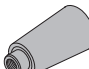
Sveisbar muffe 15,0 for spuntvegg Weldable coupler 15.0 for sheet wall	0,75	581693000
 Ubehandlet		
Lengde: 10 cm		
Høyde: 13 cm		

Klatrekonus 15,0 Anchor cone 15.0	0,46	581967000
 Gul		
Lengde: 11 cm		
Diameter: 6 cm		
		

Plastrør 22mm 2,50m Plastic tube 22mm 2.50m	0,45	581951000
		

[kg] Art. nr.

[kg] Art. nr.

Universal konus 22mm 0,005 581995000

Universal cone 22mm

Grå
Diameter: 4 cm**Plugg 22mm** 0,003 581953000

Plug 22mm



Grå

Avstandsrør med drinkappe og propp 20cm 0,05 581907000**Avstandsrør med drinkappe og propp 25cm** 0,05 581908000**Avstandsrør med drinkappe og propp 30cm** 0,10 581909000

Distancer

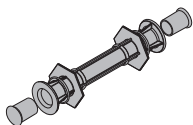

Grå

Fiberbetong rør 22mm 0,18m 0,28 581904000**Fiberbetong rør 22mm 0,23m** 0,36 581905000**Fiberbetong rør 22mm 0,28m** 0,44 581906000**Fiberbetong rør 22mm 0,38m** 0,61 581903000**Fiberbetong rør 22mm 1,25m** 2,3 581991000

Fibre concrete tube 22mm

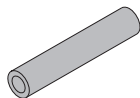
**Fiberbetong plugg 22mm** 0,02 581992000

Fibre concrete plug 22mm

**REPOXAL to-komponent lim** 1,2 581993000

REPOXAL two component adhesive

Overgang til vannspørre 26/22mm 0,01 581853000

Reducer 26/22mm



Svart

Fingerhull-foring 22mm 0,25 580219000

Form-ply protector 22mm

Galvanisert
Nøkkellåpning: 46 mm**Fingerhull-foring 32mm** 0,38 580220000

Form-ply protector 32mm

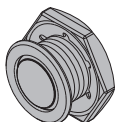

Nøkkellåpning: 70 mm

Ankerholder 15,0 0,43 581835000

Anchor holder 15.0

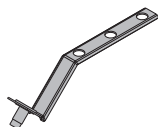

Ubehandlet

Ankerpunktskonus 15,0 0,51 581865000

Clearance cone 15.0

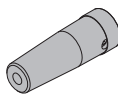
Svart
Blå
Lengde: 20,6 cm
Diameter: 7 cm
Overhold monteringsveiledningen!**Demonteringsverktøy ankerpunktskonus** 0,67 581864000

Clearance-cone dismantling tool

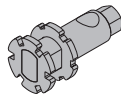
Galvanisert
Lengde: 10,7 cm
Nøkkellåpning: 24 mm**Nøkkel for forløpskonus 15,0 DK** 0,30 580579000

Positioning cone spanner 15.0 DK

Galvanisert
Lengde: 8 cm
Nøkkellåpning: 30 mm**Universal konusnøkkel 15,0/20,0** 0,90 581448000

Universal cone spanner 15.0/20.0

Galvanisert
Lengde: 9 cm
Nøkkellåpning: 50 mm**Stagnøkkel 15,0/20,0** 1,9 580594000

Tie rod wrench 15.0/20.0

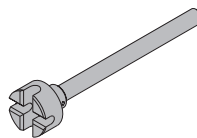
Galvanisert
Lengde: 37 cm
Diameter: 8 cm**Friksjonsskralle SW27** 0,49 581855000

Friction type ratchet SW27

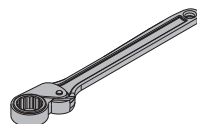
manganfosfatert
Lengde: 30 cm**Pipenøkkel 27 0,65m** 1,9 581854000

Box spanner 27 0.65m

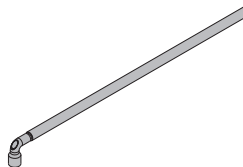

Galvanisert

Støpetrykksmåler 300kN 12,8 581834500

Form-tie load read-off device 300kN

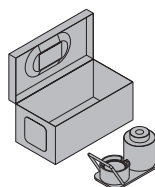

Galvanisert

Ankersystem 20,0

Stag 20,0mm galvanisert 0,50m	1,3	581411000
Stag 20,0mm galvanisert 0,75m	1,9	581417000
Stag 20,0mm galvanisert 1,00m	2,5	581412000
Stag 20,0mm galvanisert 1,25m	3,2	581418000
Stag 20,0mm galvanisert 1,50m	3,8	581413000
Stag 20,0mm galvanisert 2,00m	5,0	581414000
Stag 20,0mm galvanisertm	2,5	581410000
Stag 20,0mm ubehandlet 0,50m	1,3	581405000
Stag 20,0mm ubehandlet 0,75m	1,9	581416000
Stag 20,0mm ubehandlet 1,00m	2,5	581406000
Stag 20,0mm ubehandlet 1,50m	3,8	581407000
Stag 20,0mm ubehandlet 2,00m	5,0	581408000
Stag 20,0mm ubehandletm	2,5	581403000

Tie rod 20.0mm

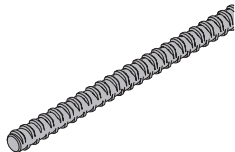

DIN
18216

Vingemutter 20,0

Wing nut 20.0

0,47 581466000

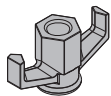

Galvanisert
Lengde: 11 cm
Høyde: 6 cm
Nøkkelåpning: 36 mm

DIN
18216

Sekskantmutter 20,0

Hexagon nut 20.0

0,60 581420000



Galvanisert
Lengde: 7 cm
Nøkkelåpning: 41 mm

DIN
18216

Ankerplate 20,0 12/12

Anchor plate 20.0 12/12

1,7 581425000

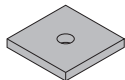

Galvanisert

DIN
18216

Stagmutter 20,0 B

Super plate 20.0 B

2,0 581424000

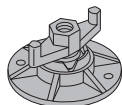

Galvanisert
Høyde: 7 cm
Diameter: 14 cm
Nøkkelåpning: 34 mm

DIN
18216

Framax kombiklemme 20,0

Framax combination nut 20.0

6,1 588683000

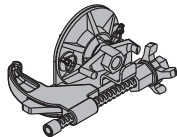

Galvanisert
Bredde: 27 cm

Framax ankermutter 20,0

Framax form-tie nut 20.0

3,6 588687000

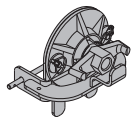

Galvanisert
Bredde: 19 cm

Top100 tec ankermutter 20,0

Top100 tec form-tie nut 20.0

4,8 586934000

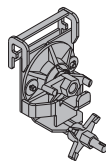

Galvanisert
Høyde: 25 cm

Løsemutter 20,0

Quick-release nut 20.0

5,9 581428000

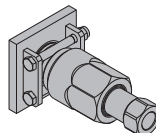

Galvanisert
Lengde: 22 cm
Overhold monteringsveiledningen!

Hun-bolt 20,0

She-bolt 20.0

5,6 581435000



Galvanisert
Lengde: 140 cm
Diameter: 5 cm
Nøkkelåpning: 41 mm

DIN
18216

Forløpskonus 20,0

Anchoring cone 20.0

1,0 581437000

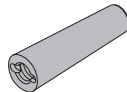

Galvanisert
Lengde: 15 cm
Diameter: 5 cm
Verktøy: Nøkkel for konus 20,0

DIN
18216

Foringshylse 20,0

Sealing sleeve 20.0

0,03 581441000

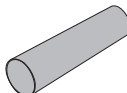

Grå
Lengde: 16 cm
Diameter: 5 cm

Vannspørre 20,0

Water stop connector 20.0

1,3 581467000

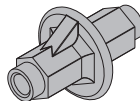

Ubehandlet
Lengde: 14 cm

Vannspørre med stag 20,0 33cm

Water stop 20.0 33cm

1,7 581426000

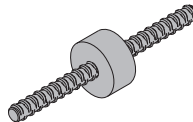

Ubehandlet
Lengde: 33 cm
Diameter: 8 cm
Spesiallengder kan bestilles på spesialart.nr. 580100000 ved å oppgi betegnelse og ønsket lengde i mm.

Universal klatrekonus 20,0

Universal climbing cone 20.0

1,2 581442000

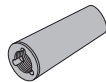

Galvanisert
Lengde: 13 cm
Diameter: 5 cm
Verktøy: Universal konusnøkkel 15,0/20,0

Konusskrue B 7cm

Cone screw B 7cm

0,86 581444000



rød
Lengde: 10 cm
Diameter: 7 cm
Nøkkelåpning: 50 mm

[kg] Art. nr.

[kg] Art. nr.

Foringshylse K 20,0

Sealing sleeve K 20.0

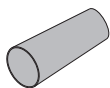
gul-grønn
Lengde: 12 cm
Diameter: 6 cm

0,03 581443000

Stop-anker 20,0 40cm

Stop anchor 20.0 40cm



Ubehandlet

1,2 581458000

Fiberbetong plugg 27mm

Fiberbetong plugg 35mm

Fiberbetong plugg 40mm

Fibre concrete plug



Grå

0,03 581473000

0,11 588923000

0,14 588924000

Sveisbar muffe 20,0

Weldable coupler 20.0

Ubehandlet
Lengde: 8 cm
Diameter: 4 cm
Overhold monteringsveiledningen!

0,55 581474000

Betongkonus 52mm

Concrete cone 52mm



Grå

0,19 581939000

Fjellanker 20,0

Rock anchor spreader unit 20.0

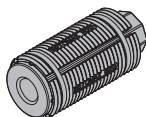
Galvanisert
Lengde: 11,9 cm
Diameter: 5,7 cm
Overhold monteringsveiledningen!

1,3 581468000

Forløpskon for matrisevegger MF 20,0

Fair-faced concrete positioning cone MF 20.0

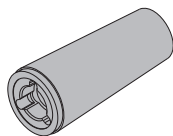
Galvanisert
Lengde: 12,6 cm
Diameter: 5,3 cm
Verktøy: Universal konusnøkkel
15,0/20,0

1,3 581469000

Forspenningsinstrument 300kN

Tensioning instrument 300kN

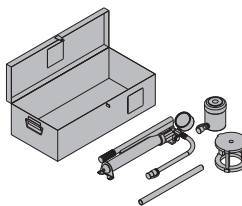

Galvanisert

32,0 581815000

Posisjoneringsplate M30

Positioning disk M30

Galvanisert
Diameter: 9 cm

0,25 581975000

Plastrør 26mm 2,00m

Plastic tube 26mm 2.00m

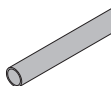

0,59 581463000

Forløpsklemme M30

Positioning clamp M30

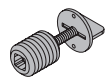
Galvanisert
Diameter: 4 cm

0,19 581833000

Universal konus 26mm

Universal cone 26mm

Grå
Diameter: 5 cm

0,008 581464000

Grisehale anker 20,0

Pigtail anchor 20.0

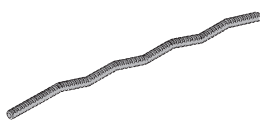
Ubehandlet
Lengde: 76 cm

2,0 581450000

Plugg 26mm

Plug 26mm



Grå

0,006 581465000

Stop-anker 20,0 11,5cm

Stop anchor 20.0 11.5cm



Ubehandlet

0,88 581456000

Fiberbetong rør 27mm 1,25m

Fibre concrete tube 27mm 1.25m

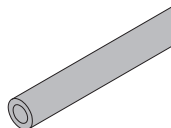

2,6 581472000

Stop-anker 20,0 17,5cm

Stop anchor 20.0 17.5cm

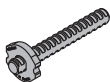

Ubehandlet

0,62 581457000

Konusnøkkel 20,0

Cone spanner 20.0

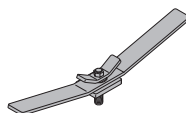
Galvanisert
Lengde: 57 cm

3,5 581471000

[kg] Art. nr.

Stagnøkkel 15,0/20,0

Tie rod wrench 15.0/20.0

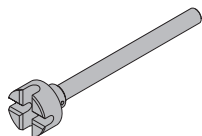
Galvanisert
Lengde: 37 cm
Diameter: 8 cm

1,9 580594000

Sekskantmutter 26,5

Hexagon nut 26.5

Galvanisert
Lengde: 8 cm
Nøkkelåpning: 46 mm

0,73 581985000

DIN
18216**Universal konusnøkkel 15,0/20,0**

Universal cone spanner 15.0/20.0

Galvanisert
Lengde: 9 cm
Nøkkelåpning: 50 mm

0,90 581448000

Ankerplate 26,5

Anchor plate 26.5

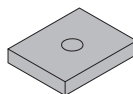
Galvanisert
Lengde: 15 cm
Bredde: 12 cm

3,4 581986000

DIN
18216**Ringnøkkel 70**

Slugging ring spanner 70

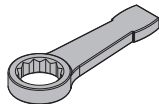

Lengde: 32 cm

2,6 581429000

Universal klatrekonus 26,5

Universal climbing cone 26.5

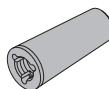
Galvanisert
Lengde: 12,6 cm
Diameter: 5 cm
Verktøy: Universal konusnøkkel
15,0/20,0

1,1 581987000

Ankerholder 20,0

Anchor holder 20.0

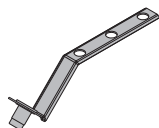

Ubehandlet

0,43 581427000

Konusskrue B 7cm

Cone screw B 7cm

rød
Lengde: 10 cm
Diameter: 7 cm
Nøkkelåpning: 50 mm

0,86 581444000

Ankerpunktikonus 20,0

Clearance cone 20.0

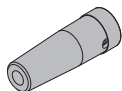
Svart
Gul
Lengde: 20,6 cm
Diameter: 7 cm
Overhold monteringsveiledningen!

0,49 581866000

Foringshylse K 26,5

Sealing sleeve K 26.5

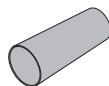
lys blå
Lengde: 12 cm
Diameter: 6 cm

0,02 581998000

Demonteringsverktøy ankerpunktikonus

Clearance-cone dismantling tool

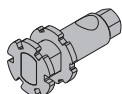
Galvanisert
Lengde: 10,7 cm
Nøkkelåpning: 24 mm

0,67 581864000

Skjøtemuffe 26,5

Rod connector 26.5

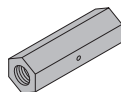
Ubehandlet
Lengde: 15 cm
Nøkkelåpning: 46 mm

1,4 581988000

DIN
18216**Støpetrykksmåler 300kN**

Form-tie load read-off device 300kN

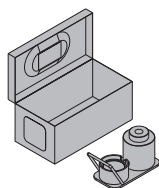

Galvanisert

12,8 581834500

Grisehale anker 26,5

Pigtail anchor 26.5

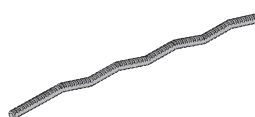
Ubehandlet
Lengde: 80 cm

3,6 581900000

Ankersystem 26,5

Tie rod system 26.5

Plastrør 32mm 2,00m

Plastic tube 32mm 2.00m

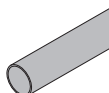

Diameter: 4 cm

0,60 581460000

Stag 26,5mm ubehandletm

Tie rod 26.5mm non-treatedm

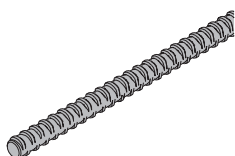
**DIN**
18216

4,5 581883000

Universal konus 32mm

Universal cone 32mm

Grå
Diameter: 5 cm

0,008 581461000

Universal konusnøkkel 15,0/20,0

Universal cone spanner 15.0/20.0

Galvanisert
Lengde: 9 cm
Nøkkelåpning: 50 mm

0,90 581448000

[kg] Art. nr.

Betongkonus 52mm
Concrete cone 52mm

0,19 581939000



Grå

Fastnøkkel firkant 32,0
Square spanner 32.0

5,3 582918000

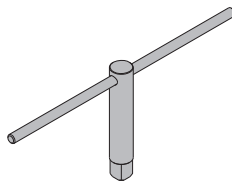
Galvanisert
Lengde: 59 cm**Stagnøkkel 20,0/26,5**
Tie rod wrench 20.0/26.5

1,7 580593000

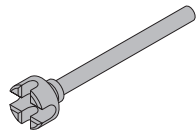
Galvanisert
Lengde: 37 cm
Diameter: 8 cm**Ankerholder 26,5**
Anchor holder 26.5

0,43 581943000

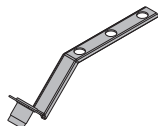

Ubehandlet

Ankerpunktskonus 26,5
Clearance cone 26.5

0,46 581867000

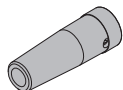
Svart
Grå
Lengde: 20,6 cm
Diameter: 7 cm
Overhold monteringsveiledningen!**Demonteringsverktøy ankerpunktskonus**
Clearance-cone dismantling tool

0,67 581864000

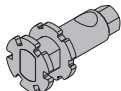
Galvanisert
Lengde: 10,7 cm
Nøkkelåpning: 24 mm**Ankersystem 32,0****Stag 32,0mm ubehandletm**
Tie rod 32.0mm non-treatedm

6,5 582914000

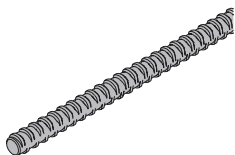
**Sekskantmutter 32,0**
Hexagon nut 32.0

1,8 582915000

Ubehandlet
Lengde: 9 cm
Nøkkelåpning: 55 mm**Ankerplate 32,0**
Anchor plate 32.0

4,1 582916000

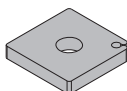
Ubehandlet
Lengde: 15 cm
Bredde: 15 cm**Forløpskonus 32,0**
Anchoring cone 32.0

7,7 582917000

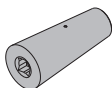
Galvanisert
Lengde: 22,5 cm
Diameter: 10 cm