

[kg] Art. nr.

[kg] Art. nr.

Støtte SL-1 2,50m	86,5 582812000
Støtte SL-1 1,25m	60,5 582813000
Støtte SL-1 0,625m	40,0 582814000
Støtte SL-1 0,312m	27,0 582815000
Støtte SL-1 0,156m	16,0 582817000
Strut SL-1	

Galvanisert
Bredde: 37 cm

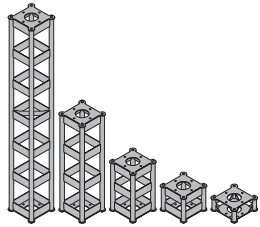

Støttespindel SL-1	81,0 582816000
Prop spindle SL-1	

Galvanisert
Lengde: 37 cm
Bredde: 37 cm
Høyde: 44,5-66,5 cm

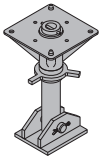

Boltesats M16x40 8.8	0,56 582831000
Screw-set M16x40 8.8	

Galvanisert
Nøkkellåpning: 24 mm



Senkespindel SL-1	83,0 582950000
Lowering spindle strut SL-1	

Galvanisert

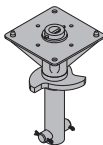

Bunnplate SL-1	22,2 582951000
Fastening shoe strut SL-1	

Galvanisert

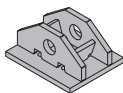

Boltesats M20x70 8.8	1,0 582952000
Screw-set M20x70 8.8	

Galvanisert
Nøkkellåpning: 30 mm

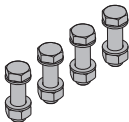

Bunnplate SL-1	31,5 582808000
Basic plate SL-1	

Galvanisert
Lengde: 37 cm
Bredde: 37 cm

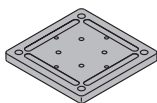

Boltesats for bunnplate SL-1	1,2 582852000
Basic plate screw-set SL-1	

Galvanisert

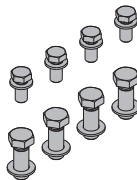

Bjelkeklemme SL-1	1,7 582824000
Beam clamp SL-1	

Galvanisert
Høyde: 17 cm
Nøkkellåpning: 24 mm



Systembjelke SL-1 5,00m	598,0 582800000
Systembjelke SL-1 4,00m	496,7 582801000
Systembjelke SL-1 3,00m	371,0 582802000
Systembjelke SL-1 1,00m	148,0 582803000
Systembjelke SL-1 0,75m	98,5 582804000
System beam SL-1	

Blålakkert

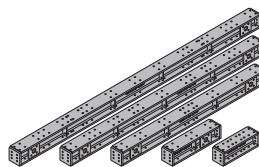

Shims for kjededrev SL-1 330mm	53,0 582863000
Travelling gear distancer SL-1 330mm	

Galvanisert
Lengde: 33 cm
Bredde: 22 cm
Høyde: 24 cm

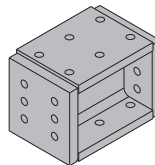

Boltesats for systembjelke SL-1	1,4 582829000
Screw-set M20x90 8.8 shank length 38mm	

Galvanisert
Nøkkellåpning: 30 mm

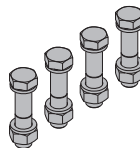

Senkekile SL-1 420kN	30,0 582821000
Lowering wedge SL-1 420kN	

Blålakkert
Høyde: 16,8 - 26,8 cm

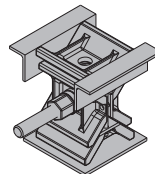

Svertebolt SL1	15,6 582807000
Bracing bolt SL-1	

Galvanisert
Lengde: 52 cm
Diameter: 7 cm

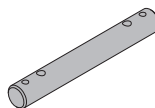

[kg] Art. nr.

[kg] Art. nr.

Distanse SL-1 1,9 582809000

Distance piece SL-1

Galvanisert
Lengde: 16 cm
Bredde: 9,2 cm
Høyde: 8,2 cm**Spennmutter SL-1 15,0** 0,70 582835000

Split nut SL-1 15.0

Galvanisert
Lengde: 9-11 cm
Nøkkelåpning: 30/41 mm**Sekskantmutter 15,0** 0,23 581964000

Hexagon nut 15.0

Galvanisert
Lengde: 5 cm
Nøkkelåpning: 30 mm**DIN**
18216**Innspenningbøyle SL-1** 6,4 582862000

Brace stirrup SL-1

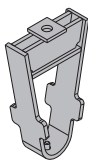
Galvanisert
Høyde: 33,4 cm**Rørkobling med bolt 48mm 50** 0,84 682002000

Screw-on coupler 48mm 50

Galvanisert
Nøkkelåpning: 22 mm
Overhold monteringsveiledningen!**Dreiekobling 48mm** 1,5 582560000

Swivel coupler 48mm

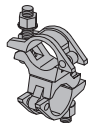
Galvanisert
Nøkkelåpning: 22 mm
Overhold monteringsveiledningen!**Rørkobling 48mm** 1,2 682004000

Normal coupler 48mm

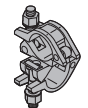
Galvanisert
Nøkkelåpning: 22 mm
Overhold monteringsveiledningen!**Stillasrør 48,3mm 0,50m** 1,7 682026000

Stillasrør 48,3mm 1,00m

Stillasrør 48,3mm 1,50m

Stillasrør 48,3mm 2,00m

Stillasrør 48,3mm 2,50m

Stillasrør 48,3mm 3,00m

Stillasrør 48,3mm 3,50m

Stillasrør 48,3mm 4,00m

Stillasrør 48,3mm 4,50m

Stillasrør 48,3mm 5,00m

Stillasrør 48,3mm 5,50m

Stillasrør 48,3mm 6,00m

Stillasrør 48,3mmm

Scaffold tube 48.3mm

Galvanisert
1,7 682026000
3,6 682014000
5,4 682015000
7,2 682016000
9,0 682017000
10,8 682018000
12,6 682019000
14,4 682021000
16,2 682022000
18,0 682023000
19,8 682024000
21,6 682025000
3,6 682001000

Galvanisert

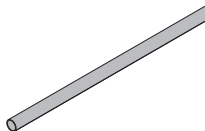

Multifunksjonsbjelke WS10 Top50 0,50m 10,2 580001000

Multifunksjonsbjelke WS10 Top50 0,75m 14,9 580002000

Multifunksjonsbjelke WS10 Top50 1,00m 19,6 580003000

Multifunksjonsbjelke WS10 Top50 1,25m 24,7 580004000

Multifunksjonsbjelke WS10 Top50 1,50m 29,7 580005000

Multifunksjonsbjelke WS10 Top50 1,75m 35,0 580006000

Multifunksjonsbjelke WS10 Top50 2,00m 38,9 580007000

Multifunksjonsbjelke WS10 Top50 2,25m 44,2 580008000

Multifunksjonsbjelke WS10 Top50 2,50m 48,7 580009000

Multifunksjonsbjelke WS10 Top50 2,75m 54,2 580010000

Multifunksjonsbjelke WS10 Top50 3,00m 60,2 580011000

Multifunksjonsbjelke WS10 Top50 3,50m 68,4 580012000

Multifunksjonsbjelke WS10 Top50 4,00m 79,4 580013000

Multifunksjonsbjelke WS10 Top50 4,50m 89,1 580014000

Multifunksjonsbjelke WS10 Top50 5,00m 102,0 580015000

Multifunksjonsbjelke WS10 Top50 5,50m 112,4 580016000

Multifunksjonsbjelke WS10 Top50 6,00m 118,0 580017000

Multi-purpose waling WS10 Top50

Blålakkert

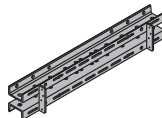
**Elementlask FF20/50** 6,3 587530000

Formwork element connector FF20/50

Blålakkert

Lengde: 55 cm

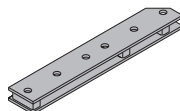
**Koblingsbolt 10cm** 0,34 580201000

Connecting pin 10cm

Galvanisert

Lengde: 14 cm

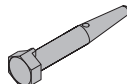
**Fjærsplint 5mm** 0,05 580204000

Spring cotter 5mm

Galvanisert

Lengde: 13 cm

**Stagkonnektor SL-1** 8,2 582806000

Strut connection SL-1

Galvanisert

Lengde: 30 cm

Bredde: 20 cm

Høyde: 10 cm

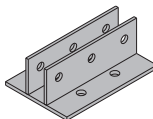
**Boltesats M20x65 8.8** 1,2 582851000

Screw-set M20x65 8.8

Galvanisert

Nøkkelåpning: 30 mm

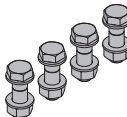

[kg] Art. nr.

[kg] Art. nr.

Spindelstøtte T6 73/110cm	10,2	584355000
Spindelstøtte T6 100/150cm	12,5	584323000

Spindle strut T6

Galvanisert

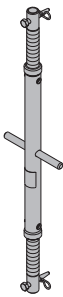

Formstøtte 340 IB	24,3	580365000
--------------------------	-------------	------------------

Panel strut 340 IB

Består av:

(A) Justerstøtte 340 IB	16,7	588696000
--------------------------------	-------------	------------------

Galvanisert

Lengde: 190,8 - 341,8 cm

(B) Justerbein 120 IB	7,6	588248500
------------------------------	------------	------------------

Galvanisert

Lengde: 81,5 - 130,6 cm

Galvanisert

Leveres: sammenslått

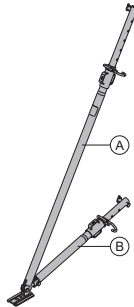

Spindelstøtte T7 75/110cm	13,2	584308000
Spindelstøtte T7 100/150cm	16,8	584309000
Spindelstøtte T7 150/200cm	21,6	584324000
Spindelstøtte T7 200/250cm	26,2	584325000
Spindelstøtte T7 250/300cm	29,4	584326000
Spindelstøtte T7 305/355cm	35,0	584327000

Spindle strut T7

Galvanisert

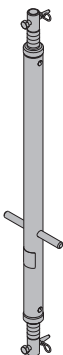

Formstøtte 540 IB	41,4	580366000
--------------------------	-------------	------------------

Panel strut 540 IB

Består av:

(A) Justerstøtte 540 IB	30,7	588697000
--------------------------------	-------------	------------------

Galvanisert

Lengde: 310,5 - 549,2 cm

(B) Justerbein 220 IB	10,9	588251500
------------------------------	-------------	------------------

Galvanisert

Lengde: 172,5 - 221,1 cm

Galvanisert

Leveres: sammenslått

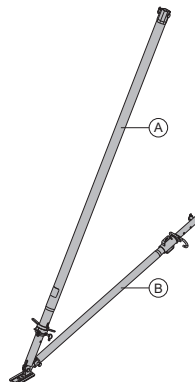

Koblingsadapter SL-1	4,3	582810000
-----------------------------	------------	------------------

Connection adapter SL-1

Galvanisert

Lengde: 35 cm

Nøkkellåpning: 22 mm

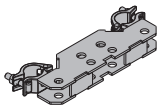

Frami konsoll 60	7,7	588442000
-------------------------	------------	------------------

Frami bracket 60

Galvanisert

Lengde: 98 cm

Høyde: 157 cm

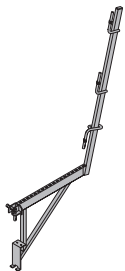

Formstøtte hode EB	3,1	588244500
---------------------------	------------	------------------

Prop head EB

Galvanisert

Lengde: 40,8 cm

Bredde: 11,8 cm

Høyde: 17,6 cm

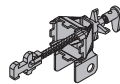

Rullestillas Z

Mobile scaffold tower Z

Består av:

(A) Stillasramme Z 1,00m	6,7	586016000
(B) Stillasramme Z 2,00m	11,3	586017000
(C) Rekkverkramme Z 1,00m	4,1	586021000
(D) Rekkverk Z 1,80m	6,5	586022000
(E) Plattform Z med mannehull 1,80m	17,5	586023000
(F) Plattform Z uten mannehull 1,80m	17,0	586024000
(G) Sparkebord Z 1,35m	4,0	586025000
(H) Sparkebord Z 1,80m	5,1	586026000
(I) Diagonal stag Z 2,00m	3,0	586027000
(J) Horizontal stag Z 1,80m	2,8	586028000
(K) Trekantbrakett Z (uten avbildning)	5,3	586029000
(L) Transporthjul Z D200mm	7,1	586030000
(M) Innstegsbøyle Z	0,97	586031000
(N) Plattformdiagonal Z (uten avbildning)	2,5	586032000
(O) Ballast Z (uten avbildning)	10,0	586033000

Alu

Følg monterings- og bruksveiledningen.

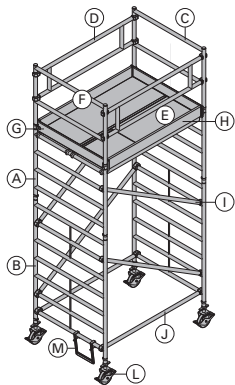
**Verktøykasse SL-1**

Tool box SL-1

Inngår som del av leveransen:

(A) Fastnøkkel 19 2 stk.	0,14	582837000
(B) Fastnøkkel 22 2 stk.	0,20	582838000
(C) Fastnøkkel 24 2 stk.	0,25	582839000
(D) Fastnøkkel 30 2 stk.	0,43	582840000
(E) Fastnøkkel 32	0,75	582859000
(F) Fastnøkkel 36	0,75	582860000
(G) Fastnøkkel 41	1,5	582841000
(H) Skralle-fastnøkkel 30/32	1,3	582843000
(I) Koppnøkkel 19 1/2" L	0,16	580598000
(J) Koppnøkkel 22 3/4" L	0,22	582844000
(K) Koppnøkkel 24 3/4" L	0,25	582845000
(L) Koppnøkkel 30 3/4" L	0,52	582846000
(M) Forlenger 20cm 3/4"	0,68	580683000
(N) Skralle 3/4" Galvanisert Lengde: 50 cm	1,9	580594000
(O) Stagnøkkel 15,0/20,0 Galvanisert Lengde: 37 cm Diameter: 8 cm		
(P) Overgang A 1/2"x 3/4"	0,18	580684000
(Q) Vinkeldor SL-1	1,4	582867000
(R) Fastnøkkel 46	0,87	582869000
(S) Ringnøkkel 46	0,96	582868000

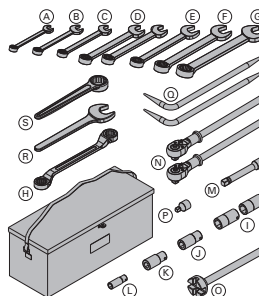
**Doka sikkerhetssele**

Doka personal fall-arrest set

3,6 583022000

Observer bruksveiledningen!



CE