

	[kg]	Art. nr.
Doka dekkestøtte Eurex 20 top 150 Lengde: 92 - 150 cm	8,0	586096000
Doka dekkestøtte Eurex 20 top 250 Lengde: 148 - 250 cm	12,7	586086400
Doka dekkestøtte Eurex 20 top 300 Lengde: 173 - 300 cm	14,3	586087400
Doka dekkestøtte Eurex 20 top 350 Lengde: 198 - 350 cm	17,4	586088400
Doka dekkestøtte Eurex 20 top 400 Lengde: 223 - 400 cm	21,6	586089400
Doka dekkestøtte Eurex 20 top 550 Lengde: 298 - 550 cm	32,3	586090400

Doka floor prop Eurex 20 top

Galvanisert

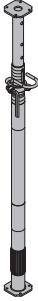

Doka dekkestøtte Eurex 30 top 250 Lengde: 148 - 250 cm	12,8	586092400
Doka dekkestøtte Eurex 30 top 300 Lengde: 173 - 300 cm	16,4	586093400
Doka dekkestøtte Eurex 30 top 350 Lengde: 198 - 350 cm	20,7	586094400
Doka dekkestøtte Eurex 30 top 400 Lengde: 223 - 400 cm	24,6	586095400
Doka dekkestøtte Eurex 30 top 450 Lengde: 248 - 450 cm	29,1	586119400
Doka dekkestøtte Eurex 30 top 550 Lengde: 303 - 550 cm	38,6	586129000

Doka floor prop Eurex 30 top

Galvanisert

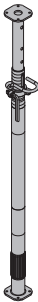

Doka dekkestøtte Eco 20 250 Lengde: 152 - 250 cm	11,7	586134000
Doka dekkestøtte Eco 20 300 Lengde: 172 - 300 cm	13,0	586135000
Doka dekkestøtte Eco 20 350 Lengde: 197 - 350 cm	15,3	586136000
Doka dekkestøtte Eco 20 400 Lengde: 227 - 400 cm	19,1	586137000

Doka floor prop Eco 20

Galvanisert

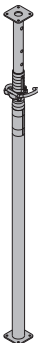

	[kg]	Art. nr.
Foldebein top Removable folding tripod top	12,0	586155500



Galvanisert
Høyde: 80 cm
Leveres: sammenslått

Foldebein 1,20m Removable folding tripod 1.20m	20,7	586145000
--	------	-----------



Galvanisert
Høyde: 120 cm
Leveres: sammenslått

Drophead gaffel H20 Lowering head H20	6,1	586174000
---	-----	-----------

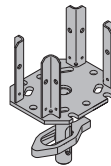

Galvanisert
Lengde: 25 cm
Bredde: 20 cm
Høyde: 38 cm

Toppgaffel H20 4-way head H20	4,0	586170000
---	-----	-----------

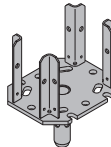

Galvanisert
Lengde: 25 cm
Bredde: 20 cm
Høyde: 33 cm

Fjærbolt 16mm Spring locked connecting pin 16mm	0,25	582528000
---	------	-----------



Galvanisert
Lengde: 15 cm

Hjelpegaffel H20 DF Supporting head H20 DF	0,77	586179000
--	------	-----------



Galvanisert
Lengde: 19 cm
Bredde: 11 cm
Høyde: 8 cm

U-hode 12,5cm U-head 12.5cm	1,2	586171000
---------------------------------------	-----	-----------

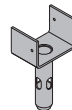

Galvanisert
Høyde: 23 cm

Avsvertingsklammer B Bracing clamp B	1,4	586195000
--	-----	-----------

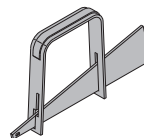

Blålakkert
Lengde: 36 cm

[kg] Art. nr.

Strøbjelkestøtte 1
Strøbjelkestøtte 2
 Secondary-beam stabiliser

1,6 586196000
2,1 586197000

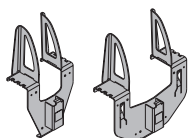
 Galvanisert
 Høyde: 38,7 cm

Universal endestengsvinkel 30cm

Universal end-shutter support 30cm

1,0 586232000

 Galvanisert
 Høyde: 21 cm

Bjelketvinge 20

Beam forming support 20

6,9 586148000

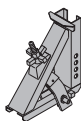
 Galvanisert
 Lengde: 30 cm
 Høyde: 35 cm

Forlenger for bjelketvinge 60cm

Extension for beam forming support 60cm

4,4 586149000

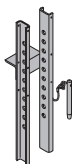
Galvanisert

Doka endestengsklemme

Doka floor end-shutter clamp

12,5 586239000

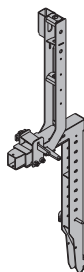
 Galvanisert
 Høyde: 137 cm

Sko for endesteng

End-shutter shoe

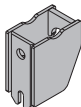
1,6 586257000

 Galvanisert
 Høyde: 13,5 cm

Spennstag for endesteng 15,0 15-40cm

End-shutter tie rod 15.0 15-40cm

0,91 586258000

 Galvanisert
 Lengde: 55 cm

Universal staghullsplugg R20/25

Universal plug R20/25

0,003 588180000

 Blå
 Diameter: 3 cm

Plugg for krymplinjal R25

Plug for closure plate R25

0,003 588187000

 Svart
 Diameter: 3 cm

Arbeidskrakk 0,97m

Platform stairway 0.97m

23,5 586555000

 Alu
 Bredde: 121 cm
 Nationale, sicherheitstechnische
 Vorschriften beachten!

Rullestillas DF

Wheel-around scaffold DF

44,0 586157000

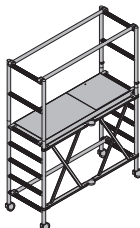
 Alu
 Lengde: 185 cm
 Bredde: 80 cm
 Høyde: 255 cm
 Leveres: sammenslått

Forlenger for bjelketvinge 60cm

Extension for beam forming support 60cm

4,4 586149000

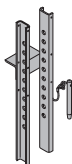
Galvanisert

Doka endestengsklemme

Doka floor end-shutter clamp

12,5 586239000

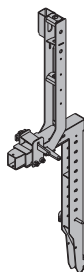
 Galvanisert
 Høyde: 137 cm

Sko for endesteng

End-shutter shoe

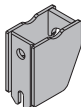
1,6 586257000

 Galvanisert
 Høyde: 13,5 cm

Spennstag for endesteng 15,0 15-40cm

End-shutter tie rod 15.0 15-40cm

0,91 586258000

 Galvanisert
 Lengde: 55 cm

Universal staghullsplugg R20/25

Universal plug R20/25

0,003 588180000

 Blå
 Diameter: 3 cm

Rullestillas Z

Mobile scaffold tower Z

Består av:

- (A) Stillasramme Z 1,00m **6,7 586016000**
- (B) Stillasramme Z 2,00m **11,3 586017000**
- (C) Rekkverkramme Z 1,00m **4,1 586021000**
- (D) Rekkverk Z 1,80m **6,5 586022000**
- (E) Plattform Z med mannehull 1,80m **17,5 586023000**
- (F) Plattform Z uten mannehull 1,80m **17,0 586024000**
- (G) Sparkebord Z 1,35m **4,0 586025000**
- (H) Sparkebord Z 1,80m **5,1 586026000**
- (I) Diagonal stag Z 2,00m **3,0 586027000**
- (J) Horisontal stag Z 1,80m **2,8 586028000**
- (K) Trekantbrakett Z **5,3 586029000**
(uten avbildning)
- (L) Transporthjul Z D200mm **7,1 586030000**
- (M) Innstegsbøyle Z **0,97 586031000**
- (N) Plattformdiagonal Z **2,5 586032000**
(uten avbildning)
- (O) Ballast Z **10,0 586033000**
(uten avbildning)

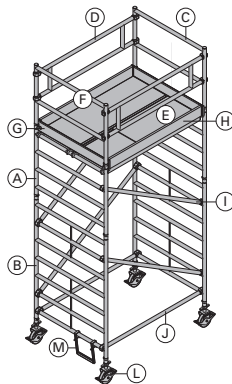
 Alu
 Følg monterings- og bruksveiledningen.

Universal demonteringsverktøy

Universal dismantling tool

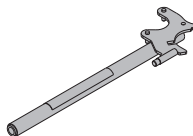
3,7 582768000

 Galvanisert
 Lengde: 75,5 cm

Alu bjelkegaffel H20

Alu beam fork H20

2,4 586182000

Alu
Gul pulverlakkert
Lengde: 176 cm

**Doka bjelke H20 top N 2,65m****Doka bjelke H20 top N 3,90m**

Doka beam H20 top N

13,8 189013000**20,0 189017000**

Gul-lakkert

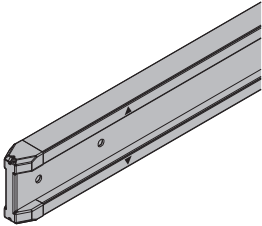
**Doka bjelke H20 top P 2,65m****Doka bjelke H20 top P 3,90m**

Doka beam H20 top P

14,3 189703000**20,8 189707000**

Gul-lakkert

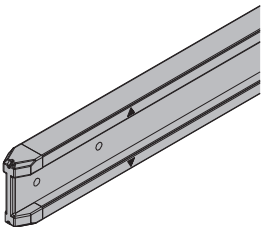
**ProFrame panel 21mm 200/50cm****ProFrame panel 21mm 200/50cm BS****ProFrame panel 21mm 250/50cm****ProFrame panel 21mm 250/50cm BS**

ProFrame panel 21

11,0 186118000**11,0 186118100****13,8 186117000****13,8 186117100****ProFrame panel 27mm 200/50cm****ProFrame panel 27mm 200/50cm BS****ProFrame panel 27mm 250/50cm****ProFrame panel 27mm 250/50cm BS**

ProFrame panel 27

13,5 187178000**13,5 187178100****16,9 187177000****16,9 187177100****Doka sikkerhetssele**

Doka personal fall-arrest set

3,6 583022000

Observer bruksveiledningen!

CE

**Doka sikkerhetssystemer**

Du finner arbeidsplattformer, rekk-
verksystemer og adkomstsystemer
under overskriften "Doka
Sikkerhetssystemer"