

[kg] Art. nr.

Plattform konsoll M

Platform bracket M

33,6 580547000Galvanisert
Lengde: 136 cm
Høyde: 230 cm**Hjørne platform stender M**

Corner platform strut M

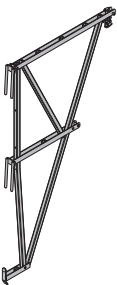
13,3 580552000Galvanisert
Høyde: 232 cm**Plattform M 3,00m**

Platform decking M 3.00m

121,7 580548000Treverk: gul-lakkert
Ståldetaljer: galvanisert
Leveres: sammenslått**Forlenger M**

Support lengthening piece M

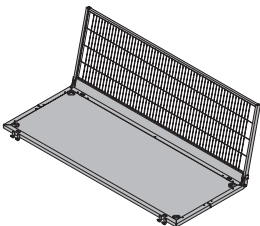
33,7 580553000Galvanisert
Høyde: 338 cm
Leveres: sammenslått**Hjørne overgang M 1,80m**

Corner transition M 1.80m

77,9 580556000Treverk: gul-lakkert
Ståldetaljer: galvanisert
Leveres: sammenslått**Opphengsbjelke M**

Suspension beam M

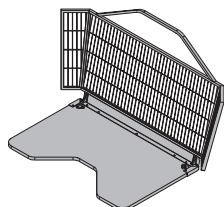
17,6 580572000Galvanisert
Høyde: 221 cm**Rekkverksforlenger Hjørneovergang M 1,80m**

Handrail extension Corner transition M 1.80m

20,1 580592000Galvanisert
Bredde: 126 cm
Høyde: 158 cm**Universal rekkverkforlenger M**

Universal handrail extension M

6,7 580560000Galvanisert
Høyde: 113 cm**Hjørne platform plattformdekke M**

Corner platform decking M

64,7 580550000Treverk: gul-lakkert
Ståldetaljer: galvanisert
Lengde: 160 cm
Bredde: 160 cm**Konsollrekkverk M**

Bracket railing post M

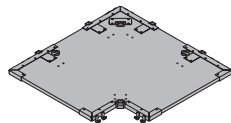
11,0 580554000Galvanisert
Høyde: 232 cm**Hjørne platform rekkverk M**

Corner platform railing M

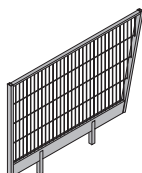
25,4 580551000Galvanisert
Lengde: 177 cm
Høyde: 123 cm

[kg] Art. nr.

Enderekkverk T

Side handrail clamping unit T

29,1 580488000

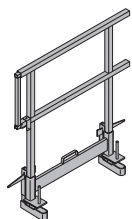

Galvanisert
Lengde: 115 - 175 cm
Høyde: 112 cm



[kg] Art. nr.

Stagnøkkel 15,0/20,0

Tie rod wrench 15.0/20.0

1,9 580594000

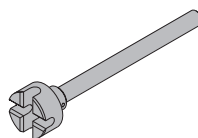

Galvanisert
Lengde: 37 cm
Diameter: 8 cm

Opphengssløyfe ES

Suspension loop ES

1,0 580458000



Ubehandlet
Lengde: 72 cm

**Innskruiingskonus 30kN 15,0**

Screw-in cone 30kN 15.0

0,74 581895000

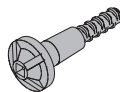

Galvanisert
Lengde: 15 cm

Opphengsplate ES

Suspension plate ES

9,2 580493000

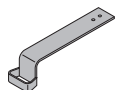

Galvanisert
Lengde: 68 cm

**Gesimsanker 30kN 15,0**

Gesimsanker 30kN 15,0 galv.
Bridge edge beam anchor 30kN 15.0

0,45 581896000

0,44 581890000



Lengde: 7 cm
Overhold monteringsveiledningen!

Hjørneoppheng M

Corner suspension plate M

19,0 580591000

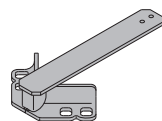

Galvanisert
Lengde: 73 cm

Spikerkonus 15,0

Nailing cone 15.0

0,02 581897000



Svart
Lengde: 7 cm

Opphengsprofil ES

Suspension profile ES

15,3 580596000

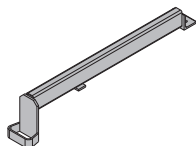

Galvanisert
Lengde: 109 cm

Hode for prefab. elementer M

Precast member head M

7,0 580573000

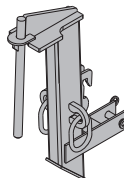

Galvanisert
Høyde: 55 cm

Opphengsko M

Suspension shoe M

4,3 580557000



Galvanisert
Bredde: 15 cm
Høyde: 18 cm

Innbyggingshylse M

Mounting sleeve M

0,09 580574000



Grå
Lengde: 29 cm

Ankerbøyle M

Anchor bracket M

1,2 580558000



Galvanisert
Bredde: 8 cm
Høyde: 16 cm

Justerstøtte 260 IB

Plumbing strut 260 IB

12,8 588437500



Galvanisert
Lengde: 146,8 - 256,7 cm

Vegganker M

Wall anchor M

1,5 580559000



Galvanisert
Lengde: 80 cm

[kg] Art. nr.

Justerstøtte 340 IB

Plumbing strut 340 IB

16,7 588696000

Galvanisert

Lengde: 190,8 - 341,8 cm

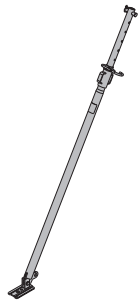
**Justerstøtte 540 IB**

Plumbing strut 540 IB

30,7 588697000

Galvanisert

Lengde: 310,5 - 549,2 cm

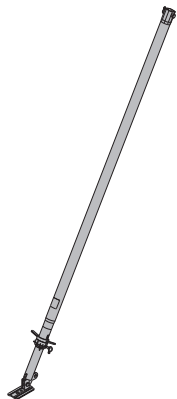
**Sko EB**

Strut shoe EB

0,93 588946000

Galvanisert

Bredde: 8 cm

Høyde: 13 cm

**Doka ekspressanker 16x125mm**

Doka express anchor 16x125mm

0,31 588631000

Galvanisert

Lengde: 18 cm

Overhold monteringsveiledningen!

**Doka låsefjær 16mm**

Doka coil 16mm

0,009 588633000

Galvanisert

Diameter: 1,6 cm



Stillasrør 48,3mm 0,50m

1,7 682026000

Stillasrør 48,3mm 1,00m

3,6 682014000

Stillasrør 48,3mm 1,50m

5,4 682015000

Stillasrør 48,3mm 2,00m

7,2 682016000

Stillasrør 48,3mm 2,50m

9,0 682017000

Stillasrør 48,3mm 3,00m

10,8 682018000

Stillasrør 48,3mm 3,50m

12,6 682019000

Stillasrør 48,3mm 4,00m

14,4 682021000

Stillasrør 48,3mm 4,50m

16,2 682022000

Stillasrør 48,3mm 5,00m

18,0 682023000

Stillasrør 48,3mm 5,50m

19,8 682024000

Stillasrør 48,3mm 6,00m

21,6 682025000

Stillasrør 48,3mmm

3,6 682001000

Scaffold tube 48.3mm

Galvanisert

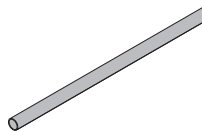
**Dreiekobling 48mm**

Swivel coupler 48mm

1,5 582560000

Galvanisert

Nøkkelåpning: 22 mm

Overhold monteringsveiledningen!

**Låserem 55cm**

Quick-locking strap 55cm

0,07 580787000

Gul

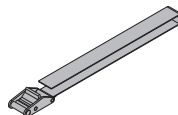
**Sko EB**

Strut shoe EB

0,93 588946000

Galvanisert

Bredde: 8 cm

Høyde: 13 cm

**Doka ekspressanker 16x125mm**

Doka express anchor 16x125mm

0,31 588631000

Galvanisert

Lengde: 18 cm

Overhold monteringsveiledningen!

**Doka låsefjær 16mm**

Doka coil 16mm

0,009 588633000

Galvanisert

Diameter: 1,6 cm

**Doka fireparts kjetting 3,20m**

Doka 4-part chain 3.20m

15,0 588620000

Observer bruksveiledningen!

CE

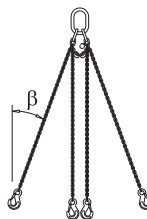
**Plattform transport gaffel K/M plus**

Transport fork K/M plus

226,0 583025000

Galvanisert

Lengde: 305 cm

Bredde: 204 cm

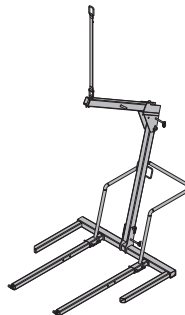

Plattform transport gaffel K/M**194,0 580492000**

Plattform transport fork K/M



Blålakkert

Lengde: 205 - 262 cm

Bredde: 210 cm

Leveres: sammenslått

Observer bruksveiledningen!

CE

Doka sikkerhetssele**3,6 583022000**

Doka personal fall-arrest set

Observer bruksveiledningen!



CE