

	[kg]	Art. nr.
Doka dekkestøtte Eurex 20 top 150 Lengde: 92 - 150 cm	8,0	586096000
Doka dekkestøtte Eurex 20 top 250 Lengde: 148 - 250 cm	12,7	586086400
Doka dekkestøtte Eurex 20 top 300 Lengde: 173 - 300 cm	14,3	586087400
Doka dekkestøtte Eurex 20 top 350 Lengde: 198 - 350 cm	17,4	586088400
Doka dekkestøtte Eurex 20 top 400 Lengde: 223 - 400 cm	21,6	586089400
Doka dekkestøtte Eurex 20 top 550 Lengde: 298 - 550 cm	32,3	586090400
Doka dekkestøtte Eurex 20 top 700 Lengde: 383 - 700 cm	48,0	586139000

Doka floor prop Eurex 20 top

Galvanisert



Doka dekkestøtte Eurex 30 top 250 Lengde: 148 - 250 cm	12,8	586092400
Doka dekkestøtte Eurex 30 top 300 Lengde: 173 - 300 cm	16,4	586093400
Doka dekkestøtte Eurex 30 top 350 Lengde: 198 - 350 cm	20,7	586094400
Doka dekkestøtte Eurex 30 top 400 Lengde: 223 - 400 cm	24,6	586095400
Doka dekkestøtte Eurex 30 top 450 Lengde: 248 - 450 cm	29,1	586119400
Doka dekkestøtte Eurex 30 top 550 Lengde: 303 - 550 cm	38,6	586129000

Doka floor prop Eurex 30 top

Galvanisert

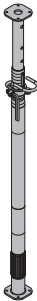

Foldebein top Removable folding tripod top	12,0	586155500
--	------	-----------

Galvanisert
Høyde: 80 cm
Leveres: sammenslått



Foldebein 1,20m Removable folding tripod 1.20m	20,7	586145000
--	------	-----------

Galvanisert
Høyde: 120 cm
Leveres: sammenslått



Drophead gaffel H20 Lowering head H20	6,1	586174000
---	-----	-----------

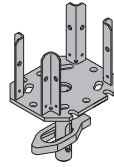

Galvanisert
Lengde: 25 cm
Bredde: 20 cm
Høyde: 38 cm

Toppgaffel H20 4-way head H20	4,0	586170000
---	-----	-----------

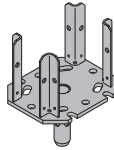

Galvanisert
Lengde: 25 cm
Bredde: 20 cm
Høyde: 33 cm

Fjærbolt 16mm Spring locked connecting pin 16mm	0,25	582528000
---	------	-----------



Galvanisert
Lengde: 15 cm

Hjelpegaffel H20 DF Supporting head H20 DF	0,77	586179000
--	------	-----------



Galvanisert
Lengde: 19 cm
Bredde: 11 cm
Høyde: 8 cm

U-hode 12,5cm U-head 12.5cm	1,2	586171000
---------------------------------------	-----	-----------

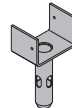

Galvanisert
Høyde: 23 cm

Avsvertingsklammer B Bracing clamp B	1,4	586195000
--	-----	-----------

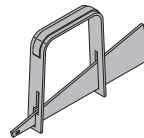

Blålakkert
Lengde: 36 cm

Laststropp 5,00m Lashing strap 5.00m	2,8	586018000
--	-----	-----------

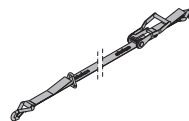

Gul

Doka ekspressanker 16x125mm Doka express anchor 16x125mm	0,31	588631000
--	------	-----------



Galvanisert
Lengde: 18 cm
Overhold monteringsveiledningen!

Doka låsefjær 16mm Doka coil 16mm	0,009	588633000
---	-------	-----------



Galvanisert
Diameter: 1,6 cm

[kg] Art. nr.

Kranøye
Lifting bracket

6,2 580460000

Galvanisert
Høyde: 59 cm**Universal endestengsvinkel 30cm**
Universal end-shutter support 30cm

1,0 586232000

Galvanisert
Høyde: 21 cm**Bjelketvinge 20**
Beam forming support 20

6,9 586148000

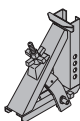
Galvanisert
Lengde: 30 cm
Høyde: 35 cm**Forlenger for bjelketvinge 60cm**
Extension for beam forming support 60cm

4,4 586149000

Galvanisert

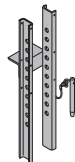
**Doka endestengsklemme**
Doka floor end-shutter clamp

12,5 586239000

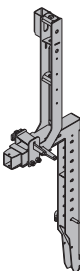
Galvanisert
Høyde: 137 cm**Sko for endesteng**
End-shutter shoe

1,6 586257000

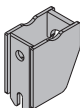
Galvanisert
Høyde: 13,5 cm**Spennstag for endesteng 15,0 15-40cm**
End-shutter tie rod 15.0 15-40cm

0,91 586258000

Galvanisert
Lengde: 55 cm**Universal staghullsplogg R20/25**
Universal plug R20/25

0,003 588180000

Blå
Diameter: 3 cm**Plugg for krymplinjal R25**
Plug for closure plate R25[kg] Art. nr.
0,003 588187000Svart
Diameter: 3 cm**Arbeidskrakk 0,97m**
Platform stairway 0.97m

23,5 586555000

Alu
Bredde: 121 cm
Nationale, sicherheitstechnische
Vorschriften beachten!**Rullestillas DF**
Wheel-around scaffold DF

44,0 586157000

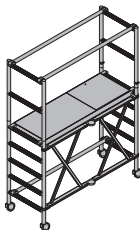
Alu
Lengde: 185 cm
Bredde: 80 cm
Høyde: 255 cm
Leveres: sammenslått**Rullestillas Z**
Mobile scaffold tower Z

Består av:

- (A) Stillasramme Z 1,00m 6,7 586016000
- (B) Stillasramme Z 2,00m 11,3 586017000
- (C) Rekkverkramme Z 1,00m 4,1 586021000
- (D) Rekkverk Z 1,80m 6,5 586022000
- (E) Plattform Z med mannehull 1,80m 17,5 586023000
- (F) Plattform Z uten mannehull 1,80m 17,0 586024000
- (G) Sparkebord Z 1,35m 4,0 586025000
- (H) Sparkebord Z 1,80m 5,1 586026000
- (I) Diagonal stag Z 2,00m 3,0 586027000
- (J) Horisontal stag Z 1,80m 2,8 586028000
- (K) Trekantbrakett Z 5,3 586029000
(uten avbildning)
- (L) Transporthjul Z D200mm 7,1 586030000
- (M) Innstegsbøyle Z 0,97 586031000
- (N) Plattformdiagonal Z 2,5 586032000
(uten avbildning)
- (O) Ballast Z 10,0 586033000
(uten avbildning)

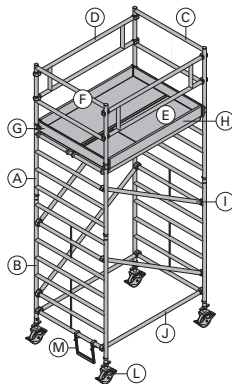
Alu
Følg monterings- og bruksveiledningen.**Universal demonteringsverktøy**
Universal dismantling tool

3,7 582768000

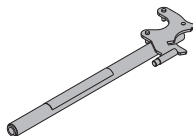
Galvanisert
Lengde: 75,5 cm

[kg] Art. nr.

Alu bjelkegaffel H20

Alu beam fork H20

Alu
Gul pulverlakkert
Lengde: 176 cm

2,4 586182000

ProFrame panel 27mm 200/50cm

ProFrame panel 27mm 200/50cm BS

ProFrame panel 27mm 250/50cm

ProFrame panel 27mm 250/50cm BS

ProFrame panel 27

13,5 187178000

13,5 187178100

16,9 187177000

16,9 187177100

Strøbjelkestøtte 1**Strøbjelkestøtte 2**

Secondary-beam stabiliser

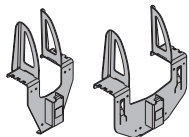
Galvanisert
Høyde: 38,7 cm

1,6 586196000

2,1 586197000

Doka sikkerhetssele

Doka personal fall-arrest set

Observer bruksveiledningen!

CE



3,6 583022000

Doka bjelke I tec 20 1,80m**Doka bjelke I tec 20 2,45m****Doka bjelke I tec 20 2,65m****Doka bjelke I tec 20 3,90m****Doka bjelke I tec 20 4,50m****Doka bjelke I tec 20 4,90m****Doka bjelke I tec 20 5,35m****Doka bjelke I tec 20 5,90m**

Doka beam I tec 20

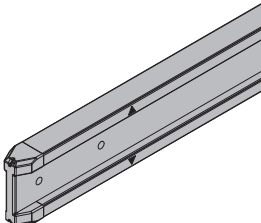
Gul-lakkert
Grå-lasert

10,1 188001000

13,7 188002000

14,8 188003000

21,8 188007000

25,2 188008000

27,4 188009000

30,0 188013000

33,0 188010000

Doka sikkerhetssystemer

Du finner arbeidsplattformer, rekkverksystemer og adkomstsystemer under overskriften "Doka Sikkerhetssystemer"

Doka bjelke H20 top N 2,65m**Doka bjelke H20 top N 2,90m****Doka bjelke H20 top N 3,30m**

Doka beam H20 top N

Gul-lakkert

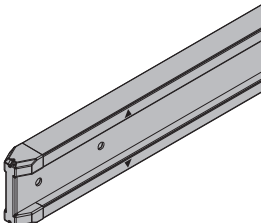

13,8 189013000

15,0 189014000

17,0 189015000

Doka bjelke H20 top P 2,65m**Doka bjelke H20 top P 2,90m****Doka bjelke H20 top P 3,30m**

Doka beam H20 top P

Gul-lakkert

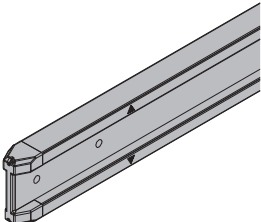

14,3 189703000

15,6 189704000

17,7 189705000

ProFrame panel 21mm 200/50cm**ProFrame panel 21mm 200/50cm BS****ProFrame panel 21mm 250/50cm****ProFrame panel 21mm 250/50cm BS**

ProFrame panel 21

11,0 186118000

11,0 186118100

13,8 186117000

13,8 186117100