

[kg] Art. nr.

FF20 element 2,00x2,75m 21mm	335,0	587512000
FF20 element 1,00x2,75m 21mm	166,0	587508000
FF20 element 0,75x2,75m 21mm	131,0	587504000
FF20 element 0,50x2,75m 21mm	92,0	587500000
FF20 element 2,00x1,00m 21mm	190,0	587523000
FF20 element 1,00x1,00m 21mm	95,0	587522000
FF20 element 0,75x1,00m 21mm	79,5	587521000
FF20 element 0,50x1,00m 21mm	58,0	587520000
FF20 element 2,00x3,75m 21mm	440,0	587564000
FF20 element 1,00x3,75m 21mm	224,0	587562000
FF20 element 0,75x3,75m 21mm	172,0	587561000
FF20 element 0,50x3,75m 21mm	120,0	587560000
FF20 element 2,00x6,50m 21mm	692,0	587563000
FF20 element 1,00x6,50m 21mm	346,0	587565000
FF20 element 0,75x6,50m 21mm	272,0	587566000
FF20 element 0,50x6,50m 21mm	189,5	587567000

Formwork element FF20 21mm

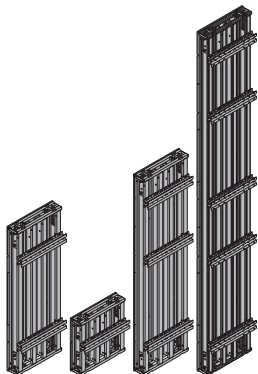

Innerhjørne FF20 2,75m 21mm
 Innerhjørne FF20 1,00m 21mm
 Inside corner FF20 21mm

[kg] Art. nr.
 214,0 587516000
 117,0 587525000

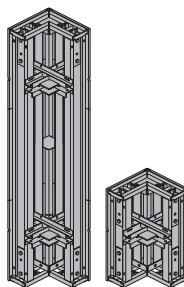

Innerhjørne FF20 2,75m 27mm
 Innerhjørne FF20 1,00m 27mm
 Innerhjørne FF20 0,50m 27mm
 Inside corner FF20 27mm

220,0 587608000
 120,0 587618000
 33,5 587628000

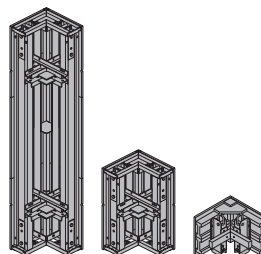

FF20 element 2,00x2,75m 27mm	348,0	587606000
FF20 element 1,00x2,75m 27mm	173,0	587604000
FF20 element 0,75x2,75m 27mm	136,0	587602000
FF20 element 0,50x2,75m 27mm	96,0	587600000
FF20 element 2,00x1,00m 27mm	195,0	587616000
FF20 element 1,00x1,00m 27mm	103,0	587614000
FF20 element 0,75x1,00m 27mm	81,5	587612000
FF20 element 0,50x1,00m 27mm	59,5	587610000

Formwork element FF20 27mm

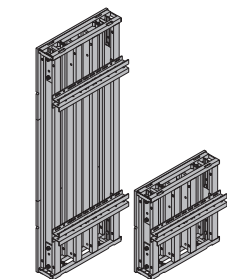

Justerbart innerhjørne FF20 2,75m 21mm
 Justerbart innerhjørne FF20 1,00m 21mm
 Justerbart innerhjørne FF20 0,50m 21mm
 Swivelling inside corner FF20 21mm

246,5 587577000
 103,0 587575000
 53,7 587573000

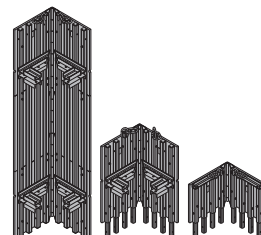

Justerbart innerhjørne FF20 0,50m 27mm
 Justerbart innerhjørne FF20 1,00m 27mm
 Justerbart innerhjørne FF20 2,75m 27mm
 Swivelling inside corner FF20 27mm

55,0 587647000
 108,8 587649000
 255,0 587651000

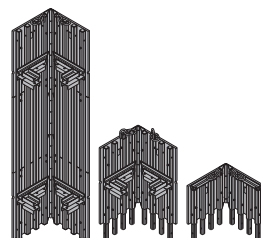

FF20 påbyggelement 2,00x0,50m 21mm	90,5	587529000
FF20 påbyggelement 1,00x0,50m 21mm	45,4	587528000
FF20 påbyggelement 0,75x0,50m 21mm	36,4	587527000
FF20 påbyggelement 0,50x0,50m 21mm	27,5	587526000

Stacking element FF20 21mm



FF20 påbyggelement 2,00x0,50m 27mm	67,5	587626000
FF20 påbyggelement 1,00x0,50m 27mm	33,4	587624000
FF20 påbyggelement 0,75x0,50m 27mm	28,8	587622000
FF20 påbyggelement 0,50x0,50m 27mm	21,0	587620000

Stacking element FF20 27mm



Justerbart ytterhjørne FF20 2,75m 21mm
 Justerbart ytterhjørne FF20 1,00m 21mm
 Swivelling outside corner FF20 21mm

102,7 587579000
 46,2 587578000

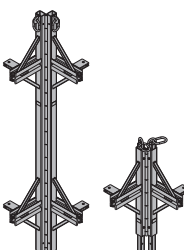

Blåläkkert

[kg] Art. nr.

Justerbart ytterhjørne FF20 2,75m 27mm 102,7 587654000
Justerbart ytterhjørne FF20 1,00m 27mm 46,2 587653000

Swivelling outside corner FF20 27mm

Blålakkert

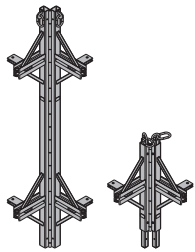

Justerbart ytterhjørne FF20 0,50m 27mm 16,1 587652000

Swivelling outside corner FF20 0.50m

Blålakkert



Hjørnelask FF20 G 7,2 587571000

Corner plate FF20 G

Blålakkert

Lengde: 49 cm

Bredde: 24 cm

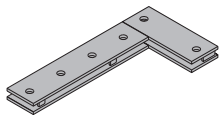

Koblingsbolt FF20 0,30 587545000

Fastening bolt FF20

Galvanisert

Lengde: 17 cm

Nøkkelåpning: 30 mm

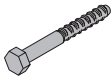

Stjernemutter 15,0 G 0,47 587544000

Star grip nut 15.0 G

Galvanisert

Bredde: 10 cm

Høyde: 5 cm

Nøkkelåpning: 30 mm



Elementlask FF20/50 6,3 587530000

Formwork element connector FF20/50

Blålakkert

Lengde: 55 cm

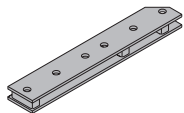

Elementlask FF20/50 Z 6,0 587533000

Formwork element connector FF20/50 Z

Blålakkert

Lengde: 55 cm

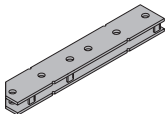

Tilpassingslask FF20/50 9,1 587532000

Adjustable waling extension FF20/50

Blålakkert

Lengde: 87 cm

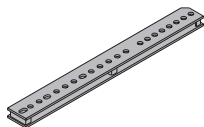
**Bjelke klemme Top50**

Beam clamp Top50

[kg] Art. nr.

1,2 580081000

Blålakkert

Høyde: 15 cm

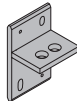
**Forankringslask FF20/50**

Anchoring plate FF20/50

6,6 587531000

Blålakkert

Lengde: 55 cm

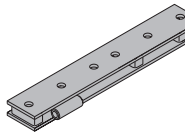
**Koblingslask med justering**

Splice plate with join adjustment

13,8 580215000

Blålakkert

Lengde: 76 cm

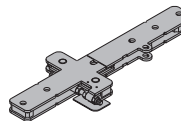
**Fordelerplate FF20**

Distribution plate FF20

1,7 580216000

Galvanisert

Bredde: 10,9 cm

Høyde: 12 cm

**Parallellask FF20**

Offset plate FF20

6,2 587534000

Blålakkert

Lengde: 35 cm

Bredde: 18 cm

Høyde: 4 cm

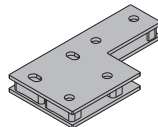
**Utvendig hjørnelask FF20 21mm**

Outside angle plate FF20

18,6 587535000

18,6 587634000

Blålakkert

Hjørnelengde: 60 cm

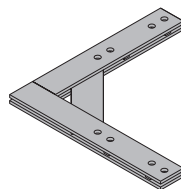
**Uni. vinkelbrakett Top50**

Universal angle tie bracket

4,4 580604000

Blålakkert

Lengde: 20 cm

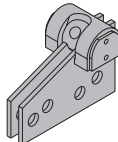
**Koblingsbolt 10cm**

Connecting pin 10cm

0,34 580201000

Galvanisert

Lengde: 14 cm

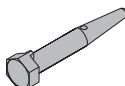

[kg] Art. nr.

[kg] Art. nr.

Fjærsplint 5mm

Spring cotter 5mm

0,05 580204000Galvanisert
Lengde: 13 cm**Bjelkeklammer H20**

Flange clamp H20

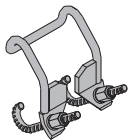
1,0 580135000Galvanisert
Bredde: 13 cm
Nøkkelåpning: 19 mm**Påbyggvinkel FF20**

Stacking angle FF20

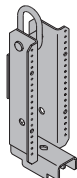
7,8 587547000Blålakkert
Høyde: 46 cm**Multifunksjonsbjelke WS10 Top50 0,50m**

Multifunctional beam WS10 Top50 0,75m

Multifunctional beam WS10 Top50 1,00m

Multifunctional beam WS10 Top50 1,25m

Multifunctional beam WS10 Top50 1,50m

Multifunctional beam WS10 Top50 1,75m

Multifunctional beam WS10 Top50 2,00m

Multifunctional beam WS10 Top50 2,25m

Multifunctional beam WS10 Top50 2,50m

Multifunctional beam WS10 Top50 2,75m

Multifunctional beam WS10 Top50 3,00m

Multifunctional beam WS10 Top50 3,50m

Multifunctional beam WS10 Top50 4,00m

Multifunctional beam WS10 Top50 4,50m

Multifunctional beam WS10 Top50 5,00m

Multifunctional beam WS10 Top50 5,50m

Multifunctional beam WS10 Top50 6,00m

Multi-purpose waling WS10 Top50

10,2 580001000**14,9 580002000****19,6 580003000****24,7 580004000****29,7 580005000****35,0 580006000****38,9 580007000****44,2 580008000****48,7 580009000****54,2 580010000****60,2 580011000****68,4 580012000****79,4 580013000****89,1 580014000****102,0 580015000****112,4 580016000****118,0 580017000**

Blålakkert

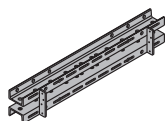
**Utsparringsklemme 24cm**

Box-out clamp 24cm

3,3 580063000

Utsparringsklemme 25cm

3,5 580064000

Utsparringsklemme 30cm

3,8 580065000

Box-out clamp

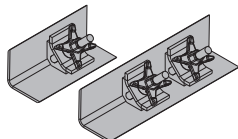
Galvanisert
Hjørnelengde: 10 cm**Utsparringsklemme type 1cm**

Box-out clampcm

16,7 580066000

Utsparringsklemme type 2cm

17,4 580067000

Box-out clampcm

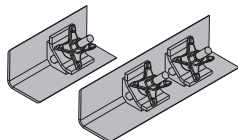
Blålakkert
Hjørnelengde: 10 cm**Formstøtte 340 IB**

Panel strut 340 IB

24,3 580365000

Består av:

(A) Justerstøtte 340 IB

Galvanisert

16,7 588696000

Lengde: 190,8 - 341,8 cm

(B) Justerbein 120 IB

Galvanisert

7,6 588248500

Lengde: 81,5 - 130,6 cm

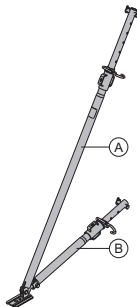
Galvanisert
Leveres: sammenslått**Formstøtte 540 IB**

Panel strut 540 IB

41,4 580366000

Består av:

(A) Justerstøtte 540 IB

Galvanisert

30,7 588697000

Lengde: 310,5 - 549,2 cm

(B) Justerbein 220 IB

Galvanisert

10,9 588251500

Lengde: 172,5 - 221,1 cm

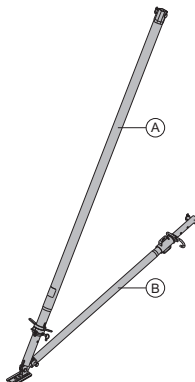
Galvanisert
Leveres: sammenslått

Eurex 60 550

Eurex 60 550

Består, avhengig av lengden, av:

- (A) **Justerstøtte Eurex 60 550** **42,5 582658000**
Blå pulverlakkert
Alu
Lengde: 343 - 553 cm
- (B) **Forlenger Eurex 60 2,00m** **21,3 582651000**
Blå pulverlakkert
Alu
Lengde: 250 cm
- (C) **Skjøtestykke Eurex 60** **8,6 582652000**
Alu
Lengde: 100 cm
Diameter: 12,8 cm
- (D) **Koblingsstykke Eurex 60 IB** **4,2 582657500**
Galvanisert
Lengde: 15 cm
Bredde: 15 cm
Høyde: 30 cm
- (E) **Bunnplate Eurex 60 EB** **8,0 582660500**
Galvanisert
Lengde: 31 cm
Bredde: 12 cm
Høyde: 33 cm
- (F) **Justerbein 540 Eurex 60 IB** **27,8 582659500**
Galvanisert
Lengde: 303,5 - 542,2 cm

Leveres: i deler

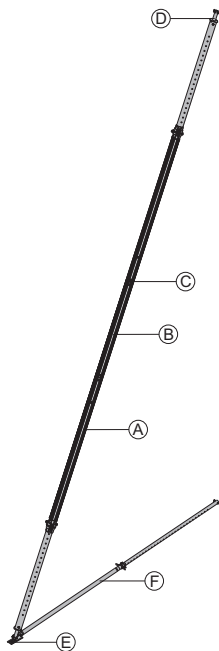
**Formstøtte hode EB**

Prop head EB

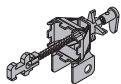
3,1 588244500Galvanisert
Lengde: 40,8 cm
Bredde: 11,8 cm
Høyde: 17,6 cm**Universal demonteringsverktøy**

Universal dismantling tool

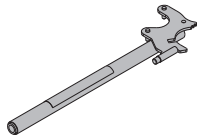
3,7 582768000Galvanisert
Lengde: 75,5 cm**Doka ekspressanker 16x125mm**

Doka express anchor 16x125mm

0,31 588631000Galvanisert
Lengde: 18 cm
Overhold monteringsveiledningen!**Doka låsefjær 16mm**

Doka coil 16mm

0,009 588633000Galvanisert
Diameter: 1,6 cm**Støpekonsoll L**

Top scaffold bracket L

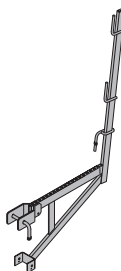
12,6 587153500Galvanisert
Lengde: 101 cm
Høyde: 159 cm**Universalkonsoll 60**

Universal bracket 60

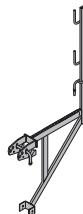
14,0 580477000Galvanisert
Lengde: 86 cm
Høyde: 181 cm**Universalkonsoll 90**

Universal bracket 90

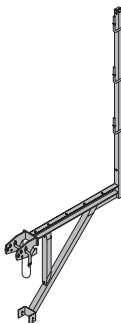
30,4 580476000Galvanisert
Lengde: 121 cm
Høyde: 235 cm**Innplanking for konsoll 60/250cm**

Bracket planking for konsoll 60/250cm

48,5 583029000**Innplanking for konsoll 90/250cm**

Bracket planking for konsoll 90/250cm

61,5 583031000Ståldetaljer: galvanisert
Treverk: gul-lakkert
(uten avbildning)**Konsollrekkverk 240-270cm**

Bracket railing 240-270cm

20,5 583032000Galvanisert
(uten avbildning)

[kg] Art. nr.

Universal rekkverkholder

Universal railing shackle

3,0 580478000Galvanisert
Høyde: 20 cm

Stillasrør 48,3mm 0,50m
Stillasrør 48,3mm 1,00m
Stillasrør 48,3mm 1,50m
Stillasrør 48,3mm 2,00m
Stillasrør 48,3mm 2,50m
Stillasrør 48,3mm 3,00m
Stillasrør 48,3mm 3,50m
Stillasrør 48,3mm 4,00m
Stillasrør 48,3mm 4,50m
Stillasrør 48,3mm 5,00m
Stillasrør 48,3mm 5,50m
Stillasrør 48,3mm 6,00m
Stillasrør 48,3mmm
 Scaffold tube 48.3mm

1,7 682026000
3,6 682014000
5,4 682015000
7,2 682016000
9,0 682017000
10,8 682018000
12,6 682019000
14,4 682021000
16,2 682022000
18,0 682023000
19,8 682024000
21,6 682025000
3,6 682001000

Galvanisert

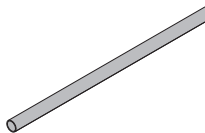
**Stillasrør festevinkel**

Scaffold tube connection

0,27 584375000Galvanisert
Høyde: 7 cm**Rørkobling med bolt 48mm 50**

Screw-on coupler 48mm 50

0,84 682002000Galvanisert
Nøkkelåpning: 22 mm
Overhold monteringsveiledningen!**Framax støpeplattform U 1,25/2,70m**

Framax pouring platform U 1.25/2.70m

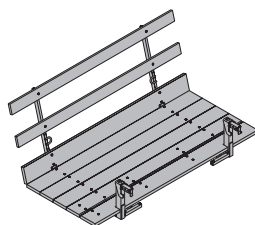
127,5 588377000Ståldetaljer: galvanisert
Treverk: gul-lakkert
Leveres: sammenslått**FF20 adapter for Framax støpeplattform U**

FF20 adapter for Framax pouring platform U

6,8 588381000Galvanisert
Lengde: 34 cm**Top50 adapter for Framax støpeplattform U**

Top50 adapter for Framax pouring platform U

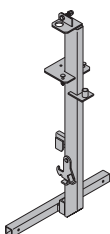
18,5 588384000Galvanisert
Bredde: 75 cm
Høyde: 134 cm**Enderekker T**

Side handrail clamping unit T

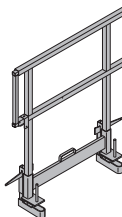
29,1 580488000Galvanisert
Lengde: 115 - 175 cm
Høyde: 112 cm**Rekkverkstolpe T 1,80m**

Handrail post T 1.80m

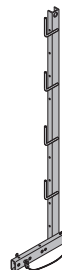
17,7 584373000

Galvanisert

Sparkebordholder T 1,80m

Toeboard holder T 1.80m

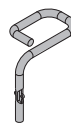
0,53 584392000Galvanisert
Høyde: 13,5 cm**Doka fireparts kjetting 3,20m**

Doka 4-part chain 3.20m

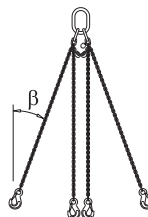
15,0 588620000

Observer bruksveiledningen!

CE

Løftekjetting 100cm 15kN

Lifting chain 100cm 15kN

1,8 587548000Lengde: 103 cm
Observer bruksveiledningen!

CE

Dokamatic løftestropp 13,00m

Dokamatic lifting strap 13.00m

10,5 586231000Grønn
Observer bruksveiledningen!

CE

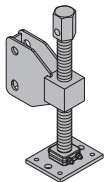

Kranøye
Lifting bracket**6,2 580460000**Galvanisert
Høyde: 59 cm**Høydejustering WS10-WU16**
Height adjuster WS10-WU16**10,1 580206500**Galvanisert
Høyde: 45 cm**Festevinkel for sikkerhetssele type A**
Tie-off connector type A**0,96 581641000**Galvanisert
Lengde: 13,7 cm**Doka sikkerhetssele**
Doka personal fall-arrest set**3,6 583022000**

Observer bruksveiledningen!

**Doka sikkerhetssystemer**Du finner arbeidsplattformer, rekk-
verksystemer og adkomstsystemer
under overskriften "Doka
Sikkerhetssystemer"