

[kg] Art. nr.

[kg] Art. nr.

Multifunksjonsbjelke WS10 Top50 0,50m	10,2	580001000
Multifunksjonsbjelke WS10 Top50 0,75m	14,9	580002000
Multifunksjonsbjelke WS10 Top50 1,00m	19,6	580003000
Multifunksjonsbjelke WS10 Top50 1,25m	24,7	580004000
Multifunksjonsbjelke WS10 Top50 1,50m	29,7	580005000
Multifunksjonsbjelke WS10 Top50 1,75m	35,0	580006000
Multifunksjonsbjelke WS10 Top50 2,00m	38,9	580007000
Multifunksjonsbjelke WS10 Top50 2,25m	44,2	580008000
Multifunksjonsbjelke WS10 Top50 2,50m	48,7	580009000
Multifunksjonsbjelke WS10 Top50 2,75m	54,2	580010000
Multifunksjonsbjelke WS10 Top50 3,00m	60,2	580011000
Multifunksjonsbjelke WS10 Top50 3,50m	68,4	580012000
Multifunksjonsbjelke WS10 Top50 4,00m	79,4	580013000
Multifunksjonsbjelke WS10 Top50 4,50m	89,1	580014000
Multifunksjonsbjelke WS10 Top50 5,00m	102,0	580015000
Multifunksjonsbjelke WS10 Top50 5,50m	112,4	580016000
Multifunksjonsbjelke WS10 Top50 6,00m	118,0	580017000
Multi-purpose waling WS10 Top50		

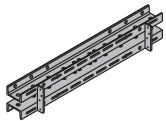

Blålakkert

Hjørne bjelke WS10 Top50m

Shaft corner waling WS10 Top50m

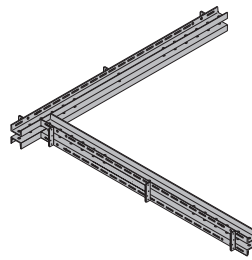
20,5 580069000

Blålakkert

Prosjektavhengig!

Doka-hjørnebjelke kan også leveres i profiltykkelse U120 (Bestillingsbetegnelse: WU12).

Vinkel hjørne bjelke WS10 Top50m

Angular waling WS10 Top50m

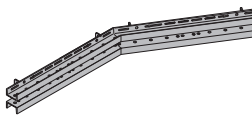
21,5 580068000

Blålakkert

Prosjektavhengig!

Doka-hjørnebjelke kan også leveres i profiltykkelse U120 (Bestillingsbetegnelse: WU12).

Multifunksjonsbjelke WU12 Top50 1,00m	25,3	580018000
Multifunksjonsbjelke WU12 Top50 1,25m	32,0	580019000
Multifunksjonsbjelke WU12 Top50 1,50m	37,5	580020000
Multifunksjonsbjelke WU12 Top50 1,75m	44,2	580021000
Multifunksjonsbjelke WU12 Top50 2,00m	50,0	580022000
Multifunksjonsbjelke WU12 Top50 2,50m	63,1	580023000
Multifunksjonsbjelke WU12 Top50 3,00m	75,7	580024000
Multifunksjonsbjelke WU12 Top50 3,50m	90,7	580025000
Multifunksjonsbjelke WU12 Top50 4,00m	103,4	580026000
Multi-purpose waling WU12 Top50		

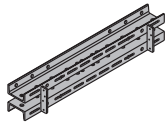

Blålakkert

Bjelkeklammer H20

Flange clamp H20

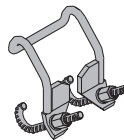
1,0 580135000

Galvanisert

Bredde: 13 cm

Nøkkellåpning: 19 mm

Bjelkeklammer G

Flange clamp G

1,1 580120000

Galvanisert

Bredde: 13 cm

Nøkkellåpning: 19 mm

Multifunksjonsbjelke SL-1 WU16 0,625m	24,0	582875000
Multifunksjonsbjelke SL-1 WU16 0,75m	26,5	582876000
Multifunksjonsbjelke SL-1 WU16 1,00m	35,0	582877000
Multifunksjonsbjelke SL-1 WU16 1,25m	44,5	582878000
Multifunksjonsbjelke SL-1 WU16 1,50m	53,0	582879000
Multifunksjonsbjelke SL-1 WU16 1,75m	67,0	582880000
Multifunksjonsbjelke SL-1 WU16 2,00m	72,1	582881000
Multifunksjonsbjelke SL-1 WU16 2,25m	86,0	582882000
Multifunksjonsbjelke SL-1 WU16 2,50m	89,9	582883000
Multifunksjonsbjelke SL-1 WU16 3,00m	107,0	582888000
Multi-purpose waling SL-1		

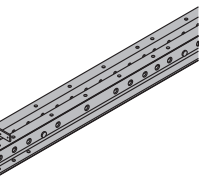

Blålakkert

Flensskralle

Flange claw

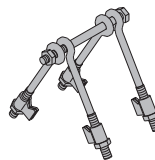
1,0 580137000

Galvanisert

Bredde: 17 cm

Nøkkellåpning: 19 mm

Hjørne bjelke 20	23,5	580031000
Corner waling 20		

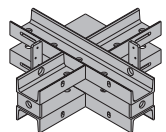

Blålakkert

Hjørnelengde: 52 cm

Bjelke klemme H20

Waling clamp H20

0,22 580114000

Galvanisert

Bredde: 8 cm

Nøkkellåpning: 13 mm

Bjelkeskrue S 8/60

Beam screw S 8/60

0,06 580116000

Galvanisert

Lengde: 7 cm

Nøkkellåpning: 13 mm

Bjelkeskrue H 8/70

Beam screw H 8/70

0,06 580117000

Galvanisert

Lengde: 8 cm

Nøkkellåpning: 13 mm

[kg] Art. nr.

Festelask H20

Fastening plate

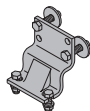

Blålakkert
Bredde: 13 cm
Høyde: 15 cm

2,7 580110000

Bjelke klemme Top50

Beam clamp Top50

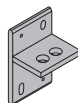

Blålakkert
Høyde: 15 cm

1,2 580081000

Endebeskytter H20

Protective cap H20

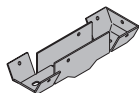

Galvanisert
Lengde: 20 cm
Bredde: 7 cm

0,36 587248000

Forankringslask FF20/50

Anchoring plate FF20/50

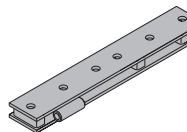

Blålakkert
Lengde: 55 cm

6,6 587531000

Kranøye

Lifting bracket



Galvanisert
Høyde: 59 cm

6,2 580460000

Halvlask

Half splice plate

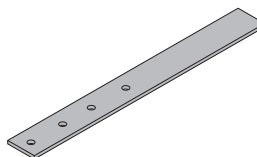

Blålakkert
Lengde: 78 cm

5,2 580267000

Koblingslask Top50 Z

Splice plate Top50 Z

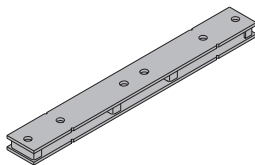

Blålakkert
Lengde: 76 cm

8,5 580074000

Koblingslask med justering

Splice plate with join adjustment

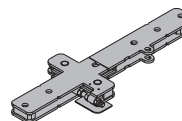

Blålakkert
Lengde: 76 cm

13,8 580215000

Elementlask FF20/50

Formwork element connector FF20/50

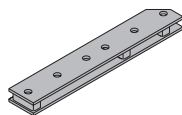

Blålakkert
Lengde: 55 cm

6,3 587530000

Parallelllask FF20

Offset plate FF20

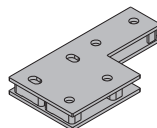

Blålakkert
Lengde: 35 cm
Bredde: 18 cm
Høyde: 4 cm

6,2 587534000

Elementlask FF20/50 Z

Formwork element connector FF20/50 Z

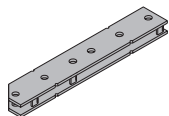

Blålakkert
Lengde: 55 cm

6,0 587533000

Innerhjørne lask H20 Top50

Internal angle plate H20 Top50

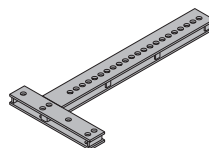

Blålakkert
Lengde: 80 cm
Bredde: 38 cm

11,3 580035000

Tilpassingslask 1,40m Top50

Adjustable waling extension 1.40m Top50

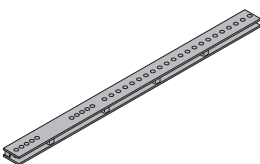

Blålakkert

15,0 580075000

Hjørnelask H20/H36 Top 50

Corner plate H20/H36 Top50

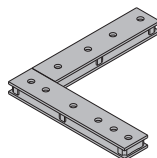

Blålakkert
Lengde: 49,7 cm
Bredde: 45,1 cm

10,0 580078000

Tilpassingslask FF20/50

Adjustable waling extension FF20/50

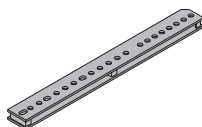

Blålakkert
Lengde: 87 cm

9,1 587532000

Vinkellask

Shaft waling squaring plate

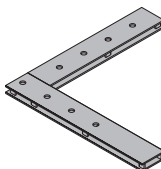

Blålakkert
Hjørnelengde: 60 cm

9,6 580262000

[kg] Art. nr.

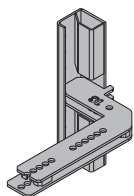
Overgangs-lask 18mm
Overgangs-lask 21mm
Transition plate**16,0 588654000**
15,8 588656000Blålakkert
Lengde: 54 cm
Bredde: 30 cm
Høyde: 51 cm

[kg] Art. nr.

Kranøye for søyleforskaling

Lifting bracket for column formwork

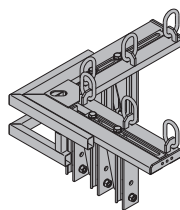
65,0 580607000Galvanisert og pulverlakkert
Lengde: 85 cm
Bredde: 85 cm**Bjelkekobling SL-1 WU16 0,75m**

Waling connector SL-1 WU16 0.75m

31,0 582886000Galvanisert
Lengde: 75 cm**Hengslet lask A Top50°**

Articulated conn. plate A Top50 degrees

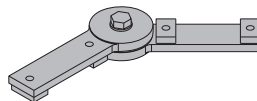
20,0 580208000Galvanisert
Hjørnelengde: 36 cm**Hjørne spindel**

Corner spindle

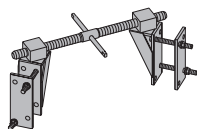
17,5 580264000Galvanisert
Lengde: 65 cm
Høyde: 31 cm**Dreie koblingslask**

Swivel joint plate

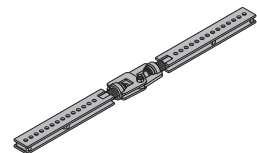
20,0 587542000Galvanisert
Lengde: 155 cm**Hjørnelask 90/50**

Corner connecting plate 90/50

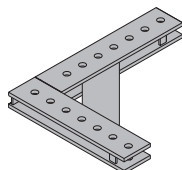
13,8 580603000Blålakkert
Lengde: 51 cm
Bredde: 40 cm**Koblingsbolt 10cm**

Connecting pin 10cm

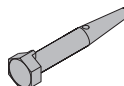
0,34 580201000Galvanisert
Lengde: 14 cm**Uni. vinkelbrakett Top50**

Universal angle tie bracket

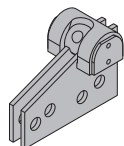
4,4 580604000Blålakkert
Lengde: 20 cm**Koblingsbolt 25cm**

Connecting pin 25cm

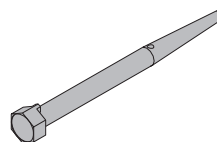
0,58 580202000Galvanisert
Lengde: 25 cm**Vinkelbrakett 20,0 SL-1 WU16**

Angle tie bracket 20.0 SL-1 WU16

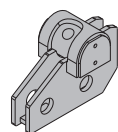
8,1 587543000Blålakkert
Lengde: 24 cm**Fjærsplint 5mm**

Spring cotter 5mm

0,05 580204000Galvanisert
Lengde: 13 cm**Søyle-lask 6/8**

Column connecting plate 6/8

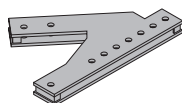
15,0 580072000Blålakkert
Lengde: 58 cm**Skjøtelask H20**

Stacking plate H20

8,3 580310000Galvanisert
Lengde: 68,8 cm

	[kg]	Art. nr.
Inner hjørne plate 3,00m	53,0	580282000
Inner hjørne plate 4,00m	69,0	580284000
Inside corner plate		

Blå pulverlakkert

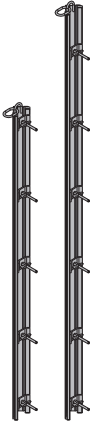

Krymplinjal 3,00m	36,8	580332000
Krymplinjal 4,00m	51,2	580334000
Joint plate		

Blå pulverlakkert

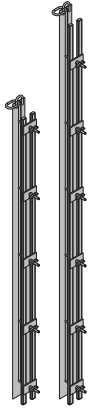

T-list 21/42 2,00m	0,34	580196000
T ledge 21/42 2.00m		

Grå



Utsparringsklemme 24cm	3,3	580063000
Utsparringsklemme 25cm	3,5	580064000
Utsparringsklemme 30cm	3,8	580065000
Box-out clamp		

Galvanisert

Hjørnelengde: 10 cm

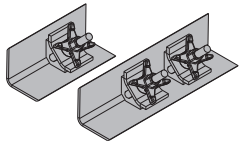

Utsparringsklemme type 1cm	16,7	580066000
Utsparringsklemme type 2cm	17,4	580067000
Box-out clampcm		

Blålakkert

Hjørnelengde: 10 cm

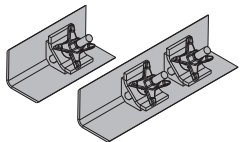

	[kg]	Art. nr.
Formstøtte 340 IB	24,3	580365000

Panel strut 340 IB

Består av:

(A) Justerstøtte 340 IB	16,7	588696000
--------------------------------	-------------	------------------

Galvanisert

Lengde: 190,8 - 341,8 cm

(B) Justerbein 120 IB	7,6	588248500
------------------------------	------------	------------------

Galvanisert

Lengde: 81,5 - 130,6 cm

Galvanisert

Leveres: sammenslått

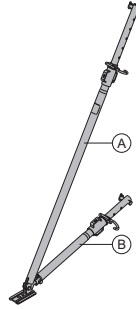

Formstøtte 540 IB	41,4	580366000
--------------------------	-------------	------------------

Panel strut 540 IB

Består av:

(A) Justerstøtte 540 IB	30,7	588697000
--------------------------------	-------------	------------------

Galvanisert

Lengde: 310,5 - 549,2 cm

(B) Justerbein 220 IB	10,9	588251500
------------------------------	-------------	------------------

Galvanisert

Lengde: 172,5 - 221,1 cm

Galvanisert

Leveres: sammenslått

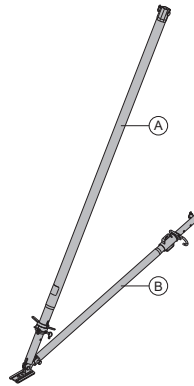

[kg] Art. nr.

[kg] Art. nr.

Eurex 60 550

Eurex 60 550

Består, avhengig av lengden, av:

- (A) **Justerstøtte Eurex 60 550** **42,5 582658000**
Blå pulverlakkert
Alu
Lengde: 343 - 553 cm
- (B) **Forlenger Eurex 60 2,00m** **21,3 582651000**
Blå pulverlakkert
Alu
Lengde: 250 cm
- (C) **Skjøtestykke Eurex 60** **8,6 582652000**
Alu
Lengde: 100 cm
Diameter: 12,8 cm
- (D) **Koblingsstykke Eurex 60 IB** **4,2 582657500**
Galvanisert
Lengde: 15 cm
Bredde: 15 cm
Høyde: 30 cm
- (E) **Bunnplate Eurex 60 EB** **8,0 582660500**
Galvanisert
Lengde: 31 cm
Bredde: 12 cm
Høyde: 33 cm
- (F) **Justerbein 540 Eurex 60 IB** **27,8 582659500**
Galvanisert
Lengde: 303,5 - 542,2 cm

Leveres: i deler

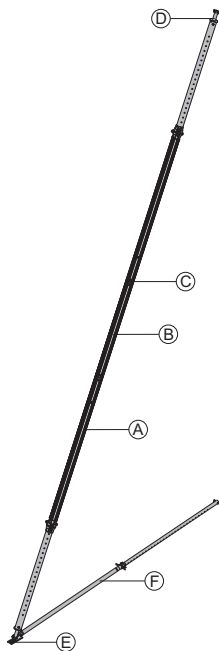
**Universal demonteringsverktøy**

Universal dismantling tool

3,7 582768000

Galvanisert

Lengde: 75,5 cm

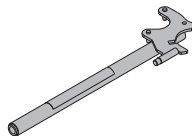
**Doka ekspressanker 16x125mm**

Doka express anchor 16x125mm

0,31 588631000

Galvanisert

Lengde: 18 cm

Overhold monteringsveiledningen!

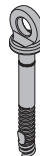
**Doka låsefjær 16mm**

Doka coil 16mm

0,009 588633000

Galvanisert

Diameter: 1,6 cm

**Universalkonsoll 60**

Universal bracket 60

14,0 580477000

Galvanisert

Lengde: 86 cm

Høyde: 181 cm

**Universalkonsoll 90**

Universal bracket 90

30,4 580476000

Galvanisert

Lengde: 121 cm

Høyde: 235 cm

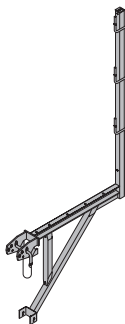
**Formstøtte hode EB**

Prop head EB

3,1 588244500

Galvanisert

Lengde: 40,8 cm

Bredde: 11,8 cm

Høyde: 17,6 cm

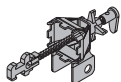
**Formstøtte hode Eurex 60 Top50**

Prop head Eurex 60 Top50

7,1 582665000

Galvanisert

Høyde: 50 cm

**Støpekonsoll L**

Top scaffold bracket L

12,6 587153500

Galvanisert

Lengde: 101 cm

Høyde: 159 cm

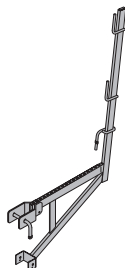

[kg] Art. nr.

[kg] Art. nr.

Innplanking for konsoll 60/250cm 48,5 583029000
Innplanking for konsoll 90/250cm 61,5 583031000

Bracket planking

Ståldetaljer: galvanisert
 Treverk: gul-lakkert
 (uten avbildning)

Konsollrekkeverk 240-270cm 20,5 583032000
 Bracket railing 240-270cm

Galvanisert
 (uten avbildning)

Universal rekkeverkholder 3,0 580478000
 Universal railing shackle



Galvanisert
 Høyde: 20 cm

Stillaserør festevinkel 0,27 584375000
 Scaffold tube connection



Galvanisert
 Høyde: 7 cm

Stillaserør 48,3mm 0,50m 1,7 682026000
Stillaserør 48,3mm 1,00m 3,6 682014000
Stillaserør 48,3mm 1,50m 5,4 682015000
Stillaserør 48,3mm 2,00m 7,2 682016000
Stillaserør 48,3mm 2,50m 9,0 682017000
Stillaserør 48,3mm 3,00m 10,8 682018000
Stillaserør 48,3mm 3,50m 12,6 682019000
Stillaserør 48,3mm 4,00m 14,4 682021000
Stillaserør 48,3mm 4,50m 16,2 682022000
Stillaserør 48,3mm 5,00m 18,0 682023000
Stillaserør 48,3mm 5,50m 19,8 682024000
Stillaserør 48,3mm 6,00m 21,6 682025000
Stillaserør 48,3mmm 3,6 682001000

Scaffold tube 48.3mm

Galvanisert

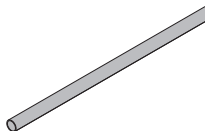

Rørkobling med bolt 48mm 50 0,84 682002000
 Screw-on coupler 48mm 50



Galvanisert
 Nøkkellåpning: 22 mm
 Overhold monteringsveiledningen!

Framax støpeplattform U 1,25/2,70m 127,5 588377000
 Framax pouring platform U 1.25/2.70m

Ståldetaljer: galvanisert
 Treverk: gul-lakkert
 Leveres: sammenslått

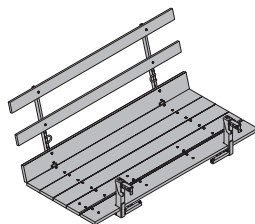

Top50 adapter for Framax støpeplattform U 18,5 588384000
 Top50 adapter for Framax pouring platform U

Galvanisert
 Bredde: 75 cm
 Høyde: 134 cm

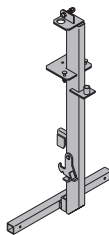

Enderekkeverk T 29,1 580488000
 Side handrail clamping unit T

Galvanisert
 Lengde: 115 - 175 cm
 Høyde: 112 cm

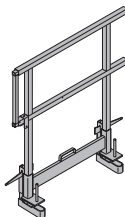

Rekkeverkstolpe T 1,80m 17,7 584373000
 Handrail post T 1.80m

Galvanisert

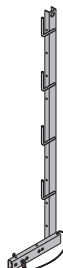

Sparkebordholder T 1,80m 0,53 584392000
 Toeboard holder T 1.80m

Galvanisert
 Høyde: 13,5 cm

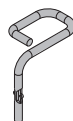

Rekkeverk 1,50m 12,4 582754000
 Handrail post 1.50m

Galvanisert



Doka fireparts kjetting 3,20m 15,0 588620000
 Doka 4-part chain 3.20m

Observer bruksveiledningen!

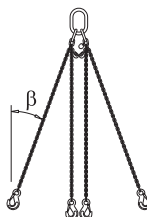

CE

[kg] Art. nr.

Støttestag T5/5mm

Universal strut T5/5mm

6,5 584311000

Blålakkert
Vekt per løpemeteter**Spindelstøtte GS T5 65/101 cm**

Spindle strut GS T5 65/101cm

9,1 584356000

Galvanisert

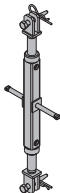
**Spindelstøtte T6 73/110cm**

Spindelstøtte T6 100/150cm

Spindle strut T6

10,2 584355000

12,5 584323000

Galvanisert

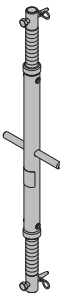
**Spindelstøtte GS T6 95/140cm**

Spindle strut GS T6 95/140cm

10,3 584340000

Galvanisert

**Spindelstøtte T7 75/110cm**

Spindelstøtte T7 100/150cm

Spindelstøtte T7 150/200cm

Spindelstøtte T7 200/250cm

Spindelstøtte T7 250/300cm

Spindelstøtte T7 305/355cm

Spindle strut T7

13,2 584308000

16,8 584309000

21,6 584324000

26,2 584325000

29,4 584326000

35,0 584327000

Galvanisert

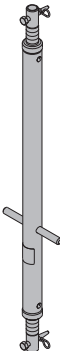
**Spindelstøtte T10 350/400cm**

Spindelstøtte T10mm

Spindle strut T10

57,5 584328000

16,9 584391000

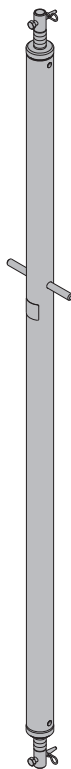
**Universal spindelfot T8**

Universal spindle foot T8

8,6 584314000

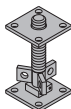
Blålakkert
Galvanisert
Høyde: 30 cm**Høydejustering bjelke**

Height adjuster for formwork beams

11,9 580218000

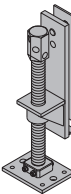
Galvanisert
Høyde: 46 cm**Høydejustering WS10-WU16**

Height adjuster WS10-WU16

10,1 580206500

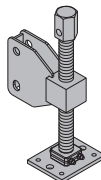
Galvanisert
Høyde: 45 cm**Høydejusterspindel M36**

Adjusting spindle M36

6,2 500663002

Galvanisert
Lengde: 31 cm
Høyde: 29,2 cm

[kg] Art. nr.

Opphengshode WS10

Suspension head WS10

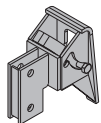

Galvanisert
Lengde: 21 cm
Bredde: 18 cm
Høyde: 23 cm

8,1 580449000

Monteringsvinkel Top50

Assembly angle Top50

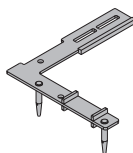

Galvanisert
Lengde: 53,2 cm
Bredde: 48,6 cm

6,7 580082000

Lask Top50mm

Universal support Top50mm

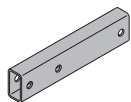

Blålakkert
Vekt per løpemetere

11,1 584312000

Båndtvinge B 5,00m

Strip tensioner B 5.00m

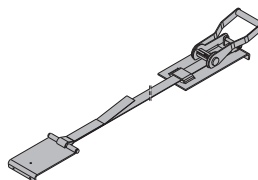

Galvanisert

3,5 580394000

Justeringsplate T

Adjusting plate T



Blålakkert
Lengde: 23,5 cm

6,5 584393000

Føringsskinnem

Positioning railm

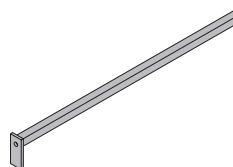

Blålakkert
Vekt per løpemetere

1,8 580079000

GF verktøykasse

Tool box GF

Inngår som del av leveransen:

(A) Skralle 1/2"

Galvanisert

Lengde: 30 cm

(B) Fastnøkkel 13/17

(C) Fastnøkkel 22/24

(D) Fastnøkkel 30/32

(E) Ringnøkkel 17/19

(F) Forlenger 11cm 1/2"

(G) Forlenger 22cm 1/2"

(H) Kardangkobling

(I) Koppnøkkel 19 1/2" L

(J) Koppnøkkel 13 1/2"

(K) Koppnøkkel 24 1/2"

(L) Koppnøkkel 30 1/2"

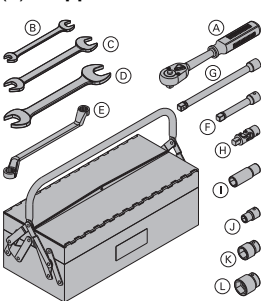

6,5 580390000

0,73 580580000

0,08 580577000

0,22 580587000

0,80 580897000

0,27 580590000

0,20 580581000

0,31 580582000

0,16 580583000

0,16 580598000

0,06 580576000

0,12 580584000

0,20 580575000

Borreplate Top50

Hole gauge Top50

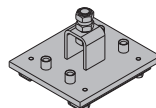

Blålakkert
Lengde: 17 cm
Bredde: 15 cm
Verktøy: Bor (diameter 10 mm)

2,9 580080000

Vinkelforbilder 9x5cm

Angle connector 9x5cm

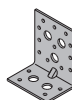

Galvanisert

0,22 580381000

Vinkel plate høyre

Vinkel plate venstre

Rafta plate

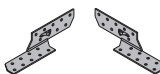

Galvanisert
Lengde: 17 cm

0,09 582521000

0,09 582522000

GF Pumpepluse SCC

Filler neck GF SCC

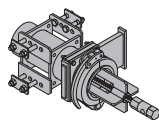

Galvanisert
Lengde: 66 cm

39,0 580217000

H20 finérbrakett

H20 screw-on bracket for formwork sheets

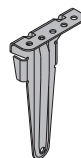

Galvanisert
Høyde: 19,2 cm

0,19 586256000

Sperrluke D125 SCC

Panel closure tool D125 SCC

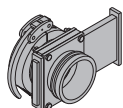

Galvanisert
Lengde: 18 cm
Bredde: 33 cm
Høyde: 27 cm

18,0 588127000

Finerskrape Xlife dobbel 100/150mm 1,40m

Double scraper Xlife 100/150mm 1.40m

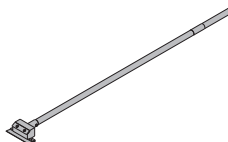

2,8 588674000

Doka sikkerhetssele

3,6 583022000

Doka personal fall-arrest set

Observer bruksveiledningen!



Doka sikkerhetssystemer



Du finner arbeidsplattformer, rekkverksystemer og adkomstsystemer under overskriften "Doka Sikkerhetssystemer"