

**Tie rod system 15.0**

Tie rod 15.0mm galvanised 0.50m	0.72	581821000
Tie rod 15.0mm galvanised 0.75m	1.1	581822000
Tie rod 15.0mm galvanised 1.00m	1.4	581823000
Tie rod 15.0mm galvanised 1.25m	1.8	581826000
Tie rod 15.0mm galvanised 1.50m	2.2	581827000
Tie rod 15.0mm galvanised 1.75m	2.5	581828000
Tie rod 15.0mm galvanised 2.00m	2.9	581829000
Tie rod 15.0mm galvanised 2.50m	3.6	581852000
Tie rod 15.0mm galvanised .....m	1.4	581824000
Tie rod 15.0mm non-treated 0.50m	0.73	581870000
Tie rod 15.0mm non-treated 0.75m	1.1	581871000
Tie rod 15.0mm non-treated 1.00m	1.4	581874000
Tie rod 15.0mm non-treated 1.25m	1.8	581886000
Tie rod 15.0mm non-treated 1.50m	2.1	581876000
Tie rod 15.0mm non-treated 1.75m	2.5	581887000
Tie rod 15.0mm non-treated 2.00m	2.9	581875000
Tie rod 15.0mm non-treated 2.50m	3.6	581877000
Tie rod 15.0mm non-treated 3.00m	4.3	581878000
Tie rod 15.0mm non-treated 3.50m	5.0	581888000
Tie rod 15.0mm non-treated 4.00m	5.7	581879000
Tie rod 15.0mm non-treated 5.00m	7.2	581880000
Tie rod 15.0mm non-treated 6.00m	8.6	581881000
Tie rod 15.0mm non-treated 7.50m	10.7	581882000
Tie rod 15.0mm non-treated .....m	1.4	581873000
Ankerstab 15,0mm		

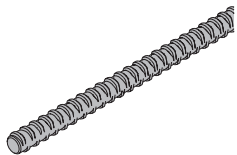

**DIN**  
18216

**Wing nut 15.0** 0.31 581961000  
 Flügelmutter 15,0

Galvanised  
Length: 10 cm  
Height: 5 cm  
Width-across: 27 mm

**DIN**  
18216

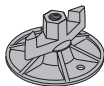
**Super plate 15.0** 1.1 581966000  
 Superplatte 15,0

Galvanised  
Height: 6 cm  
Diameter: 12 cm  
Width-across: 27 mm

**DIN**  
18216

**Hexagon nut 15.0** 0.23 581964000  
 Sechskantmutter 15,0

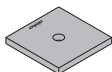

Galvanised  
Length: 5 cm  
Width-across: 30 mm

**DIN**  
18216

**Anchor plate 12/12** 1.3 581930000  
 Ankerplatte 12/12

Galvanised

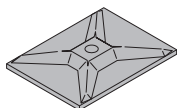
**DIN**  
18216

**Anchor plate 15/20** 1.8 581929000  
 Ankerplatte 15/20

Galvanised

**DIN**  
18216

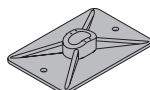
**Angle anchor plate 12/18** 1.5 581934000  
 Winkelplatte 12/18

Galvanised

**DIN**  
18216

**Top50 form-tie nut 15.0**

Top50-Ankermutter 15,0

3.8 580073000

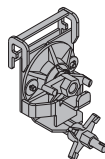

Galvanised  
Height: 25 cm

**Fixing plate 15.0**

Nagelblech 15,0

0.15 581692000



Galvanised  
Diameter: 10 cm

**Positioning cone 15.0 5cm**

Vorlaufkonus 15,0 5cm

0.43 581969000

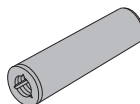

Galvanised  
Length: 11 cm  
Diameter: 3 cm  
Tool: Positioning cone spanner 15.0 DK  
Follow fitting instructions!

**Climbing cone 15.0 5cm**

Kletterkonus 15,0 5cm

0.97 581980000

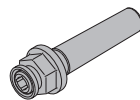

Galvanised  
Length: 17 cm  
Diameter: 6 cm  
Width-across: 41 mm  
Follow fitting instructions!

**Sealing sleeve 15.0 5cm**

Dichtungshülse 15,0 5cm

0.008 581990000



Orange  
Length: 10 cm  
Diameter: 3 cm

**She-bolt 15.0 5cm**

Ankerkopf 15,0 5cm

1.7 581972000



Galvanised  
Length: 76 cm  
Width-across: 24 mm  
Follow fitting instructions!

**DIN**  
18216

**She-bolt 15.0 5cm 1.20m**

Ankerkopf 15,0 5cm 1,20m

2.5 581832000

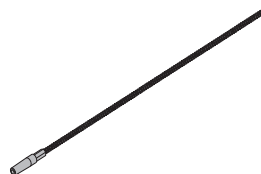

Galvanised  
Length: 131 cm  
Width-across: 24 mm  
Follow fitting instructions!

**DIN**  
18216

**Cantilever positioning cone 15.0 5cm**

Sperrenvorlauf 15,0 5cm

0.45 581699000



Length: 11 cm  
Diameter: 5 cm  
Tool: Positioning cone spanner 15.0 DK  
Follow fitting instructions!

**Sealing sleeve S 15.0 5cm**

Dichtungshülse S 15,0 5cm

0.009 581697000

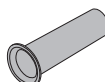

Orange  
Length: 11 cm  
Diameter: 4.7 cm

[kg] Article n°

**Fair-faced concrete positioning cone 15.0 5cm** **0.46 581973000**

Sichtbetonvorlauf 15,0 5cm



Galvanised  
Length: 11 cm  
Diameter: 4.3 cm  
Tool: Positioning cone spanner 15.0  
DK

**Suspension cone 15.0 5cm** **0.88 581971000**

Aufhängekonus 15,0 5cm

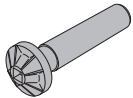

Galvanised  
Length: 16 cm  
Diameter: 6 cm  
Follow fitting instructions!

**Suspension cone 15.0 f. insulation up to 11cm** **3.6 580495000**

Aufhängekonus 15,0 für Isolierung bis 11cm

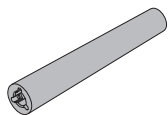

Galvanised  
Length: 30 cm  
Diameter: 5 cm

**Sealing sleeve 15.0 f. insulation up to 11cm** **0.05 580498000**

Dichtungshülse 15,0 für Isolierung bis 11cm

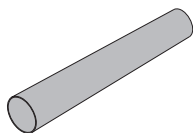

White  
Length: 30 cm  
Diameter: 6 cm

**Cone screw RD 28** **0.65 580496000**

Konusschraube RD 28



Galvanised  
Length: 9 cm  
Diameter: 6 cm

**Positioning disk RD 28** **0.25 580497000**

Vorlaufscheibe RD 28



Galvanised  
Diameter: 9 cm

**Universal climbing cone 15.0** **1.3 581977000**

Universal-Kletterkonus 15,0

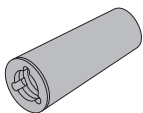

Galvanised  
Length: 13 cm  
Diameter: 5 cm  
Tool: Spanner for universal climbing  
cone 15.0/20.0

**Cone screw B 7cm** **0.86 581444000**

Konusschraube B 7cm



red  
Length: 10 cm  
Diameter: 7 cm  
Width-across: 50 mm

**Sealing sleeve K 15.0** **0.03 581976000**

Dichtungshülse K 15,0

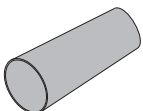

Orange  
Length: 12 cm  
Diameter: 6 cm

[kg] Article n°

**Fair-faced concrete positioning cone MF 15.0** **1.5 581928000**

Sichtbetonvorlauf MF 15,0

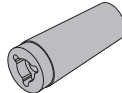

Galvanised  
Length: 12.6 cm  
Diameter: 5.3 cm  
Tool: Spanner for universal climbing  
cone 15.0/20.0

**Positioning disk M30** **0.25 581975000**

Vorlaufscheibe M30



Galvanised  
Diameter: 9 cm

**Positioning clamp M30** **0.19 581833000**

Vorlaufklemme M30



Galvanised  
Diameter: 4 cm

**Screw-in cone 30kN 15.0** **0.74 581895000**

Einschraubkonus 30kN 15,0

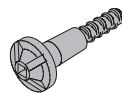

Galvanised  
Length: 15 cm

**Bridge edge beam anchor 30kN 15.0** **0.45 581896000****Bridge edge beam anchor 30kN 15.0 galv.** **0.44 581890000**

Gesimsanker 30kN 15,0



Length: 7 cm  
Follow fitting instructions!

**Nailing cone 15.0** **0.02 581897000**

Nagelkonus 15,0



Black  
Length: 7 cm

**Hole plug 29mm** **0.003 581891000**

Gesimsankerstopfen 29mm



Grey  
Diameter: 3 cm

**Zinc plug 15.0** **0.20 581889000**

Zinkstöpsel 15,0



Galvanised  
Length: 9.9 cm  
Diameter: 2.9 cm  
Tool: Spanner for 1/2" square head

**Stop anchor 15.0 11.5cm** **0.63 581868000**

Sperranker 15,0 11,5cm



Non-treated

**Stop anchor 15.0 16cm** **0.38 581997000**

Sperranker 15,0 16cm



Non-treated

[kg] Article n°

[kg] Article n°

**Stop anchor 15.0 40cm**

Sperranker 15,0 40cm

0.71 581999000

Non-treated

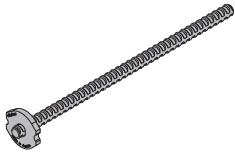
**Water stop 15.0 33cm**

Wassersperre 15,0

1.3 581817000

1.2 581819000

Non-treated

Length: 33 cm

Diameter: 7 cm

Custom lengths can be ordered under the special-component Art.n° 580100000, quoting the designation and the desired length in mm.

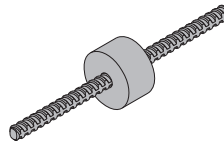
**Stop anchor double-ended 15.0 20cm**

Sperranker beidseitig 15,0 20cm

0.76 581820000

Non-treated

Custom lengths can be ordered under the special-component Art.n° 580100000, quoting the designation and the desired length in mm.

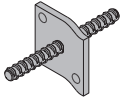
**Water stop G 15.0 33cm**

Wassersperre G 15,0 33cm

0.68 581818000

Non-treated

Length: 33 cm

Width: 12 cm

Height: 12 cm

Custom lengths can be ordered under the special-component Art.n° 580100000, quoting the designation and the desired length in mm.

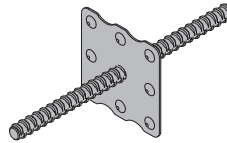
**Pigtail anchor 15.0**

Wellenanker 15,0

0.92 581984000

Non-treated

Length: 67 cm

**Fibre concrete plug 30.7mm**

Faserbetonstopfen

0.03 581902000

Fibre concrete plug 32mm

0.02 581830000

Fibre concrete plug 45mm

0.10 581438000

Fibre concrete plug 54mm

0.16 581955000

Grey

**Wall anchor 15.0 15cm**

Wandanker 15,0 15cm

1.5 581893000

Galvanised

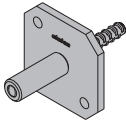
**Concrete cone 52mm**

Betonkegel 52mm

0.19 581939000

Grey

**Suspension cone 15.0 with collar**

Bund-Aufhängekegel 15,0

1.4 580428000

Galvanised

Length: 16 cm

Diameter: 6 cm

Follow fitting instructions!

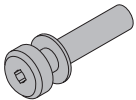
**Rod connector 15.0**

Verbindungsmuffe 15,0

0.49 581981000

Non-treated

Length: 11 cm

Diameter: 3 cm

**Rock anchor spreader unit 15.0**

Felsanker-Spreizeinheit 15,0

0.41 581120000

Galvanised

Length: 9 cm

Diameter: 4 cm

Follow fitting instructions!

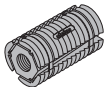
**Weldable coupler 15.0**

Anschweißmuffe 15,0

0.25 581691000

Non-treated

Length: 8 cm

Diameter: 3 cm

Safety instruction: Must not be welded with the tie-rod screwed in - risk of rod breakage!

**Rock anchor installation tube**

Felsanker-Einbaurohr

0.85 581123000

Galvanised

Length: 50 cm

Diameter: 3 cm

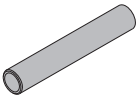
**Weldable coupler 15.0 for sheet wall**

Anschweißmuffe 15,0 für Spundwand

0.75 581693000

Non-treated

Length: 10 cm

Height: 13 cm

**Tensioning instrument 300kN**

Vorspanngerät 300kN

32.0 581815000

Galvanised

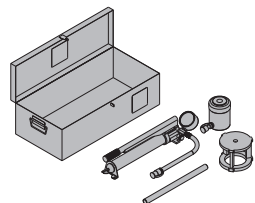
**Anchor cone 15.0**

Spannkegel 15,0

0.46 581967000

Yellow

Length: 11 cm

Diameter: 6 cm

**Plastic tube 22mm 2.50m**

Kunststoffrohr 22mm 2,50m

0.45 581951000

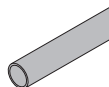
**Water stop connector 15.0**

Wasserstopp 15,0

0.52 581914000

Non-treated

Length: 12 cm

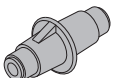

[kg] Article n°

[kg] Article n°

**Universal cone 22mm** 0.005 581995000

Universal-Konus 22mm

Grey  
Diameter: 4 cm**Clearance cone 15.0**

Freistellkonus 15,0

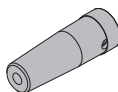
Black  
Blue  
Length: 20.6 cm  
Diameter: 7 cm  
Follow fitting instructions!

0.51 581865000

**Plug 22mm** 0.003 581953000

Verschlussstopfen 22mm



Grey

**Clearance-cone dismantling tool**

Lösewerkzeug Freistellkonus

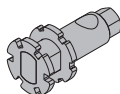
Galvanised  
Length: 10.7 cm  
Width-across: 24 mm

0.67 581864000

**Distance piece 20cm** 0.05 581907000

Distance piece 25cm 0.09 581908000

Distance piece 30cm 0.10 581909000

Distanzhalter

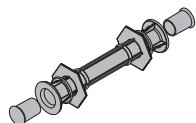

Grey

**Positioning cone spanner 15.0 DK**

Vorlaufschlüssel 15,0 DK

Galvanised  
Length: 8 cm  
Width-across: 30 mm

0.30 580579000

**Fibre concrete tube 22mm 0.18m** 0.28 581904000**Fibre concrete tube 22mm 0.23m** 0.36 581905000**Fibre concrete tube 22mm 0.28m** 0.44 581906000**Fibre concrete tube 22mm 0.38m** 0.61 581903000**Fibre concrete tube 22mm 1.25m** 1.9 581991000

Faserbetonrohr 22mm

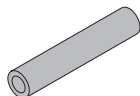
**Universal cone spanner 15.0/20.0**

Universal-Konusschlüssel 15,0/20,0

Galvanised  
Length: 9 cm  
Width-across: 50 mm

0.90 581448000

**Fibre concrete plug 22mm** 0.02 581992000

Faserbetonstopfen 22mm

**Tie rod wrench 15.0/20.0**

Ankerstabschlüssel 15,0/20,0

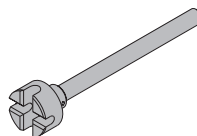
Galvanised  
Length: 37 cm  
Diameter: 8 cm

1.9 580594000

**REPOXAL two component adhesive** 1.2 581993000

REPOXAL-Zweikomponenten Kleber

**Friction type ratchet SW27**

Freilaufknarre SW27

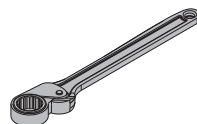
manganese-phosphated  
Length: 30 cm

0.49 581855000

**Reducer 26/22mm** 0.01 581853000

Reduzierstück 26/22mm



Black

**Box spanner 27 0.65m**

Steckschlüssel 27 0,65m

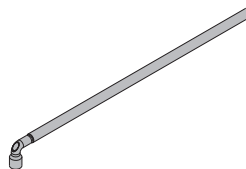

Galvanised

1.9 581854000

**Form-ply protector 22mm** 0.25 580219000

Schalhautschutz 22mm

Galvanised  
Width-across: 46 mm**Form-tie load read-off device 300kN**

Ankerlastanzeigergerät 300kN

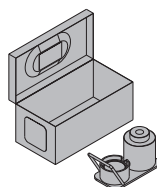

Galvanised

12.8 581834500

**Form-ply protector 32mm** 0.38 580220000

Schalhautschutz 32mm

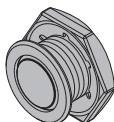

Width-across: 70 mm

**Anchor holder 15.0** 0.43 581835000

Ankerhalter 15,0

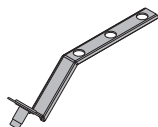

Non-treated

**Tie rod system 20.0**

Tie rod 20.0mm galvanised 0.50m	1.3	581411000
Tie rod 20.0mm galvanised 0.75m	1.9	581417000
Tie rod 20.0mm galvanised 1.00m	2.5	581412000
Tie rod 20.0mm galvanised 1.25m	3.2	581418000
Tie rod 20.0mm galvanised 1.50m	3.8	581413000
Tie rod 20.0mm galvanised 2.00m	5.0	581414000
Tie rod 20.0mm galvanised .....m	2.5	581410000
Tie rod 20.0mm non-treated 0.50m	1.3	581405000
Tie rod 20.0mm non-treated 0.75m	1.9	581416000
Tie rod 20.0mm non-treated 1.00m	2.5	581406000
Tie rod 20.0mm non-treated 1.50m	3.8	581407000
Tie rod 20.0mm non-treated 2.00m	5.0	581408000
Tie rod 20.0mm non-treated .....m	2.5	581403000

Ankerstab 20,0mm

**Wing nut 20.0**

Flügelmutter 20,0

0.47 581466000

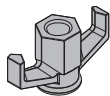

Galvanised  
Length: 11 cm  
Height: 6 cm  
Width-across: 36 mm

**Hexagon nut 20.0**

Sechskantmutter 20,0

0.60 581420000



Galvanised  
Length: 7 cm  
Width-across: 41 mm

**Anchor plate 20.0 12/12**

Ankerplatte 20,0 12/12

1.7 581425000

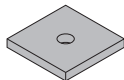

Galvanised

**Super plate 20.0 B**

Superplatte 20,0 B

2.0 581424000

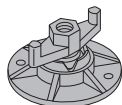

Galvanised  
Height: 7 cm  
Diameter: 14 cm  
Width-across: 34 mm

**Framax combination nut 20.0**

Framax-Kombimutter 20,0

6.1 588683000

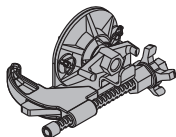

Galvanised  
Width: 27 cm

**Framax form-tie nut 20.0**

Framax-Ankermutter 20,0

3.6 588687000

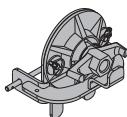

Galvanised  
Width: 19 cm

**Top100 tec form-tie nut 20.0**

Top100 tec-Ankermutter 20,0

4.8 586934000

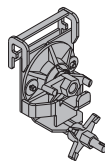

Galvanised  
Height: 25 cm

**Quick-release nut 20.0**

Lösemutter 20,0

5.9 581428000

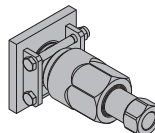

Galvanised  
Length: 22 cm  
Follow fitting instructions!

**She-bolt 20.0**

Ankerkopf 20,0

5.6 581435000



Galvanised  
Length: 140 cm  
Diameter: 5 cm  
Width-across: 41 mm

**Anchoring cone 20.0**

Ankerkonus 20,0

1.0 581437000

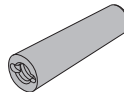

Galvanised  
Length: 15 cm  
Diameter: 5 cm  
Tool: Cone spanner 20.0

**Sealing sleeve 20.0**

Dichtungshülse 20,0

0.03 581441000

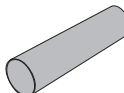

Grey  
Length: 16 cm  
Diameter: 5 cm

**Water stop connector 20.0**

Wasserstopp 20,0

1.3 581467000

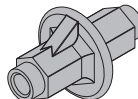

Non-treated  
Length: 14 cm

**Water stop 20.0 33cm**

Wassersperre 20,0 33cm

1.7 581426000

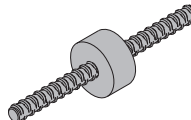

Non-treated  
Length: 33 cm  
Diameter: 8 cm  
Custom lengths can be ordered under the special-component Art.n° 580100000, quoting the designation and the desired length in mm.

**Universal climbing cone 20.0**

Universal-Kletterkonus 20,0

1.2 581442000

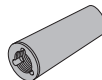

Galvanised  
Length: 13 cm  
Diameter: 5 cm  
Tool: Spanner for universal climbing cone 15.0/20.0





**Cone screw B 7cm**

Konusschraube B 7cm

0.86 581444000

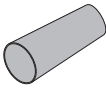

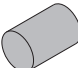
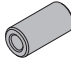
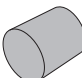
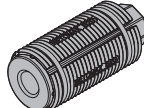
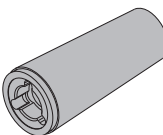
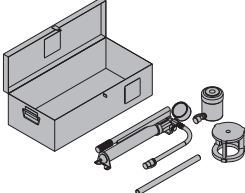
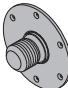
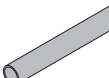
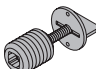
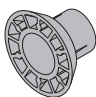
red  
Length: 10 cm  
Diameter: 7 cm  
Width-across: 50 mm

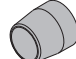
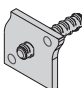
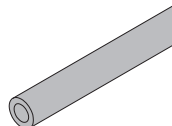
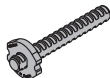
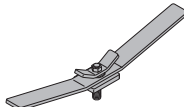
	[kg]	Article n°		[kg]	Article n°
<b>Sealing sleeve K 20.0</b> Dichtungshülse K 20,0  yellow-green Length: 12 cm Diameter: 6 cm	0.03	581443000	<b>Stop anchor 20.0 40cm</b> Sperranker 20,0 40cm  Non-treated	1.2	581458000
<b>Fibre concrete plug 27mm</b> <b>Fibre concrete plug 35mm</b> <b>Fibre concrete plug 40mm</b> Faserbetonstopfen  Grey	0.03 0.11 0.14	581473000 588923000 588924000	<b>Weldable coupler 20.0</b> Anschweißmuffe 20,0  Non-treated Length: 8 cm Diameter: 4 cm Follow fitting instructions!	0.55	581474000
<b>Concrete cone 52mm</b> Betonkonus 52mm  Grey	0.19	581939000	<b>Rock anchor spreader unit 20.0</b> Felsanker-Spreizeinheit 20,0  Galvanised Length: 11.9 cm Diameter: 5.7 cm Follow fitting instructions!	1.3	581468000
<b>Fair-faced concrete positioning cone MF 20.0</b> Sichtbetonvorlauf MF 20,0  Galvanised Length: 12.6 cm Diameter: 5.3 cm Tool: Spanner for universal climbing cone 15.0/20.0	1.3	581469000	<b>Tensioning instrument 300kN</b> Vorspanngerät 300kN  Galvanised	32.0	581815000
<b>Positioning disk M30</b> Vorlaufscheibe M30  Galvanised Diameter: 9 cm	0.25	581975000	<b>Plastic tube 26mm 2.00m</b> Kunststoffrohr 26mm 2,00m 	0.59	581463000
<b>Positioning clamp M30</b> Vorlaufklemme M30  Galvanised Diameter: 4 cm	0.19	581833000	<b>Universal cone 26mm</b> Universal-Konus 26mm  Grey Diameter: 5 cm	0.008	581464000
<b>Pigtail anchor 20.0</b> Wellenanker 20,0  Non-treated Length: 76 cm	2.0	581450000	<b>Plug 26mm</b> Verschlussstopfen 26mm  Grey	0.006	581465000
<b>Stop anchor 20.0 11.5cm</b> Sperranker 20,0 11,5cm  Non-treated	0.88	581456000	<b>Fibre concrete tube 27mm 1.25m</b> Faserbetonrohr 27mm 1,25m 	2.6	581472000
<b>Stop anchor 20.0 17.5cm</b> Sperranker 20,0 17,5cm  Non-treated	0.62	581457000	<b>Cone spanner 20.0</b> Konusschlüssel 20,0  Galvanised Length: 57 cm	3.5	581471000

[kg] Article n°

[kg] Article n°

**Tie rod wrench 15.0/20.0**

Ankerstabschlüssel 15,0/20,0

1.9 580594000

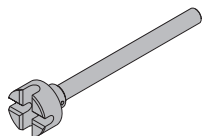
Galvanised  
Length: 37 cm  
Diameter: 8 cm**Hexagon nut 26.5**

Sechskantmutter 26,5

0.73 581985000

Galvanised  
Length: 8 cm  
Width-across: 46 mm**DIN**  
18216**Universal cone spanner 15.0/20.0**

Universal-Konusschlüssel 15,0/20,0

0.90 581448000

Galvanised  
Length: 9 cm  
Width-across: 50 mm**Anchor plate 26.5**

Ankerplatte 26,5

3.4 581986000

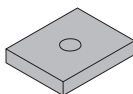
Galvanised  
Length: 15 cm  
Width: 12 cm**DIN**  
18216**Slugging ring spanner 70**

Schlag-Ringschlüssel 70

2.6 581429000

Length: 32 cm

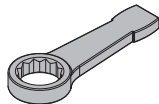
**Universal climbing cone 26.5**

Universal-Kletterkonus 26,5

1.1 581987000

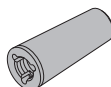
Galvanised  
Length: 12.6 cm  
Diameter: 5 cm  
Tool: Spanner for universal climbing cone 15.0/20.0**Anchor holder 20.0**

Ankerhalter 20,0

0.43 581427000

Non-treated

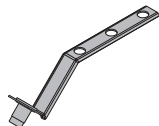
**Cone screw B 7cm**

Konusschraube B 7cm

0.86 581444000

red  
Length: 10 cm  
Diameter: 7 cm  
Width-across: 50 mm**Sealing sleeve K 26.5**

Dichtungshülse K 26,5

0.02 581998000

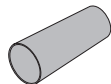
light blue  
Length: 12 cm  
Diameter: 6 cm**Clearance cone 20.0**

Freistellkonus 20,0

0.49 581866000

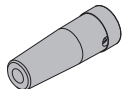
Black  
Yellow  
Length: 20.6 cm  
Diameter: 7 cm  
Follow fitting instructions!**Rod connector 26.5**

Verbindungsmuffe 26,5

1.4 581988000

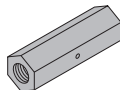
Non-treated  
Length: 15 cm  
Width-across: 46 mm**DIN**  
18216**Clearance-cone dismantling tool**

Lösewerkzeug Freistellkonus

0.67 581864000

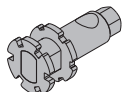
Galvanised  
Length: 10.7 cm  
Width-across: 24 mm**Pigtail anchor 26.5**

Wellenanker 26,5

3.6 581900000

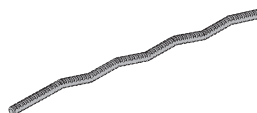
Non-treated  
Length: 80 cm**Form-tie load read-off device 300kN**

Ankerlastanzeigergerät 300kN

12.8 581834500

Galvanised

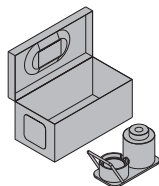
**Plastic tube 32mm 2.00m**

Kunststoffrohr 32mm 2,00m

0.60 581460000

Diameter: 4 cm

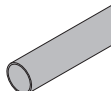
**Tie rod system 26.5****Tie rod 26.5mm non-treated .....m**

Ankerstab 26,5mm unbehandelt .....m

4.5 581883000

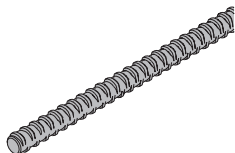
**DIN**  
18216**Universal cone 32mm**

Universal-Konus 32mm

0.008 581461000

Grey  
Diameter: 5 cm**Universal cone spanner 15.0/20.0**

Universal-Konusschlüssel 15,0/20,0

0.90 581448000

Galvanised  
Length: 9 cm  
Width-across: 50 mm

[kg] Article n°

[kg] Article n°

**Concrete cone 52mm**

Betonkonus 52mm

0.19 581939000



Grey

**Square spanner 32.0**

Vierkantschlüssel 32,0

5.3 582918000

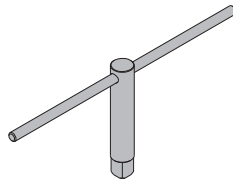

Galvanised  
Length: 59 cm

**Tie rod wrench 20.0/26.5**

Ankerstabschlüssel 20,0/26,5

1.7 580593000

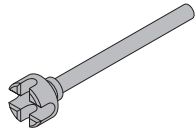

Galvanised  
Length: 37 cm  
Diameter: 8 cm

**Anchor holder 26.5**

Ankerhalter 26,5

0.43 581943000

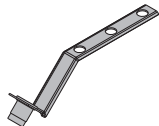

Non-treated

**Clearance cone 26.5**

Freistellkonus 26,5

0.46 581867000

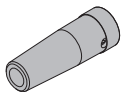

Black  
Grey  
Length: 20.6 cm  
Diameter: 7 cm  
Follow fitting instructions!

**Clearance-cone dismantling tool**

Lösewerkzeug Freistellkonus

0.67 581864000

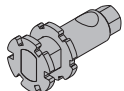

Galvanised  
Length: 10.7 cm  
Width-across: 24 mm

**Tie rod system 32.0**

**Tie rod 32.0mm non-treated .....m**

Ankerstab 32,0mm unbehandelt .....m

6.5 582914000

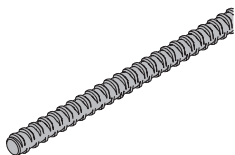

**Hexagon nut 32.0**

Sechskantmutter 32,0

1.8 582915000



Non-treated  
Length: 9 cm  
Width-across: 55 mm

**Anchor plate 32.0**

Ankerplatte 32,0

4.1 582916000

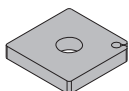

Non-treated  
Length: 15 cm  
Width: 15 cm

**Anchoring cone 32.0**

Ankerkonus 32,0

7.7 582917000

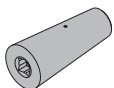

Galvanised  
Length: 22.5 cm  
Diameter: 10 cm