

[kg] Article n°

[kg] Article n°

Multi-purpose waling WS10 Top50 0.50m	10.2	580001000
Multi-purpose waling WS10 Top50 0.75m	14.9	580002000
Multi-purpose waling WS10 Top50 1.00m	19.6	580003000
Multi-purpose waling WS10 Top50 1.25m	24.7	580004000
Multi-purpose waling WS10 Top50 1.50m	29.7	580005000
Multi-purpose waling WS10 Top50 1.75m	35.0	580006000
Multi-purpose waling WS10 Top50 2.00m	38.9	580007000
Multi-purpose waling WS10 Top50 2.25m	44.2	580008000
Multi-purpose waling WS10 Top50 2.50m	48.7	580009000
Multi-purpose waling WS10 Top50 2.75m	54.2	580010000
Multi-purpose waling WS10 Top50 3.00m	60.2	580011000
Multi-purpose waling WS10 Top50 3.50m	68.4	580012000
Multi-purpose waling WS10 Top50 4.00m	79.4	580013000
Multi-purpose waling WS10 Top50 4.50m	89.1	580014000
Multi-purpose waling WS10 Top50 5.00m	102.0	580015000
Multi-purpose waling WS10 Top50 5.50m	112.4	580016000
Multi-purpose waling WS10 Top50 6.00m	118.0	580017000
Mehrzweckriegel WS10 Top50		

Painted blue

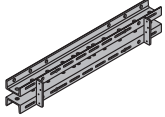

Shaft corner waling WS10 Top50m	20.5	580069000
Eckwandriegel WS10 Top50m		

Painted blue

Project-specific!

Also available in profiles of thickness U120 (Order designation: WU12).

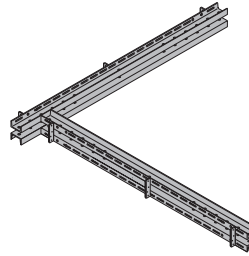

Multi-purpose waling WU12 Top50 1.00m	25.3	580018000
Multi-purpose waling WU12 Top50 1.25m	32.0	580019000
Multi-purpose waling WU12 Top50 1.50m	37.5	580020000
Multi-purpose waling WU12 Top50 1.75m	44.2	580021000
Multi-purpose waling WU12 Top50 2.00m	50.0	580022000
Multi-purpose waling WU12 Top50 2.50m	63.1	580023000
Multi-purpose waling WU12 Top50 3.00m	75.7	580024000
Multi-purpose waling WU12 Top50 3.50m	90.7	580025000
Multi-purpose waling WU12 Top50 4.00m	103.4	580026000
Mehrzweckriegel WU12 Top50		

Painted blue

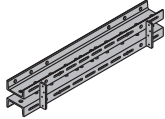

Flange clamp H20	1.0	580135000
Flanschklammer H20		

Galvanised

Width: 13 cm

Width-across: 19 mm

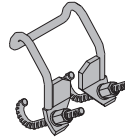

Flange clamp G	1.1	580120000
Flanschklammer G		

Galvanised

Width: 13 cm

Width-across: 19 mm



Multi-purpose waling SL-1 WU16 0.625m	24.0	582875000
Multi-purpose waling SL-1 WU16 0.75m	26.5	582876000
Multi-purpose waling SL-1 WU16 1.00m	35.0	582877000
Multi-purpose waling SL-1 WU16 1.25m	44.5	582878000
Multi-purpose waling SL-1 WU16 1.50m	53.0	582879000
Multi-purpose waling SL-1 WU16 1.75m	67.0	582880000
Multi-purpose waling SL-1 WU16 2.00m	72.1	582881000
Multi-purpose waling SL-1 WU16 2.25m	86.0	582882000
Multi-purpose waling SL-1 WU16 2.50m	89.9	582883000
Multi-purpose waling SL-1 WU16 3.00m	107.0	582888000
Mehrzweckriegel SL-1		

Painted blue

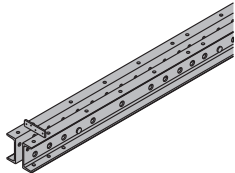

Flange claw	1.0	580137000
Flanschkralle		

Galvanised

Width: 17 cm

Width-across: 19 mm

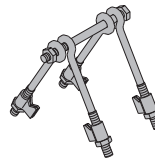

Waling clamp H20	0.22	580114000
Riegelklammer H20		

Galvanised

Width: 8 cm

Width-across: 13 mm



Corner waling 20	23.5	580031000
Eckriegel 20		

Painted blue

Leg length: 52 cm

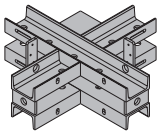

Beam screw S 8/60	0.06	580116000
Riegelverschraubung S 8/60		

Galvanised

Length: 7 cm

Width-across: 13 mm



Beam screw H 8/70	0.06	580117000
Riegelverschraubung H 8/70		

Galvanised

Length: 8 cm

Width-across: 13 mm



[kg] Article n°

[kg] Article n°

Fastening plate

Anschraublasche

2.7 580110000

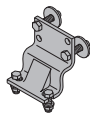

Painted blue
Width: 13 cm
Height: 15 cm

Beam clamp Top50

Trägerklammer Top50

1.2 580081000

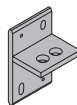

Painted blue
Height: 15 cm

Protective cap H20

Stirnschuh H20

0.36 587248000

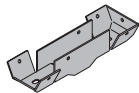

Galvanised
Length: 20 cm
Width: 7 cm

Anchoring plate FF20/50

Ankerungslasche FF20/50

6.6 587531000

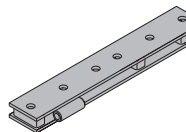

Painted blue
Length: 55 cm

Lifting bracket

Kranöse

6.2 580460000



Galvanised
Height: 59 cm

Half splice plate

Halblasche

5.2 580267000

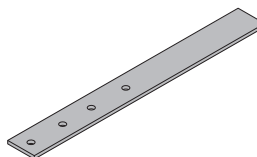

Painted blue
Length: 78 cm

Splice plate Top50 Z

Verbindungslasche Top50 Z

8.5 580074000

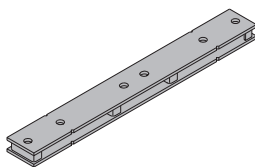

Painted blue
Length: 76 cm

Splice plate with join adjustment

Verbindungslasche mit Fugenjustierung

13.8 580215000

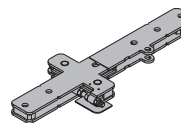

Painted blue
Length: 76 cm

Formwork element connector FF20/50

Elementverbinder FF20/50

6.3 587530000

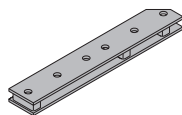

Painted blue
Length: 55 cm

Offset plate FF20

Versatzlasche FF20

6.2 587534000

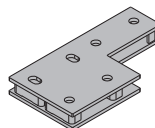

Painted blue
Length: 35 cm
Width: 18 cm
Height: 4 cm

Formwork element connector FF20/50 Z

Elementverbinder FF20/50 Z

6.0 587533000

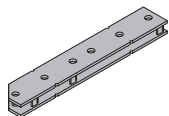

Painted blue
Length: 55 cm

Internal angle plate H20 Top50

Innenecklasche H20 Top50

11.3 580035000

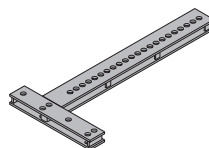

Painted blue
Length: 80 cm
Width: 38 cm

Adjustable waling extension 1.40m Top50

Ausgleichslasche 1,40m Top50

15.0 580075000

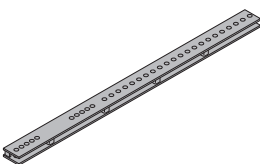

Painted blue

Corner plate H20/H36 Top50

Ecklasche H20/H36 Top50

10.0 580078000

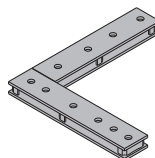

Painted blue
Length: 49.7 cm
Width: 45.1 cm

Adjustable waling extension FF20/50

Ausgleichslasche FF20/50

9.1 587532000

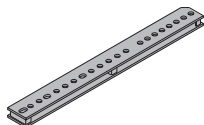

Painted blue
Length: 87 cm

Shaft waling squaring plate

Verschiebelasche

9.6 580262000

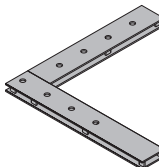

Painted blue
Leg length: 60 cm

[kg] Article n°

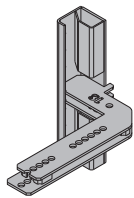
Transition plate 18mm
Transition plate 21mm
Übergangslasche**16.0 588654000**
15.8 588656000Painted blue
Length: 54 cm
Width: 30 cm
Height: 51 cm**Lifting bracket for column formwork****[kg] Article n°**

Kranöse für Stützenschalung

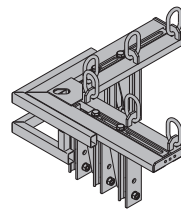
Galvanised, powder-coated
Length: 85 cm
Width: 85 cm**Waling connector SL-1 WU16 0.75m**

Riegelverbinder SL-1 WU16 0,75m

31.0 582886000**Articulated conn. plate A Top50 degrees**

Gelenklasche A Top50 Grad

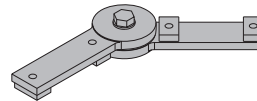
20.0 580208000Galvanised
Length: 75 cmGalvanised
Leg length: 36 cm**Corner spindle**

Eckspindel

17.5 580264000**Swivel joint plate**

Drehgelenklasche

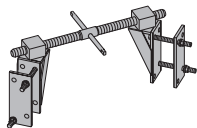
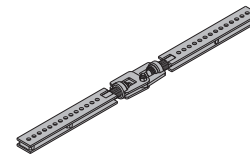
20.0 587542000Galvanised
Length: 65 cm
Height: 31 cmGalvanised
Length: 155 cm**Corner connecting plate 90/50**

Winkellasche 90/50

13.8 580603000**Connecting pin 10cm**

Verbindungsbolzen 10cm

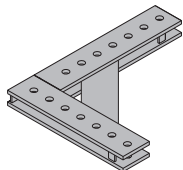
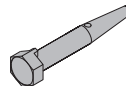
0.34 580201000Painted blue
Length: 51 cm
Width: 40 cmGalvanised
Length: 14 cm**Universal angle tie bracket**

Universal-Winkelspanner

4.4 580604000**Connecting pin 25cm**

Verbindungsbolzen 25cm

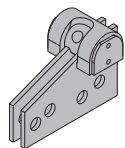
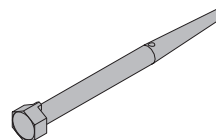
0.58 580202000Painted blue
Length: 20 cmGalvanised
Length: 25 cm**Angle tie bracket 20.0 SL-1 WU16**

Winkelspanner 20,0 SL-1 WU16

8.1 587543000**Spring cotter 5mm**

Federvorstecker 5mm

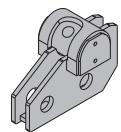
0.05 580204000Painted blue
Length: 24 cmGalvanised
Length: 13 cm**Column connecting plate 6/8**

Stützenlasche 6/8

15.0 580072000**Stacking plate H20**

Aufstocklasche H20

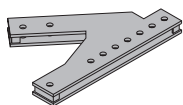
8.3 580310000Painted blue
Length: 58 cmGalvanised
Length: 68.8 cm

	[kg]	Article n°
Inside corner plate 3.00m	53.0	580282000
Inside corner plate 4.00m	69.0	580284000
Eckschiene		

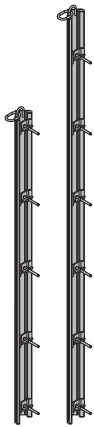

Powder-coated, blue

	[kg]	Article n°
Panel strut 340 IB	24.3	580365000
Elementstütze 340 IB		
consisting of:		
(A) Plumbing strut 340 IB	16.7	588696000
Galvanised		
Length: 190.8 - 341.8 cm		
(B) Adjusting strut 120 IB	7.6	588248500
Galvanised		
Length: 81.5 - 130.6 cm		

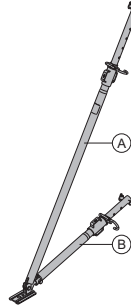

Galvanised
Delivery condition: folded closed

Joint plate 3.00m	36.8	580332000
Joint plate 4.00m	51.2	580334000
Ausgleichsschiene		

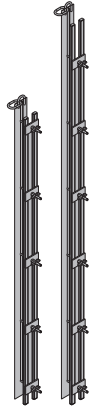

Powder-coated, blue

Panel strut 540 IB	41.4	580366000
Elementstütze 540 IB		
consisting of:		
(A) Plumbing strut 540 IB	30.7	588697000
Galvanised		
Length: 310.5 - 549.2 cm		
(B) Adjusting strut 220 IB	10.9	588251500
Galvanised		
Length: 172.5 - 221.1 cm		

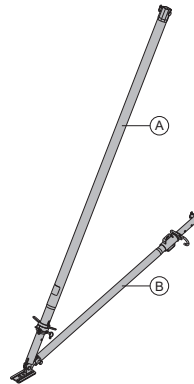

Galvanised
Delivery condition: folded closed

T ledge 21/42 2.00m	0.34	580196000
T-Leiste 21/42 2,00m		



Grey

Box-out clamp 24cm	3.3	580063000
Box-out clamp 25cm	3.4	580064000
Box-out clamp 30cm	3.8	580065000
Aussparungsklemme		

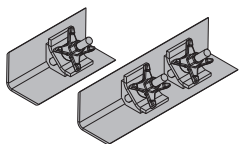

Galvanised
Leg length: 10 cm

Box-out clamp type 1cm	13.6	580066000
Box-out clamp type 2cm	15.0	580067000
Aussparungsklemmecm		

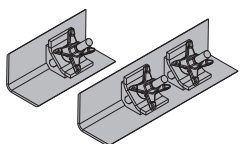

Painted blue
Leg length: 10 cm

Eurex 60 550

Eurex 60 550

depending on length, comprising:

- (A) **Plumbing strut Eurex 60 550** **42.5 582658000**
Powder-coated, blue
Aluminium
Length: 343 - 553 cm
- (B) **Extension Eurex 60 2.00m** **21.3 582651000**
Powder-coated, blue
Aluminium
Length: 250 cm
- (C) **Coupler Eurex 60** **8.6 582652000**
Aluminium
Length: 100 cm
Diameter: 12.8 cm
- (D) **Connector Eurex 60 IB** **4.2 582657500**
Galvanised
Length: 15 cm
Width: 15 cm
Height: 30 cm
- (E) **Plumbing strut shoe Eurex 60 EB** **8.0 582660500**
Galvanised
Length: 31 cm
Width: 12 cm
Height: 33 cm
- (F) **Adjusting strut 540 Eurex 60 IB** **27.8 582659500**
Galvanised
Length: 303.5 - 542.2 cm

Delivery condition: separate parts

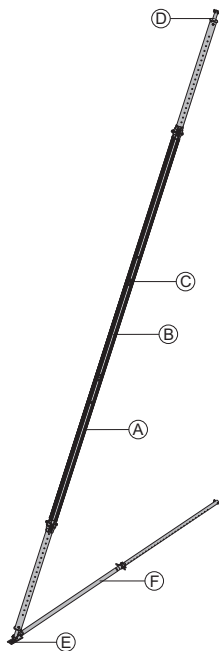
**Prop head EB**

Stützenkopf EB

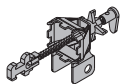
3.1 588244500Galvanised
Length: 40.8 cm
Width: 11.8 cm
Height: 17.6 cm**Prop head Eurex 60 Top50**

Stützenkopf Eurex 60 Top50

7.1 582665000Galvanised
Height: 50 cm**Universal dismantling tool**

Universal-Lösewerkzeug

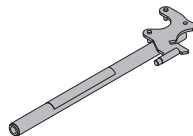
3.7 582768000Galvanised
Length: 75.5 cm**Doka express anchor 16x125mm**

Doka-Expressanker 16x125mm

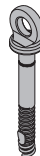
0.31 588631000Galvanised
Length: 18 cm
Follow fitting instructions!**Doka coil 16mm**

Doka-Coil 16mm

0.009 588633000Galvanised
Diameter: 1.6 cm**Universal bracket 60**

Universal-Konsole 60

14.0 580477000Galvanised
Length: 86 cm
Height: 181 cm**Universal bracket 90**

Universal-Konsole 90

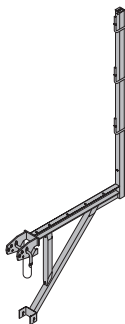
30.4 580476000Galvanised
Length: 121 cm
Height: 235 cm**Top scaffold bracket L**

Betonierkonsole L

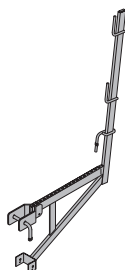
12.6 587153500Galvanised
Length: 101 cm
Height: 159 cm

Bracket planking 60/250m	48.7	583029000
Bracket planking 90/250m	61.0	583031000

Konsolenbelag

Steel parts galvanised
Timber parts varnished yellow
(not illustrated)

Bracket railing 240-270cm	20.2	583032000
----------------------------------	-------------	------------------

Konsolengeländer 240-270cm

Galvanised
(not illustrated)

Universal railing shackle	3.0	580478000
----------------------------------	------------	------------------

Universal-Geländerbügel



Galvanised
Height: 20 cm

Scaffold tube connection	0.27	584375000
---------------------------------	-------------	------------------

Gerüstrohranschluss



Galvanised
Height: 7 cm

Scaffold tube 48.3mm 0.50m	1.7	682026000
-----------------------------------	------------	------------------

Scaffold tube 48.3mm 1.00m

Scaffold tube 48.3mm 1.50m	3.6	682014000
-----------------------------------	------------	------------------

Scaffold tube 48.3mm 2.00m

Scaffold tube 48.3mm 2.50m	5.4	682015000
-----------------------------------	------------	------------------

Scaffold tube 48.3mm 3.00m

Scaffold tube 48.3mm 3.50m	7.2	682016000
-----------------------------------	------------	------------------

Scaffold tube 48.3mm 4.00m

Scaffold tube 48.3mm 4.50m	9.0	682017000
-----------------------------------	------------	------------------

Scaffold tube 48.3mm 5.00m

Scaffold tube 48.3mm 5.50m	10.8	682018000
-----------------------------------	-------------	------------------

Scaffold tube 48.3mm 6.00m

Scaffold tube 48.3mm 6.00m	12.6	682019000
-----------------------------------	-------------	------------------

Scaffold tube 48.3mmm

Scaffold tube 48.3mmm	14.4	682021000
------------------------------------	-------------	------------------

Gerüstrohr 48,3mm

Scaffold tube 48.3mmm	16.2	682022000
------------------------------------	-------------	------------------

Scaffold tube 48.3mmm	18.0	682023000
------------------------------------	-------------	------------------

Scaffold tube 48.3mmm	19.8	682024000
------------------------------------	-------------	------------------

Scaffold tube 48.3mmm	21.6	682025000
------------------------------------	-------------	------------------

Scaffold tube 48.3mmm	3.6	682001000
------------------------------------	------------	------------------

Galvanised

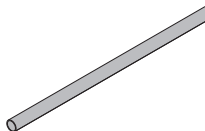

Screw-on coupler 48mm 50	0.84	682002000
---------------------------------	-------------	------------------

Anschraubkupplung 48mm 50



Galvanised
Width-across: 22 mm

Framax pouring platform U 1.25/2.70m	127.5	588377000
---	--------------	------------------

Framax-Betonierbühne U 1,25/2,70m

Steel parts galvanised
Timber parts varnished yellow
Delivery condition: folded closed

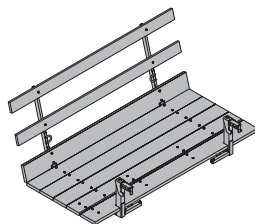

Top50 adapter for Framax pouring platform U	18.5	588384000
--	-------------	------------------

Top50-Adapter für Framax-Betonierbühne U

Galvanised
Width: 75 cm
Height: 134 cm

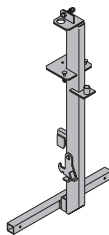

Side handrail clamping unit T	29.1	580488000
--------------------------------------	-------------	------------------

Seitenschutzgeländer T

Galvanised
Length: 115 - 175 cm
Height: 112 cm

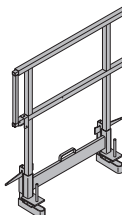

Scaffold tube connection	0.27	584375000
---------------------------------	-------------	------------------

Gerüstrohranschluss



Galvanised
Height: 7 cm

Scaffold tube 48.3mm 0.50m	1.7	682026000
-----------------------------------	------------	------------------

Scaffold tube 48.3mm 1.00m

Scaffold tube 48.3mm 1.50m	3.6	682014000
-----------------------------------	------------	------------------

Scaffold tube 48.3mm 2.00m

Scaffold tube 48.3mm 2.50m	5.4	682015000
-----------------------------------	------------	------------------

Scaffold tube 48.3mm 3.00m

Scaffold tube 48.3mm 3.50m	7.2	682016000
-----------------------------------	------------	------------------

Scaffold tube 48.3mm 4.00m

Scaffold tube 48.3mm 4.50m	9.0	682017000
-----------------------------------	------------	------------------

Scaffold tube 48.3mm 5.00m

Scaffold tube 48.3mm 5.50m	10.8	682018000
-----------------------------------	-------------	------------------

Scaffold tube 48.3mm 6.00m

Scaffold tube 48.3mm 6.00m	12.6	682019000
-----------------------------------	-------------	------------------

Scaffold tube 48.3mmm

Scaffold tube 48.3mmm	14.4	682021000
------------------------------------	-------------	------------------

Gerüstrohr 48,3mm

Scaffold tube 48.3mmm	16.2	682022000
------------------------------------	-------------	------------------

Scaffold tube 48.3mmm	18.0	682023000
------------------------------------	-------------	------------------

Scaffold tube 48.3mmm	19.8	682024000
------------------------------------	-------------	------------------

Scaffold tube 48.3mmm	21.6	682025000
------------------------------------	-------------	------------------

Scaffold tube 48.3mmm	3.6	682001000
------------------------------------	------------	------------------

Galvanised

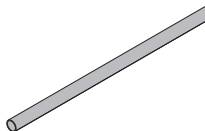

Screw-on coupler 48mm 50	0.84	682002000
---------------------------------	-------------	------------------

Anschraubkupplung 48mm 50



Galvanised
Width-across: 22 mm

Handrail post T 1.80m	17.7	584373000
------------------------------	-------------	------------------

Einschubgeländer T 1,80m

Galvanised

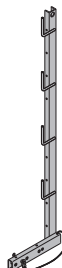

Toeboard holder T 1.80m	0.53	584392000
--------------------------------	-------------	------------------

Fußwehrhalter T 1,80m

Galvanised
Height: 13.5 cm



Screw-on coupler 48mm 50	0.84	682002000
---------------------------------	-------------	------------------

Anschraubkupplung 48mm 50



Galvanised
Width-across: 22 mm

Handrail post 1.50m	12.4	582754000
----------------------------	-------------	------------------

Geländer 1,50m

Galvanised



Doka 4-part chain 3.20m	15.0	588620000
--------------------------------	-------------	------------------

Doka-Vierstrangkette 3,20m

Follow the directions in the "Operating Instructions"!

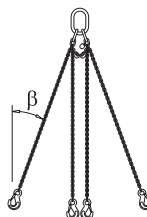

CE

[kg] Article n°

Universal strut T5/5mm

Strebe T5/5mm

6.5 584311000

Painted blue
Weight per linear metre



Spindle strut T10 350/400cm

Spindle strut T10mm

57.5 584328000

16.9 584391000

Spindelstrebe T10

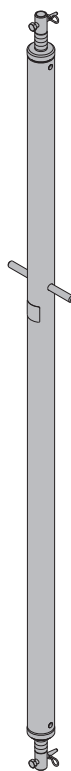

Spindle strut GS T5 65/101cm

Spindelstrebe GS T5 65/101cm

9.1 584356000

Galvanised

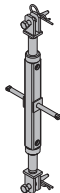

Spindle strut T6 73/110cm

Spindle strut T6 100/150cm

10.2 584355000

12.5 584323000

Spindelstrebe T6

Galvanised

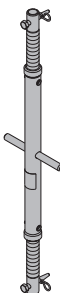

Universal spindle foot T8

Universal-Spindelfuß T8

8.6 584314000

Painted blue
Galvanised
Height: 30 cm

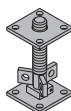

Spindle strut GS T6 95/140cm

Spindelstrebe GS T6 95/140cm

10.3 584340000

Galvanised



Height adjuster for formwork beams

Höhenjustierung für Schalungsträger

11.9 580218000

Galvanised
Height: 46 cm

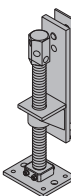

Spindle strut T7 75/110cm

Spindle strut T7 100/150cm

13.2 584308000

16.8 584309000

Spindle strut T7 150/200cm

21.6 584324000

Spindle strut T7 200/250cm

26.2 584325000

Spindle strut T7 250/300cm

29.4 584326000

Spindle strut T7 305/355cm

35.0 584327000

Spindelstrebe T7

Galvanised

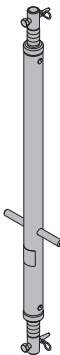

Height adjuster WS10-WU16

Höhenjustierung WS10-WU16

10.1 580206500

Galvanised
Height: 45 cm

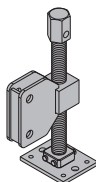

Adjusting spindle M36

Höhenjustierspindel M36

6.2 500663002

Galvanised
Length: 31 cm
Height: 29.2 cm



[kg] Article n°

[kg] Article n°

Suspension head WS10

Aufhängekopf WS10

8.1 580449000

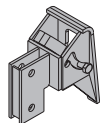

Galvanised
Length: 21 cm
Width: 18 cm
Height: 23 cm

Assembly angle Top50

Montagelasche Top50

6.7 580082000

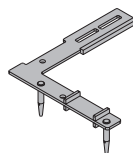

Galvanised
Length: 53.2 cm
Width: 48.6 cm

Universal support Top50mm

Tragwerklasche Top50mm

11.1 584312000

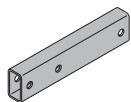

Painted blue
Weight per linear metre

Strip tensioner B 5.00m

Bandzwinne B 5,00m

3.5 580394000

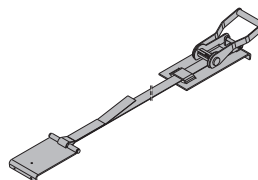

Galvanised

Adjusting plate T

Justierlasche T

6.5 584393000



Painted blue
Length: 23.5 cm

Positioning railm

Führungsschienem

1.8 580079000

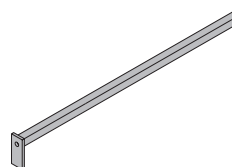

Painted blue
Weight per linear metre

Tool box GF

GF-Werkzeugbox

6.5 580390000

included in scope of supply:

(A) Reversible ratchet 1/2"

Galvanised
Length: 30 cm

0.73 580580000

(B) Fork wrench 13/17

0.08 580577000

(C) Fork wrench 22/24

0.22 580587000

(D) Fork wrench 30/32

0.80 580897000

(E) Ring spanner 17/19

0.27 580590000

(F) Extension 11cm 1/2"

0.20 580581000

(G) Extension 22cm 1/2"

0.31 580582000

(H) Universal joint coupling

0.16 580583000

(I) Box nut 19 1/2" L

0.16 580598000

(J) Box nut 13 1/2"

0.06 580576000

(K) Box nut 24 1/2"

0.12 580584000

(L) Box nut 30 1/2"

0.20 580575000

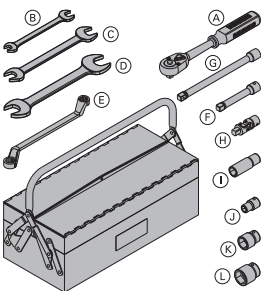
**Hole gauge Top50**

Bohrplatte Top50

2.9 580080000

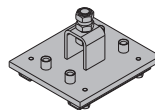

Painted blue
Length: 17 cm
Width: 15 cm
Tool: Drill bit (diameter 10 mm)

Angle connector 9x5cm

Winkerverbinder 9x5cm

0.22 580381000

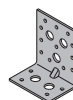

Galvanised

Rafter plate right

Sparrenpfettenanker

0.09 582521000

0.09 582522000



Galvanised
Length: 17 cm

Filler neck GF SCC

GF-Füllstützen SCC

39.0 580217000

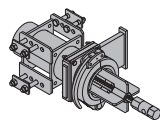

Galvanised
Length: 66 cm

H20 screw-on bracket for formwork sheets

Schalhaut-Schraubwinkel H20

0.19 586256000

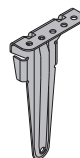

Galvanised
Height: 19.2 cm

Panel closure tool D125 SCC

Sperrschieber D125 SCC

18.0 588127000

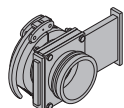

Galvanised
Length: 18 cm
Width: 33 cm
Height: 27 cm

Double scraper Xlife 100/150mm 1.40m

Doppelschaber Xlife 100/150mm 1,40m

2.8 588674000

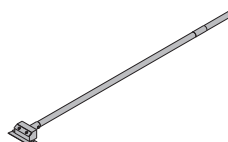

Doka personal fall-arrest set
Doka-Sicherheitsgeschirr

3.6 583022000

Follow the directions in the "Operating Instructions"!



Doka Safety Systems



You will find working and protection platforms, guardrail systems and access systems in the section headed "Doka Safety Systems".