

[kg] Article n°

Circular formwork element H20 2.40x0.70m	195.0	587820000
Circular formwork element H20 2.40x1.20m	244.0	587821000
Circular formwork element H20 2.40x2.40m	472.0	587822000
Circular formwork element H20 2.40x3.00m	523.0	587813000
Circular formwork element H20 2.40x3.60m	699.0	587823000
Rundschalungselement H20 2,40m		

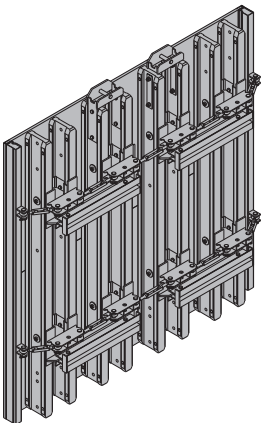

Circular formwork element H20 2.50x0.70m	197.0	587825000
Circular formwork element H20 2.50x1.20m	249.0	587826000
Circular formwork element H20 2.50x2.40m	480.0	587827000
Circular formwork element H20 2.50x3.00m	534.0	587814000
Circular formwork element H20 2.50x3.60m	716.0	587828000
Rundschalungselement H20 2,50m		

<b>Stacking plate for circular formwork H20</b>	<b>7.0</b>	<b>587830000</b>
Aufstockklasche für Rundschalung H20		



Galvanised  
Height: 62 cm

<b>Adjustable clamp 10cm</b>	<b>3.7</b>	<b>587808000</b>
Ausgleichsspanner 10cm		

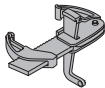

Galvanised  
Length: 30 cm

<b>Framax stop-end tie</b>	<b>1.5</b>	<b>588143000</b>
Framax-Stirnanker		

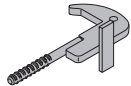

Galvanised  
Length: 29 cm

<b>Framax multi function clamp</b>	<b>5.8</b>	<b>588169000</b>
Framax-Uni-Spanner		

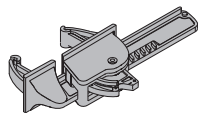

Galvanised  
Length: 40 cm

<b>Wrench for circular formwork H20</b>	<b>0.70</b>	<b>587807000</b>
Schlüssel für Rundschalung H20		

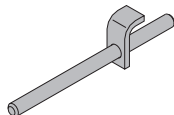

Galvanised  
Length: 27 cm

[kg] Article n°

<b>Template f. circular formw. H20 ...../.....mm</b>	<b>6.5</b>	<b>177020000</b>
Schablone für Rundschalung H20 ...../.....mm		
Weight per m <sup>2</sup>		
Project-specific!		

<b>Panel strut 340 IB</b>	<b>24.3</b>	<b>580365000</b>
Elementstütze 340 IB		
consisting of:		
(A) <b>Plumbing strut 340 IB</b>	<b>16.7</b>	<b>588696000</b>
Galvanised		
Length: 190.8 - 341.8 cm		
(B) <b>Adjusting strut 120 IB</b>	<b>7.6</b>	<b>588248500</b>
Galvanised		
Length: 81.5 - 130.6 cm		

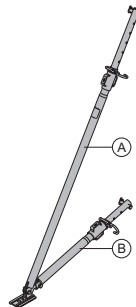

Galvanised  
Delivery condition: folded closed

<b>Panel strut 540 IB</b>	<b>41.4</b>	<b>580366000</b>
Elementstütze 540 IB		
consisting of:		

(A) <b>Plumbing strut 540 IB</b>	<b>30.7</b>	<b>588697000</b>
Galvanised		
Length: 310.5 - 549.2 cm		
(B) <b>Adjusting strut 220 IB</b>	<b>10.9</b>	<b>588251500</b>
Galvanised		
Length: 172.5 - 221.1 cm		

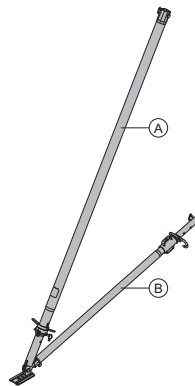

Galvanised  
Delivery condition: folded closed

**Eurex 60 550**

Eurex 60 550

depending on length, comprising:

- (A) **Plumbing strut Eurex 60 550** **42.5 582658000**  
Powder-coated, blue  
Aluminium  
Length: 343 - 553 cm
- (B) **Extension Eurex 60 2.00m** **21.3 582651000**  
Powder-coated, blue  
Aluminium  
Length: 250 cm
- (C) **Connector Eurex 60 IB** **4.2 582657500**  
Galvanised  
Length: 15 cm  
Width: 15 cm  
Height: 30 cm
- (D) **Plumbing strut shoe Eurex 60 EB** **8.0 582660500**  
Galvanised  
Length: 31 cm  
Width: 12 cm  
Height: 33 cm
- (E) **Adjusting strut 540 Eurex 60 IB** **27.8 582659500**  
Galvanised  
Length: 303.5 - 542.2 cm

Delivery condition: separate parts

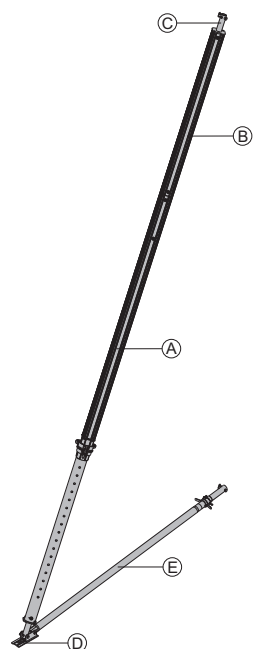
**Prop head RD EB**

Stützenkopf RD EB

**1.9 587806000**Galvanised  
Length: 19 cm  
Width: 8 cm**Universal dismantling tool**

Universal-Lösewerkzeug

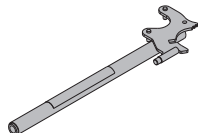
**3.7 582768000**Galvanised  
Length: 75.5 cm**Doka express anchor 16x125mm**

Doka-Expressanker 16x125mm

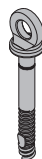
**0.31 588631000**Galvanised  
Length: 18 cm  
Follow fitting instructions!**Doka coil 16mm**

Doka-Coil 16mm

**0.009 588633000**Galvanised  
Diameter: 1.6 cm**Universal bracket 90**

Universal-Konsole 90

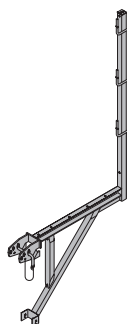
**30.4 580476000**Galvanised  
Length: 121 cm  
Height: 235 cm**Top scaffold bracket L**

Betontierkonsole L

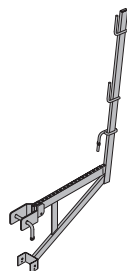
**12.6 587153500**Galvanised  
Length: 101 cm  
Height: 159 cm**Scaffold tube 48.3mm 0.50m****1.7 682026000****Scaffold tube 48.3mm 1.00m****3.6 682014000****Scaffold tube 48.3mm 1.50m****5.4 682015000****Scaffold tube 48.3mm 2.00m****7.2 682016000****Scaffold tube 48.3mm 2.50m****9.0 682017000****Scaffold tube 48.3mm 3.00m****10.8 682018000****Scaffold tube 48.3mm 3.50m****12.6 682019000****Scaffold tube 48.3mm 4.00m****14.4 682021000****Scaffold tube 48.3mm 4.50m****16.2 682022000****Scaffold tube 48.3mm 5.00m****18.0 682023000****Scaffold tube 48.3mm 5.50m****19.8 682024000****Scaffold tube 48.3mm 6.00m****21.6 682025000****Scaffold tube 48.3mm .....m****3.6 682001000**

Gerüstrohr 48,3mm

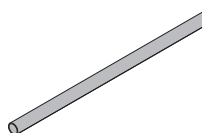

Galvanised

**Scaffold tube connection**

Gerüstrohranschluss

**0.27 584375000**Galvanised  
Height: 7 cm

**Screw-on coupler 48mm 50**

Anschraubkupplung 48mm 50

**0.84 682002000**

Galvanised

Width-across: 22 mm

**Doka 4-part chain 3.20m**

Doka-Vierstrangkette 3,20m

**15.0 588620000**

Follow the directions in the "Operating Instructions"!

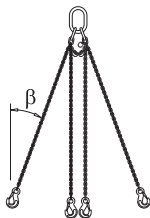
**Framax fitting timber 2x12cm 2.70m**

Framax fitting timber 3x12cm 2.70m

Framax fitting timber 5x12cm 2.70m

Framax fitting timber 10x12cm 2.70m

Framax-Passholz 2,70m

**3.1 176020000****4.7 176022000****7.8 176024000****15.5 176026000**

Varnished yellow

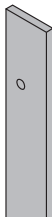
**Reversible ratchet 1/2"**

Umschaltknarre 1/2"

**0.73 580580000**

Galvanised

Length: 30 cm

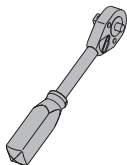
**Box nut 24 1/2"**

Stecknuss 24 1/2"

**0.12 580584000****Doka personal fall-arrest set**

Doka-Sicherheitsgeschirr

**3.6 583022000**

Follow the directions in the "Operating Instructions"!

**Doka Safety Systems**

You will find working and protection platforms, guardrail systems and access systems in the section headed "Doka Safety Systems".