

[kg] Article n°

<b>Doka folding platform K 3.00m</b>	<b>291.5</b>	<b>580442000</b>
<b>Doka folding platform K 4.50m</b>	<b>444.5</b>	<b>580443000</b>

Doka-Faltbühne K

Timber parts varnished yellow  
Steel parts galvanised  
Delivery condition: folded closed



Scaffold tube 48.3mm 0.50m	1.7	682026000
Scaffold tube 48.3mm 1.00m	3.6	682014000
Scaffold tube 48.3mm 1.50m	5.4	682015000
Scaffold tube 48.3mm 2.00m	7.2	682016000
Scaffold tube 48.3mm 2.50m	9.0	682017000
Scaffold tube 48.3mm 3.00m	10.8	682018000
Scaffold tube 48.3mm 3.50m	12.6	682019000
Scaffold tube 48.3mm 4.00m	14.4	682021000
Scaffold tube 48.3mm 4.50m	16.2	682022000
Scaffold tube 48.3mm 5.00m	18.0	682023000
Scaffold tube 48.3mm 5.50m	19.8	682024000
Scaffold tube 48.3mm 6.00m	21.6	682025000
Scaffold tube 48.3mm .....m	3.6	682001000

Gerüstrohr 48,3mm

Galvanised

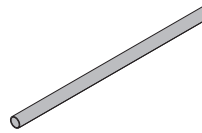

<b>Folding bracket K</b>	<b>52.4</b>	<b>580441000</b>
--------------------------	-------------	------------------

Faltkonsole K

Galvanised  
Length: 224 cm  
Height: 245 cm  
Delivery condition: folded closed



<b>Screw-on coupler 48mm 50</b>	<b>0.84</b>	<b>682002000</b>
---------------------------------	-------------	------------------

Anschraubkupplung 48mm 50

Galvanised  
Width-across: 22 mm



<b>Connection-shoe K</b>	<b>6.4</b>	<b>580451000</b>
--------------------------	------------	------------------

Anschluss Schuh K

Galvanised  
Length: 25 cm  
Width: 17 cm

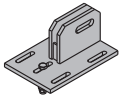

<b>Swivel coupler 48mm</b>	<b>1.5</b>	<b>582560000</b>
----------------------------	------------	------------------

Drehkupplung 48mm

Galvanised  
Width-across: 22 mm



<b>Suspended platform 120 3.30m</b>	<b>44.0</b>	<b>580411000</b>
<b>Suspended platform 120 4.30m</b>	<b>52.6</b>	<b>580412000</b>

Hängebühne 120

Galvanised  
Delivery condition: folded closed



<b>Multi-purpose waling WS10 Top50 3.00m</b>	<b>60.2</b>	<b>580011000</b>
<b>Multi-purpose waling WS10 Top50 3.50m</b>	<b>68.4</b>	<b>580012000</b>
<b>Multi-purpose waling WS10 Top50 4.00m</b>	<b>79.4</b>	<b>580013000</b>

Mehrzweckriegel WS10 Top50

Painted blue

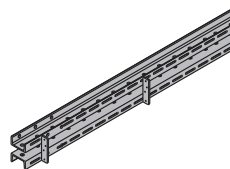

<b>Adjusting spindle M36</b>	<b>6.2</b>	<b>500663002</b>
------------------------------	------------	------------------

Höhenjustierspindel M36

Galvanised  
Length: 31 cm  
Height: 29.2 cm



<b>Connecting pin 10cm</b>	<b>0.34</b>	<b>580201000</b>
----------------------------	-------------	------------------

Verbindungsbolzen 10cm

Galvanised  
Length: 14 cm

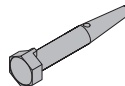

<b>Spring cotter 5mm</b>	<b>0.05</b>	<b>580204000</b>
--------------------------	-------------	------------------

Federvorstecker 5mm

Galvanised  
Length: 13 cm



[kg] Article n°

**Waling-to-bracket holder 9-15cm**

Riegelhalter 9-15cm

Galvanised

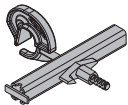

2.7 580625000

**Wind bracing MF/150F/K 6.00m**

Windabspannung MF/150F/K 6,00m

Galvanised

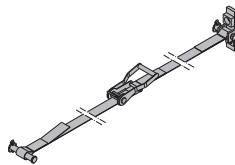

4.7 580665000

**Waling-to-bracket holder**

Keilriegelhalter

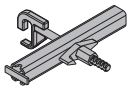
Galvanised  
Length: 26 cm  
Height: 31 cm

2.5 580526000

**Pin D16/112**

Steckbolzen D16/112

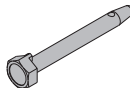
Galvanised  
Length: 16 cm

0.29 500403300

**Framax wedge clamp**

Framax-Spannklemme

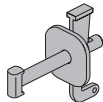
Galvanised  
Length: 21 cm

1.5 588152000

**Top scaffold bracket L**

Betonierkonsole L

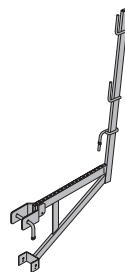
Galvanised  
Length: 101 cm  
Height: 159 cm

12.6 587153500

**Panel strut 340 IB**

Elementstütze 340 IB

consisting of:

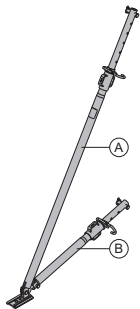
**(A) Plumbing strut 340 IB**Galvanised  
Length: 190.8 - 341.8 cm**(B) Adjusting strut 120 IB**Galvanised  
Length: 81.5 - 130.6 cmGalvanised  
Delivery condition: folded closed

24.3 580365000

**Universal bracket 90**

Universal-Konsole 90

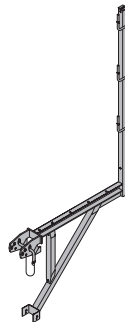
Galvanised  
Length: 121 cm  
Height: 235 cm

30.4 580476000

**Prop head EB**

Stützenkopf EB

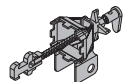
Galvanised  
Length: 40.8 cm  
Width: 11.8 cm  
Height: 17.6 cm

3.1 588244500

**Framax bracket 90**

Framax-Konsole 90

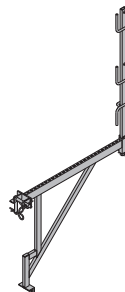
Galvanised  
Width: 103 cm  
Height: 185 cm  
Delivery condition: railing included

12.5 588167000

**Universal dismantling tool**

Universal-Löswerkzeug

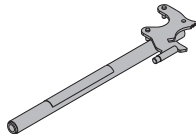
Galvanised  
Length: 75.5 cm

3.7 582768000

**Star screw**

Sternschraube

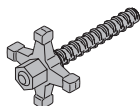
Galvanised  
Length: 17 cm

0.75 580425000

**Universal railing shackle**

Universal-Geländerbügel

Galvanised  
Height: 20 cm

3.0 580478000

[kg] Article n°

[kg] Article n°

**Scaffold tube connection**

Gerüstrohranschluss

0.27 584375000

Galvanised  
Height: 7 cm**Doka 4-part chain 3.20m**

Doka-Vierstrangkette 3,20m

15.0 588620000

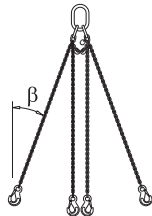

Follow the directions in the "Operating Instructions"!

**Lifting beam 110kN 6.00m**

Umsetzbalken 110kN 6,00m

136.5 586359000

Galvanised  
Length: 626 cm  
Follow the directions in the "Operating Instructions"!**Manhole B 70/60cm**

Bühnendurchstieg B 70/60cm

22.0 581530000

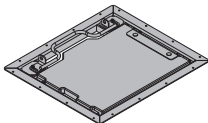
Steel parts galvanised  
Timber parts varnished yellow  
Length: 81 cm  
Width: 71 cm**Warning sign "No entry" 300x300mm**

Verbotsschild "Zutritt Verboten" 300x300mm

0.70 581575000

**Doka personal fall-arrest set**

Doka-Sicherheitsgeschirr

3.6 583022000

Follow the directions in the "Operating Instructions"!

**Universal tool box 15.0**Universal-Werkzeugbox 15,0  
included in scope of supply:

9.1 580392000

**(A) Reversible ratchet 1/2"**Galvanised  
Length: 30 cm

0.73 580580000

**(B) Fork wrench 13/17**

0.08 580577000

**(C) Fork wrench 22/24**

0.22 580587000

**(D) Fork wrench 30/32**

0.80 580897000

**(E) Fork wrench 36/41**

1.0 580586000

**(F) Ring spanner 17/19**

0.27 580590000

**(G) Square nut 22**

0.31 580589000

**(H) Box spanner 41**

0.99 580585000

**(I) Extension 11cm 1/2"**

0.20 580581000

**(J) Extension 22cm 1/2"**

0.31 580582000

**(K) Universal joint coupling**

0.16 580583000

**(L) Box nut 19 1/2" L**

0.16 580598000

**(M) Box nut 13 1/2"**

0.06 580576000

**(N) Box nut 24 1/2"**

0.12 580584000

**(O) Box nut 30 1/2"**

0.20 580575000

**(P) Positioning cone spanner 15.0 DK**

0.30 580579000

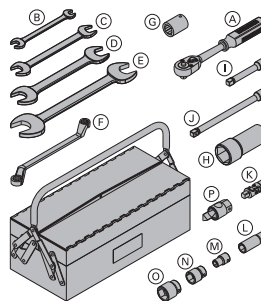
Galvanised  
Length: 8 cm  
Width-across: 30 mm**Doka Safety Systems**

You will find working and protection platforms, guardrail systems and access systems in the section headed "Doka Safety Systems".