

	[kg]	Article n°
<b>Doka floor prop Eurex 20 top 150</b> Length: 92 - 150 cm	8.0	586096000
<b>Doka floor prop Eurex 20 top 250</b> Length: 148 - 250 cm	12.7	586086400
<b>Doka floor prop Eurex 20 top 300</b> Length: 173 - 300 cm	14.3	586087400
<b>Doka floor prop Eurex 20 top 350</b> Length: 198 - 350 cm	17.4	586088400
<b>Doka floor prop Eurex 20 top 400</b> Length: 223 - 400 cm	21.6	586089400
<b>Doka floor prop Eurex 20 top 550</b> Length: 298 - 550 cm	32.3	586090400

Doka-Deckenstütze Eurex 20 top

Galvanised



<b>Doka floor prop Eurex 30 top 250</b> Length: 148 - 250 cm	12.8	586092400
<b>Doka floor prop Eurex 30 top 300</b> Length: 173 - 300 cm	16.4	586093400
<b>Doka floor prop Eurex 30 top 350</b> Length: 198 - 350 cm	20.7	586094400
<b>Doka floor prop Eurex 30 top 400</b> Length: 223 - 400 cm	24.6	586095400
<b>Doka floor prop Eurex 30 top 450</b> Length: 248 - 450 cm	29.1	586119400
<b>Doka floor prop Eurex 30 top 550</b> Length: 303 - 550 cm	38.6	586129000

Doka-Deckenstütze Eurex 30 top

Galvanised

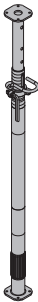

<b>Doka floor prop Eco 20 250</b> Length: 152 - 250 cm	11.7	586134000
<b>Doka floor prop Eco 20 300</b> Length: 172 - 300 cm	13.0	586135000
<b>Doka floor prop Eco 20 350</b> Length: 197 - 350 cm	15.3	586136000
<b>Doka floor prop Eco 20 400</b> Length: 227 - 400 cm	19.1	586137000

Doka-Deckenstütze Eco 20

Galvanised

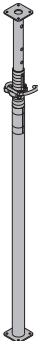

	[kg]	Article n°
<b>Removable folding tripod top</b> Stützbein top	12.0	586155500



Galvanised  
Height: 80 cm  
Delivery condition: folded closed

<b>Removable folding tripod 1.20m</b> Stützbein 1,20m	20.7	586145000
--	------	-----------



Galvanised  
Height: 120 cm  
Delivery condition: folded closed

<b>Lowering head H20</b> Absenkkopf H20	6.1	586174000
--	-----	-----------

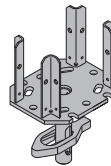

Galvanised  
Length: 25 cm  
Width: 20 cm  
Height: 38 cm

<b>4-way head H20</b> Vierwegkopf H20	4.0	586170000
--	-----	-----------

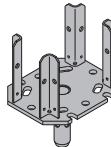

Galvanised  
Length: 25 cm  
Width: 20 cm  
Height: 33 cm

<b>Spring locked connecting pin 16mm</b> Federbolzen 16mm	0.25	582528000
--	------	-----------



Galvanised  
Length: 15 cm

<b>Supporting head H20 DF</b> Haltekopf H20 DF	0.77	586179000
---	------	-----------



Galvanised  
Length: 19 cm  
Width: 11 cm  
Height: 8 cm

<b>U-head 12.5cm</b> Kopfgabel 12,5cm	1.2	586171000
--	-----	-----------

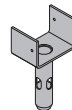

Galvanised  
Height: 23 cm

<b>Bracing clamp B</b> Verschwertungsklammer B	1.4	586195000
---	-----	-----------

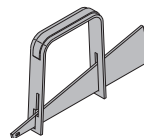

Painted blue  
Length: 36 cm

[kg] Article n°

[kg] Article n°

**Secondary-beam stabiliser 1**  
**Secondary-beam stabiliser 2**

Querträgersicherung

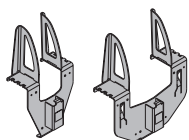
**1.6 586196000**  
**2.1 586197000**Galvanised  
Height: 38.7 cm**Universal end-shutter support 30cm**

Universal-Abschalwinkel 30cm

**1.0 586232000**Galvanised  
Height: 21 cm**Beam forming support 20**

Balkenzwinge 20

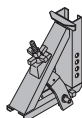
**6.9 586148000**Galvanised  
Length: 30 cm  
Height: 35 cm**Extension for beam forming support 60cm**

Balkenaufsatz 60cm

**4.4 586149000**

Galvanised

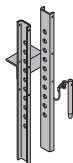
**Doka floor end-shutter clamp**

Doka-Deckenabschalcklemme

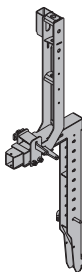
**12.5 586239000**Galvanised  
Height: 137 cm**End-shutter shoe**

Abschalshuh

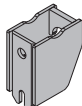
**1.6 586257000**Galvanised  
Height: 13.5 cm**End-shutter tie rod 15.0 15-40cm**

Abschalanker 15,0 15-40cm

**0.91 586258000**Galvanised  
Length: 55 cm**Universal plug R20/25**

Kombi Ankerstopfen R20/25

**0.003 588180000**Blue  
Diameter: 3 cm**Plug for closure plate R25**

Ausgleichsblechstopfen R25

**0.003 588187000**Black  
Diameter: 3 cm**Platform stairway 0.97m**

Podesttreppe 0,97m

**25.0 586555000**Aluminium  
Width: 120 cm  
Pay attention to the national, technical safety regulations!**Wheel-around scaffold DF**

Mobilgerüst DF

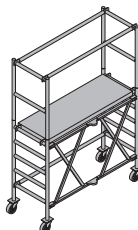
**44.0 586157000**Aluminium  
Length: 185 cm  
Width: 80 cm  
Height: 255 cm  
Delivery condition: folded closed  
Follow the directions in the "Operating Instructions"!**Mobile scaffold tower Z**

Fahrgerüst Z

consisting of:

- (A) **Attachable frame Z 1.00m** **6.7 586016000**
- (B) **Attachable frame Z 2.00m** **11.3 586017000**
- (C) **Railing frame Z 1.00m** **4.1 586021000**
- (D) **Handrail post Z 1.80m** **6.5 586022000**
- (E) **Platform Z with manhole flap 1.80m** **17.5 586023000**
- (F) **Platform Z without manhole flap 1.80m** **17.0 586024000**
- (G) **End toe-board Z 1.35m** **4.0 586025000**
- (H) **Side toe-board Z 1.80m** **5.1 586026000**
- (I) **Diagonal brace Z 2.00m** **3.0 586027000**
- (J) **Horizontal brace Z 1.80m** **2.8 586028000**
- (K) **Triangular bracket Z** **5.3 586029000**  
(not illustrated)
- (L) **Guide roller Z D200mm** **7.1 586030000**
- (M) **Step-up rung Z** **2.5 586031000**
- (N) **Platform diagonal strut Z** **2.5 586032000**  
(not illustrated)
- (O) **Ballast Z** **10.0 586033000**  
(not illustrated)

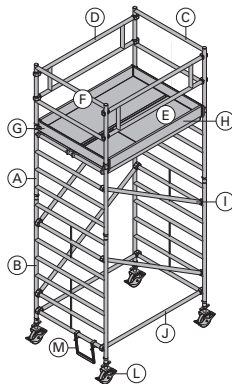
Aluminium  
Follow the directions in the "Instructions for assembly and use"!**Universal dismantling tool**

Universal-Lösewerkzeug

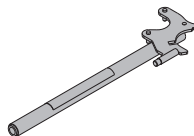
**3.7 582768000**Galvanised  
Length: 75.5 cm

**Alu beam fork H20**

Alu-Trägergabel H20

**2.4 586182000**

Aluminium  
Powder-coated yellow  
Length: 176 cm

**Doka beam H20 top N 2.65m****Doka beam H20 top N 3.90m**

Doka-Träger H20 top N

**13.8 189013000****20.0 189017000**

Varnished yellow

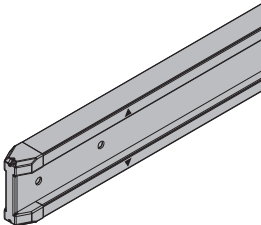
**Doka beam H20 top P 2.65m****Doka beam H20 top P 3.90m**

Doka-Träger H20 top P

**14.3 189703000****20.8 189707000**

Varnished yellow

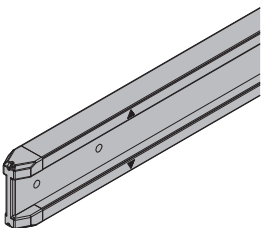
**ProFrame panel 21mm 200/50cm****ProFrame panel 21mm 200/50cm BS****ProFrame panel 21mm 250/50cm****ProFrame panel 21mm 250/50cm BS**

ProFrame-Paneel 21

**11.0 186118000****11.0 186118100****13.8 186117000****13.8 186117100****ProFrame panel 27mm 200/50cm****ProFrame panel 27mm 200/50cm BS****ProFrame panel 27mm 250/50cm****ProFrame panel 27mm 250/50cm BS**

ProFrame-Paneel 27

**13.5 187178000****13.5 187178100****16.9 187177000****16.9 187177100****Doka personal fall-arrest set**

Doka-Sicherheitsgeschirr

**3.6 583022000**

Follow the directions in the "Operating Instructions"!

**Doka Safety Systems**

You will find working and protection platforms, guardrail systems and access systems in the section headed "Doka Safety Systems".