

[kg] Article n°

[kg] Article n°

**Strut SL-1 2.50m**  
**Strut SL-1 1.25m**  
**Strut SL-1 0.625m**  
**Strut SL-1 0.312m**  
**Strut SL-1 0.156m**  
 Stütze SL-1

**86.5 582812000**  
**60.5 582813000**  
**40.0 582814000**  
**27.0 582815000**  
**16.0 582817000**

Galvanised  
 Width: 37 cm

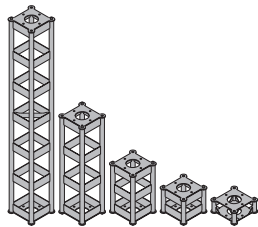

**Prop spindle SL-1**  
 Stützenspindel SL-1

**81.0 582816000**

Galvanised  
 Length: 37 cm  
 Width: 37 cm  
 Height: 44.5-66.5 cm

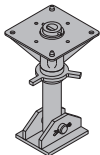

**Screw-set M16x40 8.8**  
 Schraubensatz M16x40 8.8

**0.56 582831000**

Galvanised  
 Width-across: 24 mm

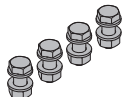

**Lowering spindle strut SL-1**  
 Absenkspindel Stütze SL-1

**83.0 582950000**

Galvanised

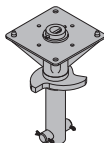

**Fastening shoe strut SL-1**  
 Anschraubschuh Stütze SL-1

**22.2 582951000**

Galvanised

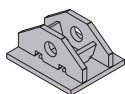

**Screw-set M20x70 8.8**  
 Schraubensatz M20x70 8.8

**1.3 582952000**

Galvanised  
 Width-across: 30 mm

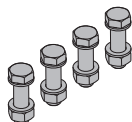

**Basic plate SL-1**  
 Grundplatte SL-1

**31.5 582808000**

Galvanised  
 Length: 37 cm  
 Width: 37 cm

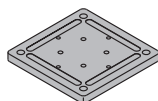

**Basic plate screw-set SL-1**  
 Schraubensatz Grundplatte SL-1

**1.2 582852000**

Galvanised

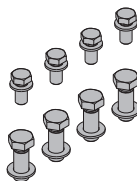

**Beam clamp SL-1**  
 Trägerklemme SL-1

**1.7 582824000**

Galvanised  
 Height: 17 cm  
 Width-across: 24 mm



**System beam SL-1 5.00m**  
**System beam SL-1 4.00m**  
**System beam SL-1 3.00m**  
**System beam SL-1 1.00m**  
**System beam SL-1 0.75m**  
 Systemträger SL-1

**598.0 582800000**  
**496.7 582801000**  
**371.0 582802000**  
**148.0 582803000**  
**98.5 582804000**

Painted blue

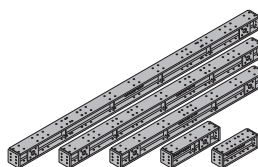

**Travelling gear distancer SL-1 330mm**  
 Fahrwerkdistanz SL-1 330mm

**53.0 582863000**

Galvanised  
 Length: 33 cm  
 Width: 22 cm  
 Height: 24 cm

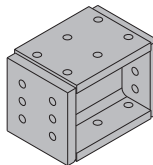

**Screw-set M20x90 8.8 shank length 38mm**  
 Schraubensatz M20x90 8.8 Schaftlänge 38mm

**1.4 582829000**

Galvanised  
 Width-across: 30 mm

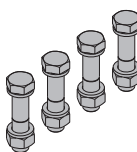

**Lowering wedge SL-1 420kN**  
 Absenckeil SL-1 420kN

**30.0 582821000**

Galvanised  
 Height: 16.8 - 26.8 cm

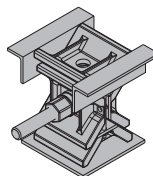

**Bracing bolt SL-1**  
 Abspannbolzen SL-1

**15.6 582807000**

Galvanised  
 Length: 52 cm  
 Diameter: 7 cm

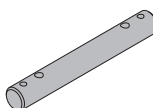

[kg] Article n°

[kg] Article n°

**Distance piece SL-1**

Distanzstück SL-1

1.9 582809000

Galvanised  
Length: 16 cm  
Width: 9.2 cm  
Height: 8.2 cm

Multi-purpose waling WS10 Top50 0.50m

10.2 580001000

Multi-purpose waling WS10 Top50 0.75m

14.9 580002000

Multi-purpose waling WS10 Top50 1.00m

19.6 580003000

Multi-purpose waling WS10 Top50 1.25m

24.7 580004000

Multi-purpose waling WS10 Top50 1.50m

29.7 580005000

Multi-purpose waling WS10 Top50 1.75m

35.0 580006000

Multi-purpose waling WS10 Top50 2.00m

38.9 580007000

Multi-purpose waling WS10 Top50 2.25m

44.2 580008000

Multi-purpose waling WS10 Top50 2.50m

48.7 580009000

Multi-purpose waling WS10 Top50 2.75m

54.2 580010000

Multi-purpose waling WS10 Top50 3.00m

60.2 580011000

Multi-purpose waling WS10 Top50 3.50m

68.4 580012000

Multi-purpose waling WS10 Top50 4.00m

79.4 580013000

Multi-purpose waling WS10 Top50 4.50m

89.1 580014000

Multi-purpose waling WS10 Top50 5.00m

102.0 580015000

Multi-purpose waling WS10 Top50 5.50m

112.4 580016000

Multi-purpose waling WS10 Top50 6.00m

118.0 580017000

Mehrzweckriegel WS10 Top50

Painted blue

**Split nut SL-1 15.0**

Spannmutter SL-1 15,0

0.70 582835000

Galvanised  
Length: 9-11 cm  
Width-across: 30/41 mm**Hexagon nut 15.0**

Sechskantmutter 15,0

0.23 581964000

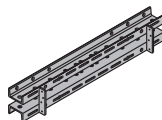
Galvanised  
Length: 5 cm  
Width-across: 30 mm**DIN**  
18216**Brace stirrup SL-1**

Abspannbügel SL-1

6.4 582862000

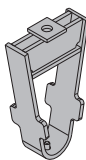
Galvanised  
Height: 33.4 cm**Formwork element connector FF20/50**

Elementverbinder FF20/50

6.3 587530000

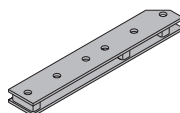
Painted blue  
Length: 55 cm**Screw-on coupler 48mm 50**

Anschraubkupplung 48mm 50

0.84 682002000

Galvanised  
Width-across: 22 mm**Connecting pin 10cm**

Verbindungsbolzen 10cm

0.34 580201000

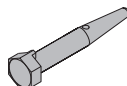
Galvanised  
Length: 14 cm**Swivel coupler 48mm**

Drehkupplung 48mm

1.5 582560000

Galvanised  
Width-across: 22 mm**Spring cotter 5mm**

Federvorstecker 5mm

0.05 580204000

Galvanised  
Length: 13 cm**Normal coupler 48mm**

Normalkupplung 48mm

1.2 682004000

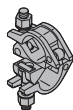
Galvanised  
Width-across: 22 mm**Strut connection SL-1**

Strebenanschluss SL-1

8.2 582806000

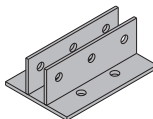
Galvanised  
Length: 30 cm  
Width: 20 cm  
Height: 10 cm**Scaffold tube 48.3mm 0.50m**

Scaffold tube 48.3mm 1.00m

Scaffold tube 48.3mm 1.50m

Scaffold tube 48.3mm 2.00m

Scaffold tube 48.3mm 2.50m

Scaffold tube 48.3mm 3.00m

Scaffold tube 48.3mm 3.50m

Scaffold tube 48.3mm 4.00m

Scaffold tube 48.3mm 4.50m

Scaffold tube 48.3mm 5.00m

Scaffold tube 48.3mm 5.50m

Scaffold tube 48.3mm 6.00m

Scaffold tube 48.3mm .....m

Gerüstrohr 48,3mm

1.7 682026000

3.6 682014000

5.4 682015000

7.2 682016000

9.0 682017000

10.8 682018000

12.6 682019000

14.4 682021000

16.2 682022000

18.0 682023000

19.8 682024000

21.6 682025000

3.6 682001000

**Screw-set M20x65 8.8**

Schraubensatz M20x65 8.8

1.2 582851000

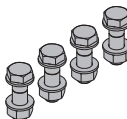
Galvanised  
Width-across: 30 mm

Galvanised

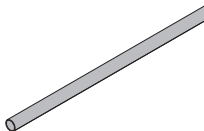

[kg] Article n°

[kg] Article n°

**Spindle strut T6 73/110cm**  
**Spindle strut T6 100/150cm**  
 Spindelstrebe T6

**10.2 584355000**  
**12.5 584323000**

Galvanised

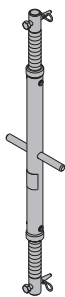

**Spindle strut T7 75/110cm**  
**Spindle strut T7 100/150cm**  
**Spindle strut T7 150/200cm**  
**Spindle strut T7 200/250cm**  
**Spindle strut T7 250/300cm**  
**Spindle strut T7 305/355cm**  
 Spindelstrebe T7

**13.2 584308000**  
**16.8 584309000**  
**21.6 584324000**  
**26.2 584325000**  
**29.4 584326000**  
**35.0 584327000**

Galvanised

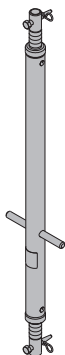

**Connection adapter SL-1**  
 Anschlussadapter SL-1

**4.3 582810000**

Galvanised  
 Length: 35 cm  
 Width-across: 22 mm

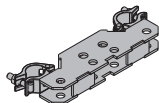

**Frami bracket 60**  
 Frami-Konsole 60

**7.7 588442000**

Galvanised  
 Length: 98 cm  
 Height: 157 cm

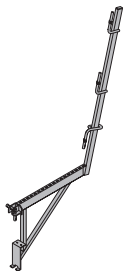
**Panel strut 340 IB****24.3 580365000**

Elementstütze 340 IB

consisting of:

**(A) Plumbing strut 340 IB****16.7 588696000**

Galvanised

Length: 190.8 - 341.8 cm

**(B) Adjusting strut 120 IB****7.6 588248500**

Galvanised

Length: 81.5 - 130.6 cm

Galvanised

Delivery condition: folded closed

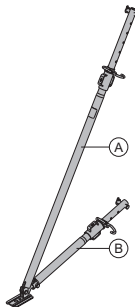
**Panel strut 540 IB****41.4 580366000**

Elementstütze 540 IB

consisting of:

**(A) Plumbing strut 540 IB****30.7 588697000**

Galvanised

Length: 310.5 - 549.2 cm

**(B) Adjusting strut 220 IB****10.9 588251500**

Galvanised

Length: 172.5 - 221.1 cm

Galvanised

Delivery condition: folded closed

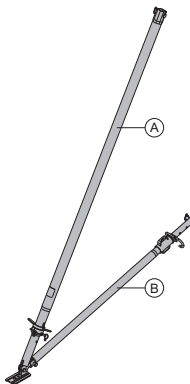
**Prop head EB****3.1 588244500**

Stützenkopf EB

Galvanised

Length: 40.8 cm

Width: 11.8 cm

Height: 17.6 cm

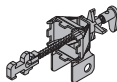

**Mobile scaffold tower Z**

Fahrgerüst Z

consisting of:

(A) Attachable frame Z 1.00m	6.7	586016000
(B) Attachable frame Z 2.00m	11.3	586017000
(C) Railing frame Z 1.00m	4.1	586021000
(D) Handrail post Z 1.80m	6.5	586022000
(E) Platform Z with manhole flap 1.80m	17.5	586023000
(F) Platform Z without manhole flap 1.80m	17.0	586024000
(G) End toe-board Z 1.35m	4.0	586025000
(H) Side toe-board Z 1.80m	5.1	586026000
(I) Diagonal brace Z 2.00m	3.0	586027000
(J) Horizontal brace Z 1.80m	2.8	586028000
(K) Triangular bracket Z (not illustrated)	5.3	586029000
(L) Guide roller Z D200mm	7.1	586030000
(M) Step-up rung Z	2.5	586031000
(N) Platform diagonal strut Z (not illustrated)	2.5	586032000
(O) Ballast Z (not illustrated)	10.0	586033000

Aluminium

Follow the directions in the "Instructions for assembly and use"!

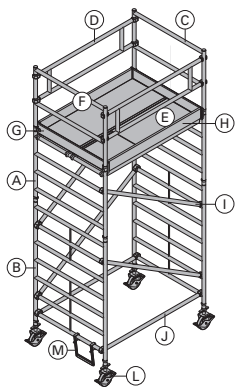
**Tool box SL-1**

Werkzeugbox SL-1

included in scope of supply:

(A) Combination wrench 19 2 pcs.	0.14	582837000
(B) Combination wrench 22 2 pcs.	0.20	582838000
(C) Combination wrench 24 2 pcs.	0.25	582839000
(D) Combination wrench 30 2 pcs.	0.43	582840000
(E) Combination wrench 32	0.75	582859000
(F) Combination wrench 36	0.75	582860000
(G) Combination wrench 41	1.5	582841000
(H) Ratchet-ring wrench 30/32	1.3	582843000
(I) Box nut 19 1/2" L	0.16	580598000
(J) Box nut 22 3/4" L	0.22	582844000
(K) Box nut 24 3/4" L	0.25	582845000
(L) Box nut 30 3/4" L	0.52	582846000
(M) Extension 20cm 3/4"	0.68	580683000
(N) Reversible ratchet 3/4" Galvanised Length: 50 cm	1.5	580894000
(O) Tie rod wrench 15.0/20.0 Galvanised Length: 37 cm Diameter: 8 cm	1.9	580594000
(P) Transition piece A 1/2"x3/4"	0.18	580684000
(Q) Angular arbor SL-1	1.4	582867000
(R) Fork wrench 46	0.87	582869000
(S) Ring spanner 46	0.96	582868000

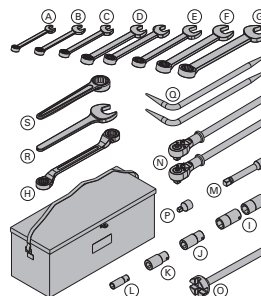
**Doka personal fall-arrest set**

Doka-Sicherheitsgeschirr

3.6 583022000

Follow the directions in the "Operating Instructions"!



CE