

**框架结构支撑“变数”3.30m**  
Support. construction frame "Variable" 3.30m

187,8 580516000

**张力板**  
Tension plate

2,5 580534000

包括:

(A) 用于框架支撑的围檩 WU14

蓝色涂漆

高度: 252 cm

99,0 580510000

(B) 多用途钢围檩 WS10 Top50 2.00m

蓝色涂漆

38,9 580007000

(C) 张力板

蓝色涂漆

长度: 19 cm

2,5 580534000

(D) 支撑靴

蓝色涂漆

长度: 28 cm

9,5 580532000

(E) 连接销钉 10cm

镀锌

长度: 14 cm

0,34 580201000

(F) 弹簧卡 5mm

镀锌

长度: 13 cm

0,05 580204000

(G) 支撑轴杆 12 3.00m

蓝色涂漆

长度: 201 - 234 cm

32,0 580521000

(H) 半边扣件 48mm 50

镀锌

对边宽度: 22 mm

0,84 682002000

多用途钢围檩 WS10 Top50 1.00m

19,6 580003000

多用途钢围檩 WS10 Top50 1.75m

35,0 580006000

多用途钢围檩 WS10 Top50 2.00m

38,9 580007000

多用途钢围檩 WS10 Top50 2.50m

48,7 580009000

多用途钢围檩 WS10 Top50 2.75m

54,2 580010000

多用途钢围檩 WS10 Top50 3.00m

60,2 580011000

多用途钢围檩 WS10 Top50 3.50m

68,4 580012000

多用途钢围檩 WS10 Top50 4.00m

79,4 580013000

Multi-purpose waling WS10 Top50

蓝色涂漆

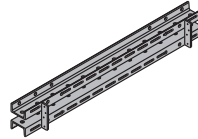

支撑轴杆 12 3.00m

Spindle strut 12 3.00m

32,0 580521000

蓝色涂漆

长度: 201 - 234 cm



轴杆支撑 T7 305/355cm

Spindle strut T7 305/355cm

35,0 584327000

镀锌

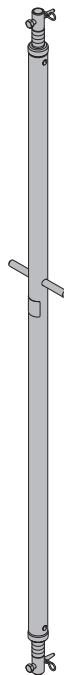

用于框架支撑的围檩 WU14

Waling WU14 for supporting construction frame

99,0 580510000

包括:

(A) 楼板支撑框架钢切片 WU14

蓝色涂漆

高度: 250 cm

81,0 580509000

(B) 压力靴

蓝色涂漆

高度: 32 cm

6,2 580531000

(C) 锚固靴

蓝色涂漆

高度: 51 cm

12,0 580533000

蓝色涂漆

高度: 252 cm

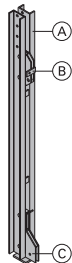

支撑靴

Supporting shoe

9,5 580532000

蓝色涂漆

长度: 28 cm

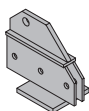

模板板块连接器 FF20/50 Z

Formwork element connector FF20/50 Z

6,0 587533000

蓝色涂漆

长度: 55 cm

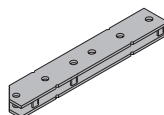

[kg] 产品编号

**连接销钉 10cm**  
Connecting pin 10cm

0,34 580201000

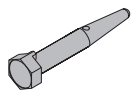

镀锌  
长度: 14 cm

**弹簧卡 5mm**  
Spring cotter 5mm

0,05 580204000



镀锌  
长度: 13 cm

**通用框架结构支撑 F 4.50m**  
Supporting construct. frame Universal F 4.50m

306,0 580500000

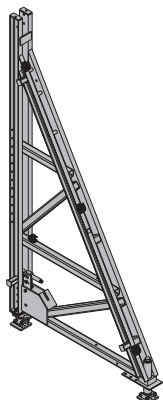

蓝色涂漆  
长度: 196 cm  
高度: 365 - 394 cm

**可附加框架 F 1.50m**  
Attachable frame F 1.50m

236,0 580502000

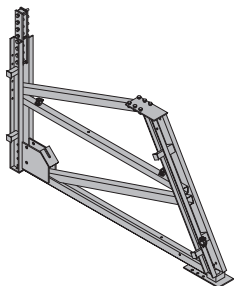

蓝色涂漆  
长度: 280 cm

**可附加框架 F 1.50m**  
Attachable frame F 2.00m

451,0 580501000

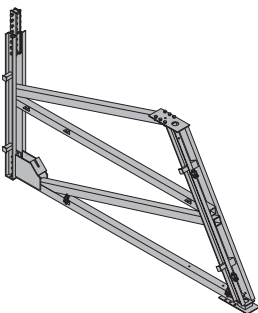

蓝色涂漆  
长度: 394 cm

**支撑框架前轴杆**  
Front spindle for supp. construction frame

8,5 580508000

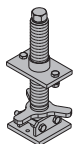

镀锌

**支撑框架后部主轴**  
Rear spindle for supp. construction frame

18,3 580515000

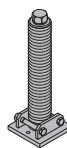

镀锌

**锚固围檩 0.70m**  
**锚固围檩 1.95m**  
**锚固围檩 2.95m**  
Anchor waling

27,0 580517000  
76,3 580545000  
110,0 580546000

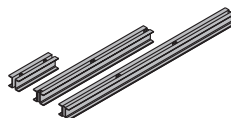

蓝色涂漆

**多用途钢围檩 WU12 Top50 2.00m**  
**多用途钢围檩 WU12 Top50 3.00m**  
Multi-purpose waling WU12 Top50

50,0 580022000  
75,7 580024000

蓝色涂漆

**锚固杆件 0.55m**  
Anchoring profile 0.55m

44,5 582904000

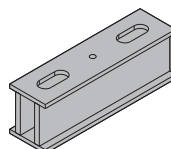

蓝色涂漆

**锚固围檩定位器**  
Anchor waling positioner

0,62 580539000

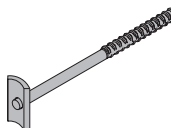

镀锌  
长度: 31 cm

**支撑结构框架角部板**  
Corner plate supporting constr. frame

44,4 580518000

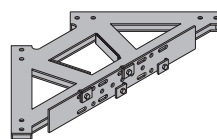

蓝色涂漆  
长度: 92 cm  
宽度: 92 cm

**正面围檩 WS10 2.50m**  
Facade waling WS10 2.50m

50,0 580692000



蓝色涂漆

**支撑结构测距器 20cm**  
Supporting construction distancer 20cm

9,4 580519000

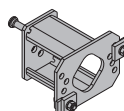

镀锌  
长度: 25 cm  
宽度: 19 cm  
高度: 20 cm

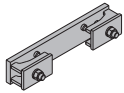
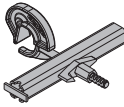
**夹具用于框架支撑间隔器 20cm**  
Clamp for supp. constr. distancer 20cm**5,0 582920000****可附着滚轮 200**  
Attachable roller 200**19,3 580538000**镀锌  
长度: 36 cm  
宽度: 7 cm蓝色涂漆  
高度: 38 cm**钩头螺栓 9-15cm**  
Waling-to-bracket holder 9-15cm**2,7 580625000****可附着滚轮 300**  
Attachable roller 250**47,0 580537000**

镀锌

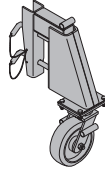
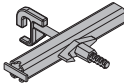
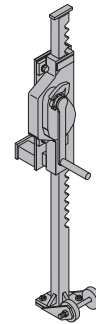
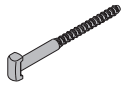
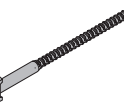
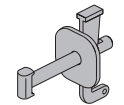
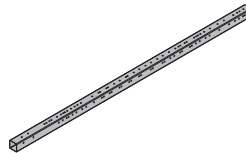
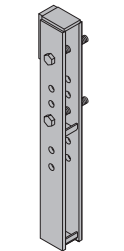
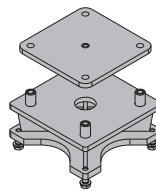
蓝色涂漆  
高度: 78 cm**围檩 - 支架的固定架**  
Waling-to-bracket holder**2,5 580526000****带自行装置的手摇提升支撑**  
Winch with transport device**37,0 580541000**镀锌  
长度: 26 cm  
高度: 31 cm蓝色涂漆  
高度: 127 cm  
请遵守“操作说明书”中的指令!**Framax 通用固定栓 10-16cm**  
Framax universal fixing bolt 10-16cm**0,60 588158000**镀锌  
长度: 26 cm**Framax 通用固定栓 10-25cm**  
Framax universal fixing bolt 10-25cm**0,69 583002000**镀锌  
长度: 36 cm**Framax 楔形夹**  
Framax wedge clamp**1,5 588152000**镀锌  
长度: 21 cm**移动杆件 F 2.00m 前部**  
Travelling profile F 2.00m front**180,0 582925000**镀锌  
长度: 600 cm**Framax 配套骨架连接件**  
Framax supporting construct. frame connector**15,0 580506000**蓝色涂漆  
高度: 77 cm**轮子连接器 F 2.00m 前轮**  
Wheel connector F 2.00m front**33,7 582926000**镀锌  
长度: 30 cm  
宽度: 30 cm  
高度: 16,5 cm**Framax 配套骨架销钉 36cm**  
Framax supporting construct. frame bolt 36cm**0,62 580505000**

镀锌

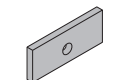
**夹板叉头 F 2.00m**  
Clamping jaw F 2.00m**0,82 582927000**镀锌  
长度: 12,5 cm**Framax 压盘 6/15**  
Framax pressure plate 6/15**0,80 588183000**

镀锌

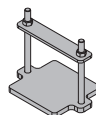
**夹紧板 F 2.00m**  
Clamping plate F 2.00m**3,5 582928000**镀锌  
长度: 24 cm**连接板 F 2.00m**  
Intermediate plate F 2.00m**6,0 582929000**镀锌  
长度: 25 cm  
宽度: 18 cm

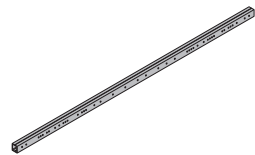
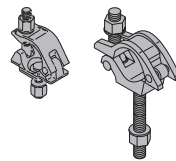
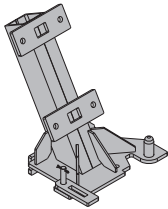
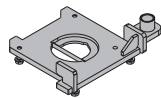
**移动杆件 F 2.00m 后部**  
Travelling profile F 2.00m rear**187,5 582930000**镀锌  
长度: 574 cm**半边扣件 48mm 50**  
**半边扣件 48mm 95**  
Screw-on coupler**0,84 682002000**  
**0,88 586013000**镀锌  
对边宽度: 22 mm**轮子连接器 F 2.00m 后轮**  
Wheel connector F 2.00m rear**44,5 582931000**镀锌  
高度: 61,5 cm**万向扣件 48mm**  
Swivel coupler 48mm**1,5 582560000**镀锌  
对边宽度: 22 mm**连接板 F 2.00m**  
Connection plate F 2.00m**15,8 582932000**镀锌  
长度: 44,1 cm  
宽度: 35,7 cm**脚手管 48.3mm 0.50m**  
**脚手管 48.3mm 1.00m**  
**脚手管 48.3mm 1.50m**  
**脚手管 48.3mm 2.00m**  
**脚手管 48.3mm 2.50m**  
**脚手管 48.3mm 3.00m**  
**脚手管 48.3mm 3.50m**  
**脚手管 48.3mm 4.00m**  
**脚手管 48.3mm 4.50m**  
**脚手管 48.3mm 5.00m**  
**脚手管 48.3mm 5.50m**  
**脚手管 48.3mm 6.00m**  
**脚手管 48.3mm .....m**  
Scaffold tube 48.3mm**1,7 682026000**  
**3,6 682014000**  
**5,4 682015000**  
**7,2 682016000**  
**9,0 682017000**  
**10,8 682018000**  
**12,6 682019000**  
**14,4 682021000**  
**16,2 682022000**  
**18,0 682023000**  
**19,8 682024000**  
**21,6 682025000**  
**3,6 682001000**

镀锌

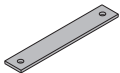
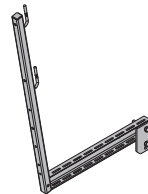
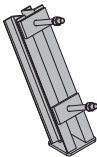
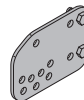
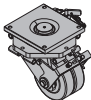
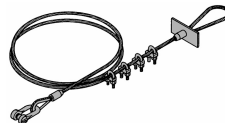
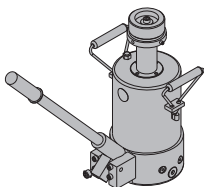
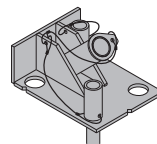
**螺栓连接板 F 2.00m**  
Bolting plate F 2.00m**2,9 582933000**镀锌  
长度: 20 cm**连接片 F 2.00m**  
Connection plate F 2.00m**2,3 582934000**镀锌  
长度: 42 cm**旋入式托架 MF75**  
Screw-on access bracket MF75**19,0 580669000**镀锌  
长度: 113 cm  
高度: 152 cm**提升支架 F 2.00m 背面**  
Lifting bracket F 2.00m rear**14,0 582935000**镀锌  
高度: 48,6 cm**回转盘 MF**  
Swivel plate MF**4,5 580672000**镀锌  
长度: 29 cm  
高度: 20 cm**重型支撑轮 90kN**  
Heavy duty wheel 90kN**85,0 582921000**镀锌  
高度: 38 cm**塔吊吊索 3.50m**  
Crane sling 3.50m**8,8 580461000**直径: 16 cm  
请遵守“操作说明书”中的指令!**下沉式千斤顶 SL-1 250kN**  
Lowering cylinder SL-1 250kN**27,2 582870000**蓝色涂漆  
高度: 28-56 cm  
请遵守“操作说明书”中的指令!**对角锚具 15.0/20.0 的桁架测试器**  
Testing truss for diagonal anchors 15.0/20.0**13,5 580514000**镀锌  
长度: 32 cm  
宽度: 25 cm  
高度: 19 cm

**通用工具箱 15.0**  
 Universal tool box 15.0

包括在供应范围内:

**(A) 棘轮扳手 1/2"**

镀锌

长度: 30 cm

**(B) 开口扳手 13/17****(C) 开口扳手 22/24****(D) 开口扳手 30/32****(E) 开口扳手 36/41****(F) 梅花双头扳手 17/19****(G) 方形螺母 22****(H) 套筒扳手 41****(I) 套筒加长杆 11cm 1/2"****(J) 套筒加长杆 22cm 1/2"****(K) 套筒万向接头****(L) 扳手套筒 19 1/2" L****(M) 扳手套筒 13 1/2"****(N) 扳手套筒 24 1/2"****(O) 扳手套筒 30 1/2"****(P) 定位锥扳手 15.0 DK**

镀锌

长度: 8 cm

对边宽度: 30 mm

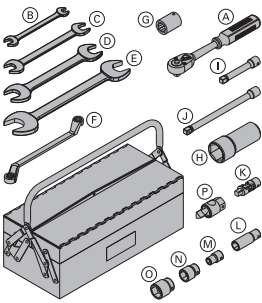
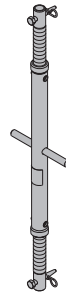
**9,1 580392000****轴杆支撑 T6 100/150cm**  
Spindle strut T6 100/150cm**12,5 584323000****0,73 580580000****0,08 580577000****0,22 580587000****0,80 580897000****1,0 580586000****0,27 580590000****0,31 580589000****0,99 580585000****0,20 580581000****0,31 580582000****0,16 580583000****0,16 580598000****0,06 580576000****0,12 580584000****0,20 580575000****0,30 580579000**

镀锌

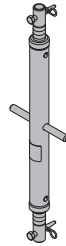
**轴杆支撑 T7 100/150cm**  
Spindle strut T7 100/150cm**16,8 584309000**

镀锌

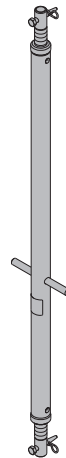
**轴杆支撑 T7 200/250cm**  
Spindle strut T7 200/250cm**26,2 584325000**

镀锌

**棘轮扳手 3/4"**  
Reversible ratchet 3/4"**1,5 580894000**

镀锌

长度: 50 cm

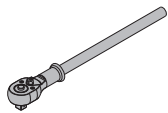
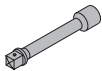
**六角扳手头 46 3/4"**  
Hexagon spanner head 46 3/4"**0,70 580512000****套筒加长杆 20cm 3/4"**  
Extension 20cm 3/4"**0,68 580683000****锚固锥扳手 20.0**  
Cone spanner 20.0**3,5 581471000**

镀锌

长度: 57 cm

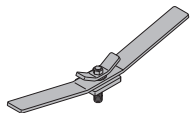
**爬锥拆除工具**  
Clearance-cone dismantling tool**0,67 581864000**

镀锌

长度: 10,7 cm

对边宽度: 24 mm

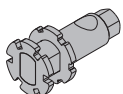

[kg] 产品编号

轴杆支撑 T7 250/300cm  
Spindle strut T7 250/300cm

29,4 584326000

镀锌

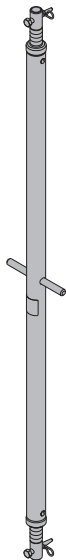

[kg] 产品编号

可调轴杆 SL-1 T16 140/225cm  
Spindle strut SL-1 T16 140/225cm

87,8 582872000

镀锌

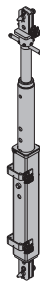

轴杆支撑 T10 350/400cm  
Spindle strut T10 350/400cm

57,5 584328000

镀锌

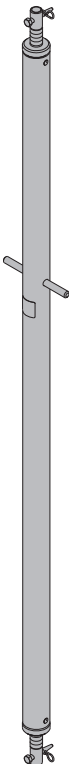

可调轴杆 SL-1 T16 220/375cm  
Spindle strut SL-1 T16 220/375cm

123,0 582874000

镀锌



可附加框架 F 2.40m  
Attachable frame F 2.40m

1107,0 582901000

蓝色涂漆  
长度: 576 cm

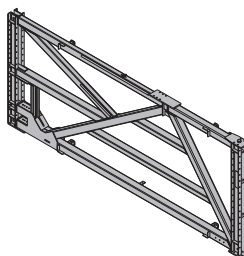

堆叠盘 F 2.40m  
Stacking plate F 2.40m

32,5 582902000

蓝色涂漆  
高度: 63,5 cm

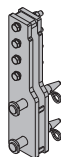

可调轴杆 SL-1 T16 100/140cm  
Spindle strut SL-1 T16 100/140cm

54,1 582871000

镀锌

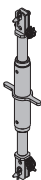

可附着框架主轴 F 2.40m  
Spindle for attachable frame F 2.40m

20,1 582903000

镀锌  
高度: 47,5 cm

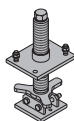

**降低楔 1000kN**  
Lowering wedge 1000kN

**53,5 582905000**

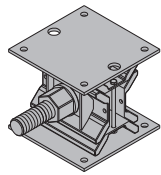

蓝色涂漆  
高度: 18,2 - 27,2 cm

**梅花双头扳手 80**  
Ring spanner 80

**3,8 582906000**



镀锌  
长度: 62,4 cm

**支撑杆件 2.95m**  
Bracing profile 2.95m

**42,5 582907000**

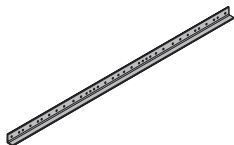

蓝色涂漆

**楼办支撑框架平台杆件 1.00m**  
Platform profile 1.00m f. supp. constr. frame

**10,7 582908000**

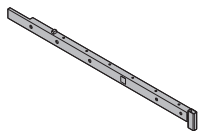

镀锌  
长度: 147,5 cm

**平台延伸安全钳**  
Extension safety clamp for platform profile

**1,7 582909000**

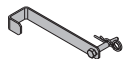

镀锌  
长度: 38,4 cm

**扶手栏杆 1.00m**  
Handrail post 1.00m

**3,8 584335000**



镀锌  
长度: 124 cm

**T形板用于框架支撑**  
T plate for supporting construction frame

**29,8 582910000**

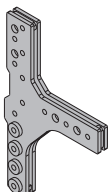

蓝色涂漆  
长度: 74,6 cm

**连接销 SL-1 D32 100**  
Connecting pin SL-1 D32 100

**1,0 582885000**



镀锌  
长度: 17 cm

**扶手栏杆 T 1.80m**  
Handrail post T 1.80m

**17,7 584373000**

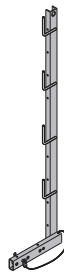

镀锌

**下部围护板固定装置 T 1.80m**  
Toeboard holder T 1.80m

**0,53 584392000**

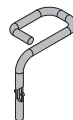

镀锌  
高度: 13,5 cm

**框架构造配套中间法兰**  
Intermediate flange for supp. constr. frame

**16,2 582911000**

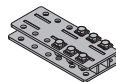

蓝色涂漆  
长度: 42,7 cm

**支撑靴 WU16**  
Supporting shoe WU16

**8,3 582912000**

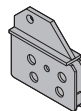

蓝色涂漆  
长度: 26,5 cm

**压力靴 T7/T16**  
Pressure shoe T7/T16

**18,5 582913000**



蓝色涂漆  
高度: 72,5 cm

**多功能围棧 SL-1 WU16 1.00m**  
**多功能围棧 SL-1 WU16 3.00m**  
Multi-purpose waling SL-1

**35,0 582877000**  
**107,0 582888000**

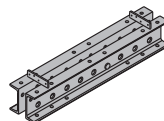

蓝色涂漆

**围棧连接件 SL-1 WU16 0.75m**  
Waling connector SL-1 WU16 0.75m

**31,0 582886000**

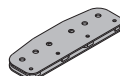

镀锌  
长度: 75 cm

**轮子连接器 F 2.40m**  
Wheel connector F 2.40m

**45,0 582922000**

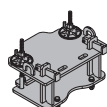

镀锌  
长度: 49 cm  
宽度: 36 cm  
高度: 25 cm

移动杆件支架 F 2.40m  
Travelling profile bracket F 2.40m

31,0 582924000

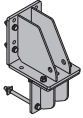

镀锌  
长度: 28,5 cm  
宽度: 22 cm  
高度: 48,2 cm

---

## 多卡安全系统

---



在标题为“Doka 安全系统”章节中  
你将找到施工和防护平台, 护栏系统  
和通道系统。