

Frami Xlife 模板	0.90x1.20m	39,0	588401500
Frami Xlife 模板	0.75x1.20m	33,5	588447500
Frami Xlife 模板	0.60x1.20m	29,5	588463500
Frami Xlife 模板	0.45x1.20m	24,0	588404500
Frami Xlife 模板	0.30x1.20m	19,5	588405500
Frami Xlife 模板	0.90x1.50m	46,5	588406500
Frami Xlife 模板	0.75x1.50m	41,3	588448500
Frami Xlife 模板	0.60x1.50m	35,5	588464500
Frami Xlife 模板	0.45x1.50m	28,9	588409500
Frami Xlife 模板	0.30x1.50m	24,8	588410500
Frami Xlife 模板	0.90x2.70m	79,2	588481500
Frami Xlife 模板	0.75x2.70m	69,5	588449500
Frami Xlife 模板	0.60x2.70m	60,5	588465500
Frami Xlife 模板	0.45x2.70m	49,5	588482500
Frami Xlife 模板	0.30x2.70m	40,3	588483500
Frami Xlife 模板	0.90x3.00m	86,5	588411500
Frami Xlife 模板	0.75x3.00m	76,5	588412500
Frami Xlife 模板	0.60x3.00m	65,0	588413500
Frami Xlife 模板	0.45x3.00m	54,3	588414500
Frami Xlife 模板	0.30x3.00m	45,0	588415500
Frami Xlife panel			

镀锌  
咨询定制尺寸!

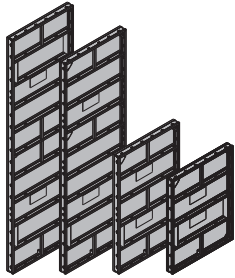

Frami Xlife 胶板	0.75x1.20m	39,0	588402500
Frami Xlife 胶板	0.75x1.50m	49,5	588407500
Frami Xlife 胶板	0.75x2.70m	83,5	588484500
Frami Xlife 胶板	0.75x3.00m	93,0	588416500
Frami Xlife universal panel	0.75m		

镀锌

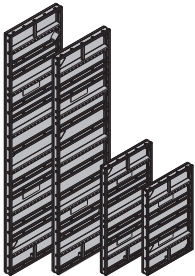

Frami Xlife 胶板	0.90x1.20m	47,2	588423500
Frami Xlife 胶板	0.90x1.50m	58,7	588424500
Frami Xlife 胶板	0.90x2.70m	106,4	588427500
Frami Xlife 胶板	0.90x3.00m	117,5	588428500
Frami Xlife universal panel	0.90m		

镀锌

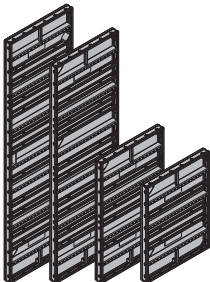

Frami 定型模板	0.60x1.20m	32,1	588403000
Frami 定型模板	0.60x1.50m	37,8	588408000
Frami anchoring panel			

镀锌  
绿色角件



Frami 内角模	1.20cm 20cm	25,3	588471000
Frami 内角模	1.50cm 20cm	30,7	588472000
Frami 内角模	2.70cm 20cm	51,6	588485000
Frami 内角模	3.00cm 20cm	57,4	588417000
Frami inside corner			

镀锌

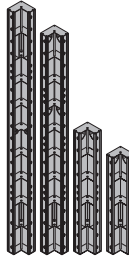

Frami 外角模	1.20cm	11,0	588459000
Frami 外角模	1.50cm	12,9	588460000
Frami 外角模	2.70cm	23,8	588461000
Frami 外角模	3.00cm	25,0	588418000
Frami outside corner			

镀锌

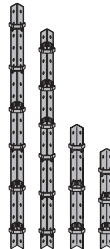

Frami 阴角铰链板块 I 镀锌	1.20m	34,1	588425500
Frami 阴角铰链板块 I 镀锌	1.50m	40,8	588426500
Frami hinged inside corner I galv.			

镀锌



Frami 铰接外角模 A 镀锌	1.20m	12,9	588419000
Frami 铰接外角模 A 镀锌	1.50m	16,0	588420000
Frami hinged outside corner A galv.			

镀锌



Frami 圆弧成型板 0.20x1.50m	21,5	588486000
Frami 圆弧成型板 0.25x1.50m	22,5	588487000
Frami 圆弧成型板 0.30x1.50m	23,5	588488000

Frami circular forming plate

蓝色粉末涂层



Frami 锚固围棧 0.40m	4,4	588489000
------------------	-----	-----------

Frami anchor waling 0.40m

蓝色涂漆

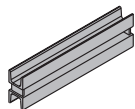

Frami 调节木块 10x9cm 1.50m	6,0	176035000
Frami 调节木块 5x9cm 1.50m	3,0	176034000
Frami 调节木块 3x9cm 1.50m	1,9	176033000
Frami 调节木块 2x9cm 1.50m	1,2	176032000
Frami 调节木块 10x9cm 2.70m	12,3	176083000
Frami 调节木块 5x9cm 2.70m	6,1	176082000
Frami 调节木块 3x9cm 2.70m	3,7	176081000
Frami 调节木块 2x9cm 2.70m	2,5	176080000

Frami fitting timber

黄色清漆

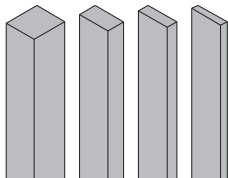

Frami 面板支撑 27mm	2,0	588473000
Frami 面板支撑 21mm	2,1	588474000
Frami 面板支撑 18mm	2,2	588499000

Frami plywood support

镀锌  
高度: 56 cm

Framax 脱模角 I 2.70m	171,0	588675000
Framax 脱模角 I 1.35m	90,0	588614000
Framax 脱模角 I 3.30m	209,9	588676000

Framax stripping corner I

镀锌, 粉末涂层

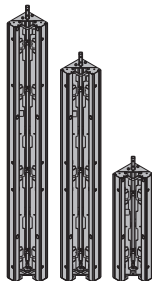

Framax 拆模轴杆 I	3,2	588618000
---------------	-----	-----------

Framax stripping spindle I

镀锌  
高度: 25 cm

Framax 带棘齿的拆模轴杆 I	5,5	588653000
-------------------	-----	-----------

Framax stripping spindle I with ratchet

镀锌  
高度: 24,8 cm

Framax 退模延伸组件 I	0,90	588947000
-----------------	------	-----------

Extension set Framax stripping spindle I

镀锌  
高度: 2,5 cm

Framax 退模拆除工具 I	4,5	588948000
-----------------	-----	-----------

Dismantling tool Framax stripping spindle I

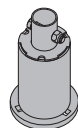
镀锌  
高度: 27,5 cm

Frami 对拉调解器 I	0,47	588492000
---------------	------	-----------

Frami tie-adapter for stripping corner I

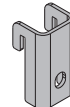
镀锌  
高度: 11 cm

Frami 适配杆件 脱模角 I	0,60	588491000
------------------	------	-----------

Frami profile adapter for stripping corner I

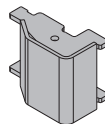
镀锌  
高度: 8 cm

Framax 快速安装夹 RU	3,3	588153400
-----------------	-----	-----------

Framax quick acting clamp RU

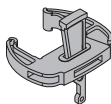
镀锌  
长度: 20 cm

Frami 模板金属箍	1,3	588490000
-------------	-----	-----------

Frami panel shoe

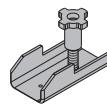
镀锌  
长度: 16 cm

Frami 夹具	1,2	588433000
----------	-----	-----------

Frami clamp

镀锌  
长度: 11 cm

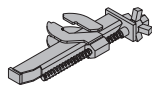
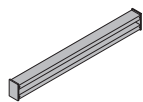
**Frami 矫正夹**  
Frami aligning clamp**3,2 588435000**镀锌  
长度: 62 cm**Frami 可调夹**  
Frami adjustable clamp**3,6 588436000**镀锌  
长度: 40 cm**Frami 通用围檩 0.70m**  
**Frami 通用围檩 1.25m**  
Frami universal waling**3,7 588439000**  
**6,4 588440000**

蓝色涂漆

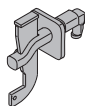
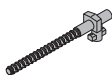
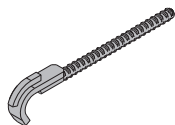
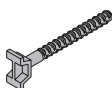
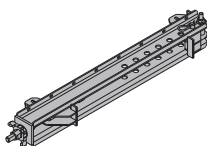
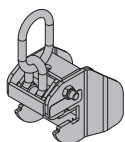
**Frami 楔形夹**  
Frami wedge clamp**1,1 588441000**镀锌  
长度: 16 cm**Frami 通用固定螺栓 5-12cm**  
Frami universal fixing bolt 5-12cm**0,43 588479000**镀锌  
长度: 23 cm**Frami 杆件连接件 5-18cm**  
Frami profile connector 5-18cm**0,80 588493000**镀锌  
长度: 33 cm**Frami 角部连接件**  
Frami corner connector**0,40 588446000**镀锌  
长度: 19 cm**Frami 墙体端部围檩 15-45cm**  
Frami stop-end waler tie 15-45cm**8,8 588498000**镀锌  
长度: 85 cm**Frami 提升挂钩**  
Frami lifting hook**7,5 588438000**镀锌  
宽度: 15 cm  
高度: 21 cm  
请遵守“操作说明书”中的指令!

CE

**浇注支撑 260 IB**  
Plumbing strut 260 IB**12,8 588437500**镀锌  
长度: 146,8 - 256,7 cm**模板侧支撑 340 IB**  
Panel strut 340 IB**24,3 580365000**

包括:

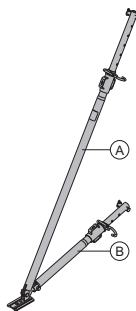
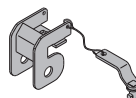
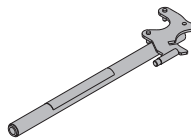
**(A) 浇注支撑 340 IB**镀锌  
长度: 190,8 - 341,8 cm**16,7 588696000****(B) 可调支撑 120 IB**镀锌  
长度: 81,5 - 130,6 cm**7,6 588248500**镀锌  
交货条件: 折叠件**支撑头 EB**  
Strut head EB**1,4 588945000**镀锌  
宽度: 9 cm  
高度: 14 cm**通用拆卸工具**  
Universal dismantling tool**3,7 582768000**镀锌  
长度: 75,5 cm**Doka 销钉 16x125mm**  
Doka express anchor 16x125mm**0,31 588631000**镀锌  
长度: 18 cm  
请遵守安装说明!**Doka 弹簧 16mm**  
Doka coil 16mm**0,009 588633000**镀锌  
直径: 1,6 cm

**Frami 支架 60** **7,7 588442000** **半边扣件 48mm 50** **0,84 682002000**  
 Frami bracket 60 Screw-on coupler 48mm 50

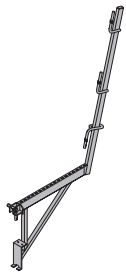

镀锌  
 长度: 98 cm  
 高度: 157 cm



镀锌  
 对边宽度: 22 mm

**Frami 框架孔塞** **0,002 588444000**  
 Frami frame hole plug



蓝色  
 直径: 2,5 cm

**走道板 60/270cm** **51,4 583030000** **Frami 塞子** **0,003 588445000**  
 Bracket planking 60/270cm Frami plug

镀锌钢件  
 黄清漆木工件  
 (没有图示)



黄色  
 直径: 2 cm

**支架扶手 240-270cm** **20,2 583032000** **Framax 三角凸缘 2.70m** **0,38 588170000**  
 Bracket railing 240-270cm Framax triangular ledge 2.70m

镀锌  
 (没有图示)



**Frami 可调框架** **14,3 588451000** **Frami 前端三角楔 2.70m** **1,5 588496000**  
 Frami adjustment frame Frami frontal triangular ledge 2.70m

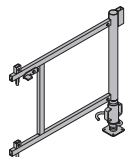

镀锌  
 长度: 103 cm  
 高度: 94 - 143 cm

**Frami 前端三角楔 3.00m** **1,7 588497000**  
 Frami frontal triangular ledge 3.00m

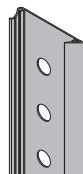

灰色

**扶手栏杆 1.00m** **3,8 584335000** **阳角夹 24cm** **3,3 580063000**  
 Handrail post 1.00m 阳角夹 25cm **3,4 580064000**  
 Box-out clamp **3,8 580065000**



镀锌  
 长度: 124 cm

**阳角夹 30cm** **3,8 580065000**  
 Box-out clamp

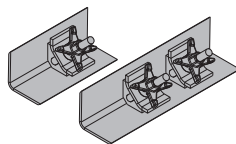

镀锌  
 支柱长度: 10 cm

**脚手管 48.3mm 0.50m** **1,7 682026000** **阳角夹 型号 1 ... cm** **13,6 580066000**  
**脚手管 48.3mm 1.00m** **3,6 682014000** **阳角夹 型号 2 ... cm** **15,0 580067000**  
**脚手管 48.3mm 1.50m** **5,4 682015000** **Box-out clamp ...cm**  
**脚手管 48.3mm 2.00m** **7,2 682016000**  
**脚手管 48.3mm 2.50m** **9,0 682017000**  
**脚手管 48.3mm 3.00m** **10,8 682018000**  
**脚手管 48.3mm 3.50m** **12,6 682019000**  
**脚手管 48.3mm 4.00m** **14,4 682021000**  
**脚手管 48.3mm 4.50m** **16,2 682022000**  
**脚手管 48.3mm 5.00m** **18,0 682023000**  
**脚手管 48.3mm 5.50m** **19,8 682024000**  
**脚手管 48.3mm 6.00m** **21,6 682025000**  
**脚手管 48.3mm .....m** **3,6 682001000**  
 Scaffold tube 48.3mm

镀锌

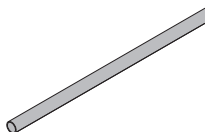

**Frami 锚固支架** **0,58 588453000**  
 Frami tie-holder bracket



镀锌

**脚手管连接** **0,27 584375000** **Frami 平拉杆 10-80m** **2,1 588475000**  
 Scaffold tube connection Frami flat tie-rod 10-80cm

镀锌  
 高度: 7 cm



镀锌  
 长度: 97 cm

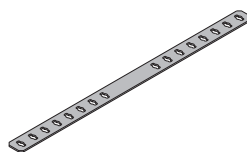

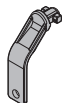
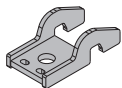
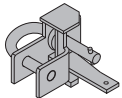
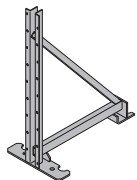
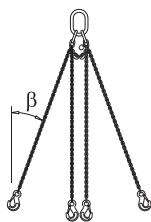
**Frami 夹子**  
Frami clip**0,26 588434000**镀锌  
宽度: 3 cm  
高度: 12 cm**Frami 地面固定装置**  
Frami floor fixing plate**0,53 588495000**镀锌  
长度: 12,7 cm  
宽度: 6,7 cm**Frami 基础夹**  
Frami foundation clamp**1,6 588452000**镀锌  
高度: 9 cm**Doka 多孔带 50x2.0mm 25m**  
Doka perforated tape 50x2.0mm 25m**17,0 588206000****支撑结构**  
Supporting construction**10,7 588477000**镀锌  
长度: 66 cm  
宽度: 37 cm  
高度: 91 cm**Doka 4段锁链 3.20m**  
Doka 4-part chain 3.20m**15,0 588620000**

请遵守“操作说明书”中的指令！

CE

**Frami 吊装挂钩 2.5kN**  
Frami transport hook 2.5kN**0,56 588494000**镀锌  
长度: 17,5 cm  
请遵守“操作说明书”中的指令！

CE

**Dokamatic 提升带 13.00m**  
Dokamatic lifting strap 13.00m**10,5 586231000**绿色  
请遵守“操作说明书”中的指令！

CE

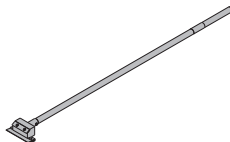
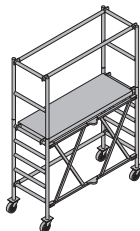
**双面铲子 Xlife 100/150mm 1.40m**  
Double scraper Xlife 100/150mm 1.40m**2,8 588674000****带轮支架 DF**  
Wheel-around scaffold DF**44,0 586157000**铝  
长度: 185 cm  
宽度: 80 cm  
高度: 255 cm  
交货条件: 折叠件  
请遵守“操作说明书”中的指令！**多卡安全系统**在标题为“Doka 安全系统”章节中  
你将找到施工和防护平台, 护栏系统  
和通道系统。