

| | | |
|---------------------------------|-------|-----------|
| 多用途钢围檩 WS10 Top50 0.50m | 10,2 | 580001000 |
| 多用途钢围檩 WS10 Top50 0.75m | 14,9 | 580002000 |
| 多用途钢围檩 WS10 Top50 1.00m | 19,6 | 580003000 |
| 多用途钢围檩 WS10 Top50 1.25m | 24,7 | 580004000 |
| 多用途钢围檩 WS10 Top50 1.50m | 29,7 | 580005000 |
| 多用途钢围檩 WS10 Top50 1.75m | 35,0 | 580006000 |
| 多用途钢围檩 WS10 Top50 2.00m | 38,9 | 580007000 |
| 多用途钢围檩 WS10 Top50 2.25m | 44,2 | 580008000 |
| 多用途钢围檩 WS10 Top50 2.50m | 48,7 | 580009000 |
| 多用途钢围檩 WS10 Top50 2.75m | 54,2 | 580010000 |
| 多用途钢围檩 WS10 Top50 3.00m | 60,2 | 580011000 |
| 多用途钢围檩 WS10 Top50 3.50m | 68,4 | 580012000 |
| 多用途钢围檩 WS10 Top50 4.00m | 79,4 | 580013000 |
| 多用途钢围檩 WS10 Top50 4.50m | 89,1 | 580014000 |
| 多用途钢围檩 WS10 Top50 5.00m | 102,0 | 580015000 |
| 多用途钢围檩 WS10 Top50 5.50m | 112,4 | 580016000 |
| 多用途钢围檩 WS10 Top50 6.00m | 118,0 | 580017000 |
| Multi-purpose waling WS10 Top50 | | |

蓝色涂漆

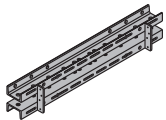

| | | |
|---------------------------------|-------|-----------|
| 多用途钢围檩 WU12 Top50 1.00m | 25,3 | 580018000 |
| 多用途钢围檩 WU12 Top50 1.25m | 32,0 | 580019000 |
| 多用途钢围檩 WU12 Top50 1.50m | 37,5 | 580020000 |
| 多用途钢围檩 WU12 Top50 1.75m | 44,2 | 580021000 |
| 多用途钢围檩 WU12 Top50 2.00m | 50,0 | 580022000 |
| 多用途钢围檩 WU12 Top50 2.50m | 63,1 | 580023000 |
| 多用途钢围檩 WU12 Top50 3.00m | 75,7 | 580024000 |
| 多用途钢围檩 WU12 Top50 3.50m | 90,7 | 580025000 |
| 多用途钢围檩 WU12 Top50 4.00m | 103,4 | 580026000 |
| Multi-purpose waling WU12 Top50 | | |

蓝色涂漆

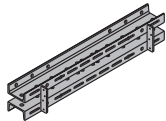

| | | |
|---------------------------|-------|-----------|
| 多功能围檩 SL-1 WU16 0.625m | 24,0 | 582875000 |
| 多功能围檩 SL-1 WU16 0.75m | 26,5 | 582876000 |
| 多功能围檩 SL-1 WU16 1.00m | 35,0 | 582877000 |
| 多功能围檩 SL-1 WU16 1.25m | 44,5 | 582878000 |
| 多功能围檩 SL-1 WU16 1.50m | 53,0 | 582879000 |
| 多功能围檩 SL-1 WU16 1.75m | 67,0 | 582880000 |
| 多功能围檩 SL-1 WU16 2.00m | 72,1 | 582881000 |
| 多功能围檩 SL-1 WU16 2.25m | 86,0 | 582882000 |
| 多功能围檩 SL-1 WU16 2.50m | 89,9 | 582883000 |
| 多功能围檩 SL-1 WU16 3.00m | 107,0 | 582888000 |
| Multi-purpose waling SL-1 | | |

蓝色涂漆

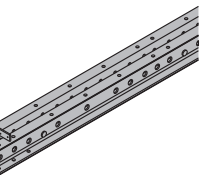

| | | |
|-----------------------------|------|-----------|
| 角部围檩 20 Corner waling 20 | 23,5 | 580031000 |
|-----------------------------|------|-----------|

蓝色涂漆

支柱长度: 52 cm

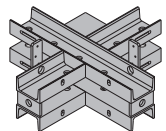

| | | |
|---|------|-----------|
| 竖井角部围檩 WS10 Top50m Shaft corner waling WS10 Top50m | 20,5 | 580069000 |
|---|------|-----------|

蓝色涂漆

请根据工程项目的具体情况而定！
也存在于 U120 剖面中（订货编号 WU12）。

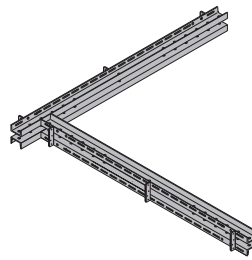

| | | |
|---|------|-----------|
| 角型 围檩 WS10 Top50m Angular waling WS10 Top50m | 21,5 | 580068000 |
|---|------|-----------|

蓝色涂漆

请根据工程项目的具体情况而定！
也存在于 U120 剖面中（订货编号 WU12）。

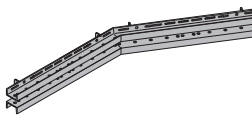

| | | |
|-----------------------------|-----|-----------|
| 法兰夹 H20 Flange clamp H20 | 1,0 | 580135000 |
|-----------------------------|-----|-----------|

镀锌

宽度: 13 cm
对边宽度: 19 mm

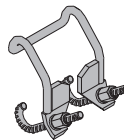

| | | |
|-------------------------|-----|-----------|
| 法兰夹 G Flange clamp G | 1,1 | 580120000 |
|-------------------------|-----|-----------|

镀锌

宽度: 13 cm
对边宽度: 19 mm



| | | |
|--------------------|-----|-----------|
| 法兰爪 Flange claw | 1,0 | 580137000 |
|--------------------|-----|-----------|

镀锌

宽度: 17 cm
对边宽度: 19 mm

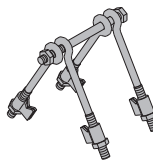

| | | |
|-----------------------------|------|-----------|
| 围檩夹 H20 Waling clamp H20 | 0,22 | 580114000 |
|-----------------------------|------|-----------|

镀锌

宽度: 8 cm
对边宽度: 13 mm



| | | |
|----------------------------------|------|-----------|
| 木梁螺栓 S 8/60 Beam screw S 8/60 | 0,06 | 580116000 |
|----------------------------------|------|-----------|

镀锌

长度: 7 cm
对边宽度: 13 mm



| | | |
|----------------------------------|------|-----------|
| 木梁螺栓 H 8/70 Beam screw H 8/70 | 0,06 | 580117000 |
|----------------------------------|------|-----------|

镀锌

长度: 8 cm
对边宽度: 13 mm

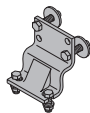
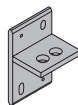
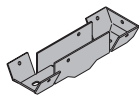
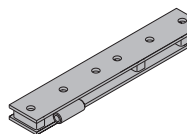
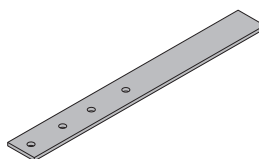
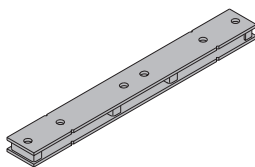
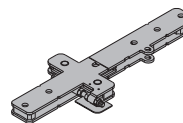
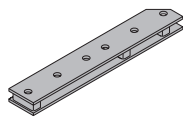
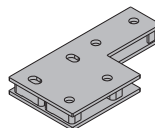
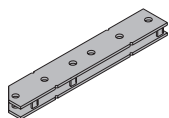
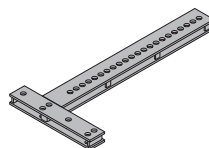
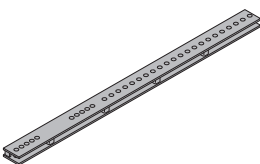

夹盘
Fastening plate蓝色涂漆
宽度: 13 cm
高度: 15 cm**2,7 580110000****木梁夹 Top50**
Beam clamp Top50蓝色涂漆
高度: 15 cm**1,2 580081000****H20 防护帽**
Protective cap H20镀锌
长度: 20 cm
宽度: 7 cm**0,36 587248000****锚固板 FF20/35**
Anchoring plate FF20/50蓝色涂漆
长度: 55 cm**6,6 587531000****提升吊环**
Lifting bracket镀锌
高度: 59 cm**6,2 580460000****半结合板**
Half splice plate蓝色涂漆
长度: 78 cm**5,2 580267000****接合板 Top50 Z**
Splice plate Top50 Z蓝色涂漆
长度: 76 cm**8,5 580074000****可调连接件**
Splice plate with join adjustment蓝色涂漆
长度: 76 cm**13,8 580215000****模板板块连接器 FF20/50**
Formwork element connector FF20/50蓝色涂漆
长度: 55 cm**6,3 587530000****偏移盘 FF20**
Offset plate FF20蓝色涂漆
长度: 35 cm
宽度: 18 cm
高度: 4 cm**6,2 587534000****模板板块连接器 FF20/50 Z**
Formwork element connector FF20/50 Z蓝色涂漆
长度: 55 cm**6,0 587533000****内部角板 H20 Top50**
Internal angle plate H20 Top50蓝色涂漆
长度: 80 cm
宽度: 38 cm**11,3 580035000****可调围檩连接件 1.40m Top50**
Adjustable waling extension 1.40m Top50

蓝色涂漆

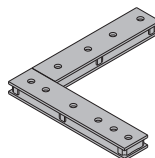
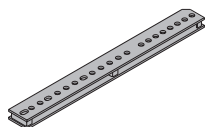
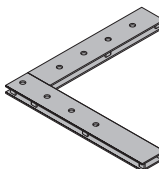
15,0 580075000**角部板 H20/H36 Top50**
Corner plate H20/H36 Top50蓝色涂漆
长度: 49,7 cm
宽度: 45,1 cm**10,0 580078000****可调围檩延长件 FF20/50**
Adjustable waling extension FF20/50蓝色涂漆
长度: 87 cm**9,1 587532000****竖井围檩方形板**
Shaft waling squaring plate蓝色涂漆
支柱长度: 60 cm**9,6 580262000**

角部连接板 18mm
角部连接板 21mm
Transition plate

16,0 588654000
15,8 588656000

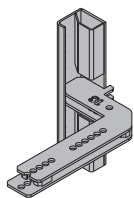

蓝色涂漆
长度: 54 cm
宽度: 30 cm
高度: 51 cm

柱模提升吊环
Lifting bracket for column formwork

65,0 580607000

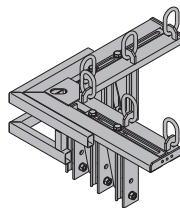

镀锌, 粉末涂层
长度: 85 cm
宽度: 85 cm

围檩连接件 SL-1 WU16 0.75m
Waling connector SL-1 WU16 0.75m

31,0 582886000



镀锌
长度: 75 cm

可调角度连接件 A Top50 度
Articulated conn. plate A Top50 degrees

20,0 580208000

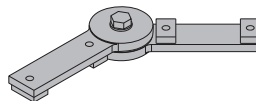

镀锌
支柱长度: 36 cm

角部轴杆
Corner spindle

17,5 580264000

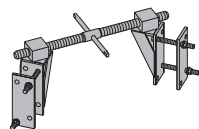

镀锌
长度: 65 cm
高度: 31 cm

转向连接板
Swivel joint plate

20,0 587542000

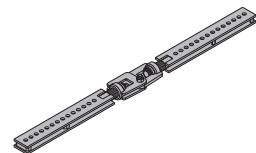

镀锌
长度: 155 cm

角部连接片 90/50
Corner connecting plate 90/50

13,8 580603000

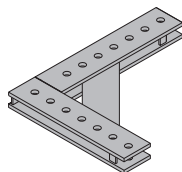

蓝色涂漆
长度: 51 cm
宽度: 40 cm

连接销钉 10cm
Connecting pin 10cm

0,34 580201000

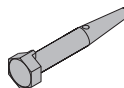

镀锌
长度: 14 cm

转角连接器
Universal angle tie bracket

4,4 580604000

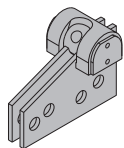

蓝色涂漆
长度: 20 cm

连接销钉 25cm
Connecting pin 25cm

0,58 580202000

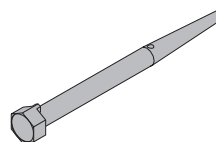

镀锌
长度: 25 cm

角部拉接板 20.0 SL-1 WU16
Angle tie bracket 20.0 SL-1 WU16

8,1 587543000

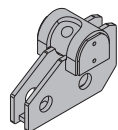

蓝色涂漆
长度: 24 cm

弹簧卡 5mm
Spring cotter 5mm

0,05 580204000



镀锌
长度: 13 cm

柱连接板 6/8
Column connecting plate 6/8

15,0 580072000

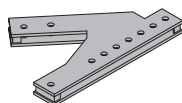

蓝色涂漆
长度: 58 cm

堆叠盘 H20
Stacking plate H20

8,3 580310000



镀锌
长度: 68,8 cm

[kg] 产品编号

内角板 3.00m
内角板 4.00m
Inside corner plate

53,0 580282000
69,0 580284000

蓝色粉末涂层

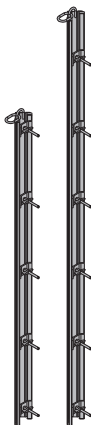

连接盘 3.00m
连接盘 4.00m
Joint plate

36,8 580332000
51,2 580334000

蓝色粉末涂层

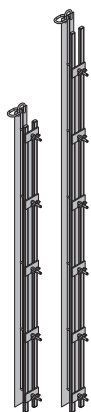

T 型楔块 21/42 2.00m
T ledge 21/42 2.00m

0,34 580196000

灰色



阳角夹 24cm
阳角夹 25cm
阳角夹 30cm
Box-out clamp

3,3 580063000
3,4 580064000
3,8 580065000

镀锌

支柱长度: 10 cm

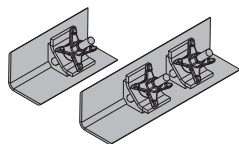

阳角夹 型号 1cm
阳角夹 型号 2cm
Box-out clampcm

13,6 580066000
15,0 580067000

蓝色油漆

支柱长度: 10 cm

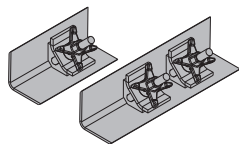

模板侧支撑 340 IB
Panel strut 340 IB

24,3 580365000

包括:

(A) 浇注支撑 340 IB

16,7 588696000

镀锌

长度: 190,8 - 341,8 cm

(B) 可调支撑 120 IB

7,6 588248500

镀锌

长度: 81,5 - 130,6 cm

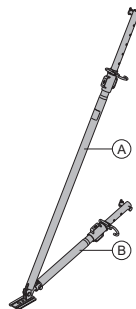

镀锌

交货条件: 折叠件

模板侧支撑 540 IB
Panel strut 540 IB

41,4 580366000

包括:

(A) 浇注支撑 540 IB

30,7 588697000

镀锌

长度: 310,5 - 549,2 cm

(B) 可调支撑 220 IB

10,9 588251500

镀锌

长度: 172,5 - 221,1 cm

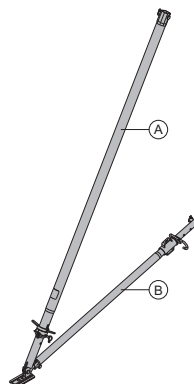

镀锌

交货条件: 折叠件

Eurex 60 550 型支撑顶托
Eurex 60 550

根据要求的长度, 包括:

- (A) **支撑 Eurex 60 550** **42,5 582658000**
蓝色粉末涂层
铝
长度: 343 - 553 cm
- (B) **Eurex 60 延伸件 2.00m** **21,3 582651000**
蓝色粉末涂层
铝
长度: 250 cm
- (C) **扣件 Eurex 60** **8,6 582652000**
铝
长度: 100 cm
直径: 12,8 cm
- (D) **连接器 Eurex 60 IB** **4,2 582657500**
镀锌
长度: 15 cm
宽度: 15 cm
高度: 30 cm
- (E) **支撑靴 Eurex 60 EB** **8,0 582660500**
镀锌
长度: 31 cm
宽度: 12 cm
高度: 33 cm
- (F) **可调支撑 540 Eurex 60 IB** **27,8 582659500**
镀锌
长度: 303,5 - 542,2 cm

交货条件: 单独部件

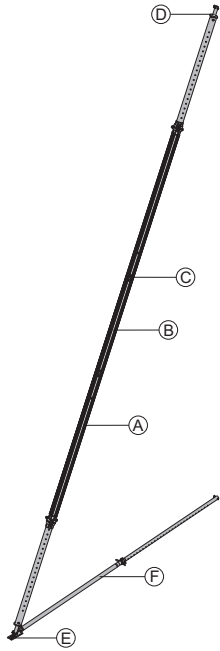
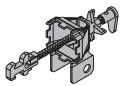
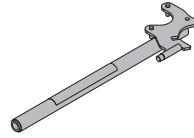
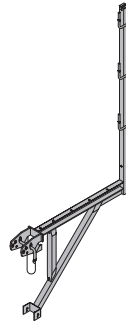
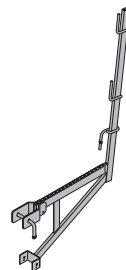
**支撑头 EB**
Prop head EB**3,1 588244500**镀锌
长度: 40,8 cm
宽度: 11,8 cm
高度: 17,6 cm**支撑头 Eurex 60 Top50**
Prop head Eurex 60 Top50**7,1 582665000**镀锌
高度: 50 cm**通用拆卸工具**
Universal dismantling tool**3,7 582768000**镀锌
长度: 75,5 cm**Doka 销钉 16x125mm**
Doka express anchor 16x125mm**0,31 588631000**镀锌
长度: 18 cm
请遵守安装说明!**Doka 弹簧 16mm**
Doka coil 16mm**0,009 588633000**镀锌
直径: 1,6 cm**浇筑平台 60**
Universal bracket 60**14,0 580477000**镀锌
长度: 86 cm
高度: 181 cm**浇筑平台 90**
Universal bracket 90**30,4 580476000**镀锌
长度: 121 cm
高度: 235 cm**上层浇筑平台 L**
Top scaffold bracket L**12,6 587153500**镀锌
长度: 101 cm
高度: 159 cm

| | | |
|------------------|------|-----------|
| 走道板 60/250cm | 48,7 | 583029000 |
| 走道板 90/250cm | 61,0 | 583031000 |
| Bracket planking | | |

镀锌钢件
黄清漆木工件
(没有图示)

| | | |
|---------------------------|------|-----------|
| 支架扶手 240-270cm | 20,2 | 583032000 |
| Bracket railing 240-270cm | | |

镀锌
(没有图示)

| | | |
|---------------------------|-----|-----------|
| 通用栏杆扣件 | 3,0 | 580478000 |
| Universal railing shackle | | |



镀锌
高度: 20 cm

| | | |
|--------------------------|------|-----------|
| 脚手管连接 | 0,27 | 584375000 |
| Scaffold tube connection | | |



镀锌
高度: 7 cm

| | | |
|----------------------|------|-----------|
| 脚手管 48.3mm 0.50m | 1,7 | 682026000 |
| 脚手管 48.3mm 1.00m | 3,6 | 682014000 |
| 脚手管 48.3mm 1.50m | 5,4 | 682015000 |
| 脚手管 48.3mm 2.00m | 7,2 | 682016000 |
| 脚手管 48.3mm 2.50m | 9,0 | 682017000 |
| 脚手管 48.3mm 3.00m | 10,8 | 682018000 |
| 脚手管 48.3mm 3.50m | 12,6 | 682019000 |
| 脚手管 48.3mm 4.00m | 14,4 | 682021000 |
| 脚手管 48.3mm 4.50m | 16,2 | 682022000 |
| 脚手管 48.3mm 5.00m | 18,0 | 682023000 |
| 脚手管 48.3mm 5.50m | 19,8 | 682024000 |
| 脚手管 48.3mm 6.00m | 21,6 | 682025000 |
| 脚手管 48.3mmm | 3,6 | 682001000 |
| Scaffold tube 48.3mm | | |

镀锌

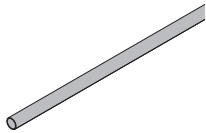

| | | |
|--------------------------|------|-----------|
| 半边扣件 48mm 50 | 0,84 | 682002000 |
| Screw-on coupler 48mm 50 | | |

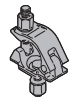

镀锌
对边宽度: 22 mm

| | | |
|--------------------------------------|-------|-----------|
| Framax 浇注平台 U 1.25/2.70m | 127,5 | 588377000 |
| Framax pouring platform U 1.25/2.70m | | |

镀锌钢件
黄清漆木工件
交货条件: 折叠件

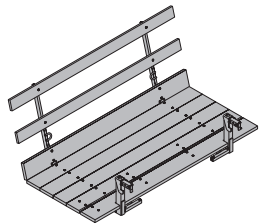

| | | |
|---|------|-----------|
| Framax 浇筑平台 U 调解件 Top50 | 18,5 | 588384000 |
| Top50 adapter for Framax pouring platform U | | |

镀锌
宽度: 75 cm
高度: 134 cm

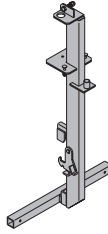

| | | |
|-------------------------------|------|-----------|
| 侧扶手夹紧单元 T | 29,1 | 580488000 |
| Side handrail clamping unit T | | |

镀锌
长度: 115 - 175 cm
高度: 112 cm

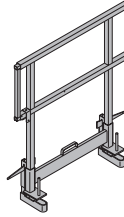

| | | |
|-----------------------|------|-----------|
| 扶手栏杆 T 1.80m | 17,7 | 584373000 |
| Handrail post T 1.80m | | |

镀锌

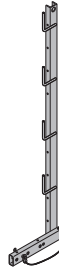

| | | |
|-------------------------|------|-----------|
| 下部围护板固定装置 T 1.80m | 0,53 | 584392000 |
| Toeboard holder T 1.80m | | |

镀锌
高度: 13,5 cm

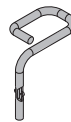

| | | |
|---------------------|------|-----------|
| 扶手栏杆 1.50m | 12,4 | 582754000 |
| Handrail post 1.50m | | |

镀锌



| | | |
|--------------------------------------|-------|-----------|
| Framax 浇注平台 U 1.25/2.70m | 127,5 | 588377000 |
| Framax pouring platform U 1.25/2.70m | | |

镀锌钢件
黄清漆木工件
交货条件: 折叠件

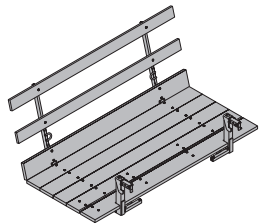

| | | |
|-------------------------|------|-----------|
| Doka 4段锁链 3.20m | 15,0 | 588620000 |
| Doka 4-part chain 3.20m | | |

请遵守“操作说明书”中的指令!

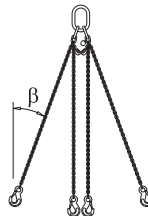

CE

通用支撑 T5/5mm
Universal strut T5/5mm

6,5 584311000

蓝色涂漆
每纵尺重量



轴杆支撑 T10 350/400cm
轴杆支撑 T10mm
Spindle strut T10

57,5 584328000
16,9 584391000



轴杆支撑 GS T5 65/101cm
Spindle strut GS T5 65/101cm

9,1 584356000

镀锌

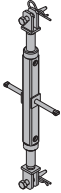

轴杆支撑 T6 73/110cm
轴杆支撑 T6 100/150cm
Spindle strut T6

10,2 584355000
12,5 584323000

镀锌

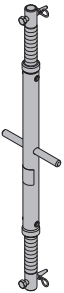

通用可调支腿 T8
Universal spindle foot T8

8,6 584314000

蓝色涂漆
镀锌
高度: 30 cm

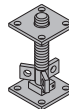

轴杆支撑 GS T6 95/140cm
Spindle strut GS T6 95/140cm

10,3 584340000

镀锌



模板木梁高度调节器
Height adjuster for formwork beams

11,9 580218000

镀锌
高度: 46 cm

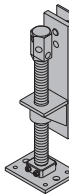

轴杆支撑 T7 75/110cm
轴杆支撑 T7 100/150cm
轴杆支撑 T7 150/200cm
轴杆支撑 T7 200/250cm
轴杆支撑 T7 250/300cm
轴杆支撑 T7 305/355cm
Spindle strut T7

13,2 584308000
16,8 584309000
21,6 584324000
26,2 584325000
29,4 584326000
35,0 584327000

镀锌

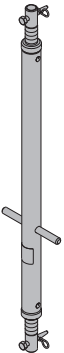

高度调节器 WS10-WU16
Height adjuster WS10-WU16

10,1 580206500

镀锌
高度: 45 cm

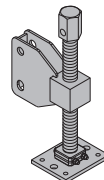

可调式轴杆 M36
Adjusting spindle M36

6,2 500663002

镀锌
长度: 31 cm
高度: 29,2 cm

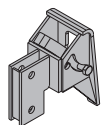
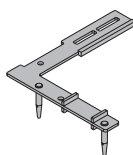
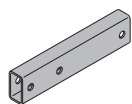
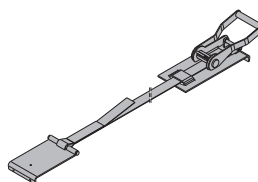

悬挂头 WS10
Suspension head WS10**8,1 580449000**镀锌
长度: 21 cm
宽度: 18 cm
高度: 23 cm**组装角尺 Top50**
Assembly angle Top50**6,7 580082000**镀锌
长度: 53,2 cm
宽度: 48,6 cm**通用支撑 Top50mm**
Universal support Top50mm**11,1 584312000**蓝色涂漆
每纵尺重量**组装绑带 B 5.00m**
Strip tensioner B 5.00m**3,5 580394000**

镀锌

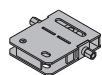
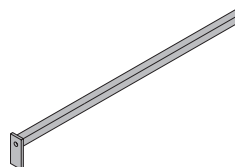
调整板 T
Adjusting plate T**6,5 584393000**蓝色涂漆
长度: 23,5 cm**定位钉m**
Positioning railm**1,8 580079000**蓝色涂漆
每纵尺重量**工具箱 GF**
Tool box GF**6,5 580390000**

包括在供应范围内:

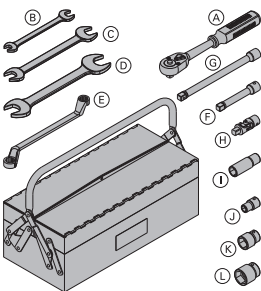
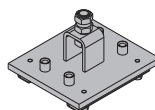
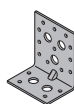
(A) 棘轮扳手 1/2"镀锌
长度: 30 cm**(B) 开口扳手 13/17****0,08 580577000****(C) 开口扳手 22/24****0,22 580587000****(D) 开口扳手 30/32****0,80 580897000****(E) 梅花双头扳手 17/19****0,27 580590000****(F) 套筒加长杆 11cm 1/2"****0,20 580581000****(G) 套筒加长杆 22cm 1/2"****0,31 580582000****(H) 套筒万向接头****0,16 580583000****(I) 扳手套筒 19 1/2" L****0,16 580598000****(J) 扳手套筒 13 1/2"****0,06 580576000****(K) 扳手套筒 24 1/2"****0,12 580584000****(L) 扳手套筒 30 1/2"****0,20 580575000****孔衡量 Top50**
Hole gauge Top50**2,9 580080000**蓝色涂漆
长度: 17 cm
宽度: 15 cm
工具: 钻头 (直径 10 mm)**角度连接器 9x5cm**
Angle connector 9x5cm**0,22 580381000**

镀锌

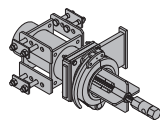
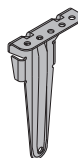
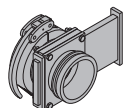
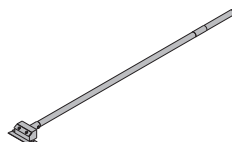
右檐板
左檐板
Rafter plate**0,09 582521000****0,09 582522000**镀锌
长度: 17 cm**填料颈 GF SCC**
Filler neck GF SCC**39,0 580217000**镀锌
长度: 66 cm**模板面板挂架 H20**
H20 screw-on bracket for formwork sheets**0,19 586256000**镀锌
高度: 19,2 cm**面板封闭工具 D125 SCC**
Panel closure tool D125 SCC**18,0 588127000**镀锌
长度: 18 cm
宽度: 33 cm
高度: 27 cm**双面铲子 Xlife 100/150mm 1.40m**
Double scraper Xlife 100/150mm 1.40m**2,8 588674000**

Doka 防坠保护马甲
Doka personal fall-arrest set

3,6 583022000

请遵守“操作说明书”中的指令！



多卡安全系统



在标题为“Doka 安全系统”章节中
你将找到施工和防护平台，护栏系统
和通道系统。