

Perfil multi-uso WS10 Top50 0,50m	10,2	580001000
Perfil multi-uso WS10 Top50 0,75m	14,9	580002000
Perfil multi-uso WS10 Top50 1,00m	19,6	580003000
Perfil multi-uso WS10 Top50 1,25m	24,7	580004000
Perfil multi-uso WS10 Top50 1,50m	29,7	580005000
Perfil multi-uso WS10 Top50 1,75m	35,0	580006000
Perfil multi-uso WS10 Top50 2,00m	38,9	580007000
Perfil multi-uso WS10 Top50 2,25m	44,2	580008000
Perfil multi-uso WS10 Top50 2,50m	48,7	580009000
Perfil multi-uso WS10 Top50 2,75m	54,2	580010000
Perfil multi-uso WS10 Top50 3,00m	60,2	580011000
Perfil multi-uso WS10 Top50 3,50m	68,4	580012000
Perfil multi-uso WS10 Top50 4,00m	79,4	580013000
Perfil multi-uso WS10 Top50 4,50m	89,1	580014000
Perfil multi-uso WS10 Top50 5,00m	102,0	580015000
Perfil multi-uso WS10 Top50 5,50m	112,4	580016000
Perfil multi-uso WS10 Top50 6,00m	118,0	580017000
Multi-purpose waling WS10 Top50		

pintado de azul

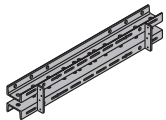

Perfil multi-uso WU12 Top50 1,00m	25,3	580018000
Perfil multi-uso WU12 Top50 1,25m	32,0	580019000
Perfil multi-uso WU12 Top50 1,50m	37,5	580020000
Perfil multi-uso WU12 Top50 1,75m	44,2	580021000
Perfil multi-uso WU12 Top50 2,00m	50,0	580022000
Perfil multi-uso WU12 Top50 2,50m	63,1	580023000
Perfil multi-uso WU12 Top50 3,00m	75,7	580024000
Perfil multi-uso WU12 Top50 3,50m	90,7	580025000
Perfil multi-uso WU12 Top50 4,00m	103,4	580026000
Multi-purpose waling WU12 Top50		

pintado de azul

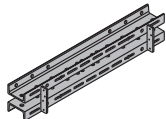

Perfil multi-uso SL-1 WU16 0,625m	24,0	582875000
Perfil multi-uso SL-1 WU16 0,75m	26,5	582876000
Perfil multi-uso SL-1 WU16 1,00m	35,0	582877000
Perfil multi-uso SL-1 WU16 1,25m	44,5	582878000
Perfil multi-uso SL-1 WU16 1,50m	53,0	582879000
Perfil multi-uso SL-1 WU16 1,75m	67,0	582880000
Perfil multi-uso SL-1 WU16 2,00m	72,1	582881000
Perfil multi-uso SL-1 WU16 2,25m	86,0	582882000
Perfil multi-uso SL-1 WU16 2,50m	89,9	582883000
Perfil multi-uso SL-1 WU16 3,00m	107,0	582888000
Multi-purpose waling SL-1		

pintado de azul

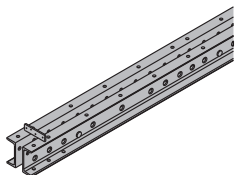

Perfil de canto 20	23,5	580031000
Corner waling 20		

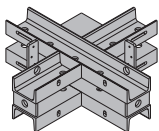
pintado de azul  
comprimento lateral: 52 cm

Perfil de canto WS10 Top50 .....m	20,5	580069000
Shaft corner waling WS10 Top50 .....m		

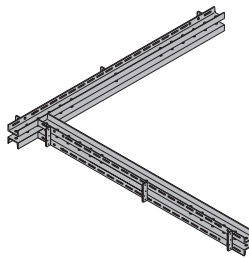
pintado de azul  
Em função do projecto!  
As cintas de canto Doka podem ser fornecidas também com o perfil U120 (Designação para encomenda: WU12).

Perfil angular WS10 Top50 .....m	21,5	580068000
Angular waling WS10 Top50 .....m		

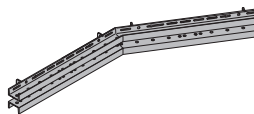
pintado de azul  
Em função do projecto!  
As cintas de canto Doka podem ser fornecidas também com o perfil U120 (Designação para encomenda: WU12).

Grampo de união H20	1,0	580135000
Flange clamp H20		

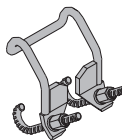
galvanizado  
largura: 13 cm  
tamanho de chave: 19 mm

Grampo de união G	1,1	580120000
Flange clamp G		

galvanizado  
largura: 13 cm  
tamanho de chave: 19 mm

Garra de união	1,0	580137000
Flange claw		

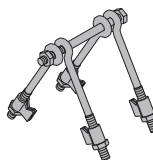
galvanizado  
largura: 17 cm  
tamanho de chave: 19 mm

Grampo de H20	0,22	580114000
Waling clamp H20		

galvanizado  
largura: 8 cm  
tamanho de chave: 13 mm

Parafuso de fixação de viga S 8/60	0,06	580116000
Beam screw S 8/60		

galvanizado  
comprimento: 7 cm  
tamanho de chave: 13 mm

Parafuso de fixação de viga H 8/70	0,06	580117000
Beam screw H 8/70		

galvanizado  
comprimento: 8 cm  
tamanho de chave: 13 mm

[kg] Artikel nr.

[kg] Artikel nr.

**Placa de fixação**

Fastening plate

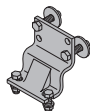
**2,7 580110000**

pintado de azul  
largura: 13 cm  
altura: 15 cm

**Presilha de viga Top50**

Beam clamp Top50

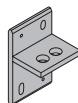
**1,2 580081000**

pintado de azul  
altura: 15 cm

**Proteção para topo de H20**

Protective cap H20

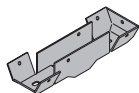
**0,36 587248000**

galvanizado  
comprimento: 20 cm  
largura: 7 cm

**Tala de ancoragem FF20/50**

Anchoring plate FF20/50

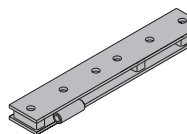
**6,6 587531000**

pintado de azul  
comprimento: 55 cm

**Gancho para içamento**

Lifting bracket

**6,2 580460000**

galvanizado  
altura: 59 cm

**Meia tala de união**

Half splice plate

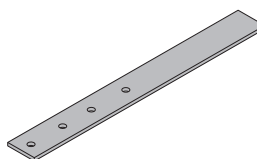
**5,2 580267000**

pintado de azul  
comprimento: 78 cm

**Tala de união Top50 Z**

Splice plate Top50 Z

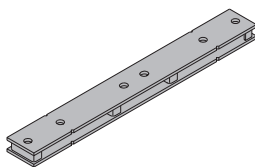
**8,5 580074000**

pintado de azul  
comprimento: 76 cm

**Tala de ligação ajustável**

Splice plate with join adjustment

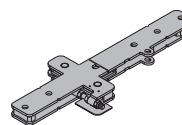
**13,8 580215000**

pintado de azul  
comprimento: 76 cm

**Tala de união FF20/50**

Formwork element connector FF20/50

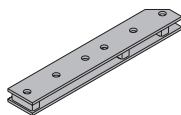
**6,3 587530000**

pintado de azul  
comprimento: 55 cm

**Tala de sobreposição FF20**

Offset plate FF20

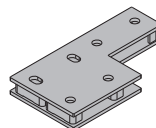
**6,2 587534000**

pintado de azul  
comprimento: 35 cm  
largura: 18 cm  
altura: 4 cm

**Tala de união FF20/50 Z**

Formwork element connector FF20/50 Z

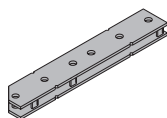
**6,0 587533000**

pintado de azul  
comprimento: 55 cm

**Esquadro de canto interior H20 Top50**

Internal angle plate H20 Top50

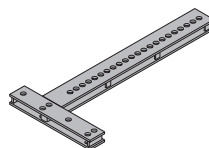
**11,3 580035000**

pintado de azul  
comprimento: 80 cm  
largura: 38 cm

**Tala de compensação 1,40m Top50**

Adjustable waling extension 1.40m Top50

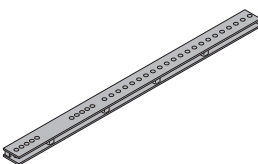
**15,0 580075000**

pintado de azul

**Esquadro de canto H20/H36 Top50**

Corner plate H20/H36 Top50

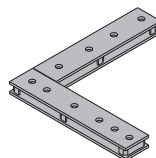
**10,0 580078000**

pintado de azul  
comprimento: 49,7 cm  
largura: 45,1 cm

**Tala de compensação FF20/50**

Adjustable waling extension FF20/50

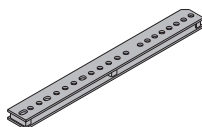
**9,1 587532000**

pintado de azul  
comprimento: 87 cm

**Tala de canto**

Shaft waling squaring plate

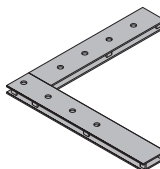
**9,6 580262000**

pintado de azul  
comprimento lateral: 60 cm

[kg] Artikel nr.

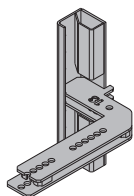
**Placa de transição 18mm**  
**Placa de transição 21mm**  
Transition plate**16,0 588654000**  
**15,8 588656000**pintado de azul  
comprimento: 54 cm  
largura: 30 cm  
altura: 51 cm

[kg] Artikel nr.

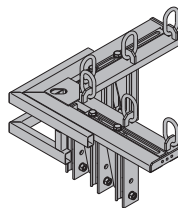
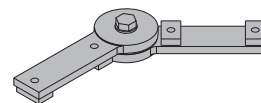
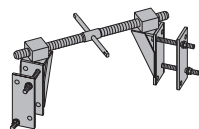
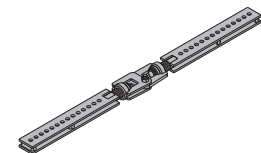
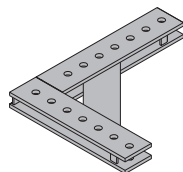
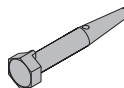
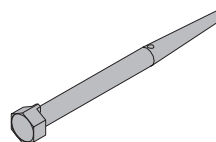
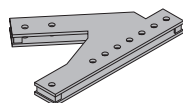
**Gancho para içamento para fôrma de pilares**  
Lifting bracket for column formwork**65,0 580607000**galvanizado, pintado de azul  
comprimento: 85 cm  
largura: 85 cm**Tala de união SL-1 WU16 0,75m**  
Waling connector SL-1 WU16 0.75m**31,0 582886000****Tala de união articulável A Top50 ..... graus**  
Articulated conn. plate A Top50 ..... degrees**20,0 580208000**galvanizado  
comprimento: 75 cmgalvanizado  
comprimento lateral: 36 cm**Tensor de canto**  
Corner spindle**17,5 580264000**galvanizado  
comprimento: 65 cm  
altura: 31 cm**Tala angular giratória**  
Swivel joint plate**20,0 587542000**galvanizado  
comprimento: 155 cm**Esquadro ligação de canto 90/50**  
Corner connecting plate 90/50**13,8 580603000**pintado de azul  
comprimento: 51 cm  
largura: 40 cm**Pino de união 10cm**  
Connecting pin 10cm**0,34 580201000**galvanizado  
comprimento: 14 cm**Ângulo universal de ancoragem para console**  
Universal angle tie bracket**4,4 580604000****Pino de união 25cm**  
Connecting pin 25cm**0,58 580202000**pintado de azul  
comprimento: 20 cmgalvanizado  
comprimento: 25 cm**Ângulo exterior orientável 20,0 SL-1 WU16**  
Angle tie bracket 20.0 SL-1 WU16**8,1 587543000****Contrapino 5mm**  
Spring cotter 5mm**0,05 580204000**pintado de azul  
comprimento: 24 cmgalvanizado  
comprimento: 13 cm**Tala para coluna 6/8**  
Column connecting plate 6/8**15,0 580072000****Tala de união H20**  
Stacking plate H20**8,3 580310000**pintado de azul  
comprimento: 58 cmgalvanizado  
comprimento: 68,8 cm

[kg] Artikel nr.

[kg] Artikel nr.

**Compensação de canto 3,00m****53,0 580282000****Compensação de canto 4,00m****69,0 580284000**

Inside corner plate

revestido com pó, azul

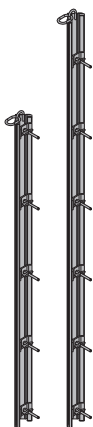
**Escora de prumo 340 IB****24,3 580365000**

Panel strut 340 IB

Constituído por:

**(A) Escora de ajuste 340 IB****16,7 588696000**

galvanizado

comprimento: 190,8 - 341,8 cm

**(B) Escora ajustável 120 IB****7,6 588248500**

galvanizado

comprimento: 81,5 - 130,6 cm

galvanizado

Estado de fornecimento: fechado

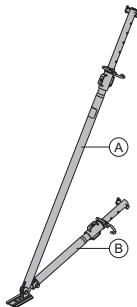
**Junta de compensação 3,00m****36,8 580332000****Junta de compensação 4,00m****51,2 580334000**

Joint plate

revestido com pó, azul

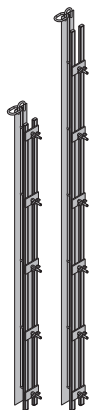
**Escora de prumo 540 IB****41,4 580366000**

Panel strut 540 IB

Constituído por:

**(A) Escora de ajuste 540 IB****30,7 588697000**

galvanizado

comprimento: 310,5 - 549,2 cm

**(B) Escora ajustável 220 IB****10,9 588251500**

galvanizado

comprimento: 172,5 - 221,1 cm

galvanizado

Estado de fornecimento: fechado

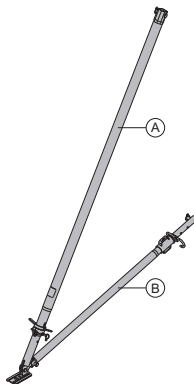
**Cantoneira plástica T 21/42 2,00m****0,34 580196000**

T ledge 21/42 2.00m

cinzento

**Chapa de compensação de canto 24cm****3,3 580063000****Chapa de compensação de canto 25cm****3,4 580064000****Chapa de compensação de canto 30cm****3,8 580065000**

Box-out clamp

galvanizado

comprimento lateral: 10 cm

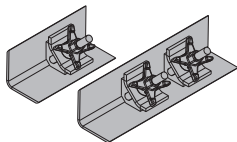
**Chapa de compensação de canto tipo 1 ....cm****13,6 580066000****Chapa de compensação de canto tipo 2 ....cm****15,0 580067000**

Box-out clamp .....cm

pintado de azul

comprimento lateral: 10 cm

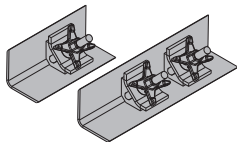

**Eurex 60 550**

Eurex 60 550

Conforme o comprimento necessário, constituído por:

- (A) **Escora de prumo Eurex 60 550** **42,5 582658000**  
revestido com pó, azul  
alumínio  
comprimento: 343 - 553 cm
- (B) **Extensão Eurex 60 2,00m** **21,3 582651000**  
revestido com pó, azul  
alumínio  
comprimento: 250 cm
- (C) **Acoplamento Eurex 60** **8,6 582652000**  
alumínio  
comprimento: 100 cm  
diâmetro: 12,8 cm
- (D) **Conector Eurex 60 IB** **4,2 582657500**  
galvanizado  
comprimento: 15 cm  
largura: 15 cm  
altura: 30 cm
- (E) **Base para escora de prumo Eurex 60 EB** **8,0 582660500**  
galvanizado  
comprimento: 31 cm  
largura: 12 cm  
altura: 33 cm
- (F) **Escora ajustável Eurex 60 540 IB** **27,8 582659500**  
galvanizado  
comprimento: 303,5 - 542,2 cm

Estado de fornecimento: peças individuais

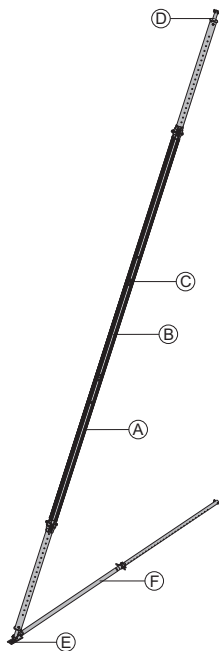
**Cabeça para escora de prumo EB**

Prop head EB

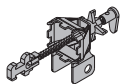
**3,1 588244500**galvanizado  
comprimento: 40,8 cm  
largura: 11,8 cm  
altura: 17,6 cm**Cabeça para escora de prumo Eurex 60 Top50**

Prop head Eurex 60 Top50

**7,1 582665000**galvanizado  
altura: 50 cm**Ferramenta de desmontagem universal**

Universal dismantling tool

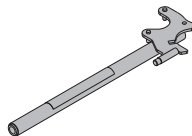
**3,7 582768000**galvanizado  
comprimento: 75,5 cm**Ancoragem expressa Doka 16x125mm**

Doka express anchor 16x125mm

**0,31 588631000**galvanizado  
comprimento: 18 cm  
Atenção às instruções de montagem!**Bucha espiral Doka 16mm**

Doka coil 16mm

**0,009 588633000**galvanizado  
diâmetro: 1,6 cm**Console universal 60**

Universal bracket 60

**14,0 580477000**galvanizado  
comprimento: 86 cm  
altura: 181 cm**Console universal 90**

Universal bracket 90

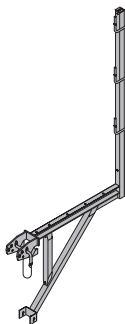
**30,4 580476000**galvanizado  
comprimento: 121 cm  
altura: 235 cm**Console de concretagem L**

Top scaffold bracket L

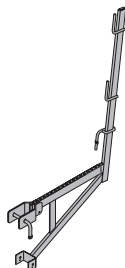
**12,6 587153500**galvanizado  
comprimento: 101 cm  
altura: 159 cm

[kg] Artikel nr.

[kg] Artikel nr.

<b>Plataforma para console 60/250m</b>	<b>48,7</b>	<b>583029000</b>
<b>Plataforma para console 90/250m</b>	<b>61,0</b>	<b>583031000</b>

Bracket planking

peças de aço galvanizadas  
peças de madeira envernizadas a amarelo  
(sem figura)

<b>Suporte de guarda-corpo 240-270cm</b>	<b>20,2</b>	<b>583032000</b>
--	-------------	------------------

Bracket railing 240-270cm

galvanizado  
(sem figura)

<b>Luva universal para guarda-corpo</b>	<b>3,0</b>	<b>580478000</b>
---	------------	------------------

Universal railing shackle



galvanizado  
altura: 20 cm

<b>Conector para tubo de contraventamento</b>	<b>0,27</b>	<b>584375000</b>
---	-------------	------------------

Scaffold tube connection



galvanizado  
altura: 7 cm

<b>Tubo de contraventamento 48,3mm 0,50m</b>	<b>1,7</b>	<b>682026000</b>
--	------------	------------------

<b>Tubo de contraventamento 48,3mm 1,00m</b>	<b>3,6</b>	<b>682014000</b>
--	------------	------------------

<b>Tubo de contraventamento 48,3mm 1,50m</b>	<b>5,4</b>	<b>682015000</b>
--	------------	------------------

<b>Tubo de contraventamento 48,3mm 2,00m</b>	<b>7,2</b>	<b>682016000</b>
--	------------	------------------

<b>Tubo de contraventamento 48,3mm 2,50m</b>	<b>9,0</b>	<b>682017000</b>
--	------------	------------------

<b>Tubo de contraventamento 48,3mm 3,00m</b>	<b>10,8</b>	<b>682018000</b>
--	-------------	------------------

<b>Tubo de contraventamento 48,3mm 3,50m</b>	<b>12,6</b>	<b>682019000</b>
--	-------------	------------------

<b>Tubo de contraventamento 48,3mm 4,00m</b>	<b>14,4</b>	<b>682021000</b>
--	-------------	------------------

<b>Tubo de contraventamento 48,3mm 4,50m</b>	<b>16,2</b>	<b>682022000</b>
--	-------------	------------------

<b>Tubo de contraventamento 48,3mm 5,00m</b>	<b>18,0</b>	<b>682023000</b>
--	-------------	------------------

<b>Tubo de contraventamento 48,3mm 5,50m</b>	<b>19,8</b>	<b>682024000</b>
--	-------------	------------------

<b>Tubo de contraventamento 48,3mm 6,00m</b>	<b>21,6</b>	<b>682025000</b>
--	-------------	------------------

<b>Tubo de contraventamento 48,3mm .....m</b>	<b>3,6</b>	<b>682001000</b>
---	------------	------------------

Scaffold tube 48.3mm

galvanizado

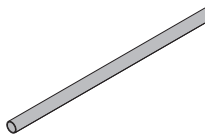

<b>Abraçadeira de aparafusar 48mm 50</b>	<b>0,84</b>	<b>682002000</b>
--	-------------	------------------

Screw-on coupler 48mm 50



galvanizado  
tamanho de chave: 22 mm

<b>Plataforma de concretagem Framax U 1,25/2,70m</b>	<b>127,5</b>	<b>588377000</b>
--	--------------	------------------

Framax pouring platform U 1.25/2.70m

peças de aço galvanizadas  
peças de madeira envernizadas a amarelo  
Estado de fornecimento: fechado

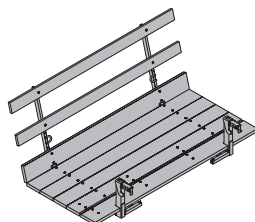

<b>Adapt. Top50 p/ plataf. de concret. Framax U</b>	<b>18,5</b>	<b>588384000</b>
---	-------------	------------------

Top50 adapter for Framax pouring platform U

galvanizado  
largura: 75 cm  
altura: 134 cm

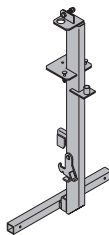

<b>Guarda-corpo lateral T</b>	<b>29,1</b>	<b>580488000</b>
-------------------------------	-------------	------------------

Side handrail clamping unit T

galvanizado  
comprimento: 115 - 175 cm  
altura: 112 cm

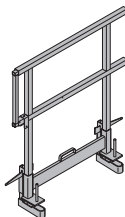

<b>Montante para guarda-corpo T 1,80m</b>	<b>17,7</b>	<b>584373000</b>
---	-------------	------------------

Handrail post T 1.80m

galvanizado

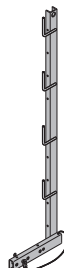

<b>Suporte para rodapé T 1,80m</b>	<b>0,53</b>	<b>584392000</b>
------------------------------------	-------------	------------------

Toeboard holder T 1.80m

galvanizado  
altura: 13,5 cm



<b>Montante de guarda-corpo 1,50m</b>	<b>12,4</b>	<b>582754000</b>
---------------------------------------	-------------	------------------

Handrail post 1.50m

galvanizado



<b>Corrente para içamento 4 pernas Doka 3,20m</b>	<b>15,0</b>	<b>588620000</b>
---	-------------	------------------

Doka 4-part chain 3.20m

Atenção às instruções de serviço!

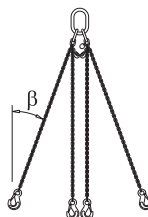

CE

[kg] Artikel nr.

**Haste T5/5 .....mm**

Universal strut T5/5 .....mm

**6,5 584311000**pintado de azul  
peso por m**Tensor de regulagem GS T5 65/101cm**

Spindle strut GS T5 65/101cm

**9,1 584356000**

galvanizado

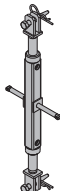
**Tensor de regulagem T6 73/110cm**

Spindle strut T6 73/110cm

**10,2 584355000**

Spindle strut T6

**12,5 584323000**

galvanizado

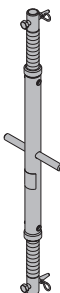
**Tensor de regulagem GS T6 95/140cm**

Spindle strut GS T6 95/140cm

**10,3 584340000**

galvanizado

**Tensor de regulagem T7 75/110cm**

Spindle strut T7 75/110cm

**13,2 584308000**

Tensor de regulagem T7 100/150cm

**16,8 584309000**

Tensor de regulagem T7 150/200cm

**21,6 584324000**

Tensor de regulagem T7 200/250cm

**26,2 584325000**

Tensor de regulagem T7 250/300cm

**29,4 584326000**

Tensor de regulagem T7 305/355cm

**35,0 584327000**

Spindle strut T7

galvanizado

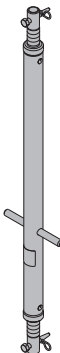
**Tensor de regulagem T10 350/400cm**

Tensor de regulagem T10 .....mm

**57,5 584328000**

Spindle strut T10

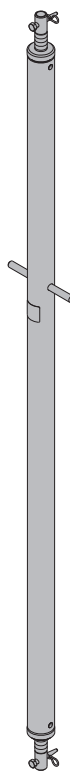
**16,9 584391000****Base universal T8**

Universal spindle foot T8

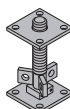
**8,6 584314000**pintado de azul  
galvanizado  
altura: 30 cm**Adaptador de altura para viga**

Height adjuster for formwork beams

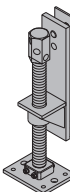
**11,9 580218000**galvanizado  
altura: 46 cm**Tensor de regulagem T7 75/110cm**

Spindle strut T7 75/110cm

**13,2 584308000**

Tensor de regulagem T7 100/150cm

**16,8 584309000**

Tensor de regulagem T7 150/200cm

**21,6 584324000**

Tensor de regulagem T7 200/250cm

**26,2 584325000**

Tensor de regulagem T7 250/300cm

**29,4 584326000**

Tensor de regulagem T7 305/355cm

**35,0 584327000**

Spindle strut T7

galvanizado

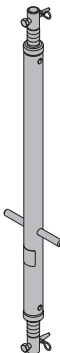
**Adaptador de altura WS10-WU16**

Height adjuster WS10-WU16

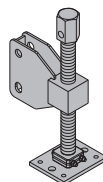
**10,1 580206500**galvanizado  
altura: 45 cm**Fuso de ajuste M36**

Adjusting spindle M36

**6,2 500663002**galvanizado  
comprimento: 31 cm  
altura: 29,2 cm

[kg] Artikel nr.

[kg] Artikel nr.

**Cabeça de suspensão WS10**

Suspension head WS10

8,1 580449000

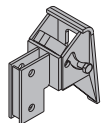

galvanizado  
comprimento: 21 cm  
largura: 18 cm  
altura: 23 cm

**Esquadro de montagem Top50**

Assembly angle Top50

6,7 580082000

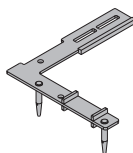

galvanizado  
comprimento: 53,2 cm  
largura: 48,6 cm

**Suporte universal Top50 .....mm**

Universal support Top50 .....mm

11,1 584312000

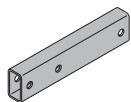

pintado de azul  
peso por m

**Cinta de carga com catraca B 5,00m**

Strip tensioner B 5.00m

3,5 580394000

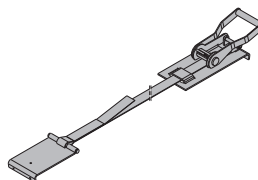

galvanizado

**Placa de ajuste T**

Adjusting plate T

6,5 584393000

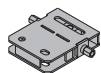

pintado de azul  
comprimento: 23,5 cm

**Perfil guia .....m**

Positioning rail .....m

1,8 580079000

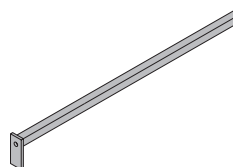

pintado de azul  
peso por m

**Caixa de ferramentas GF**

Tool box GF

6,5 580390000

Incluído no volume de fornecimento:

**(A) Chave de soquete 1/2"**

galvanizado  
comprimento: 30 cm

0,73 580580000

**(B) Chave fixa 13/17**

0,08 580577000

**(C) Chave fixa 22/24**

0,22 580587000

**(D) Chave fixa 30/32**

0,80 580897000

**(E) Chave fixa 17/19**

0,27 580590000

**(F) Extensão 11cm 1/2"**

0,20 580581000

**(G) Extensão 22cm 1/2"**

0,31 580582000

**(H) Cardan**

0,16 580583000

**(I) Soquete 19 1/2" L**

0,16 580598000

**(J) Soquete 13 1/2"**

0,06 580576000

**(K) Soquete 24 1/2"**

0,12 580584000

**(L) Soquete 30 1/2"**

0,20 580575000

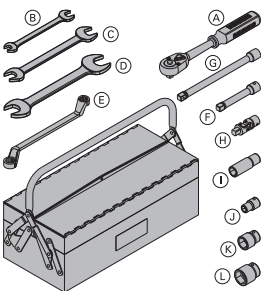
**Bitola de furação Top50**

Hole gauge Top50

2,9 580080000

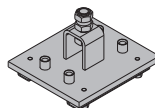

pintado de azul  
comprimento: 17 cm  
largura: 15 cm  
Ferramenta: Broca (diâmetro 10 mm)

**Cantoneira de ligação 9x5cm**

Angle connector 9x5cm

0,22 580381000

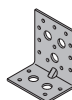

galvanizado

**Cantoneira direita para viga de madeira**

Rafter plate

0,09 582521000



galvanizado  
comprimento: 17 cm

**Válvula GF SCC**

Filler neck GF SCC

39,0 580217000

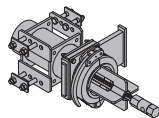

galvanizado  
comprimento: 66 cm

**Esquadro H20 parafusável para chapa**

H20 screw-on bracket for formwork sheets

0,19 586256000

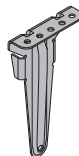

galvanizado  
altura: 19,2 cm

**Válvula de fechamento de painel D125 SCC**

Panel closure tool D125 SCC

18,0 588127000

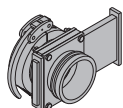

galvanizado  
comprimento: 18 cm  
largura: 33 cm  
altura: 27 cm

**Raspadeira dupla Xlife 100/150mm 1,40m**

Double scraper Xlife 100/150mm 1.40m

2,8 588674000

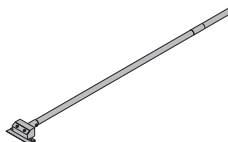



**Kit de segurança Doka**  
Doka personal fall-arrest set

**3,6 583022000**

Atenção às instruções de serviço!



---

**Doka Sistemas de segurança**

---



Plataformas de trabalho e protecção, segurança e acesso encontra no capítulo "Sistemas-Segurança-Doka"