



# Floor prop extension 0.50m

Art. n° 586011000

## User Information

Instructions for assembly and use



## Basic safety warnings

### User target groups

- This booklet is aimed at all persons who will be working with the Doka product or system that it describes. It contains information on the standard design for setting up this system, and on correct, compliant utilization of the system.
- All persons working with the product described herein must be familiar with the contents of this booklet and with all the safety instructions it contains.
- Persons who are incapable of reading and understanding this booklet, or who can do so only with difficulty, must be instructed and trained by the customer.
- The customer is to insure that the information materials provided by Doka (e.g. User Information booklets, Method Statements, Operating Instruction manuals, plans etc.) are up to date and available to all users, and that users have been made aware of them and have easy access to them at the usage location.
- In the relevant technical documentation and form-work utilization plans, Doka shows the workplace safety precautions that are necessary in order to use the Doka products safely in the usage situations shown.  
In all cases, users must ensure compliance with the national applicable laws, standards and rules throughout the entire project and to take appropriate additional or alternative workplace safety precautions where necessary.

### Hazard assessment

- The customer is responsible for drawing up, documenting, implementing and continually updating a hazard assessment at every job-site.  
This booklet serves as the basis for the site-specific hazard assessment, and for the instructions given to users on how to prepare and utilize the system. It does not substitute for these, however.

### Remarks on this booklet

- This document can be used as general Instructions for Assembly and Use (Method Statement) or be incorporated into site-specific Instructions for Assembly and Use (Method Statement).
- **The graphics, animations and videos in this document or app sometimes depict partially assembled assemblies and may require additional safety equipment and/or measures to comply with safety regulations.**  
The customer must ensure all applicable regulations are complied with, even if they are not shown or implied in the graphics, animations and videos provided.
- **Individual sections contain further safety instructions and/or special warnings as applicable.**

### Planning

- Provide safe workplaces for those using the form-work (e.g. for when it is being erected/dismantled, modified or repositioned etc). It must be possible to get to and from these workplaces via safe access routes!
- **If you are considering any deviation from the details and instructions given in this booklet, or any application which goes beyond those described in the booklet, then revised static calculations must be produced for checking, as well as supplementary assembly instructions.**

### Regulations; occupational health & safety

- All laws, Standards, industrial safety regulations and other safety rules applying to the application and utilization of our products in the country and/or region in which you are operating must be observed at all times.
- If a person or object falls against, or into, the side-guard component and/or any of its accessories, the component affected may only continue in use after it has been inspected and passed by an expert.

## Rules applying during all phases of the assignment:

- The customer shall ensure that this product is erected and dismantled, repositioned and generally used for its intended purpose in accordance with the applicable laws, standards and rules, under the direction and supervision of suitably skilled persons. These persons' mental and physical capacity shall not in any way be impaired by alcohol, medicines or drugs.
- Doka products are technical working appliances which are intended for industrial / commercial use only, always in accordance with the respective Doka User Information booklets or other technical documentation authored by Doka.
- The stability and load-bearing capacity of all components and units must be ensured during all phases of the construction work!
- Do not step on or apply strain to cantilevers, closures, etc. until suitable measures to ensure their stability have been correctly implemented (e.g. by tie-backs).
- The functional / technical instructions, safety warnings and loading data shall all be strictly observed and complied with. Non-compliance can cause accidents and severe injury (risk of fatality) and serious damage to property.
- Sources of fire in the vicinity of the formwork are prohibited. Heaters are permissible only when used correctly and situated a correspondingly safe distance from the formwork.
- Customer must give due consideration to any and all effects of the weather on the equipment and regards both its use and storage (e.g. slippery surfaces, risk of slipping, effects of the wind, etc.) and implement appropriate precautionary measures to secure the equipment and surrounding areas and to protect workers.
- All connections must be checked at regular intervals to ensure that they are secure and in full working order.  
In particular threaded connections and wedged connections have to be checked and retightened as necessary in accordance with activity on the jobsite and especially after out-of-the-ordinary occurrences (e.g. after a storm).
- It is strictly prohibited to weld or heat Doka products, particularly parts for anchoring, suspension or connecting, and also cast parts, etc.  
Welding radically changes the micro-structure of the materials of which these components are made. This leads to a drastic reduction in failure load, constituting a serious safety risk.  
It is permissible to cut individual tie rods to length with metal cutting discs (introduction of heat at the end of the rod only), but it is important to ensure that

flying sparks do not heat and thus damage other tie rods.

Welding work can be done only on the articles expressly mentioned in the Doka documents as being suitable for work of this nature.

## Assembly

- The equipment/system must be inspected by the customer before use, to ensure that it is in suitable condition. Steps must be taken to rule out the use of components that are damaged, deformed, or weakened due to wear, corrosion or rot (e.g. fungal decay).
- The use of our safety systems and formwork systems in combination with those of other manufacturers could be dangerous, risking injury to health and damage to property, and therefore requires separate verification by the user.
- The equipment/system must be assembled and erected in accordance with the applicable laws, standards and rules by suitably skilled personnel of the customer's, having regard to any and all required safety inspections.
- It is not permitted to modify Doka products; any such modifications constitute a safety risk.

## Erecting the formwork

- Doka products and systems must be set up in such a way that all loads acting upon them are safely transferred!

## Pouring

- Do not exceed the permitted fresh-concrete pressures. Excessively high pouring rates lead to formwork overload, cause greater deflection and risk causing breakage.

## Stripping the formwork

- Do not strip the formwork until the concrete has reached sufficient strength and the person in charge has given the order for the formwork to be stripped!
- When stripping the formwork, never use the crane to break concrete cohesion. Use suitable tools such as timber wedges, special pry-bars or system features such as Framax S bias-cut corners.
- When stripping the formwork, do not endanger the stability of any part of the structure, or of any scaffolding, platforms or formwork that is still in place!

## Transporting, stacking and storing

- Observe all country-specific regulations applying to the handling of formwork and scaffolding. For system formwork the Doka slinging means stated in this booklet must be used – this is a mandatory requirement.

If the type of sling is not specified in this booklet, the customer must use slinging means that are suitable for the application envisaged and that comply with the regulations.

- When lifting, always make sure that the unit to be lifted and its individual parts can absorb the forces that occur.
- Remove loose parts or secure them so that they cannot slip out of position and drop.
- When lifting formwork or formwork accessories with a crane, no persons must be carried along, e.g. on working platforms or in multi-trip packaging.
- All components must be stored safely, following all the special Doka instructions given in the relevant sections of this document!

## Maintenance

- Only original Doka components may be used as spare parts. Repairs may only be carried out by the manufacturer or authorized facilities.

## Miscellaneous

The weights are averages on the basis of new material. Actual weights can vary due to material tolerances. Weights can also differ on account of dirtying, moisture absorption, etc.

We reserve the right to make alterations in the interests of technical progress.

## Symbols

The following symbols are used in this document:



### DANGER

This is a notifier drawing attention to an extremely dangerous situation in which non-compliance with this notifier will lead to death or severe, irreversible injury.



### WARNING

This is a notifier drawing attention to a dangerous situation in which non-compliance with this notifier can lead to death or severe, irreversible injury.



### CAUTION

This is a notifier drawing attention to a dangerous situation in which non-compliance with this notifier can lead to slight, reversible injury.



### NOTE

This is a notifier drawing attention to a situation in which non-compliance with this notifier can lead to malfunctions or damage to property.



### Instruction

Indicates that actions have to be performed by the user.



### Visual inspection

Indicates that actions performed must be checked by means of a visual inspection.



### Tip

Draws attention to a useful tip for best-practice usage.



### Reference

Cross-references other documents.

## Floor prop extension 0.50m

### Intended use

The Floor prop extension 0.50m is an extension piece used to extend Doka floor props by 0.50 m (1'-7<sup>11</sup>/<sub>16</sub>").

Boundary conditions for use:

Observe the relevant information in the Doka technical documents.

Other use or use not in conformity with that stated above is non-intended use and requires the prior written approval from Doka!

### Product description

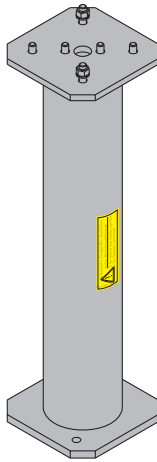

Included in the scope of supply of the Floor prop extension 0.50m:

- 2 hexagon bolts ISO 4017 M8x30 8.8 galvanized
- 2 x spring washers DIN 127 A8 spring steel, galvanized
- 2 x hexagon nuts ISO 4032 M8 8 galvanized



#### WARNING

▶ Alterations or modifications are strictly forbidden!

### Permissible load-bearing capacities



#### WARNING

**Using the Floor prop extension 0.50m reduces the permissible load-bearing capacity of the Floor prop Eurex 30 top and Eurex 30 eco to 7.8 kip (34.7 kN)!**

▶ Allow for the reduced load-bearing capacity when planning and when carrying out the assignment.

#### Permissible load-bearing capacity

Floor prop	Without Floor prop extension 0.50m	With Floor prop extension 0.50m
Eurex 20 top/eco	6 kip (26.7 kN)	6 kip (26.7 kN)
Eurex 30 top/eco	8.5 kip (37.8 kN)	<b>7.8 kip (34.7 kN)<sup>1)</sup></b>

<sup>1)</sup> Except Eurex 30 550 - no values available

## Assembly



### WARNING

Load-bearing capacity reduced!

- ▶ For head and baseplates of floor props, use only holes with a max. diameter of 10 mm ( $\frac{3}{8}$ ").



### CAUTION

- ▶ In the area covered by the diameter of the tubes, the baseplate of the floor prop and head plate of the floor prop extension must be resting flat against one another.
- ▶ The floor prop extension must align exactly with the outer tube.
- ▶ Components with bent flange plates must not be used for floor prop extensions!

Boundary conditions due to the design:

- The floor prop extension can only be mounted on the outer tube of the floor prop.
- It is not possible to join together several floor prop extensions.

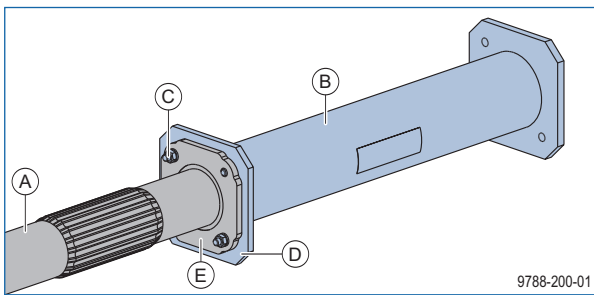

- A Doka floor prop
- B Floor prop extension 0.50m
- C Hexagon bolt M8x30 (8.8) with nut M8 (8) and spring washer A8 (included with product)
- D Head plate, Floor prop extension 0.50m
- E Baseplate, Doka floor prop

## Areas of use



### WARNING

- ▶ The following systems do not allow for the use of the Floor prop extension 0.50m, since the floor-prop heads in use already serve as an extension of the floor prop:  
DokaXdek panel floor formwork, Panel floor formwork Dokadek 20 and 30, Superdek, Doka Xtra.



### WARNING

- ▶ Use with Doka floor prop Eurex 20 top 700 is not permitted and in fact is not possible due to differences in design.

## Using with Doka tableforms



### NOTICE

The preferred method for lengthening the floor props of Tableforms is to use **Table frames 1.50m, (4'-11 $\frac{1}{16}$ "**).

As a temporary expedient, e.g. if bigger heights are needed in just one story, the Floor prop extension 0.50m may be used – provided that the following restrictions are observed:

- The Floor prop extension 0.50m may only be combined with Doka floor props Eurex top and Eurex eco.
  - Exception: Floor props Eurex 20 top 550 may only be extended using the Table frame 1.50m (4'-11 $\frac{1}{16}$ "!)
- Max. extension length **a** = 4.50 m (14'-9 $\frac{1}{16}$ " (floor prop plus Floor prop extension 0.50m).
- The floor props can only be used with their outer tubes at the bottom.

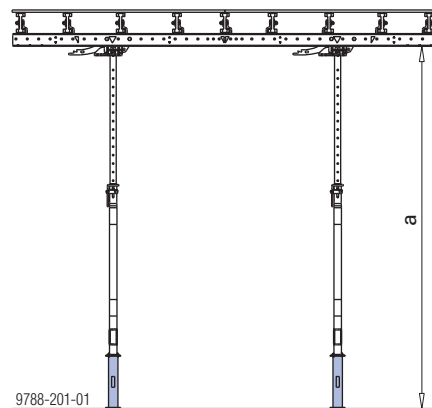

a ... max. 4.50 m (14'-9 $\frac{1}{16}$ "

## Using with Dokaflex

---



### NOTICE

- The Floor prop extension 0.50m may only be combined with Doka floor props Eurex top and Eurex eco.
- The floor props can only be used with their outer tubes at the bottom.

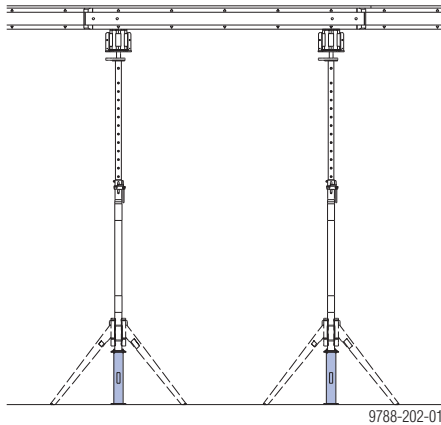

## Using with temporary repropping

---



### NOTICE

- The Floor prop extension 0.50m may only be combined with Doka floor props Eurex top and Eurex eco.
- The floor props can only be used with their outer tubes at the bottom.



Formwork & Scaffolding.  
**We make it work.**

---



[www.doka.com/floor-props](http://www.doka.com/floor-props)