

The Formwork Experts.

Floor prop extension 0.50m

Art. n° 586011000

User Information

Instructions for assembly and use

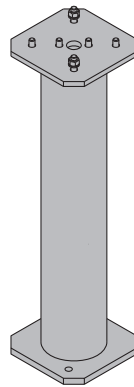

Product description

The Floor prop extension 0.50m (1'-7¹¹/₁₆"") is a lengthening-piece used to extend Doka floor props.



WARNING

- ▶ **Allow for the reduced load-bearing capacity when used with Eurex 30 top floor props!**
- ▶ Use with Doka floor prop Eurex 20 top 700 is not permitted and in fact not possible on account of differences in design.

Permitted load-bearing capacities **without** Floor prop extension 0.50m:

- Eurex 20 top: 6 kip
- Eurex 30 top: 8.5 kip

Permitted load-bearing capacities **with** Floor prop extension 0.50m:

- Eurex 20 top: 6 kip
- Eurex 30 top: **7.8 kip**

It is allowed to be used with the following formwork systems:

- Dokamatic and Dokaflex tables with Doka floor props Eurex 30 top and Eurex 20 top up to a max. prop length of 4.50 m (14'-9¹/₁₆"").
- Dokaflex 1-2-4 with Doka floor props Eurex 30 top, Eurex 20 top and Eco 20.

as well as for temporary shoring of floor-slabs with Doka floor props Eurex 30 top, Eurex 20 top and Eco 20.

The Floor prop extension 0.50m has been designed in such a way that:

- it can only be mounted on the outer tubes of floor props, and that
- it is not possible to join together several floor-prop extensions.



- ▶ Alterations or modifications are strictly forbidden!

Assembly



CAUTION

- ▶ In the area covered by the diameter of the tubes, the baseplates and flange-plates of the floor-prop extension must be resting flat against one another.
- ▶ The floor-prop extension must align exactly with the outer tube.
- ▶ Components with bent flange-plates must not be used for floor-prop extensions!

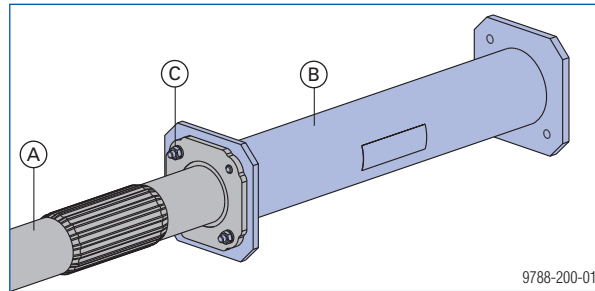

- A Doka floor prop
- B Floor prop extension 0.50m
- C Hexagonal bolt M8x30 (8.8) with nut M8 (8) and spring washer A8 (included with product)

Using with Doka tableforms



NOTICE

If the floor props need to be lengthened, this should, preferably, be done with **Dokamatic table frames 1.50m (4'-11¹/₁₆"**).

As a temporary expedient, e.g. if bigger heights are needed in just one storey, the Floor prop extension 0.50m may be used – provided that the following restrictions are observed:

- The Floor prop extension 0.50m may only be combined with Doka floor props Eurex 30 top and Eurex 20 top.
- Max. extension length $a = 4.50$ m (14'-9¹/₁₆") (floor prop plus Floor prop extension 0.50m)
- If Eurex floor props 20 top 550 need to be lengthened, this can only be done using Table frames 1.50m (4'-11¹/₁₆")!
- Allow for the reduced load-bearing capacity when planning and when carrying out the assignment.
- The floor props can only be used with their outer tubes at the bottom.

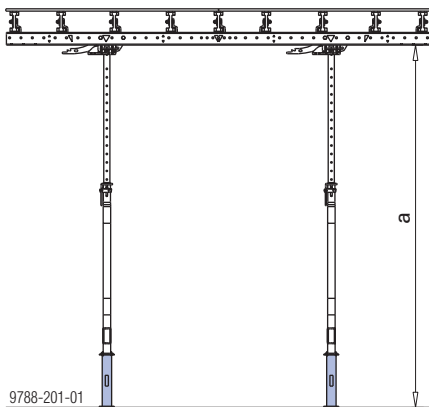

a ... max. 4.50 m (14'-9¹/₁₆")

Using with Dokaflex



NOTICE

- It is permitted to combine the Floor prop extension 0.50m with Doka floor props Eurex 30 top, Eurex 20 top and Eco 20.
- Allow for the reduced load-bearing capacity when planning and when carrying out the assignment.
- The floor props can only be used with their outer tubes at the bottom.

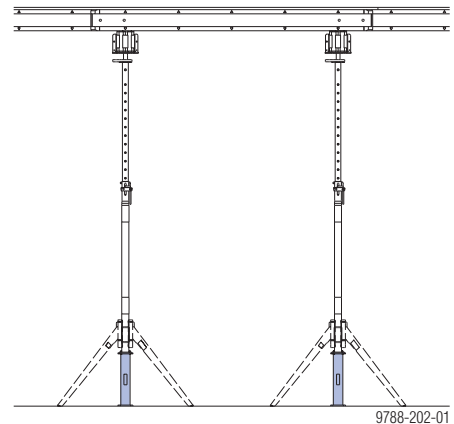

Using with temporary repropping



NOTICE

- It is permitted to combine the Floor prop extension 0.50m with Doka floor props Eurex 30 top, Eurex 20 top and Eco 20.
- Allow for the reduced load-bearing capacity when planning and when carrying out the assignment.
- The floor props may be used with their outer tubes either at the top or at the bottom.

Note on Doka Xtra and Dokadek 30



WARNING

- ▶ The function of the Doka Xtra head and the Dokadek 30 system heads means that it is already an extension of the floor prop in any case.
For this reason, it is not permitted to use the Floor prop extension 0.50m with Doka Xtra and Dokadek 30!

Near to you, worldwide

Doka is one of the world leaders in developing, manufacturing and distributing formwork technology for use in all fields of the construction sector.

With more than 160 sales and logistics facilities in over 70 countries, the Doka Group has a highly efficient distribution network which ensures that equipment and

technical support are provided swiftly and professionally.

An enterprise forming part of the Umdasch Group, the Doka Group employs a worldwide workforce of more than 6000.

