

The Formwork Experts.

# Bolt-on castor set B

Art. n°: 586168000

## User Information

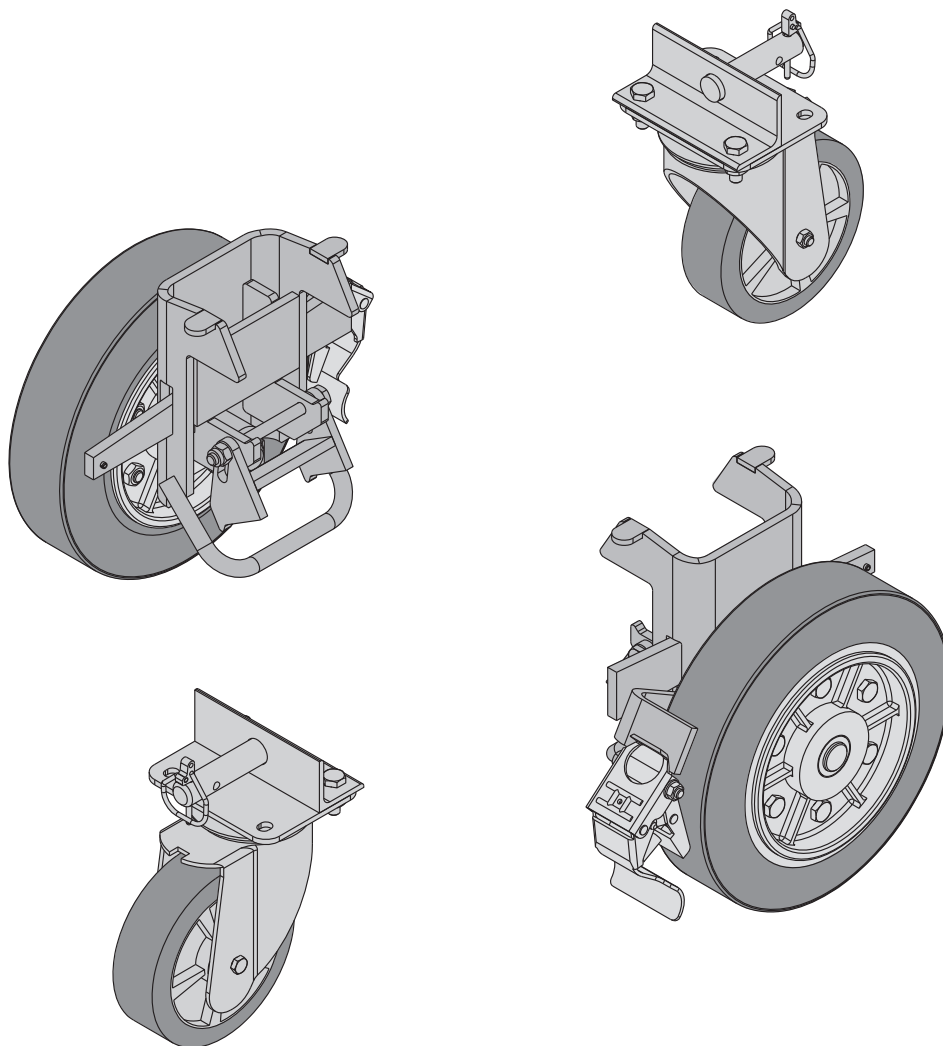

## Product description

The Bolt-on caster set B turns the stacking pallet into a fast and manoeuvrable transport device.

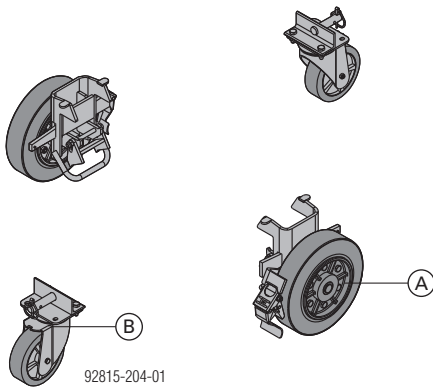

**A** Heavy-duty wheel

**B** Castor wheel

A Bolt-on castor set B consists of:

- 2 heavy-duty wheels
- 2 castor wheels

Total weight: 34 kg

The Bolt-on castor set B can be mounted to the following multi-trip packaging items:

- Doka stacking pallet
- Doka accessory box
- Dokadek infill beam pallet
- Protective barrier Z pallet

## Preconditions for use:



### WARNING

Do not use multi-trip packaging fitted with Bolt-on castor set B on slab formwork.

- ▶ There must be a flat, firm (e.g. concrete) base that is capable of supporting the load.



### NOTICE

- Max. gradient of floor 3%.
- Max. travel speed: 4 km/h (walking pace)
- Either close structure openings with decking of adequate strength secured so that it cannot slip out of place, or cordon off the openings with edge railings of adequate strength!
- Keep the travel route clean and free of any obstacles.
- It is forbidden to use any other mechanical assistance for the travelling operation!
- It is forbidden to wheel multi-trip packaging units that have been stacked on top of one another!

## Mounting the heavy-duty wheel on the inside

### Note:

**On stacking pallets manufactured up to and including 2007**

It is only possible to mount the heavy-duty wheels on the outside.

The instructions below describe installation on the stacking pallet. The procedure for installation on other multi-trip packing is identical.

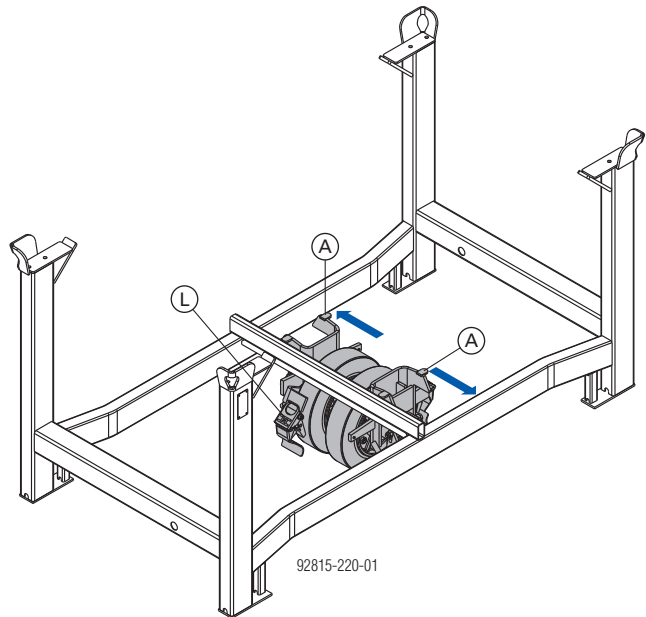

**A** Heavy-duty wheel

**L** Fixing brake

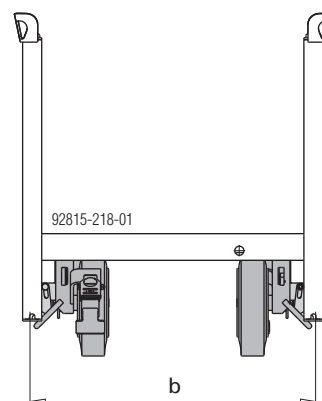

b ... < 900 mm

- ▶ Raise the stacking pallet by min. 'a'=120 mm by means of hardwood blocking.

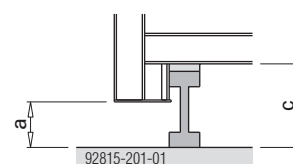

a ... 120 mm

c ... 220 mm

- ▶ Apply the fixing brake on the heavy-duty wheel.
- ▶ Loosen the tensioning wedge.

- ▶ Flip the adapter down.

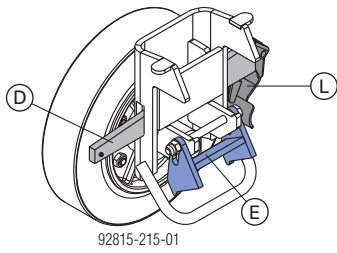

- D** Tensioning wedge
- E** Adapter
- L** Fixing brake

- ▶ Fit a formwork hammer between the handle and the mounting plate.
- ▶ Pass the heavy-duty wheel under the pallet.

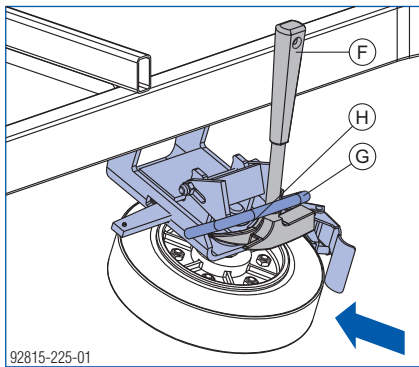

- F** Formwork hammer
- G** Handle
- H** Mounting plate

- ▶ Working from the inside, place the heavy-duty wheel onto the horizontal squared tube.

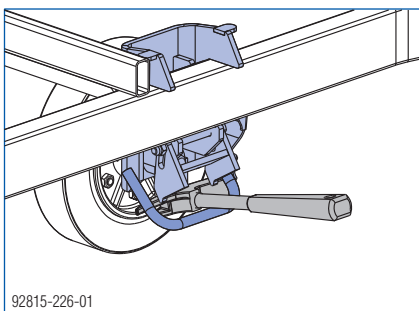

- ▶ Mount both the heavy-duty wheels, first pushing them up against the cross-brace so that they are in exact alignment.

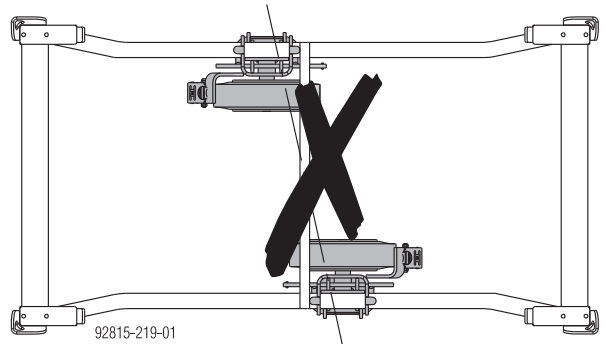
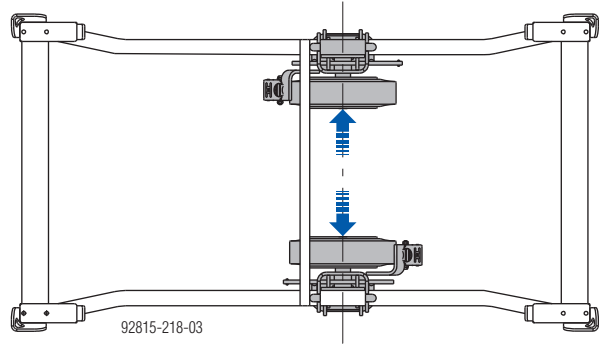

- ▶ Hammer the tensioning wedge firmly into place.

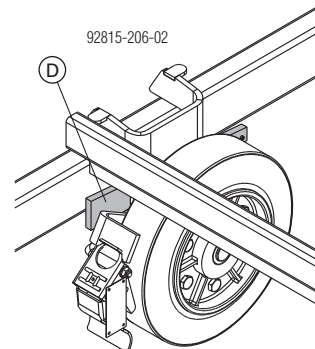

- D** Tensioning wedge



If necessary, the braking force can be adjusted with the setting screw (w/f 24).

## Mounting the heavy-duty wheel on the outside

The instructions below describe installation on the stacking pallet. The procedure for installation on other multi-trip packing is identical.

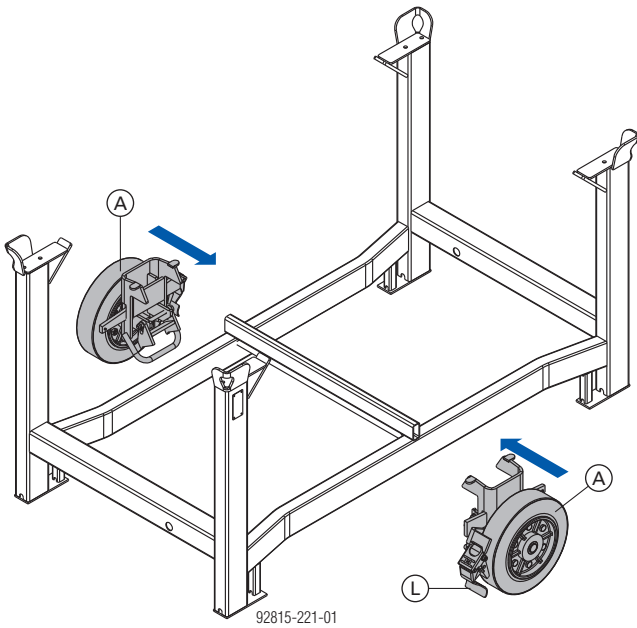

- A Heavy-duty wheel
- L Fixing brake

### Models manufactured until 2008

### 2009 models onward

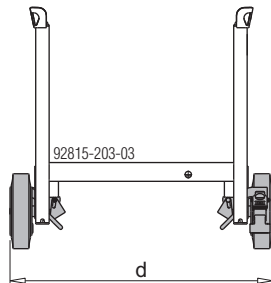
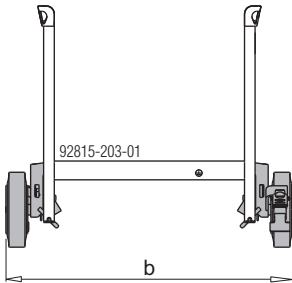

b... < 1100 mm  
d... < 1020 mm

- ▶ Raise the stacking pallet with hardwood blocking (e.g. H20 beams) by min. 'a' = 100 mm.

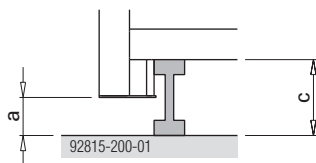

a ... 100 mm  
c ... 200 mm

- ▶ Apply the fixing brake on the heavy-duty wheel.
- ▶ Loosen the tensioning wedge.

### On stacking pallets manufactured from 2008 onward

- ▶ Tilt the adapter down.

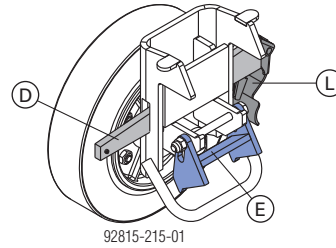

- D Tensioning wedge
- E Adapter
- L Fixing brake

### On stacking pallets manufactured up to and including 2007

- ▶ Flip up the adapter for squared tube 50.

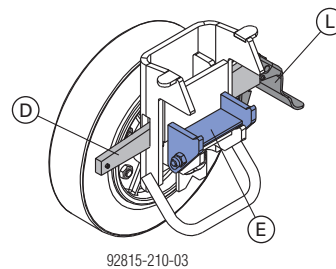

- D Tensioning wedge
- E Adapter
- L Fixing brake

- ▶ Position the heavy-duty wheel at the **middle** of the horizontal squared tube.
- ▶ Hammer the tensioning wedge firmly into place.

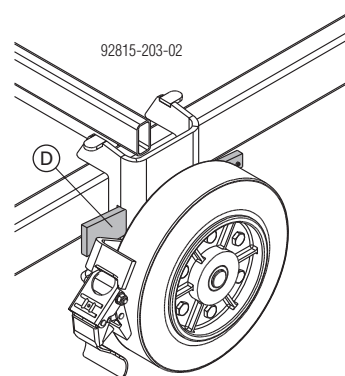

- D Tensioning wedge



If necessary, the braking force can be adjusted with the setting screw (w/f 24).

## Mounting the castor wheel

The instructions below describe installation on the stacking pallet. The procedure for installation on other multi-trip packing is identical.

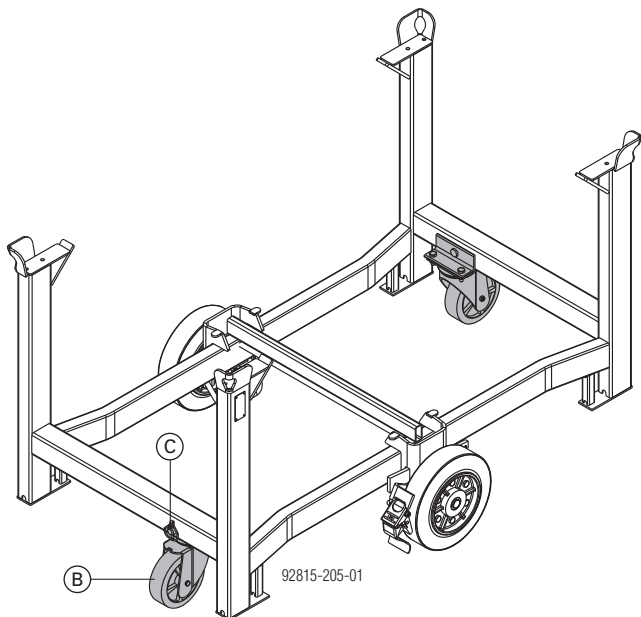

**B** Castor wheel

**C** Linch pin

- Remove the linch pin.
- Working from the inside, insert the Fastening bolt D22 of the castor wheel into the hole in the cross profile.
- Secure with a linch pin.

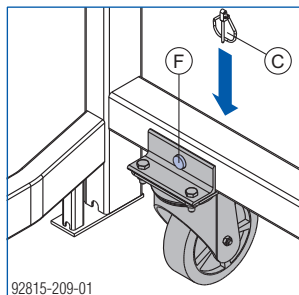
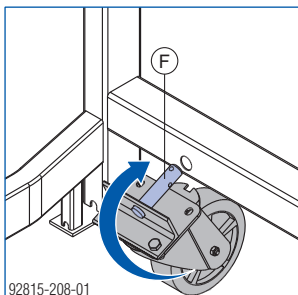

**C** Linch pin

**F** Fastening bolt D22

## Lifting by crane

The Bolt-on castor set B can stay fixed to the multi-trip packaging while it is being lifted.

➤ Before attaching the lifting chain, check that:



- the fixing brake is applied
- the tensioning wedge of the heavy-duty wheel has been hammered firmly into place
- the linch pin has been mounted to the fastening bolt of the castor wheel

## Near to you, worldwide

---

Doka is one of the world leaders in developing, manufacturing and distributing formwork technology for use in all fields of the construction sector.

With more than 160 sales and logistics facilities in over 70 countries, the Doka Group has a highly efficient distribution network which ensures that equipment and

technical support are provided swiftly and professionally.

An enterprise forming part of the Umdasch Group, the Doka Group employs a worldwide workforce of more than 6000.

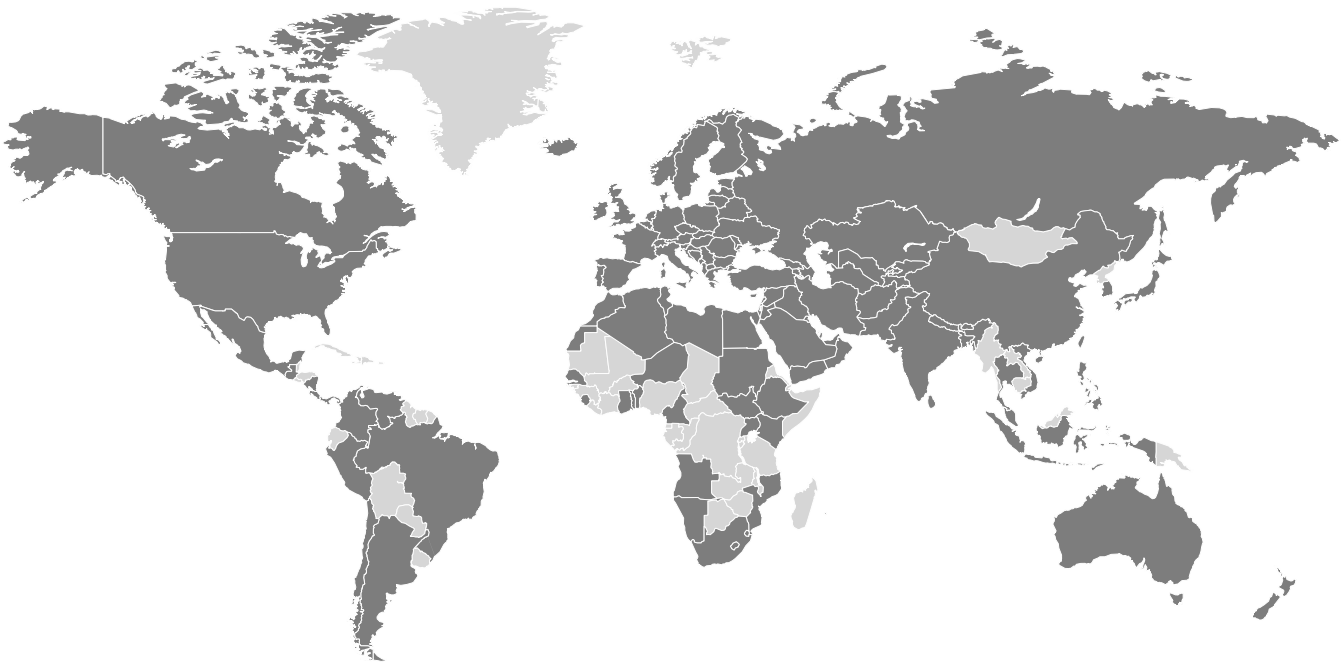

[www.doka.com/multi-trip-packaging](http://www.doka.com/multi-trip-packaging)