

The Formwork Experts.

Bolt-on castor set B

Art. n°: 586168000 | 2008 models onward

Original Operating Instructions

Please retain for future reference

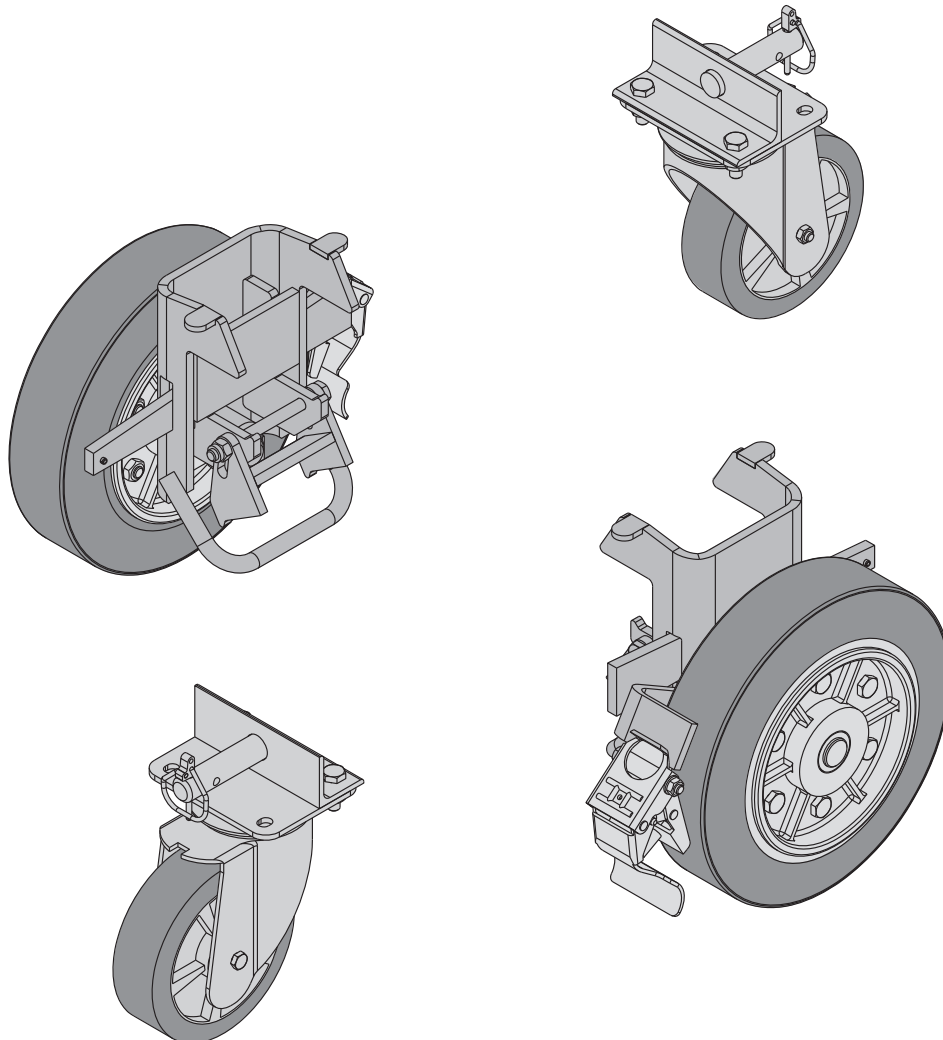

Product description

The Bolt-on castor set B turns the stacking pallet into a fast and manoeuvrable transport device.

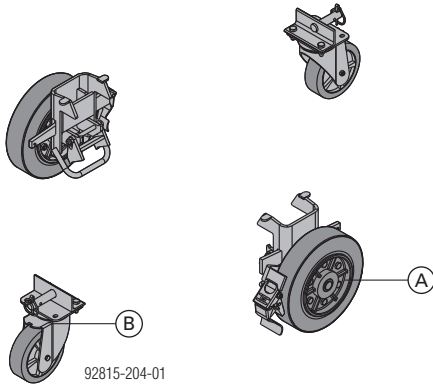

A Heavy-duty wheel

B Castor wheel

A Bolt-on castor set B consists of:

- 2 heavy-duty wheels
- 2 castor wheels

Total weight: 33.8 kg

The Bolt-on castor set B can be mounted to the following multi-trip packaging items:

- Doka stacking pallets
- **Doka accessory box**
- **Dokadek infill beam pallet**

Maintenance & inspection

- Repairs may only be carried out by the manufacturer!
- Doka accepts no liability for products that have been altered!

Before every use

- ▶ Check for any signs of damage or visible deformation.



Lifting accessories that do not meet the following criteria must be withdrawn from use immediately:

- Crack-free and notch-free welds.
- No deformation.

Storage

- Store lifting accessories in a dry and well ventilated place, protected from the weather and from all corrosive substances.

Preconditions for use:



WARNING

Do not use multi-trip packaging fitted with Bolt-on castor set B on slab formwork.

- ▶ There must be a flat, firm (e.g. concrete) base that is capable of supporting the load.



NOTICE

- Max. gradient of floor 3%.
- Max. travel speed: 4 km/h (walking pace)
- Either close structure openings with decking of adequate strength secured so that it cannot slip out of place, or cordon off the openings with edge railings of adequate strength!
- Keep the travel route clean and free of any obstacles.
- It is forbidden to use any other mechanical assistance for the travelling operation!
- It is forbidden to wheel multi-trip packaging units that have been stacked on top of one another!

Mounting the heavy-duty wheel on the inside

Note:

On stacking pallets manufactured up to and including 2007

It is only possible to mount the heavy-duty wheels on the outside.

The instructions below describe installation on the stacking pallet. The procedure for installation on other multi-trip packing is identical.

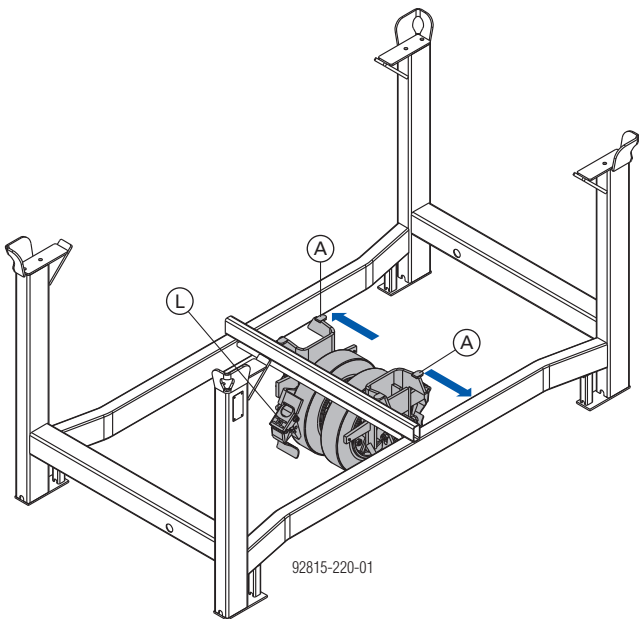

- A Heavy-duty wheel
- L Fixing brake

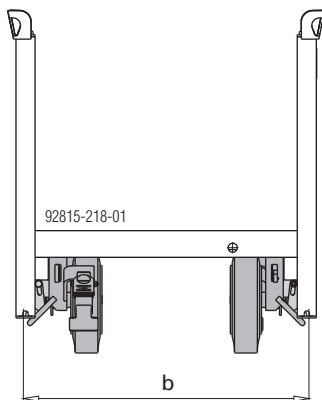

b ... < 900 mm

- ▶ Raise the stacking pallet by min. 'a'=120 mm by means of hardwood blocking.

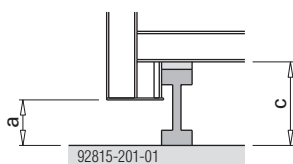

a ... 120 mm
c ... 220 mm

- ▶ Apply the fixing brake on the heavy-duty wheel.
- ▶ Loosen the tensioning wedge.

- ▶ Flip the adapter down.

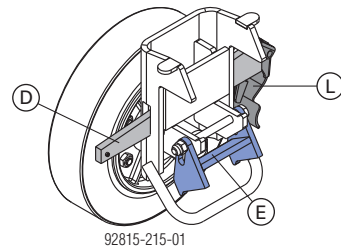

- D Tensioning wedge
- E Adapter
- L Fixing brake

- ▶ Fit a formwork hammer between the handle and the mounting plate.
- ▶ Pass the heavy-duty wheel under the pallet.

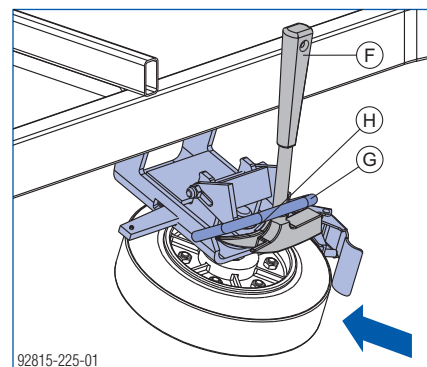

- F Formwork hammer
- G Handle
- H Mounting plate

- ▶ Working from the inside, place the heavy-duty wheel onto the horizontal squared tube.

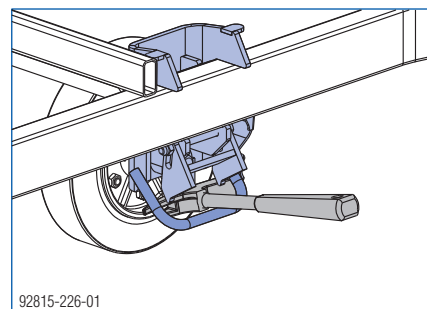

- ▶ Mount both the heavy-duty wheels, first pushing them up against the cross-brace so that they are in exact alignment.

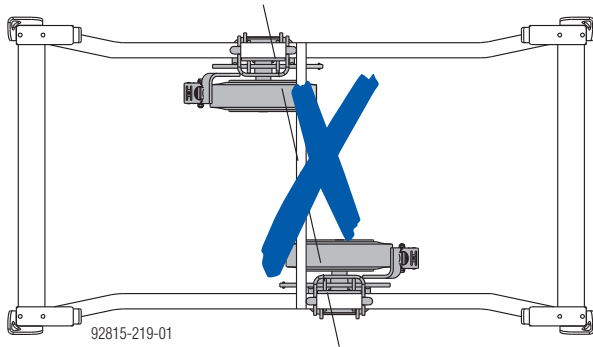
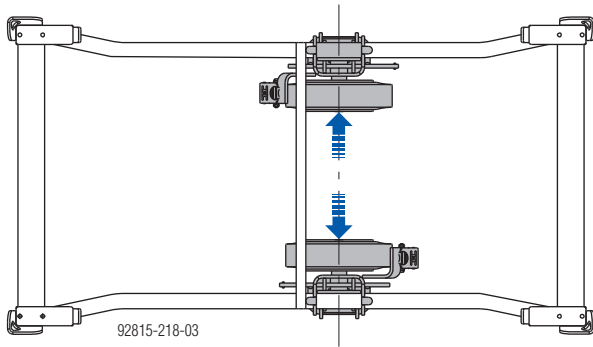

- ▶ Hammer the tensioning wedge firmly into place.

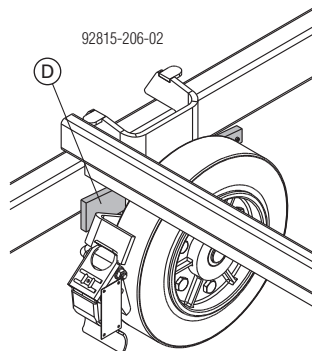

D Tensioning wedge



If necessary, the braking force can be adjusted with the setting screw (w/f 24).

Mounting the heavy-duty wheel on the outside

The instructions below describe installation on the stacking pallet. The procedure for installation on other multi-trip packing is identical.

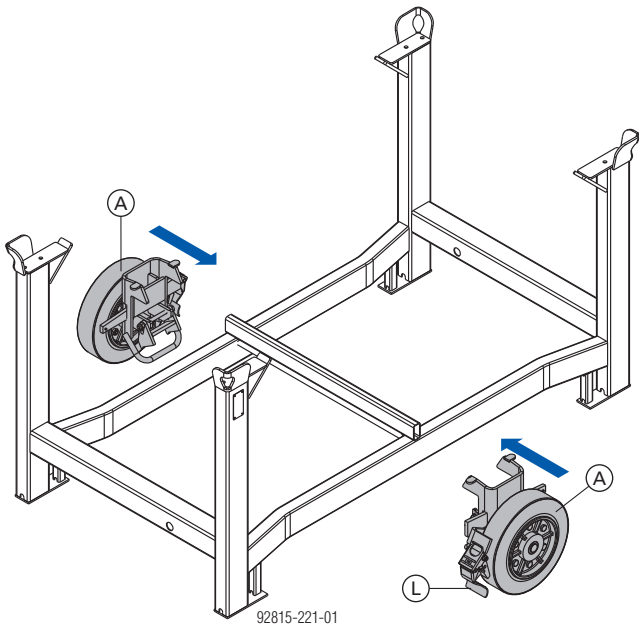

- A** Heavy-duty wheel
- L** Fixing brake

Models manufactured until 2008

2009 models onward

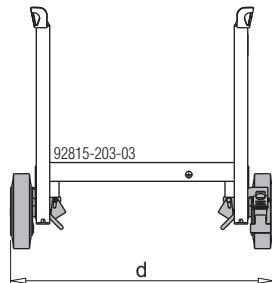
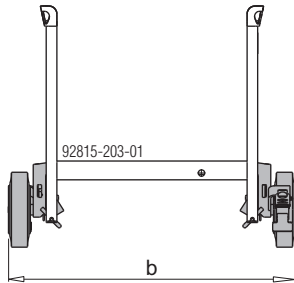

b... < 1100 mm
d... < 1020 mm

- ▶ Raise the stacking pallet with hardwood blocking (e.g. H20 beams) by min. 'a' = 100 mm.



a ... 100 mm
c ... 200 mm

- ▶ Apply the fixing brake on the heavy-duty wheel.
- ▶ Loosen the tensioning wedge.

On stacking pallets manufactured from 2008 onward

- ▶ Tilt the adapter down.

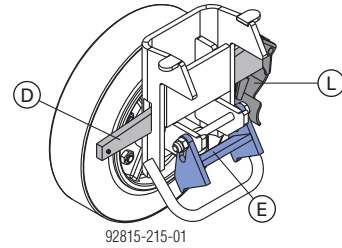

- D** Tensioning wedge
- E** Adapter
- L** Fixing brake

On stacking pallets manufactured up to and including 2007

- ▶ Flip up the adapter for squared tube 50.

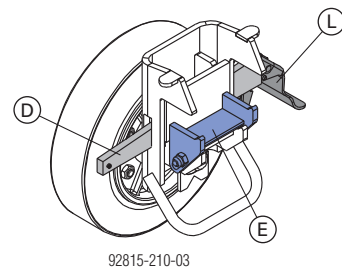

- D** Tensioning wedge
- E** Adapter
- L** Fixing brake

- ▶ Position the heavy-duty wheel at the **middle** of the horizontal squared tube.
- ▶ Hammer the tensioning wedge firmly into place.

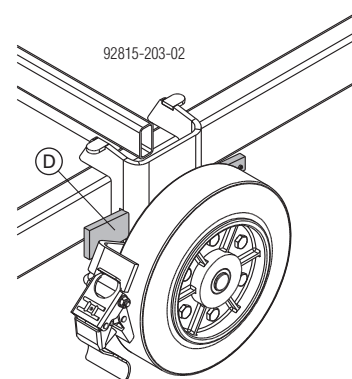

- D** Tensioning wedge



If necessary, the braking force can be adjusted with the setting screw (w/f 24).

Mounting the castor wheel

The instructions below describe installation on the stacking pallet. The procedure for installation on other multi-trip packing is identical.

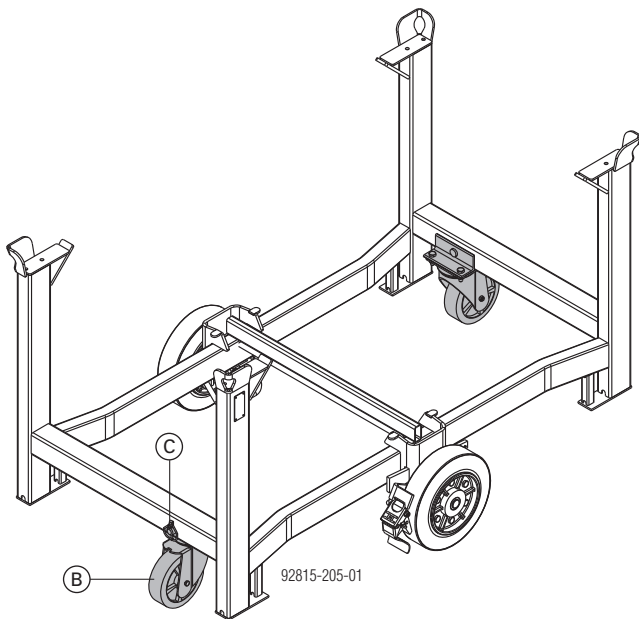

B Castor wheel

C Linch pin

- Remove the linch pin.
- Working from the inside, insert the Fastening bolt D22 of the castor wheel into the hole in the cross profile.
- Secure with a linch pin.

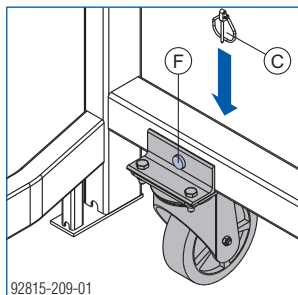
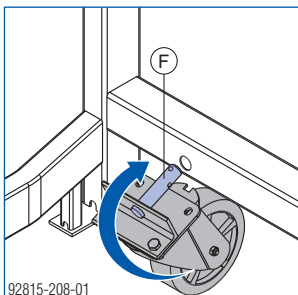

C Linch pin

F Fastening bolt D22

Lifting by crane

The Bolt-on castor set B can stay fixed to the multi-trip packaging while it is being lifted.

- Before attaching the lifting chain, check that:



- the fixing brake is applied
- the tensioning wedge of the heavy-duty wheel has been hammered firmly into place
- the linch pin has been mounted to the fastening bolt of the castor wheel